

## TORQUE CONVERTER, TRANSMISSION PIPING

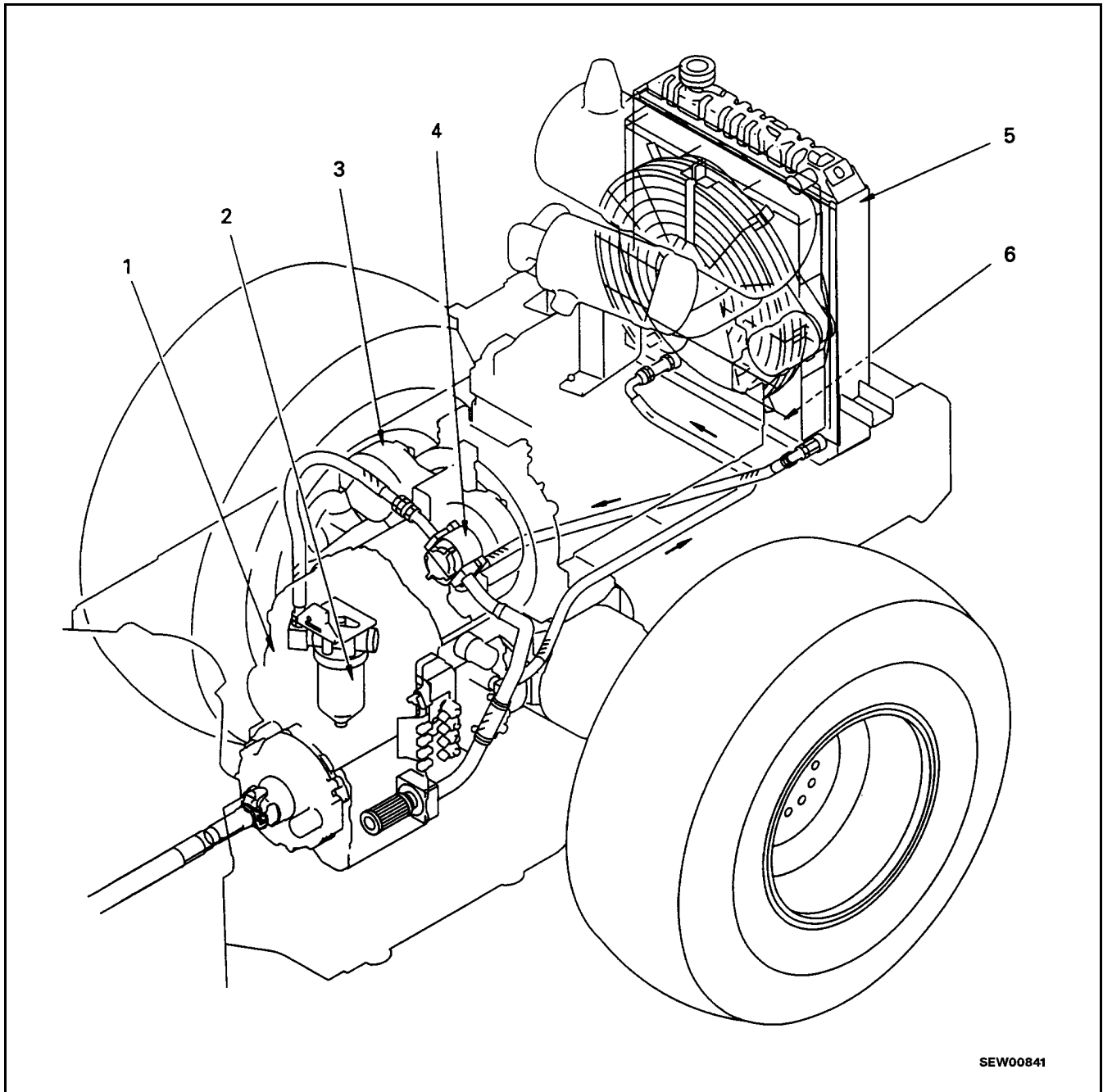

- |                     |                                   |
|---------------------|-----------------------------------|
| 1. Transmission     | 4. Torque converter charging pump |
| 2. Oil filter       | 5. Radiator                       |
| 3. Torque converter | 6. Oil cooler                     |

**OUTLINE**

The oil from the torque converter charging pump passes through the oil filter and flows to the brake booster. From the brake booster, it flows to the main regulator valve and is divided into three lines: the torque converter circuit, clutch circuit, and solenoid pilot circuit.

The oil flowing to the torque converter circuit enters the torque converter. The oil pressure is adjusted by the torque converter outlet port valve, the oil is cooled by the oil cooler, lubricates the transmission and returns to the transmission case.

**MEMORANDUM**

# TRANSMISSION HYDRAULIC SYSTEM DIAGRAM

ENGINE LOW IDLING, DIRECTIONAL LEVER AT NEUTRAL, SPEED LEVER AT 2ND

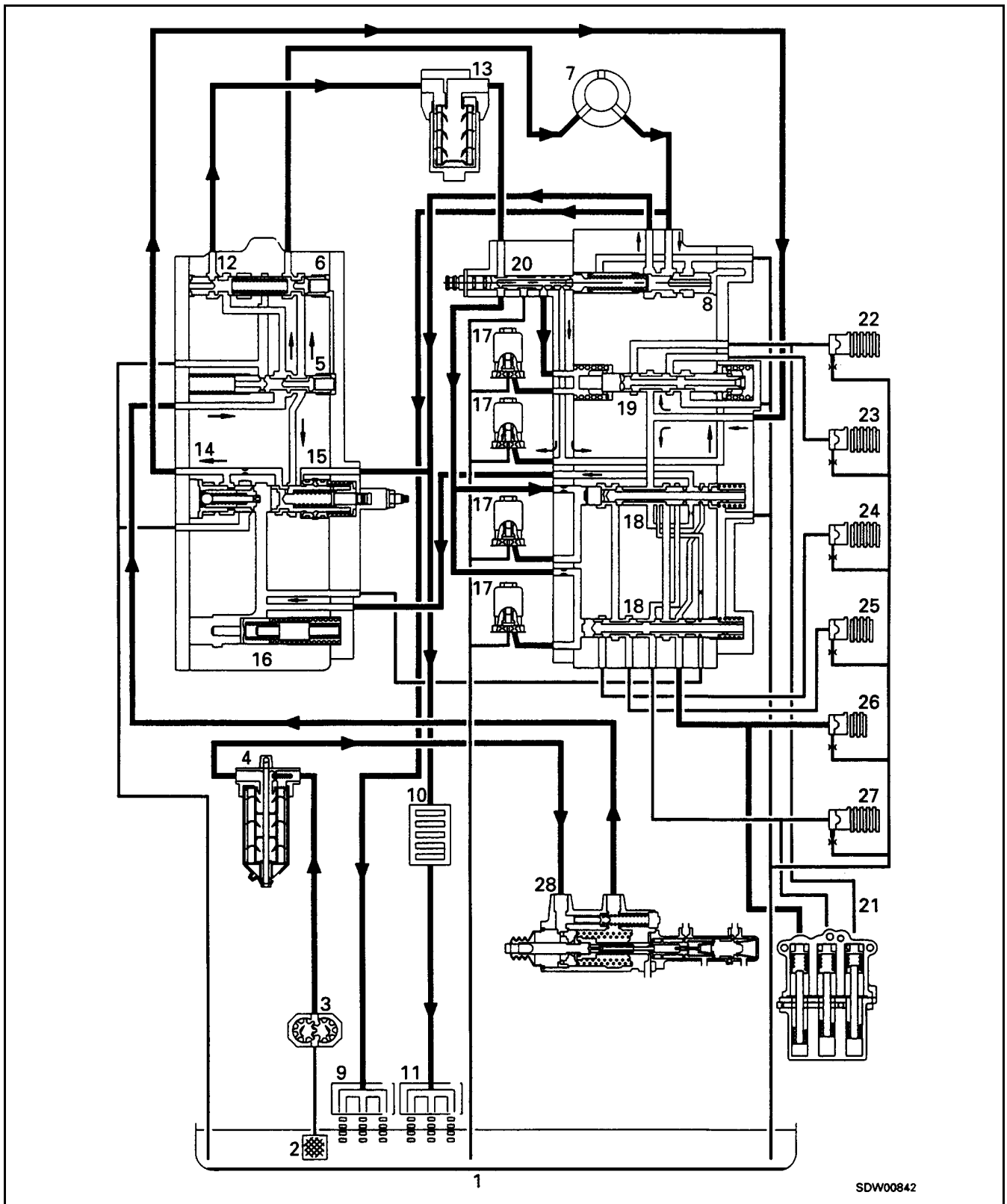

SDW00842