

Clean Electronic injectors (In Engine)

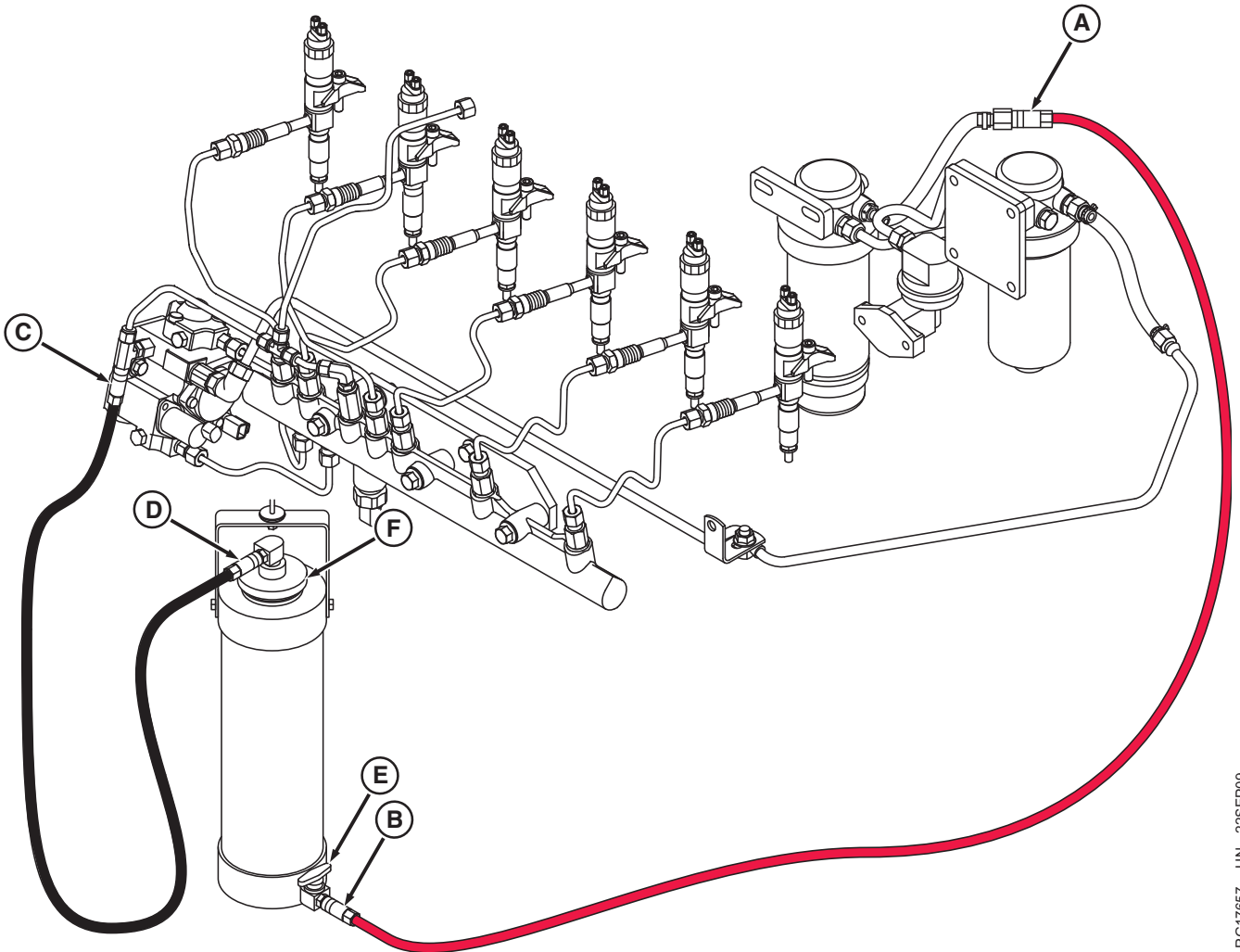

Clean Electronic Injectors In-Engine

A—Fuel Filter Inlet
B—Reservoir Fuel Outlet

C—Fuel Return-to-Tank (Leak-off) E—Shut-Off Valve
D—Reservoir Fuel Inlet F—Filter

1. Change engine primary and secondary fuel filters.
2. Prime fuel system and start engine.
3. Run engine until normal operating temperature is reached.
4. Disconnect the fuel supply to the primary fuel filter (A).

Connect the 2 meter (6 ft.) red hose (supply) to the primary fuel filter (A) using the appropriate adapter in the SW10015JD Fuel Injector Flush Kit.

Connect the other end of the red hose to the bottom fitting (B) of the kit reservoir tank.

5. Disconnect fuel return-to-fuel tank (C). This location will vary for each application.

Connect the 2 meter (6 ft.) black hose (return) to the tank line using the appropriate Kit adapter in the SW10015JD Fuel Injector Flush Kit.

6. Fill the reservoir tank with the full contents of John Deere Diesel Fuel System Clean-Up solution. Open valve (E) on the reservoir tank.
7. Key-on engine to check for leaks and verify return fuel is flowing back to the reservoir. If the fluid level drops quickly, shut-off engine and check to make sure all of the return fuel is getting back to the tool reservoir.
8. Start engine and run at 1100 rpm.

Allow engine to run for 20-40 minutes. Watch for fuel to get to the bottom of the warning decal. **Do not let the engine run out of fuel.**

Shut-off engine.

Continued on next page

MK41968,0000040 -19-26MAY11-1/2

RG17657—UN—22SEP09