

---

**IN-VEHICLE REPAIR****Engine Mount — LH****Removal and Installation**

1. With the vehicle in NEUTRAL, position it on a hoist. For additional information, refer to Section 100-00.
2. Remove the intake manifold tuning valves. For additional information, refer to Section 303-04A.
3. Remove the fresh air inlet duct housing. For additional information, refer to Section 412-00.
4. Remove the components in the order indicated in the following illustration and table.

**IN-VEHICLE REPAIR (Continued)**

5. To install, reverse the removal procedure.

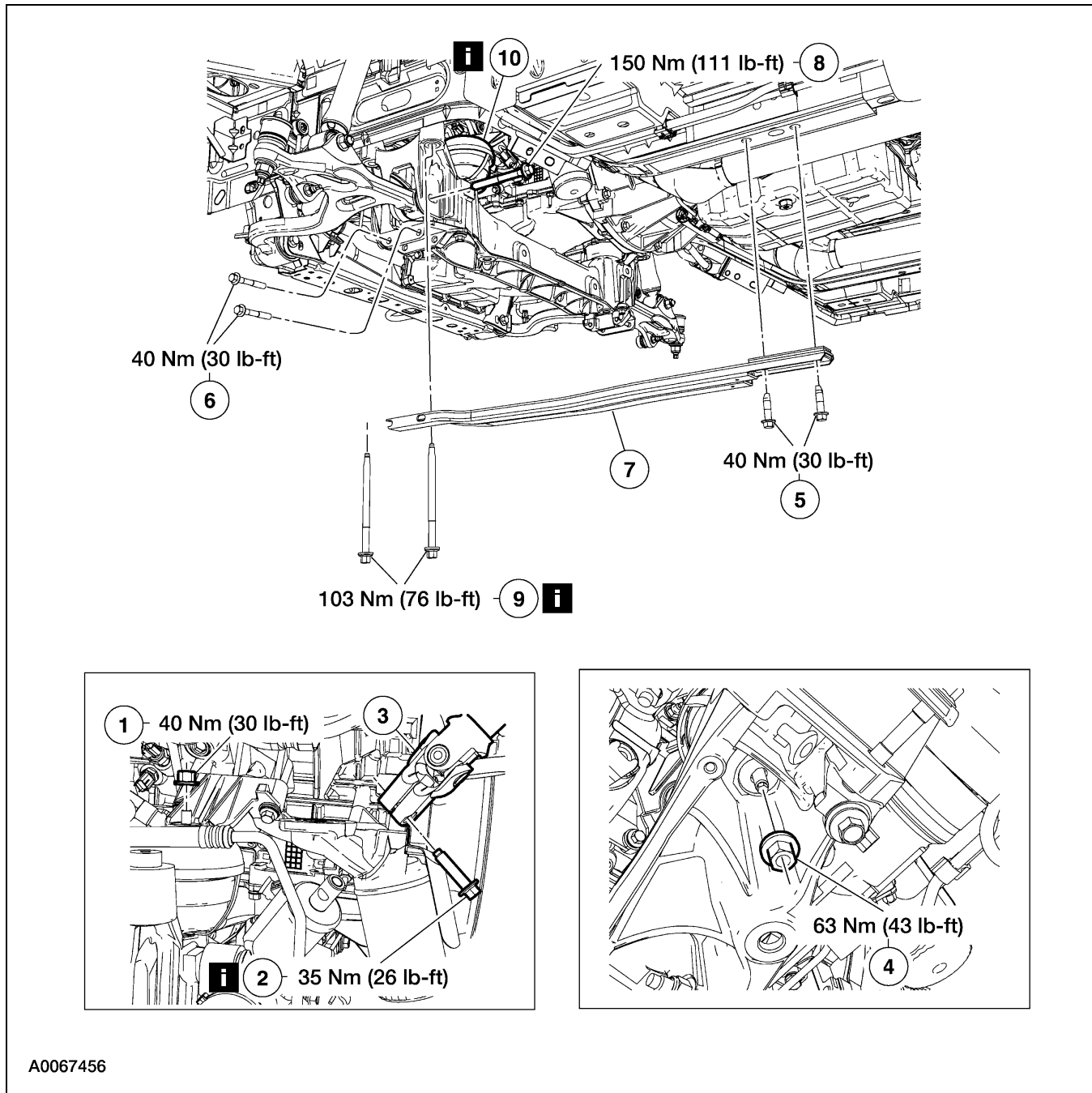

A0067456

Item	Part Number	Description
1	N621942	LH engine mount upper nut
2	W705133	Intermediate shaft pinch bolt Removal Note
3	3C662	Intermediate shaft
4	N621942	LH engine mount lower nut
5	W707186	Crossmember brace bolts (rear) (4 req'd)

(Continued)

Item	Part Number	Description
6	N804518	Crossmember brace bolts (front) (4 req'd)
7	5A099	Crossmember brace
8	W706933	Lower control arm through-bolt
9	W706239	Center crossmember bolts (4 req'd) Removal Note
10	6A003	LH engine mount Removal Note

---

**IN-VEHICLE REPAIR (Continued)****Item 2: Intermediate Shaft Pinch Bolt Removal Note**

1.  **CAUTION:** The steering wheel must be in the locked position, or the lower end of the column wired in such a way that the steering column does not rotate, resulting in damage to air bag sliding contact.

Disconnect the steering coupling.

**Item 9: Center Crossmember Bolts Removal Note**

1. Loosen the center crossmember bolts.

**Item 10: LH Engine Mount Removal Note**

1. Raise the engine and lower the center crossmember to remove the LH engine mount.