

Lift Wheels

FIG. 2: Loosen both pressure strap springs (1).
Remove the caster axle (2).

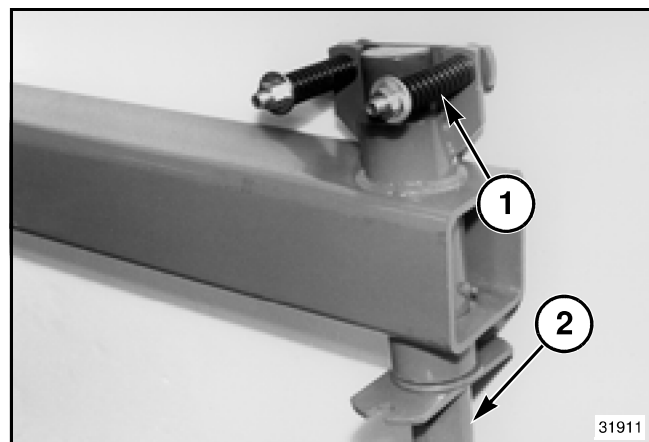

FIG. 2

FIG. 3: Lift Assist Beam Removal from Frame

- (1) Mounting Anchor
- (2) Frame
- (3) Beam
- (4) U-bolts
- (5) Pin, bolts
- (6) Hydraulic Fittings

With the planter connected to the tractor and row units on the ground, remove the mounting anchor from the toolbar (locations above) using the four U-bolts.

NOTE: On 12-row vertical fold models, anchor straddles wing lockup U-bolt.

Remove lift assist beam from the mounting anchor.

Replace parts as necessary.

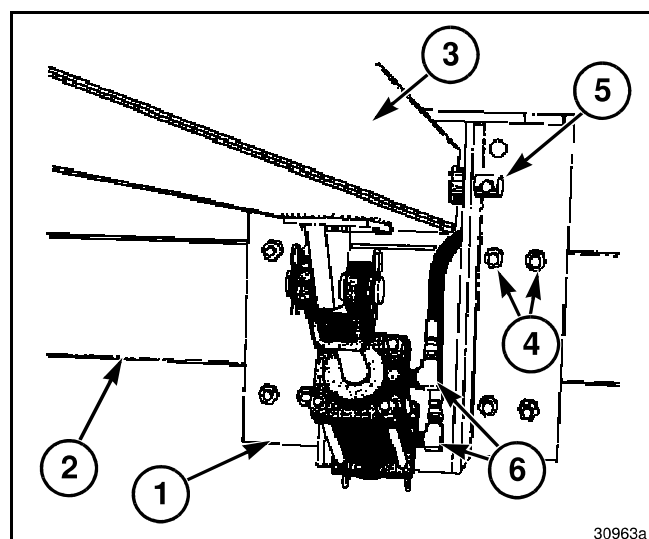

FIG. 3

Disassembly

FIG. 4: Remove the wheel (1) from the hub assembly (2).

Disassemble hub assembly.

Replace cup bearings and cone bearings as needed.

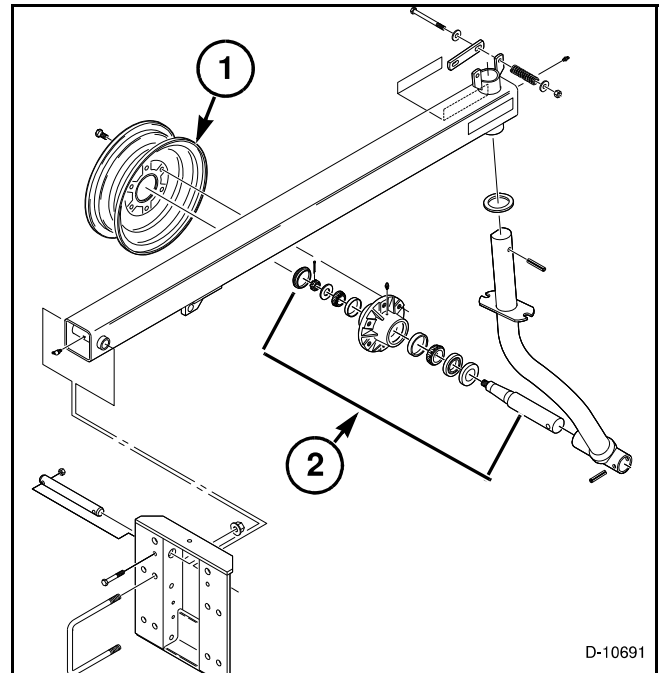

FIG. 4

Assembly

FIG. 5: Assemble hub assembly (1).

Install the wheel (2) to the hub assembly.

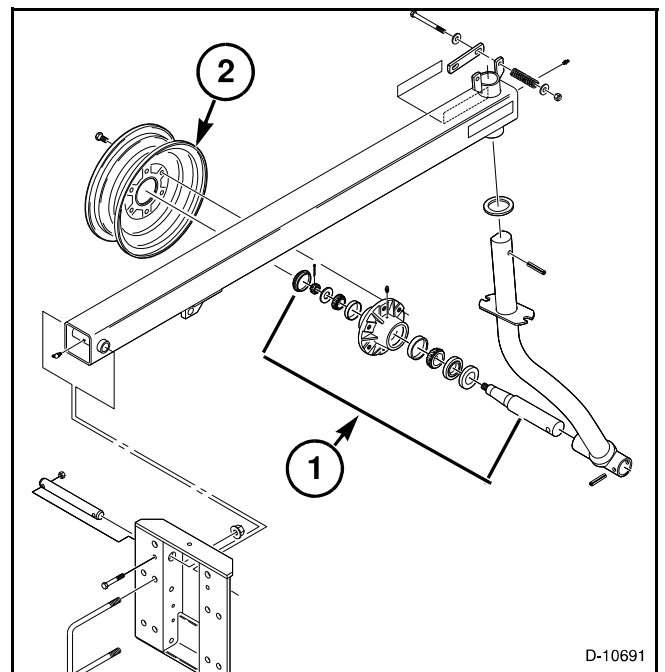

FIG. 5

Lift Wheels

Installation

FIG. 6: Lift Assist Beam Attached to Frame

- (1) Mounting Anchor
- (2) Frame
- (3) Beam
- (4) U-bolts
- (5) Pin, bolts
- (6) Hydraulic Fittings

With the planter connected to the tractor and row units on the ground, fasten the mounting anchor to the toolbar (locations above) with four U-bolts. Position the mounting anchor between row units.

NOTE: On 12-row vertical fold models, anchor straddles wing lockup U-bolt.

Install lift assist beam on the mounting anchor with a pin and 1/2 x 2 inch bolts.

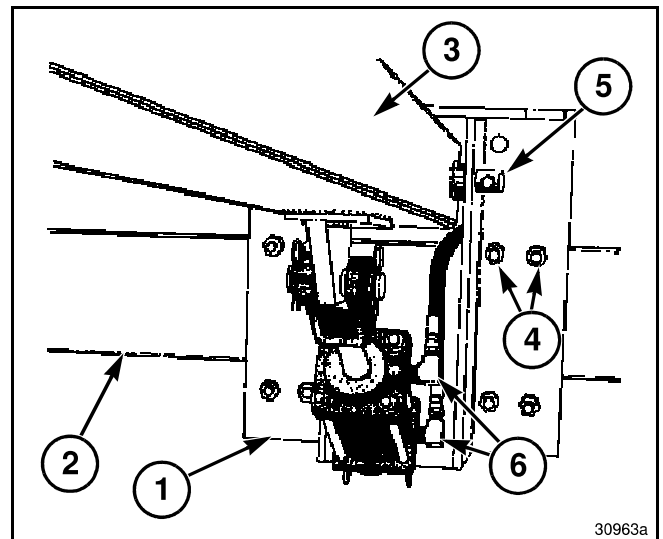

FIG. 6

FIG. 7: Install the wear washer (1) onto the caster axle (2).

Install the caster axle.

Install both pressure strap springs (3).

Tighten both pressure strap springs (3) to 83 mm (3-3/4 in) length.

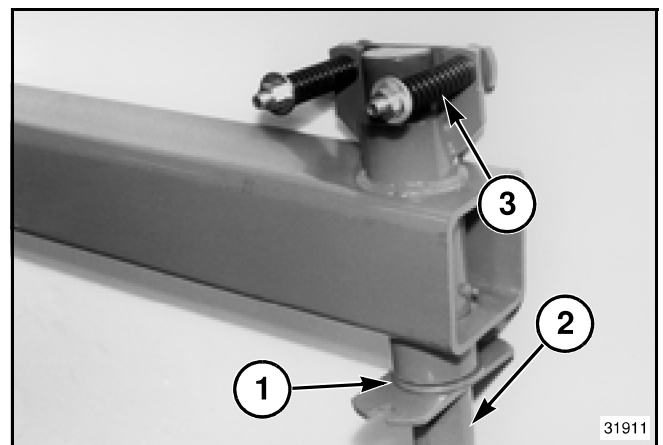

FIG. 7

FIG. 8: Install the rod end of the 4 x 4 inch hydraulic cylinder (1) to the lift assist beam (2) and the base end to the mounting anchor (3).

NOTE: Position the hose ports toward the center of planter.

Install 90 degree elbow fittings in the cylinder ports with open ends up if needed.

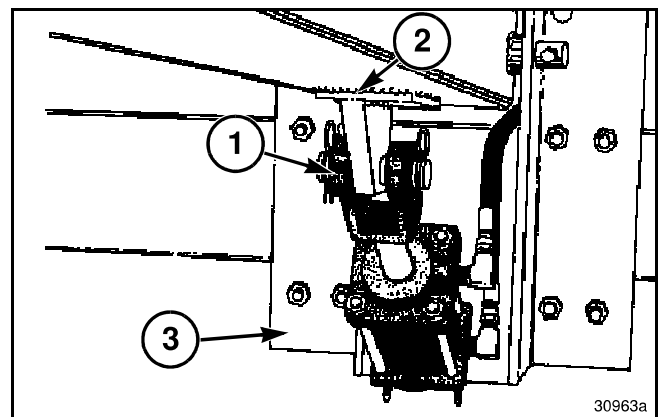

FIG. 8