

Fig. 3

The steering control unit (1) controls the flow of oil to the steering cylinder (2). When the steering wheel is motionless, pressurized oil travels from the three point control valve (3) through the pressure hose (4) to the steering control unit pressure port . Return oil travels from the steering control unit tank port through the return hose (5) to the front transmission cover (6).

When the steering wheel is turned to the left, the steering control unit will send oil from left turn port through the left turn steering hose (7) and move the steering cylinder rod so the wheels turn to the left. When the steering wheel is turned to the right, the steering control unit will send oil from right turn port through the right turn steering hose (8) and move the steering cylinder rod so the wheels turn to the right.

4.1.1 Steering wheel and steering control unit

- (1) Cap
- (2) Nut
- (3) Steering wheel
- (4) Steering control unit

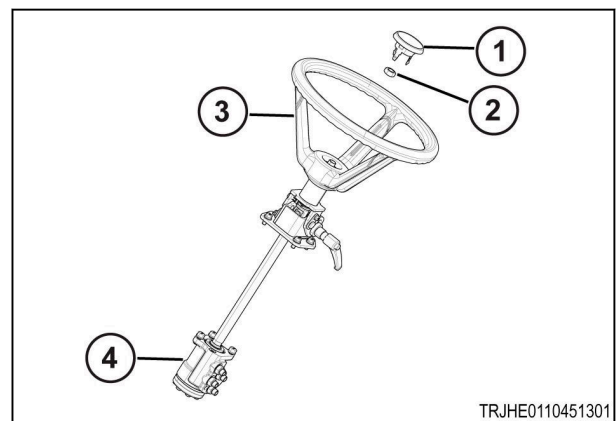

Fig. 4

4.1.2 Steering control unit specifications

Specifications	
Displacement	50 cc/rev
Relief valve setting	85 kg/cm ² to 90 kg/cm ² (1208 psi to 1280 psi)

4.1.3 Remove the steering control unit

Procedure

1. Use a flat screwdriver to remove the middle cap on the steering wheel.
2. Remove the nut.
3. Pull the steering wheel upwards off the splined steering shaft.
4. Remove the screw (1) then remove the lower dash cover.



Fig. 5

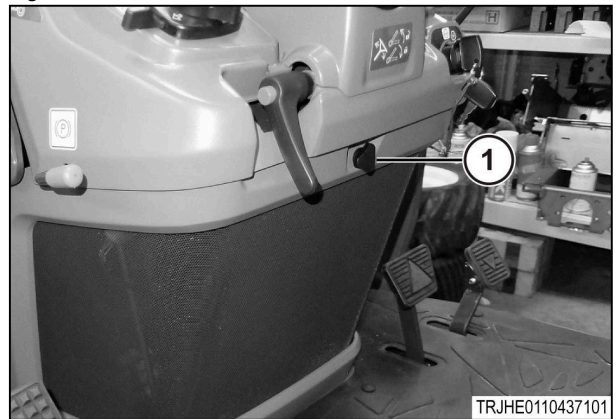

Fig. 6