

FIG. 9: Remove tension from springs (1) on transmission support mounts (2). Remove support mounts from transmission.

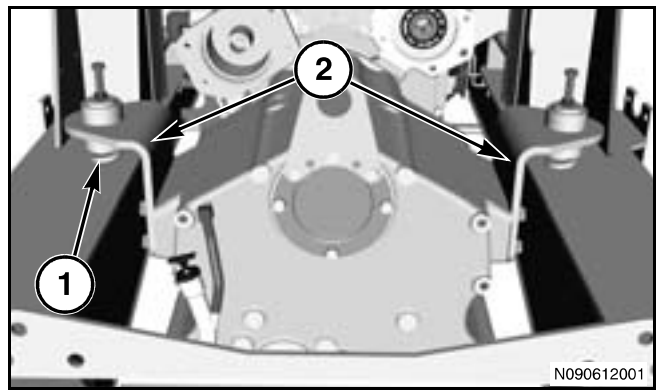

FIG. 9

FIG. 10: Bolt transmission stand to sides of transmission and install three hydraulic jacks to support transmission. Apply pressure to jacks to support transmission.

Install come-along bracket on cab frame and fasten come-along to bracket with cables hanging from pulleys on bracket.

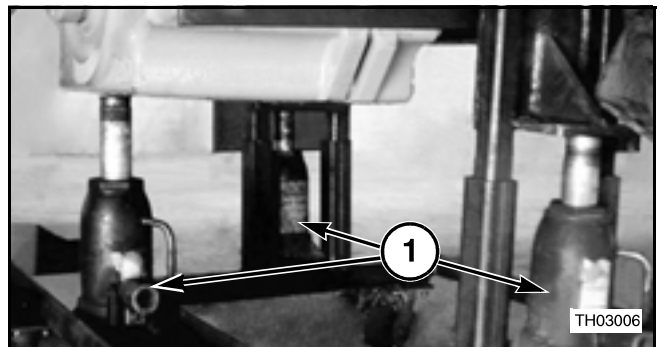

FIG. 10

FIG. 11: Reposition rear transmission lifting eye to top and install transmission lifting bar (1) through both lifting eyes and secure. Attach come-along cable to lifting bar and tighten cable.

Remove bolts that hold transmission to engine flywheel housing. Pry transmission away from engine flywheel housing.

Lower rear jack and remove.

Lower transmission with come-along until transmission is laying down on stand.



CAUTION: The transmission is extremely heavy. Care should be used while lowering the transmission with the come-along.

Disconnect come-along and roll transmission out from under machine using stand.

Inspect torsion damper for loose or broken springs, damaged and discolored clutch plates or other signs of slippage and wear. Replace if necessary.

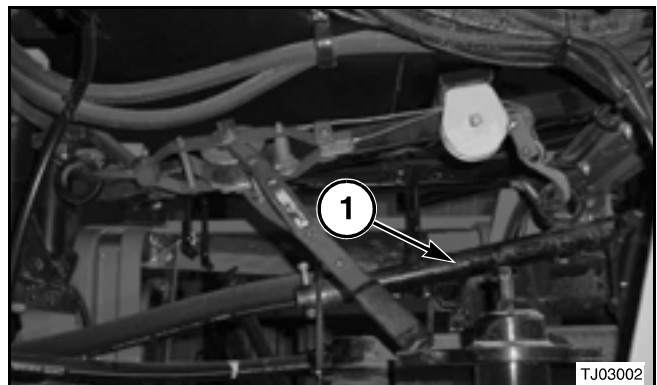

FIG. 11

Transmission

TRANSMISSION INSTALLATION

FIG. 12: Remove dipstick tube from transmission and install any necessary fittings in transmission. If necessary, install torsion damper. Mount transmission on stand and lay in horizontal position. Position transmission under chassis and install come-along and pulley system.

Using come-along and pulley system, lift transmission to vertical position and install rear jack to support in position.



CAUTION: The transmission is extremely heavy. Care should be used while lifting the transmission with the come-along.

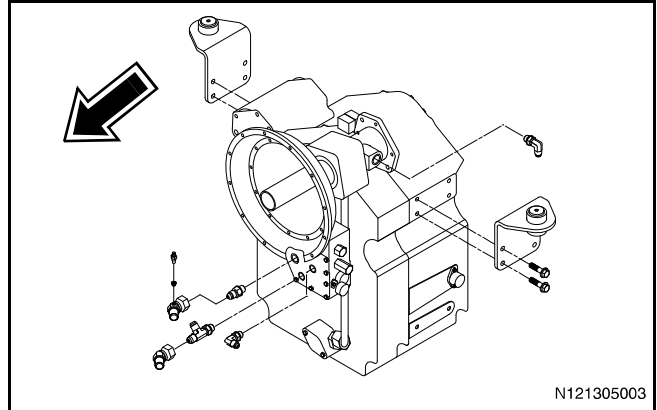

FIG. 12

FIG. 13: Remove cable lifting system (1).

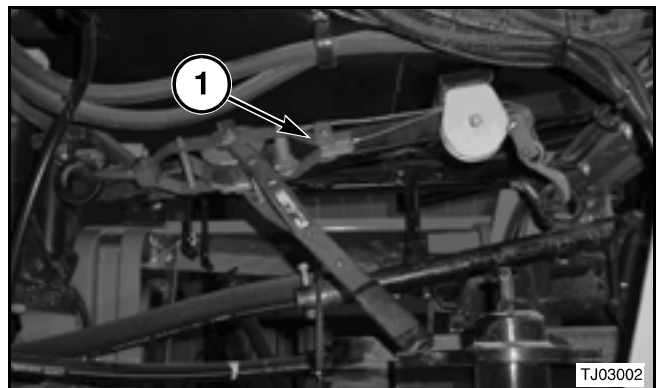

FIG. 13

FIG. 14: Using three hydraulic jacks (1), align transmission with flywheel housing and input shaft with damper.

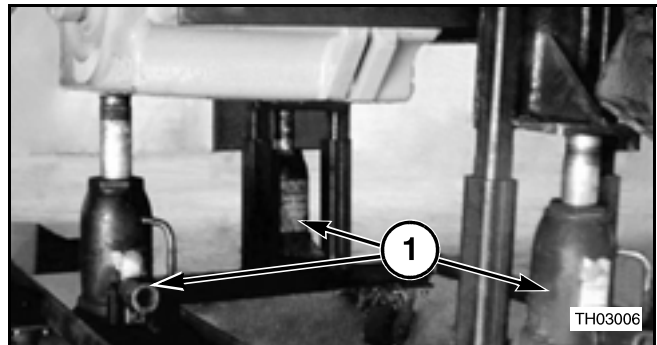

FIG. 14

FIG. 15: Move transmission (1) forward to engage input shaft into damper.

NOTE: The come-along may be attached to the front of the chassis to help pull the transmission forward.

Rotate transmission input shaft to align spines of damper and input shaft.

NOTE: An old pump drive shaft may be used in one of the auxiliary pump drives to help rotate the input shaft.

Install bolts to hold transmission to flywheel housing.

NOTE: Use blue thread lock adhesive on the bolts and torque to 35 Nm (26 lbf ft).

Remove transmission stand.

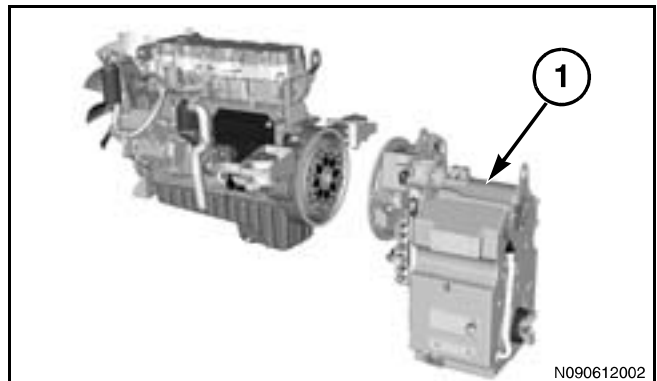

FIG. 15