

## Wheels and Tires

### DRIVE WHEEL REMOVAL AND INSTALLATION

**FIG. 1:** Park the machine on a solid level surface and lower the header to the floor. Stop the engine and apply the parking lock. Make sure the steering wheel is centered and locked.

Put blocks in front of and behind the opposite tire. Put blocks in front of and behind both tailwheels.

To remove the drive wheel, loosen the wheel bolts (1) a small amount.

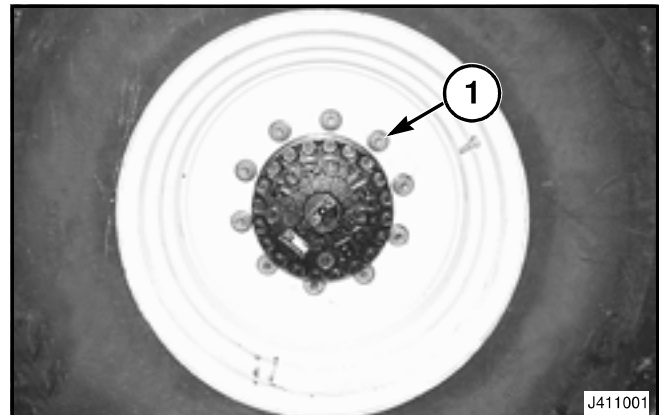

**FIG. 1**

**FIG. 2:** Use a jack with a capacity of at least 2724 kg (6000 lb) to raise the tire off the floor. Put the jack under the bracket (1) at the rear of the strut.

Put a support under the strut (2).

Remove the wheel bolts. Remove the wheel.

To install the drive wheel, put the wheel on the pilot. Start all of the wheel bolts into the hub by hand. Tighten the wheel bolts with a hand wrench.

Remove the support from under the strut. Lower the tire to the floor.

Tighten wheel bolts to the correct torque.

**IMPORTANT:** Check the torque of the wheel bolts after 3 to 5 hours of operation.

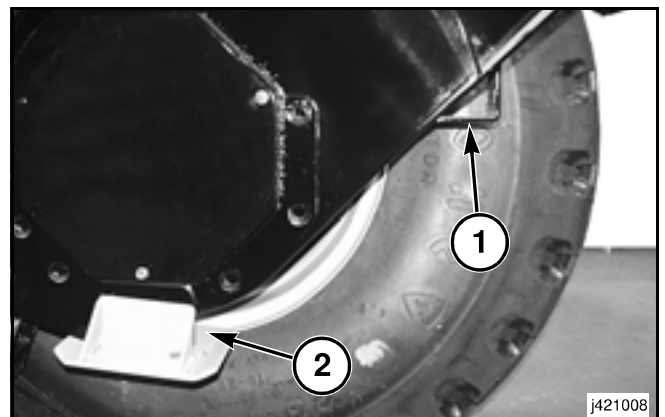

**FIG. 2**

## TAILWHEEL REMOVAL AND INSTALLATION

### Formed Casters

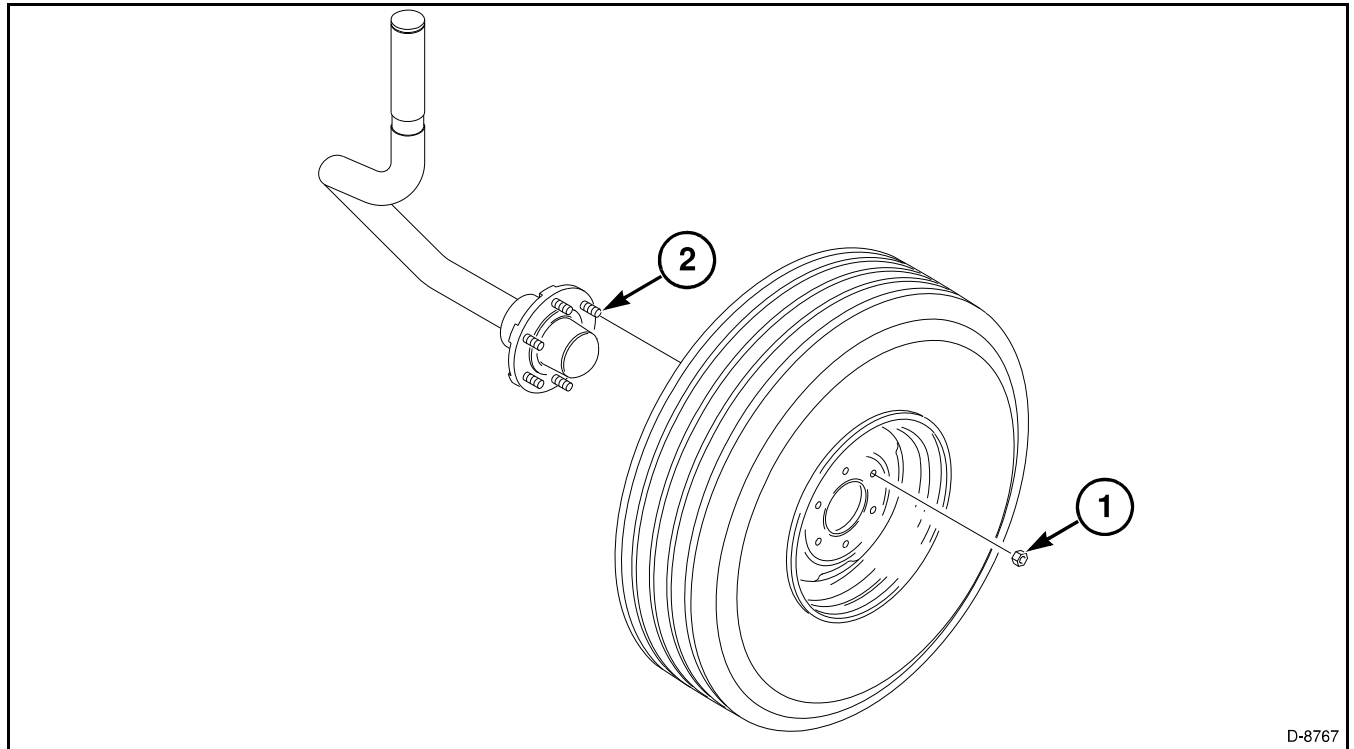

D-8767

**FIG. 3**

**FIG. 3:** Park the machine on a solid level surface and lower the header to the floor.

Stop the engine and apply the parking lock. Make sure the steering wheel is centered and locked.

Put blocks in front of and behind both drive wheels.

Loosen the wheel nuts (1) a small amount.

Use a jack under the outer end of the walking beam to raise the tire off the floor.

Put a support under the walking beam.

Remove the six wheel nuts.

Remove the tailwheel.

Clean the threads of the wheel bolts (2) with a wire brush.

Install the wheel on the hub. Make sure the hub is on the opposite side as the valve stem. Install the wheel nuts and tighten the wheel nuts enough to center the wheel on the hub. **DO NOT** tighten the wheel nuts all the way.

Use a jack under the outer end of the walking beam to raise the walking beam. Remove the support from under the walking beam. Lower the wheel to the floor.

Tighten the wheel nuts. See Specifications in this section for the correct torque.

**IMPORTANT:** Check the torque of the wheel nuts after 3 to 5 hours of operation.