

## LIFT WHEELS

### MAIN LIFT WHEELS

#### General Information

Worn bearings in the wheel hub could cause the tire not to rotate properly.

#### Removal

**FIG. 1:** Lower planter.

Use proper lifting device to lift wheel off of the ground.

Remove the eight lug nuts (1) from the wheel.

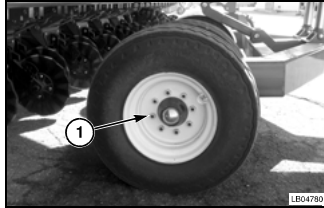

FIG. 1

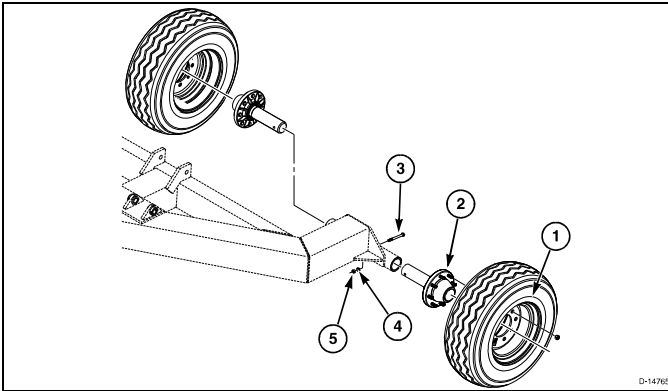

FIG. 2

**FIG. 2:** Pull the wheel (1) from the hub (2).

Remove bolt (3), lock washer (4), and nut (5).

Remove hub.

## Lift Wheels

### Disassembly

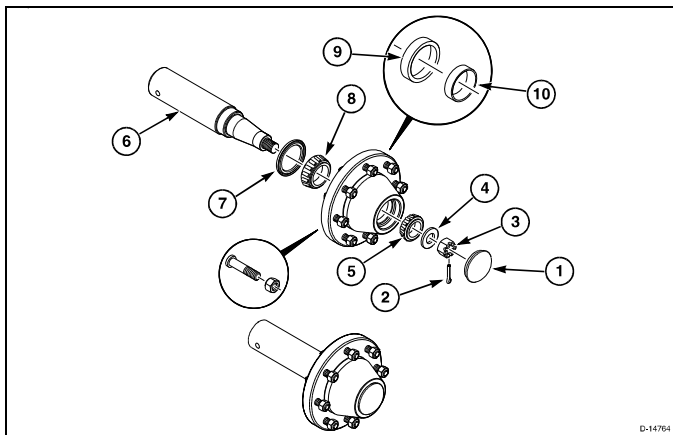

FIG. 3

**FIG. 3:** Remove the hub cap (1) by using a chisel and hammer and working the hub cap out of the hub.

Pull out the cotter pin (2).

Unscrew the slotted hex nut (3).

*NOTE: There is no need to remove the spindle (6) if only replacing or packing the bearings.*

Remove the washer (4) and outer cone bearing (5).

Remove the spindle (6), grease seal (7), and the inner cone bearing (8).

Remove the inner (9) and outer (10) cup bearings.

### Inspection

Clean the components in a solvent.

Inspect the bearings to see if the rollers are working properly. If damaged, replace the bearings.

Inspect other components. Replace if damaged.