

GAUGE WHEELS

GENERAL INFORMATION

The row unit has two depth gauge wheels, one on each side of the lower frame. Each wheel raises and lowers independently, so when one wheel rides over an obstacle the other remains at ground level. As a result, the row unit raises only half the distance of the highest wheel to help maintain correct planting depth.

GAUGE WHEELS

Before working on row units:

- Park the planter on a solid, level surface.
- Install the transport lockup channels on the planter before working.
- Turn tractor off and take key with you.

Tire-to-Opener Clearance

FIG. 1: Gauge wheel tire-to-opener clearance must be 0 to 1.6 mm (0.0625 in). The tires can lightly rub opener discs and the discs must rotate freely. To adjust, add or subtract washers (1) on pivots between gauge wheel arms (2) and row unit frame.

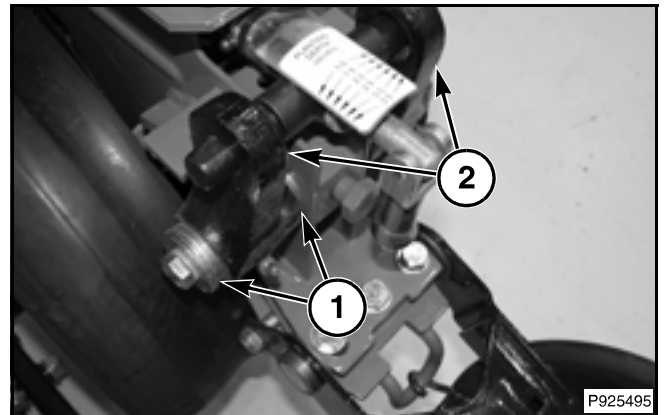

FIG. 1

Wheel Arm Endplay

FIG. 2: Remove arm end play by adding washers between cap screw (1), arm (2) and wheel support (3).

NOTE: Gauge wheel arm must pivot freely after cap screws are tightened. Apply grease to the gauge wheel arm grease fitting (4) to ensure free movement of the gauge wheel arms.

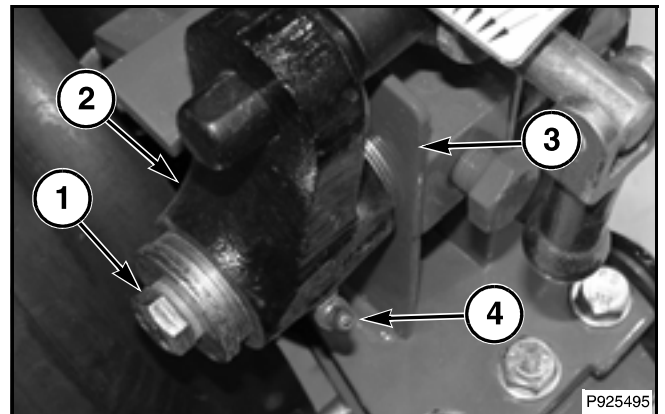
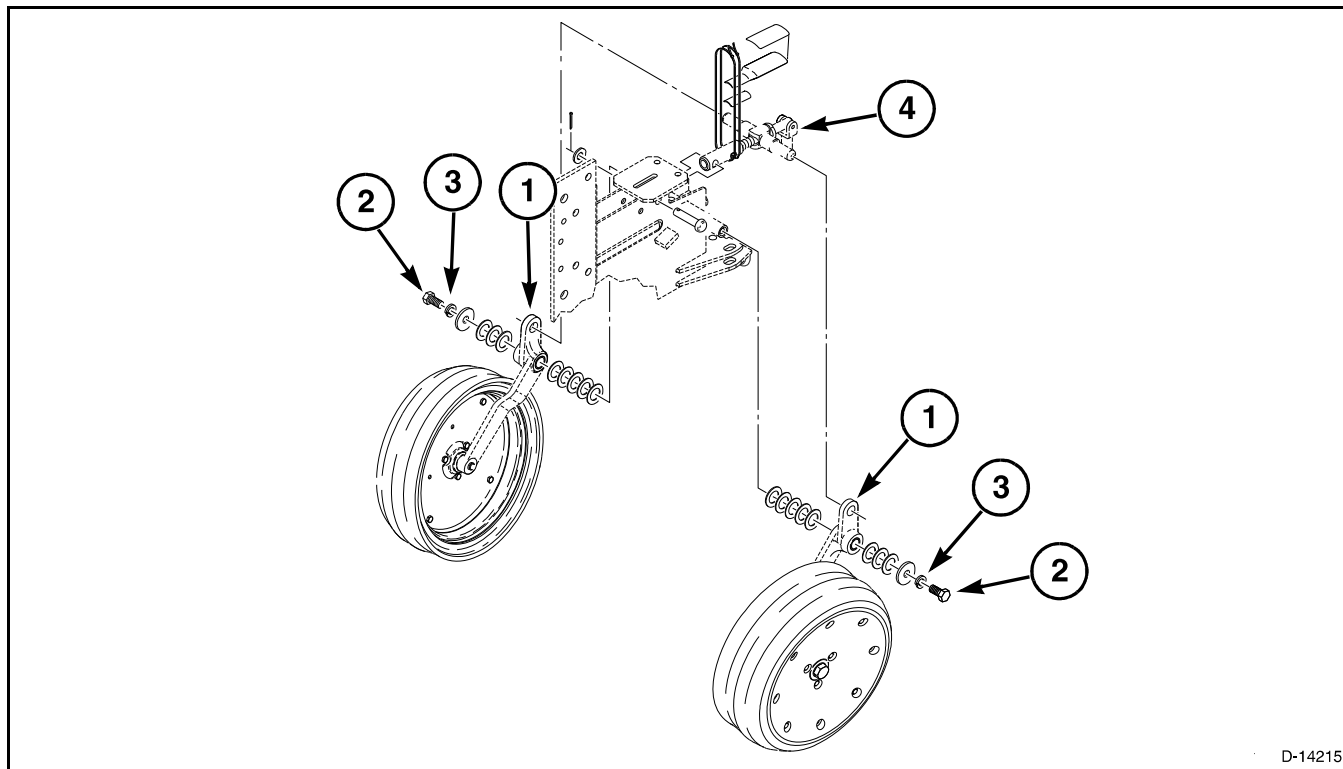

FIG. 2

Gauge Wheels

Gauge Wheel Mounting



D-14215

FIG. 3

FIG. 3: To remove arm assemblies (1), unscrew the cap screw (2) from the arm and wheel support.

Remove arm assembly. Remove the bushings and seal from the arm. Clean in solvent and replace if necessary.

To install the arm assembly, insert the bushings and seals into the arm. Position the seals with the open side facing out. Align the arm with the wheel mount and install washers as needed. Install lock washer (3) on to cap screw. Insert cap screw and tighten.

Make sure depth gauge (4) is installed into the arms.

Insert grease into grease fitting on arm.

FIG. 4: To remove gauge wheel from arm unscrew bolt (1) and remove gauge wheel.

To install gauge wheel place lock washer (2) in between arm and gauge wheel as a spacer.

Insert bolt and tighten to 200 to 260 Nm (147.5 to 191.8 lbf ft).

NOTE: The bolt on the arm on the left side is a left-handed bolt.

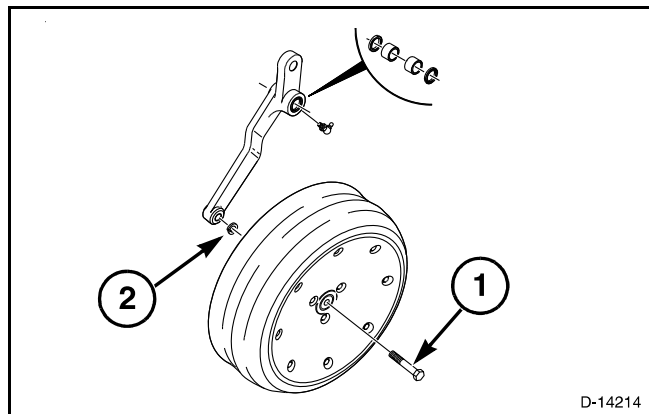

D-14214

FIG. 4