

Hydraulics

HEADER DRIVE MOTOR

General Information

The following procedures are the same for the left-hand and right-hand header drive motors for the double and single conditioner machines.

Components

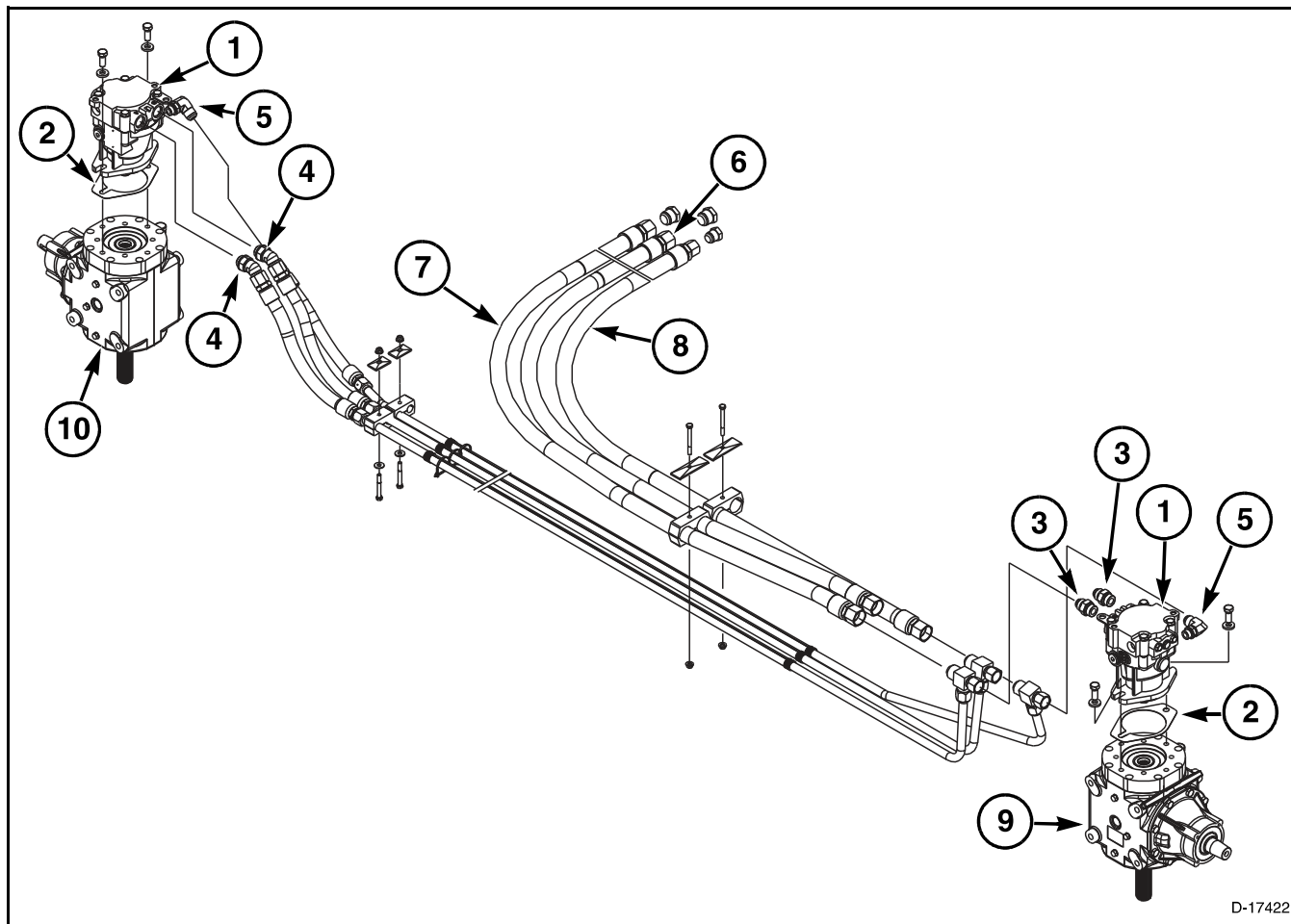

FIG. 2

FIG. 2: Disconnect the hoses from the machine and plug or cap the hoses or fittings. Fasten identification tags to all of the hydraulic hoses and lines.

- (1) Header Motor
- (2) Gasket
- (3) O-Ring Boss Straight Adapter
- (4) Elbow - 37 degree O-Ring Boss
- (5) Elbow - 90 O-Ring Boss
- (6) Return Hose
- (7) Pressure Line
- (8) Case Drain Hose
- (9) Gearbox - Left-Hand

(10) Gearbox - Right-Hand

NOTE: If the hoses are not connected to the correct ports at assembly, the header drive motor will rotate in the wrong direction and will lock up. The drive motors on a rotary header rotate in opposite directions. Make sure to fasten identification tags to the hoses and lines before removal.

FIG. 3: Right-hand motor

- (1) Port A - Right-Hand
- (2) Port B - Right-Hand

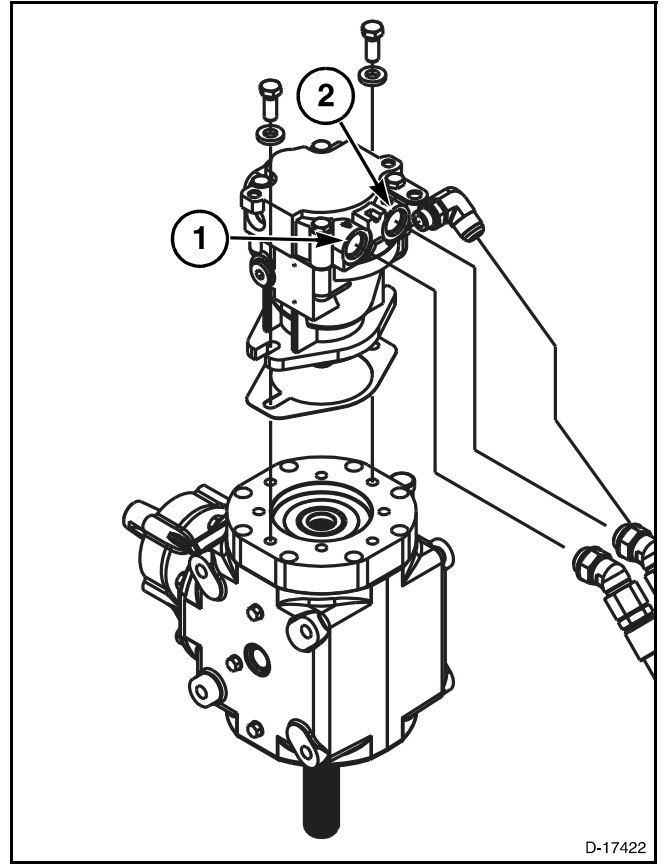

FIG. 3

FIG. 4: Left-hand motor

- (1) Port A - Left-Hand
- (2) Port B - Left-Hand

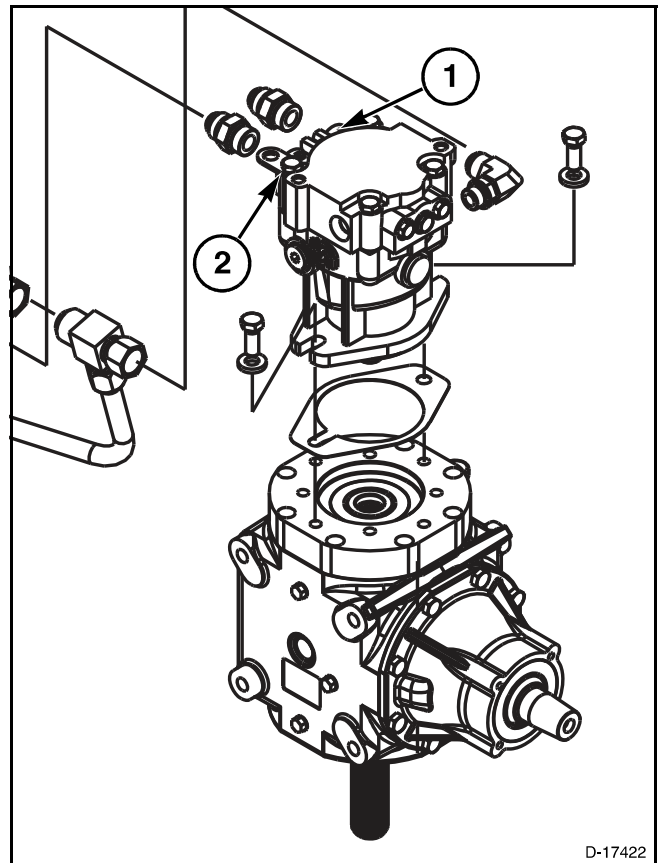

FIG. 4