

OPENERS

Disc Blade Replacement and Adjustment

General Information

FIG. 45: Replace disc blades (1) if worn to less than 36 cm (14 in) diameter.

As discs wear, keep openers adjusted so discs contact each other at outer edges.

Replacement - Discs

If replacement is required, remove the gauge wheel, remove each disc by removing hubcap and cap screw (2).

Install new opener discs onto frame. Check disc contact and add shims as required.

Tighten cap screw to 185 Nm (135 lbf ft).

Adjustments

To adjust, remove shim(s) between discs and row unit frame. Store extra shims under cap screw heads.

Maximum contact distance must be under 38 mm (1.5 inches) (A).

Adjust scrapers after opener discs are adjusted.

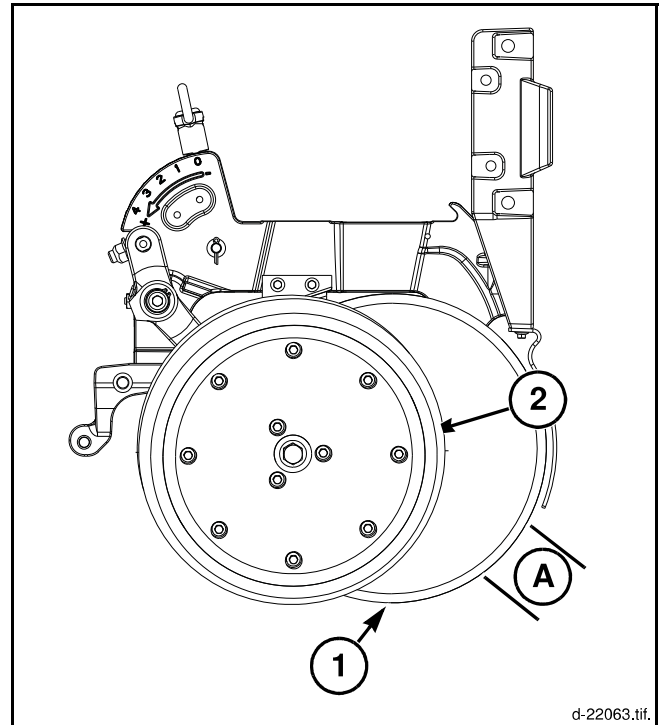

FIG. 45

Replacement - Bearings

FIG. 46: To check opener bearing condition, remove gauge wheels and scrapers. Rotate opener discs to check for bearing roughness and wear. If replacement is required, remove each disc by removing hubcap and cap screw (1).

NOTE: Cap screw on left-hand side has left-hand thread.

Install new opener discs onto frame. Check disc contact and add shims as required.

Tighten cap screw to 185 Nm (135 lbf ft).

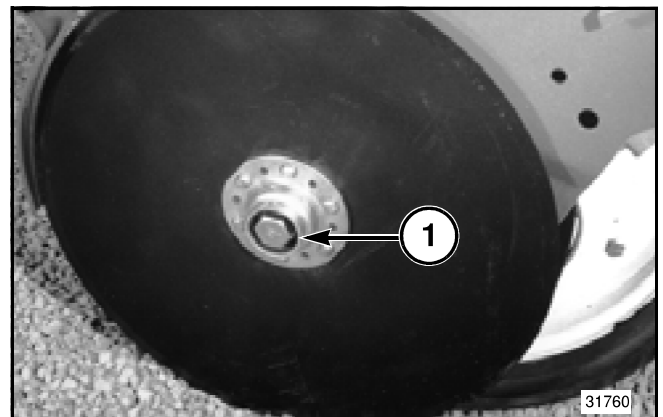

FIG. 46

Gauge Wheels

SCRAPER

FIG. 47: Some units are equipped with a flat scraper instead of the rotary scraper.

To remove scraper (1), remove the two bolts (2).

To install the scraper, insert the two bolts and finger tighten.

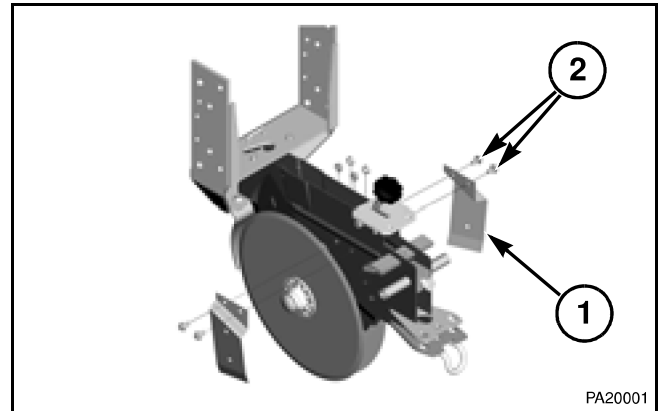

FIG. 47

FIG. 48: Align the flat scraper (1) to the edge of the bevel of the disc opener. Tighten the bolts.

Install the gauge wheel and arm assembly.

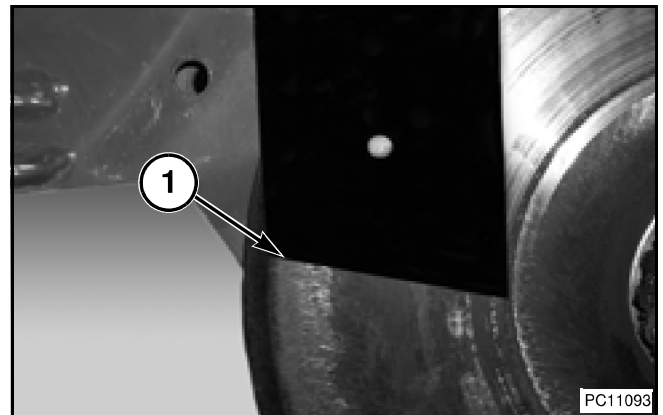

FIG. 48