

## 6.3 Augers

### 6.3.1 Augers general information

The pickup assembly has two augers that move the crop toward the center of the pickup into the opening of the charge chamber. Each auger is mounted on two bearings located at the outer end of the auger shaft. The drive sprocket is installed between the two bearings. The right-hand auger and the left-hand auger are not interchangeable. On optional cutter machine's, there is top auger to help feed the crop.

### 6.3.2 Left-hand auger components

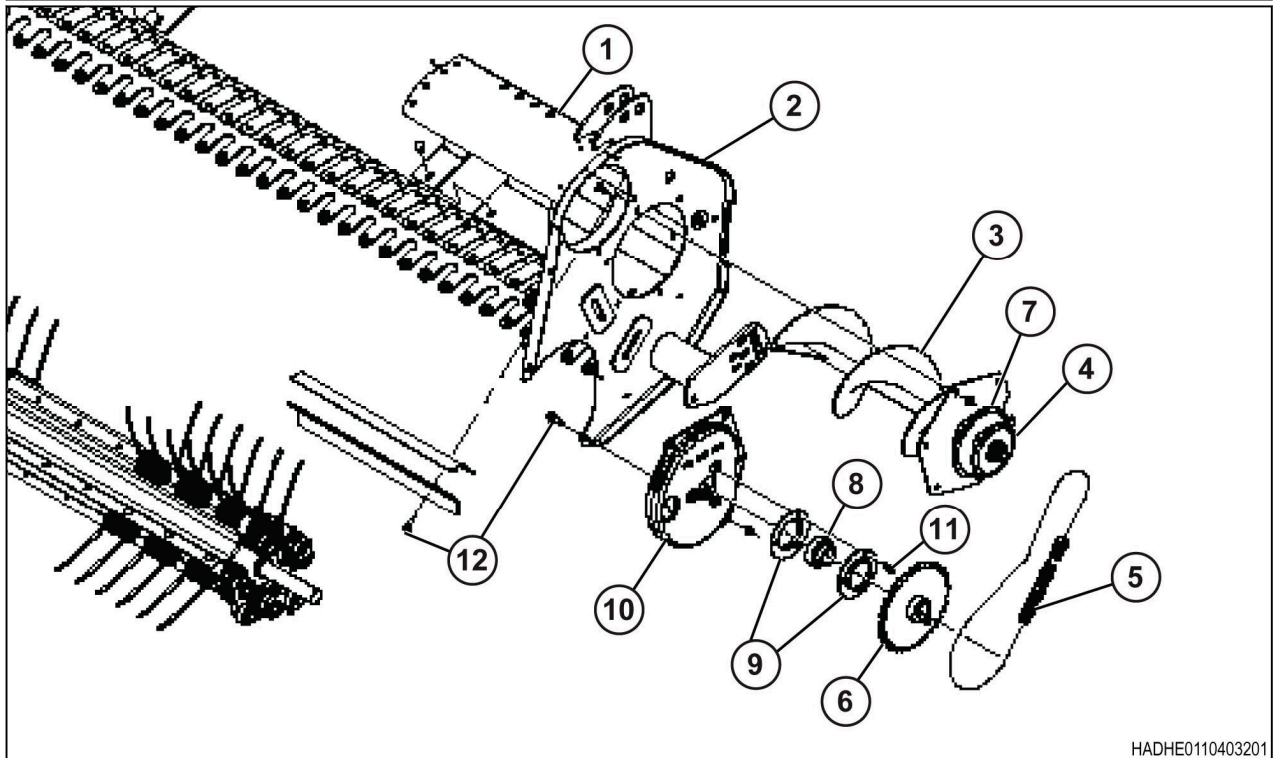

HADHE0110403201

Fig. 7

- |                        |                        |
|------------------------|------------------------|
| (1) Pickup assembly    | (7) Sprocket           |
| (2) Pickup shield      | (8) Spherical bearing  |
| (3) Auger assembly     | (9) Bearing flange     |
| (4) Idler sprocket     | (10) Camtrack          |
| (5) Pickup drive chain | (11) Hex machine screw |
| (6) Sprocket           | (12) Carriage bolt     |

### 6.3.3 Remove the primary drive sprocket and the top auger drive sprocket

#### Procedure

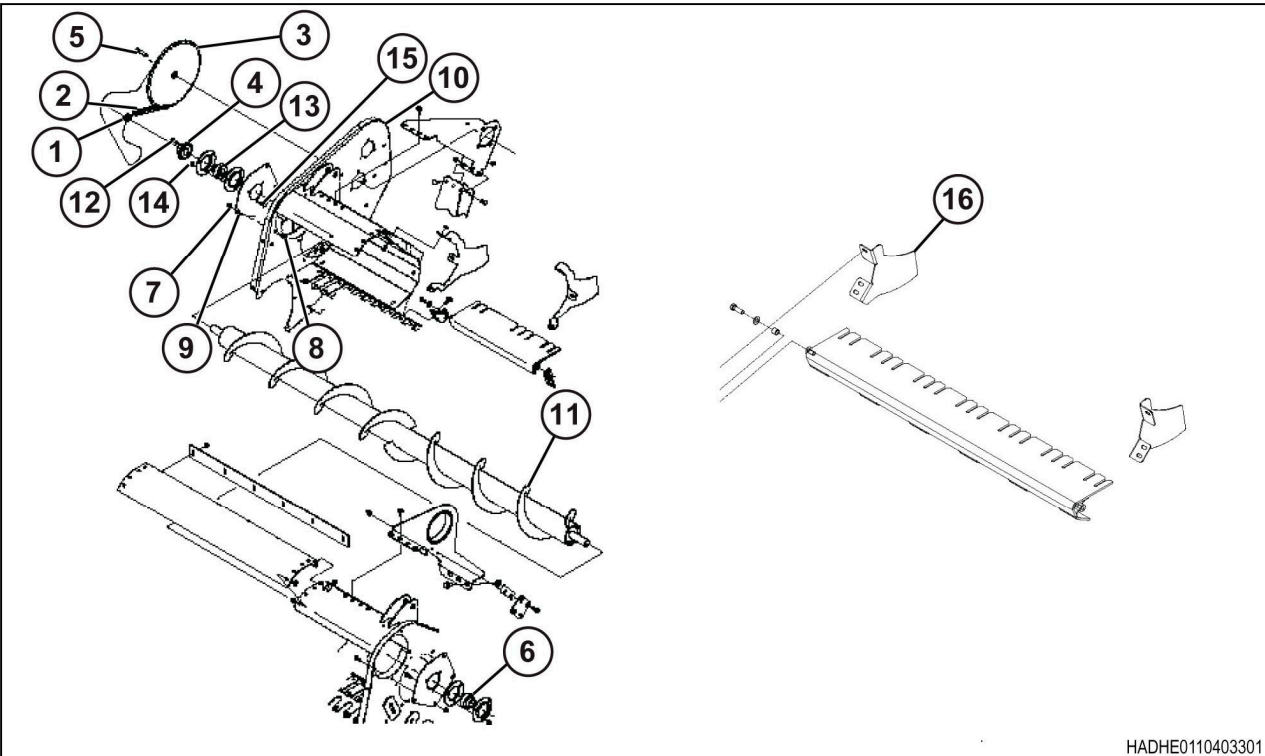

Fig. 8

1. Remove the connecting link (1) from the chain (2).
2. Remove the chain from the primary pickup drive sprocket (3) and the top auger sprocket (4).
3. Remove the gib key (5) that fastens the primary drive sprocket to the drive shaft.
4. Remove the primary drive sprocket.
5. Loosen the set screw on the lock collar of the left-hand bearing (6).
6. Remove the lock nuts (7) and the carriage bolts (8) that fasten the auger support plate (9) to the pickup (10).
7. Remove the top auger (11).
8. Remove the gib key (12) that fastens top auger drive sprocket to the top auger.
9. Remove the auger drive sprocket.
10. Loosen the set screw on the lock collar of the right-hand bearing (13).
11. Remove the lock nuts (14) and the carriage bolts (15) from the bearing flanges.
12. Remove the bearing flanges, the support plate, and the side chute (16).