

5.5.2 Disassemble the reel motor

Procedure

1. Use a wire brush to remove debris from around the outside joints of the motor.
2. Drain the oil from the motor.
3. Remove the key from the shaft.
4. Do a check of the shaft and the key slot. Remove all defects that can damage the housing seals while being installed.
5. Put the motor in a vise in the assembly process. Make sure the output shaft points to the ground.

NOTE: Make sure to use soft jaws or pieces of hard rubber or a board to protection of the motor in the clamp.

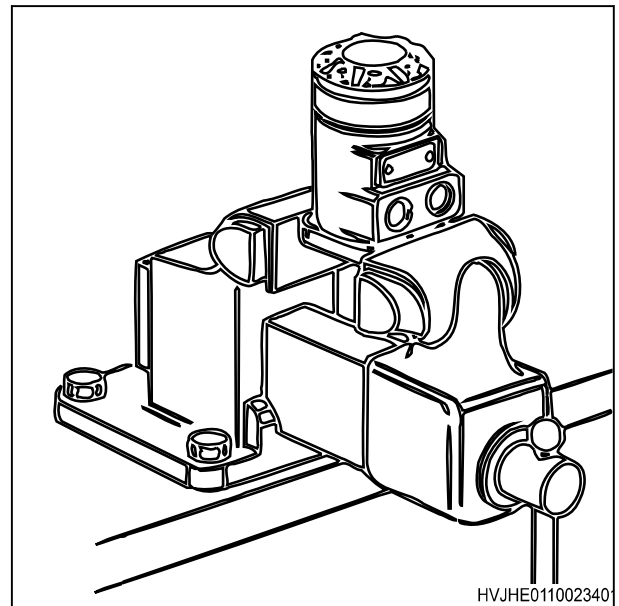

Fig. 42

6. Remove the cap screws (1) and the washers (2).
7. Remove the end cap (3).
8. Remove the O-ring seal (4) from the end cap and discard the O-ring.

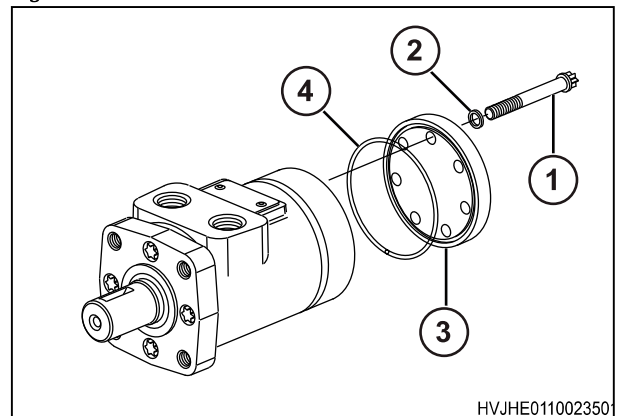

Fig. 43

9. Remove the rotor assembly (1).
10. Remove the O-ring seal (2) from the rotor assembly and discard the O-ring.

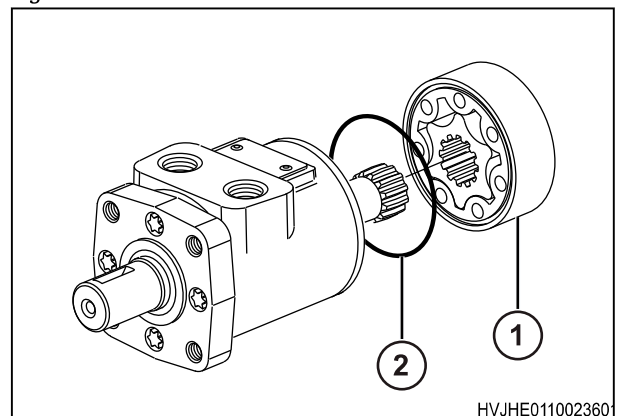
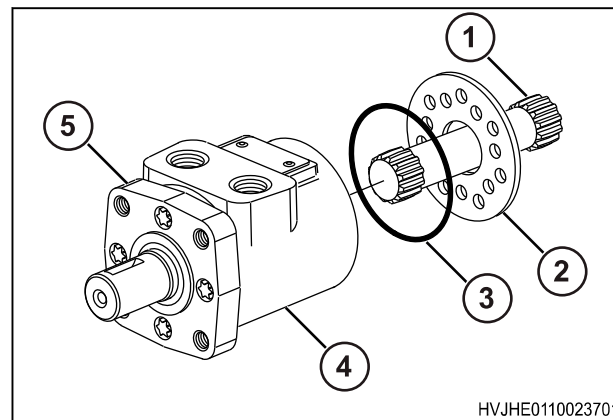

Fig. 44

11. Remove the drive (1).
12. Remove the spacer plate (2).
13. Remove the O-ring seal (3) from the housing (4) and discard the O-ring.
14. Remove the output shaft (5) through the back of the housing.
15. Remove the needle thrust bearing and the thrust race from the shaft of the housing. These items not shown.



HVJHE011002370

Fig. 45

16. Move the motor to a new position in the vise.
17. Clamp across the port.
18. Do not apply too much pressure as this will cause damage to the housing.

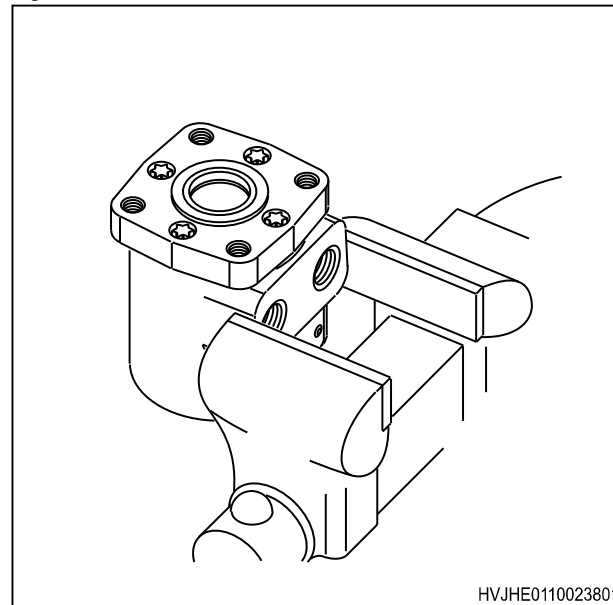

HVJHE011002380

Fig. 46

19. Remove the screws (1) from the flange (2).

NOTE: The screws are held with high strength threadlocker. They can require heat to remove.

20. To break the screws loose it is necessary to use 35 Nm to 45 Nm (25 lbf ft to 33 lbf ft) of torque.
21. 11 Nm (100 lbf in) of torque is necessary to remove them.
22. Do not use an impact wrench on the screws.
23. If heat is necessary, use a small propane torch to heat a small area of the housing where the screw enters.
24. Do not overheat the housing. Only heat for 8 seconds to 10 seconds. Remove heat once the screw is loose.
25. Carefully remove the flange from the housing.

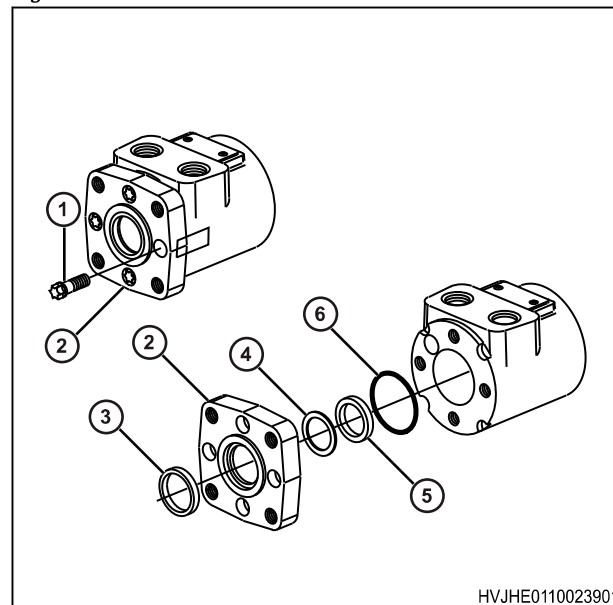

HVJHE011002390

Fig. 47