

Fig. 1: Identifying Oil Check Valve And Spray Nozzle Valve Overview
 Courtesy of AUDI OF AMERICA, LLC

1. O-ring
 - Replace
2. Spray Nozzle Valve
 - Removing and installing, refer to **OIL CHECK VALVE AND SPRAY NOZZLE VALVE**
3. Gasket
 - Replace
4. Cover
5. O-ring

2012 Audi S5 3.0T

ENGINE 4.2 Liter - Lubrication - Engine Code(s): CAUA (Coupe)

- Replace
- 6. Hose
 - For crankcase ventilation
- 7. Bolt
 - 9 Nm
- 8. Oil Return Line
- 9. Bolt
 - 9 Nm
- 10. Oil Check Valve
 - Removing and installing, refer to **OIL CHECK VALVE AND SPRAY NOZZLE VALVE**
- 11. O-ring
 - Replace

OIL FILTER HOUSING OVERVIEW

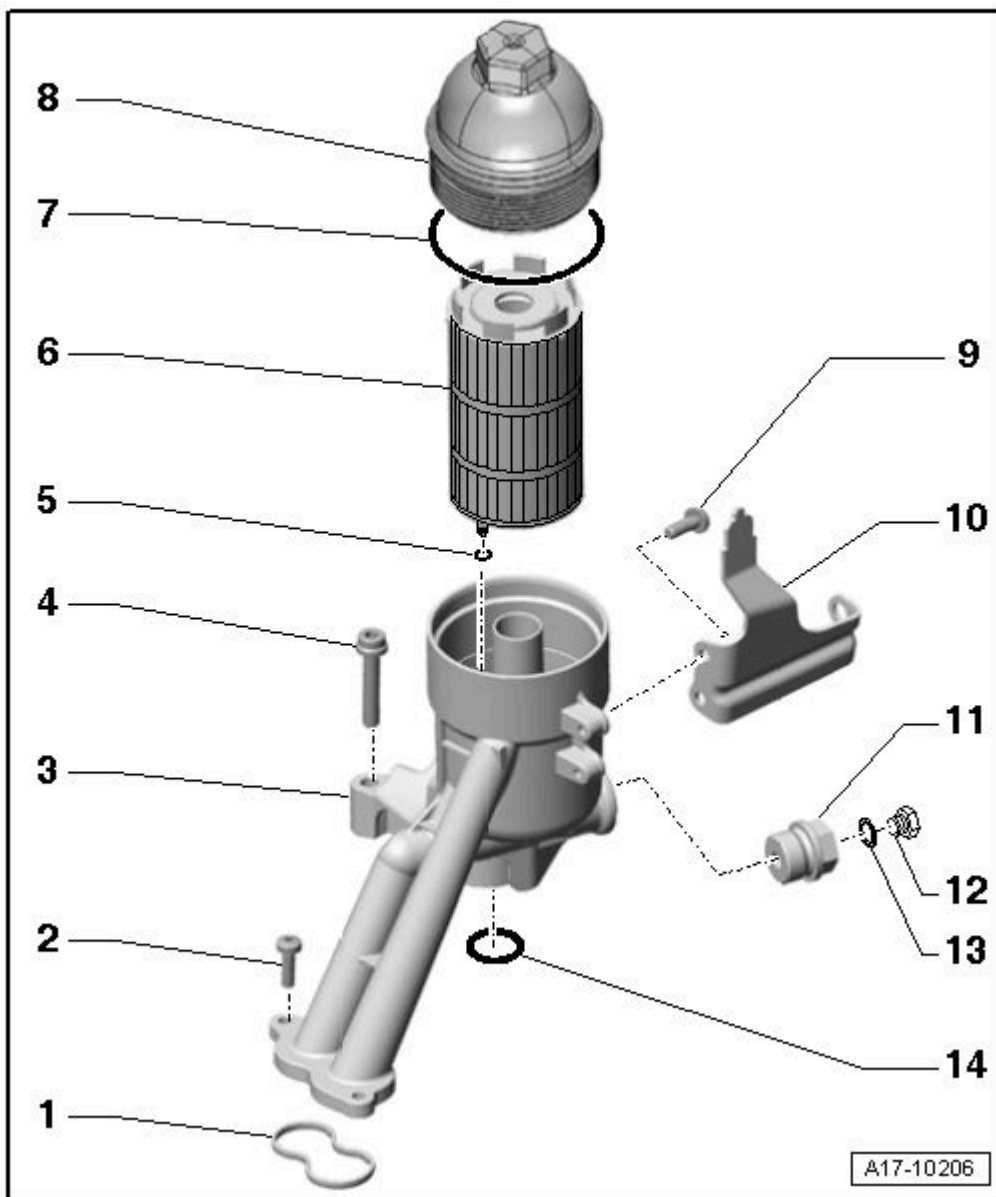

Fig. 2: Oil Filter Housing, Component Overview
 Courtesy of AUDI OF AMERICA, LLC

1. Gasket
 - Replace
2. Bolt
 - 9 Nm
3. Oil Filter Housing
 - With oil filter bypass valve 1.3 bar
4. Bolt
 - 22 Nm

5. O-ring
 - Oil filter element component
6. Oil Filter Element
 - Removing and installing.
7. O-ring
 - Replace
8. Cap
 - 25 Nm
9. Bolt
 - 9 Nm
10. Bracket
 - For Evaporative Emission (EVAP) canister purge regulator valve -N80-
11. Drain Plug
 - 50 Nm
12. Drain Plug
 - 9 Nm
13. Seal
 - Replace
14. O-ring
 - Replace

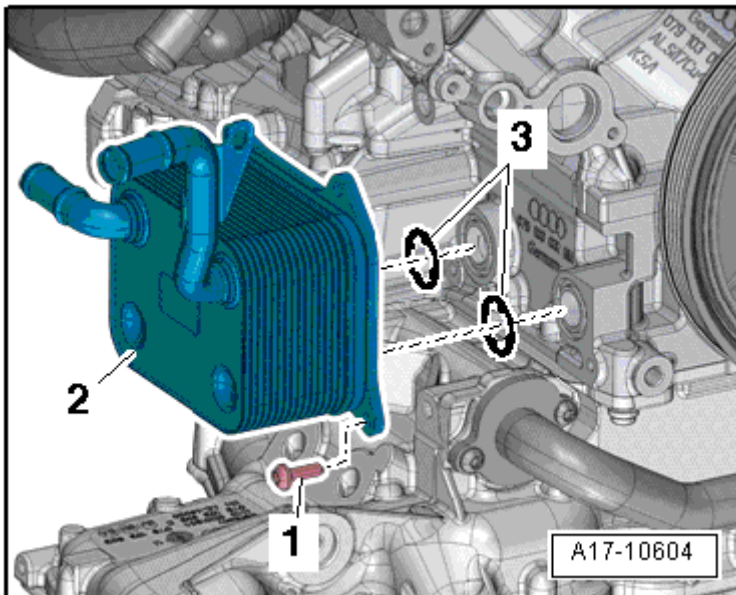

Fig. 3: Oil Cooler Tightening Specifications & Sequence
Courtesy of AUDI OF AMERICA, LLC

2012 Audi S5 3.0T

ENGINE 4.2 Liter - Lubrication - Engine Code(s): CAUA (Coupe)

NOTE: Replace the gaskets -3- for the oil cooler -2-.

-- Tighten bolts in 2 stages as follows:

Stage	Bolts	Tightening Specifications
1.	-1-	3 Nm
2.	-1-	9 Nm

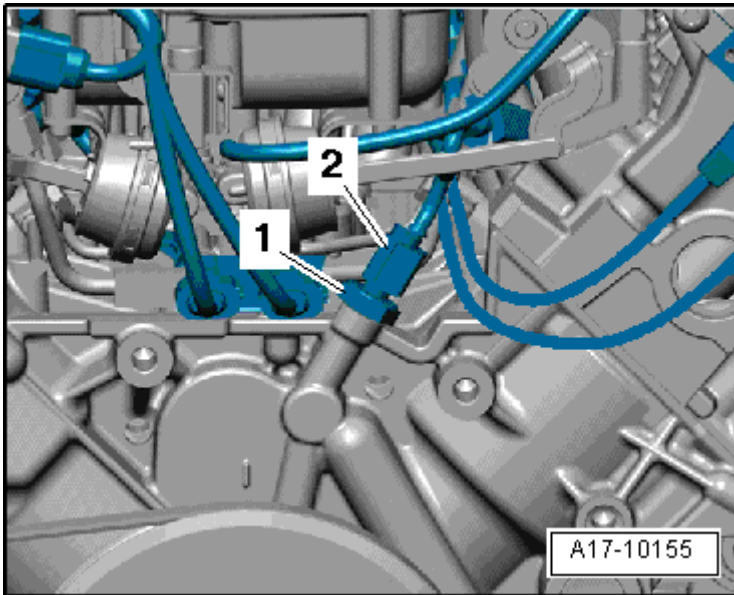

Fig. 4: Disconnecting Electrical Harness Connector From Oil Pressure Switch F1 & Oil Pressure Switch
Courtesy of AUDI OF AMERICA, LLC

-- Replace seal.

-- Tighten the oil pressure switch -1- to 20 Nm.

OIL PUMP AND LOWER OIL PAN OVERVIEW

CAUTION: Danger of catalytic converter damage.

- The oil level must not exceed the "MAX" marking.

NOTE: If large quantities of metal particles or abraded material are detected during engine repairs, it may mean the crankshaft or rod bearings are damaged. To prevent subsequent damage, the following work must be performed after the repair: Oil channels must be cleaned carefully; replace oil spray jets, engine oil cooler and oil filter.

Oil capacities, specifications and viscosity classes.

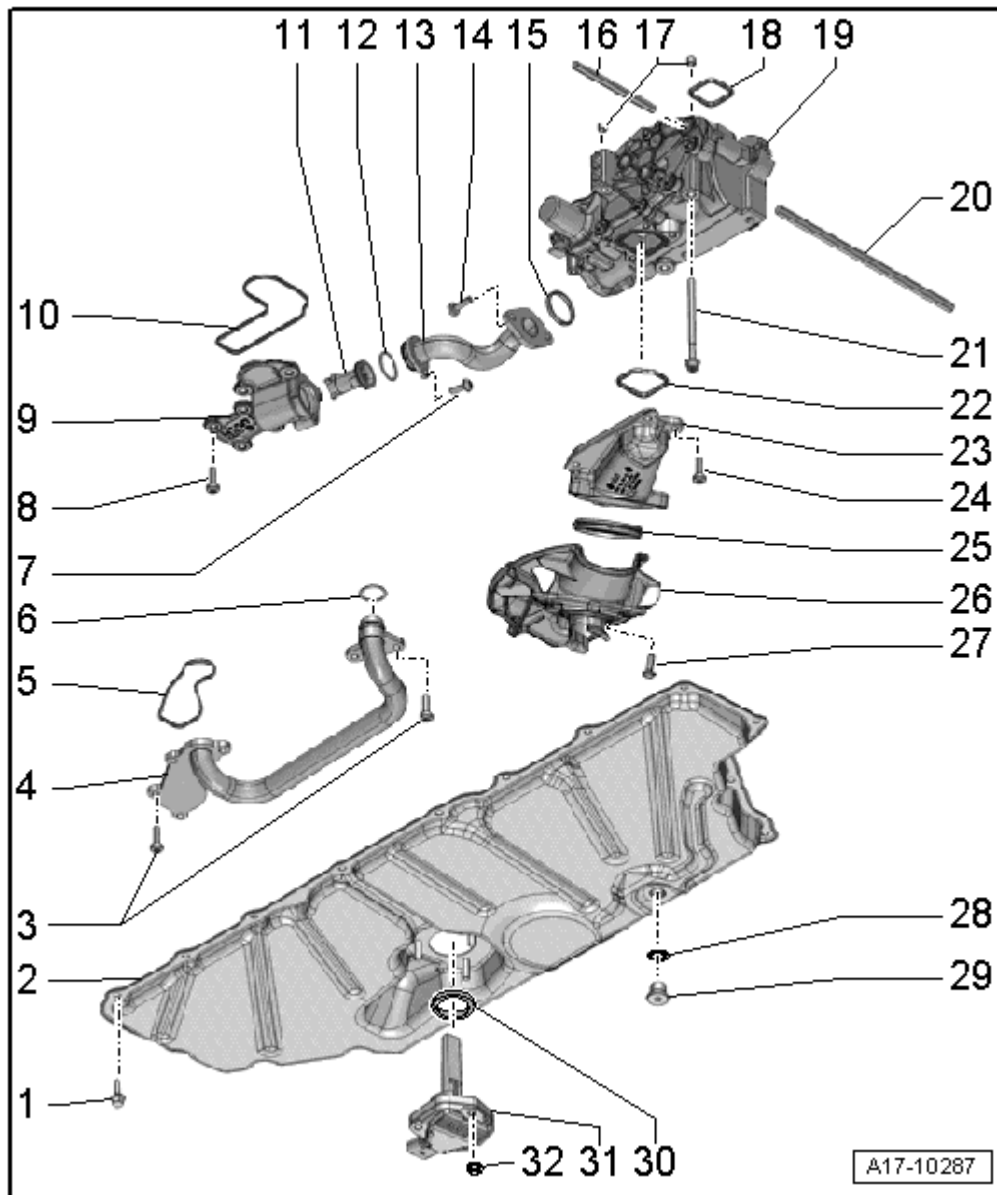

Fig. 5: Identifying Oil Pump And Lower Oil Pan Overview
 Courtesy of AUDI OF AMERICA, LLC

1. Bolt
 - Tightening specification and sequence, refer to **Fig. 6**
2. Lower Oil Pan
 - Removing and installing, refer to **LOWER OIL PAN**
3. Bolts
 - 9 Nm
4. Oil Pipe
 - Removing and installing, refer to **OIL PUMP, THROUGH VIN CAU 003 685** or **OIL PUMP,**