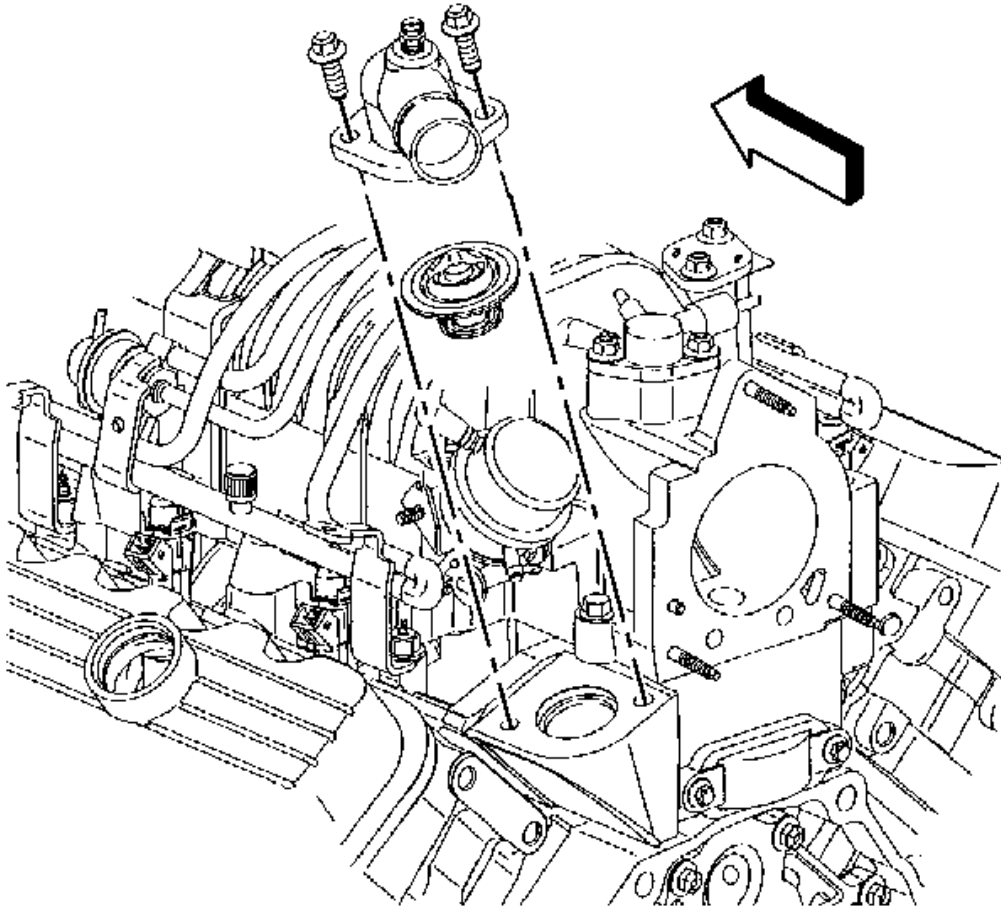


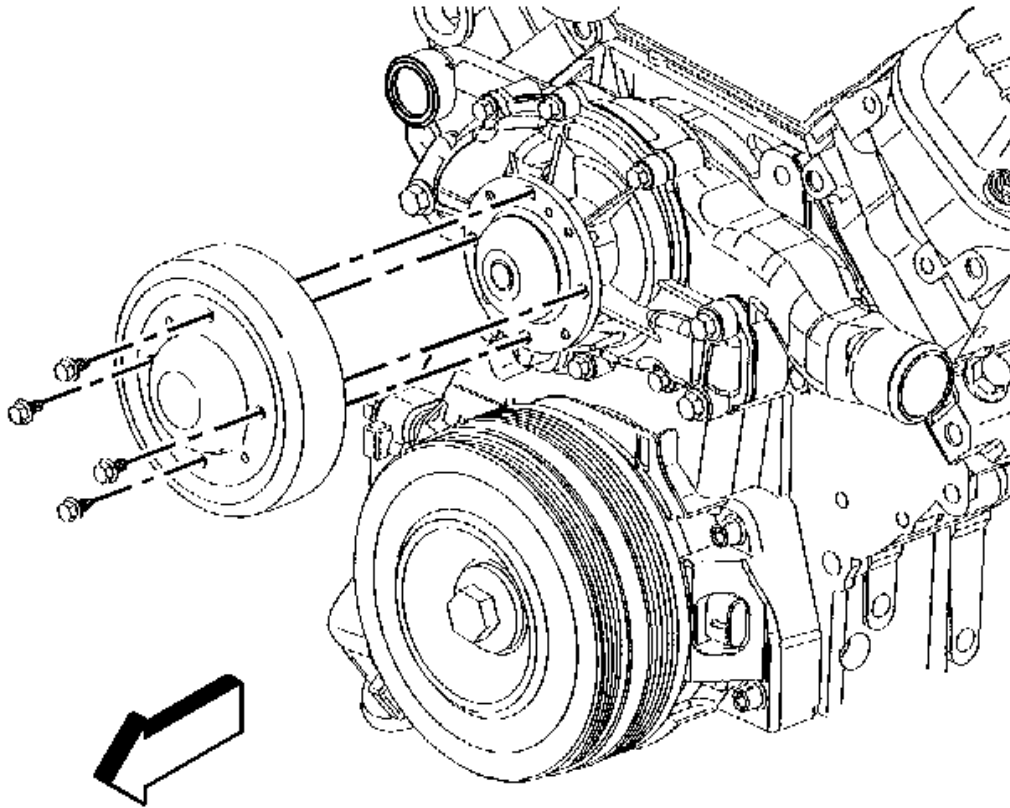
**Water Outlet and Thermostat Removal (L67)**



**Fig. 207: Removing/Installing Water Outlet & Thermostat (L67)**  
Courtesy of GENERAL MOTORS CORP.

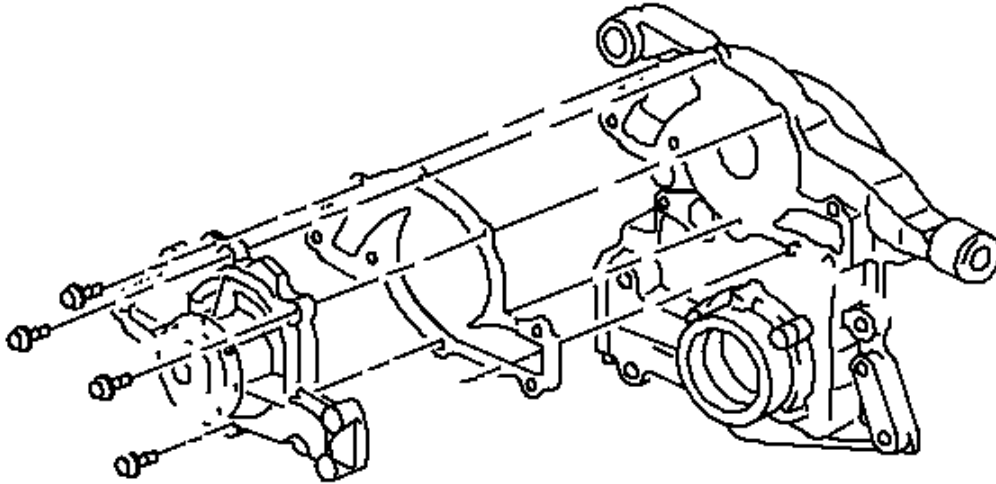
1. Remove the water outlet bolts.
2. Remove the water outlet.
3. Remove the thermostat.

**Water Pump Removal**



**Fig. 208: Removing/Installing Water Pump Pulley**  
Courtesy of GENERAL MOTORS CORP.

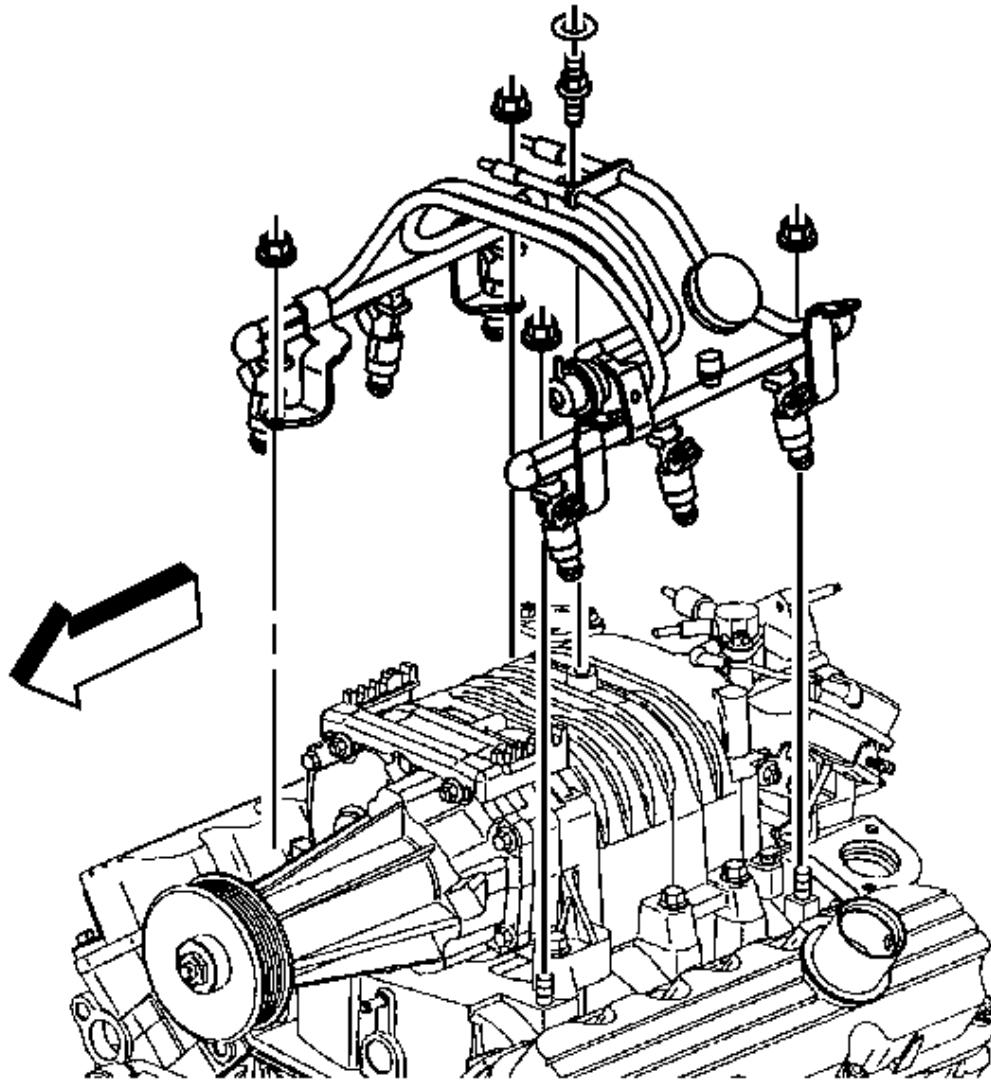
1. Remove the water pump pulley bolts.
2. Remove the water pump pulley.



**Fig. 209: Removing Water Pump Bolts & Water Pump**  
Courtesy of GENERAL MOTORS CORP.

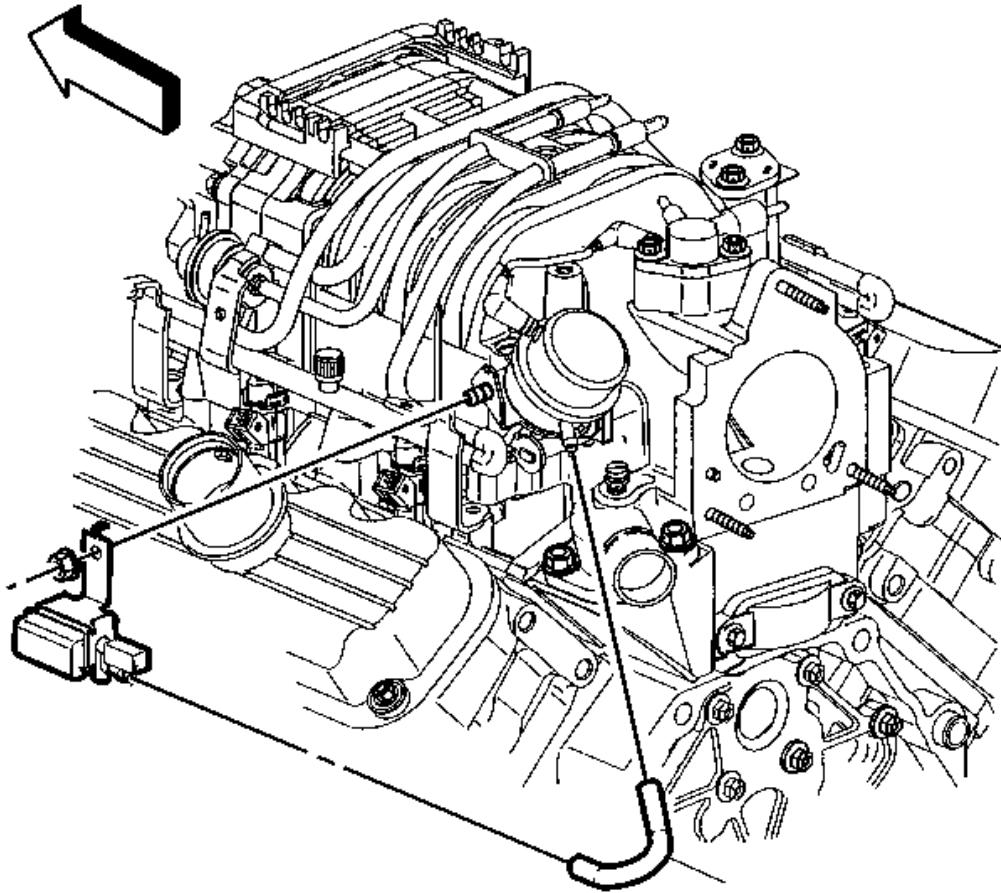
3. Remove the water pump bolts.
4. Remove the water pump.
5. Remove the water pump gasket.

#### **Supercharger Removal**



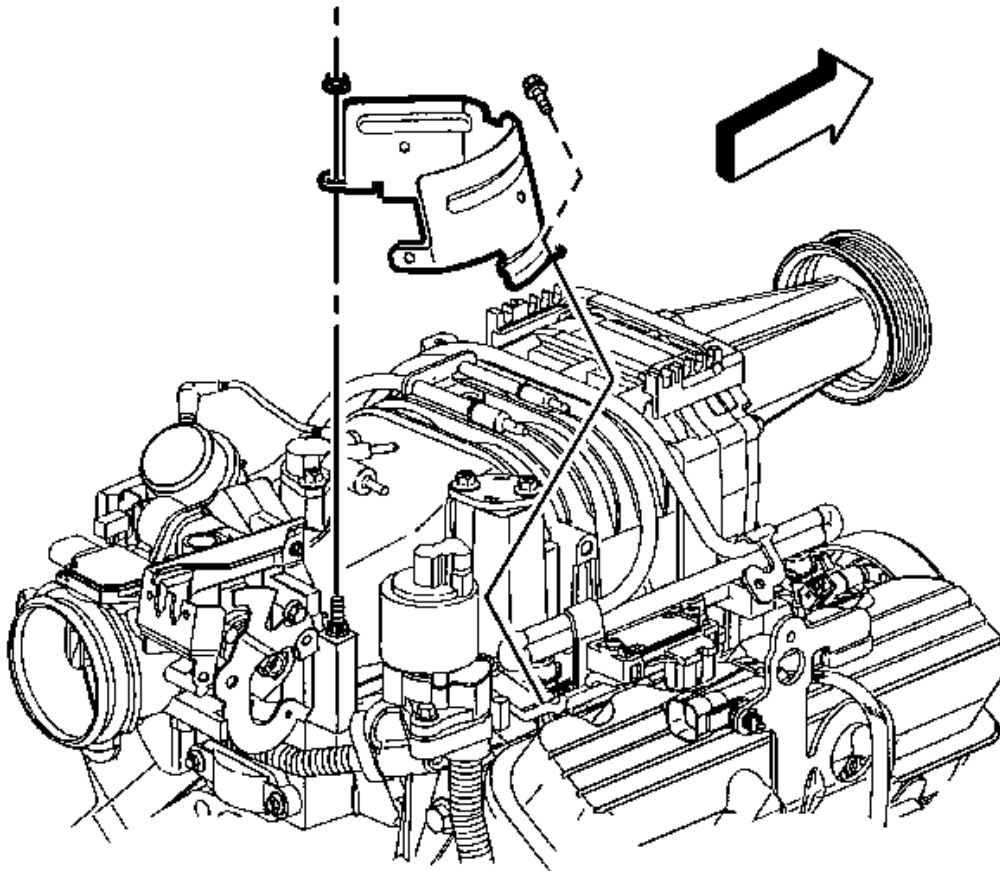
**Fig. 210: Removing/Installing Fuel Rail**  
Courtesy of GENERAL MOTORS CORP.

1. Remove the spark plug wires.
2. Remove the vacuum line from the fuel injector rail.
3. Remove the fuel injector rail nuts and stud.
4. Remove the fuel injector rail.



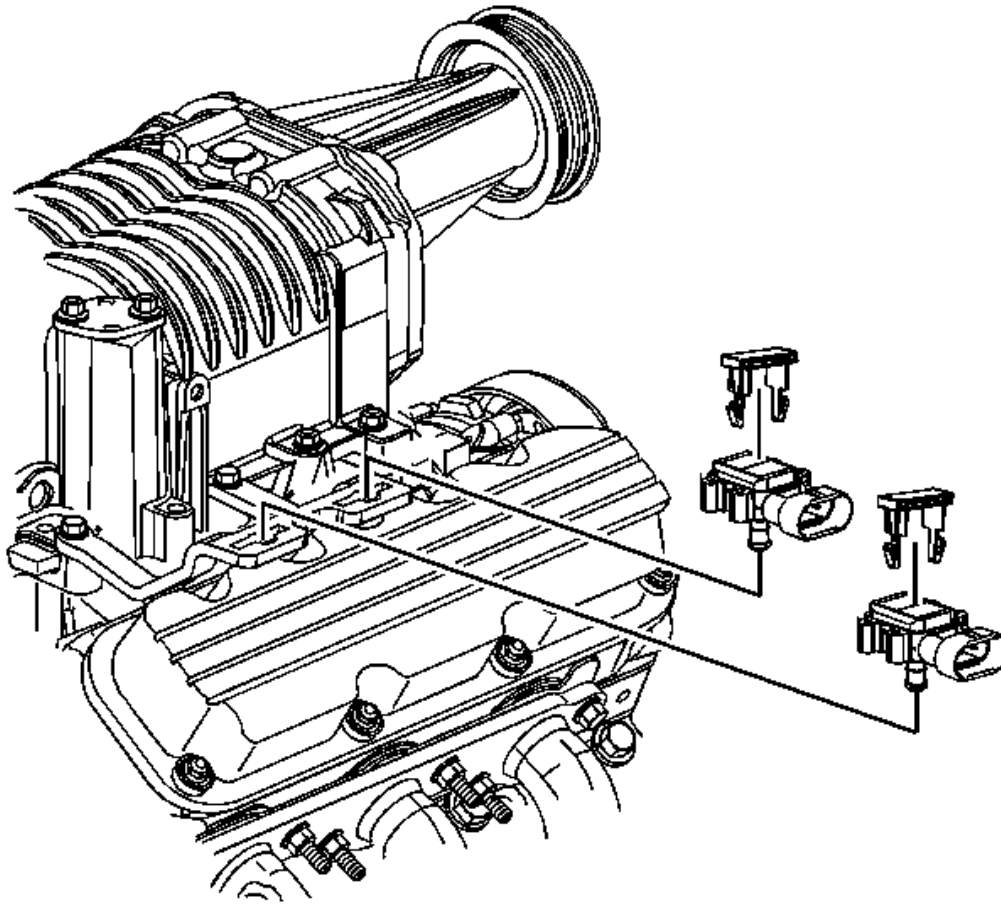
**Fig. 211: Installing Regulator Valve & Harness Bolt**  
Courtesy of GENERAL MOTORS CORP.

5. Remove the booster bypass nut and hose.
6. Remove the booster bypass.
7. Remove the regulator valve and the harness bolt.
8. Remove the boost solenoid bolts and hose.
9. Remove the bolts from the vacuum block.



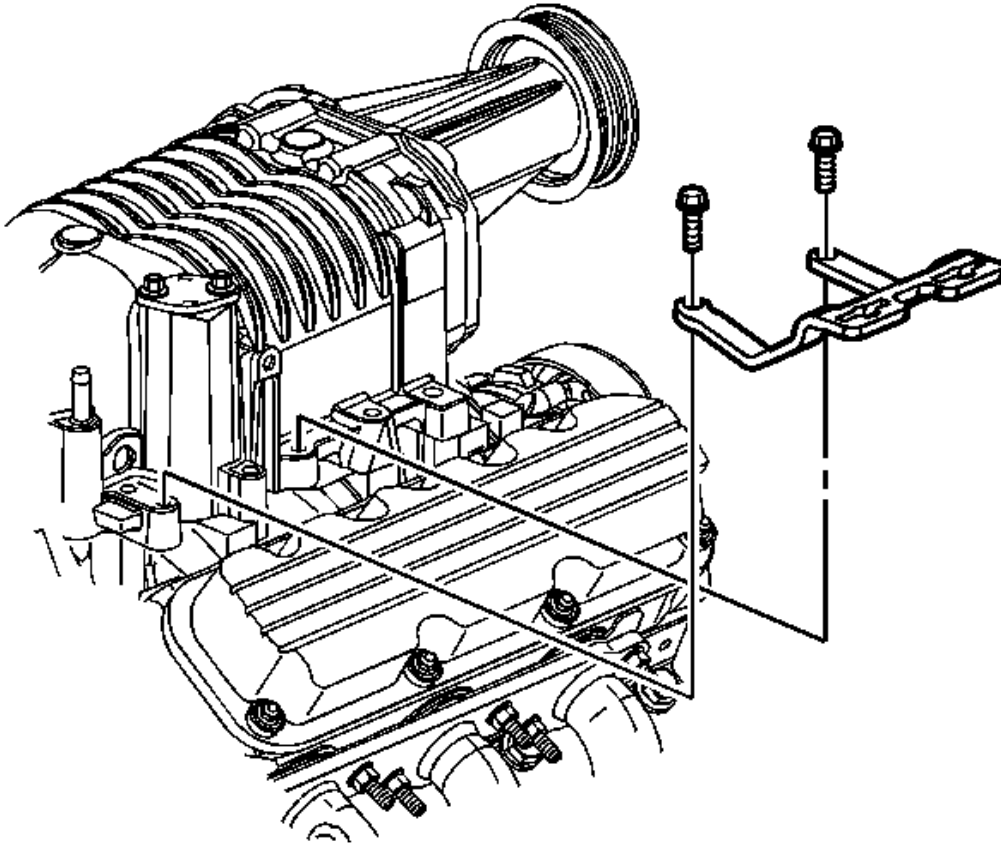
**Fig. 212: Removing/Installing Engine Wiring Harness Heat Shield**  
Courtesy of GENERAL MOTORS CORP.

10. Remove the engine wiring harness heat shield bolt and nut.
11. Remove the engine wiring harness heat shield.



**Fig. 213: Removing/Installing MAP & BARO Sensors Retaining Clips**  
Courtesy of GENERAL MOTORS CORP.

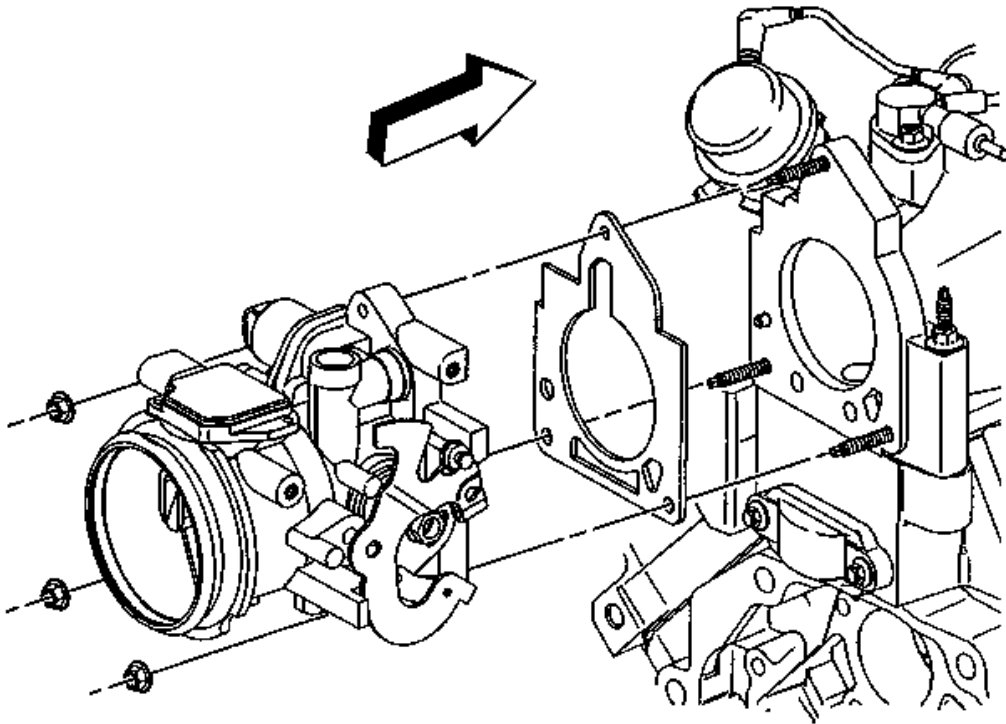
12. Remove the manifold absolute pressure (MAP) and barometric pressure (BARO) sensor retaining clips.
13. Remove the MAP and BARO sensors.



**Fig. 214: Removing/Installing MAP/BARO Sensor Bracket**  
Courtesy of GENERAL MOTORS CORP.

14. Remove the MAP/BARO sensor bracket bolts and bracket.

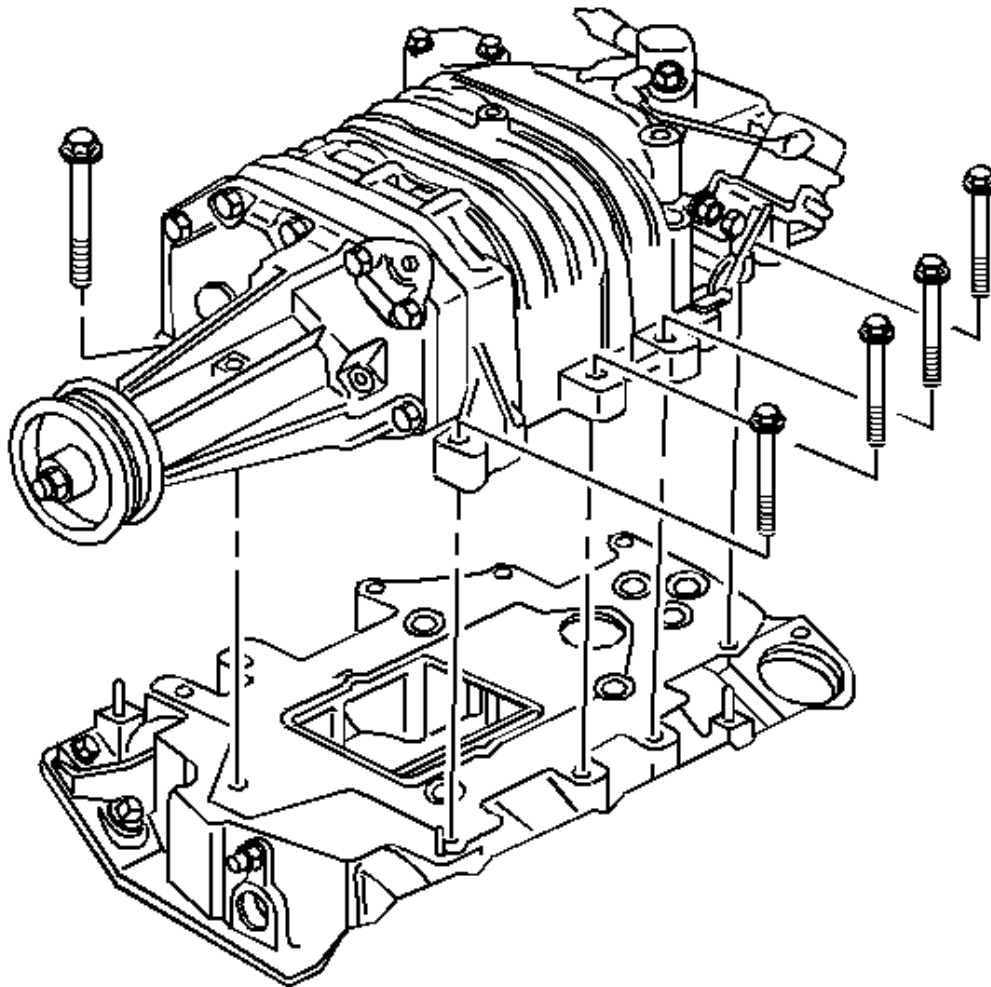




**Fig. 215: Removing/Installing Throttle Body**  
Courtesy of GENERAL MOTORS CORP.

**IMPORTANT:** Note the location of the spacers and the bolt sizes to aid in installation.

15. Remove the throttle body nuts.
16. Remove the throttle body and gasket.



**Fig. 216: Removing/Installing Supercharger**  
Courtesy of GENERAL MOTORS CORP.

17. Remove the bolts, spacers, and the stud from the supercharger.
18. Remove the supercharger.