

Fig. 24: View Of Left Side Lift Hook Assembly
Courtesy of GENERAL MOTORS CORP.

11. Install the left side lift hook assembly to the left side hole in the **J 45057** (2). See **Special Tools**.
12. Gently tighten the **J 28467-34** lift hook wing nuts. See **Special Tools**.
13. Raise the vehicle. Refer to **Lifting and Jacking the Vehicle**.
14. Remove the lower air baffle. Refer to **Radiator Air Baffle Assemblies and Deflectors**.
15. Install one end of a suitable utility strap to the transaxle.
 - If the vehicle is equipped with All Wheel Drive (AWD), carefully wrap the utility strap around the transfer case.
 - If the vehicle is equipped with Front Wheel Drive (FWD), carefully wrap the utility strap around the transaxle case extension housing.
16. Install the opposite end of the utility strap to a suitable underbody structure.
17. Tighten the utility strap in order to prevent movement of the powertrain.

Engine Mount Inspection

IMPORTANT: Before replacing any engine mount due to suspected fluid loss, verify that the source of the fluid is the engine mount, not the engine or accessories.

1. Install the engine support fixture. Refer to **Engine Support Fixture**.
2. Observe the engine mount while raising the engine. Raising the engine removes the weight from the engine mount and creates slight tension on the rubber.
3. Replace the engine mount if the engine mount exhibits any of the following conditions:
 - The hard rubber is covered with heat check cracks.
 - The rubber is separated from the metal plate of the engine mount.
 - The rubber is split through the center of the engine mount.
 - The engine mount itself is leaking fluid.
4. For engine mount replacement. Refer to **Engine Mount Replacement - Right Side**.

Engine Mount Replacement - Right Side

Removal Procedure

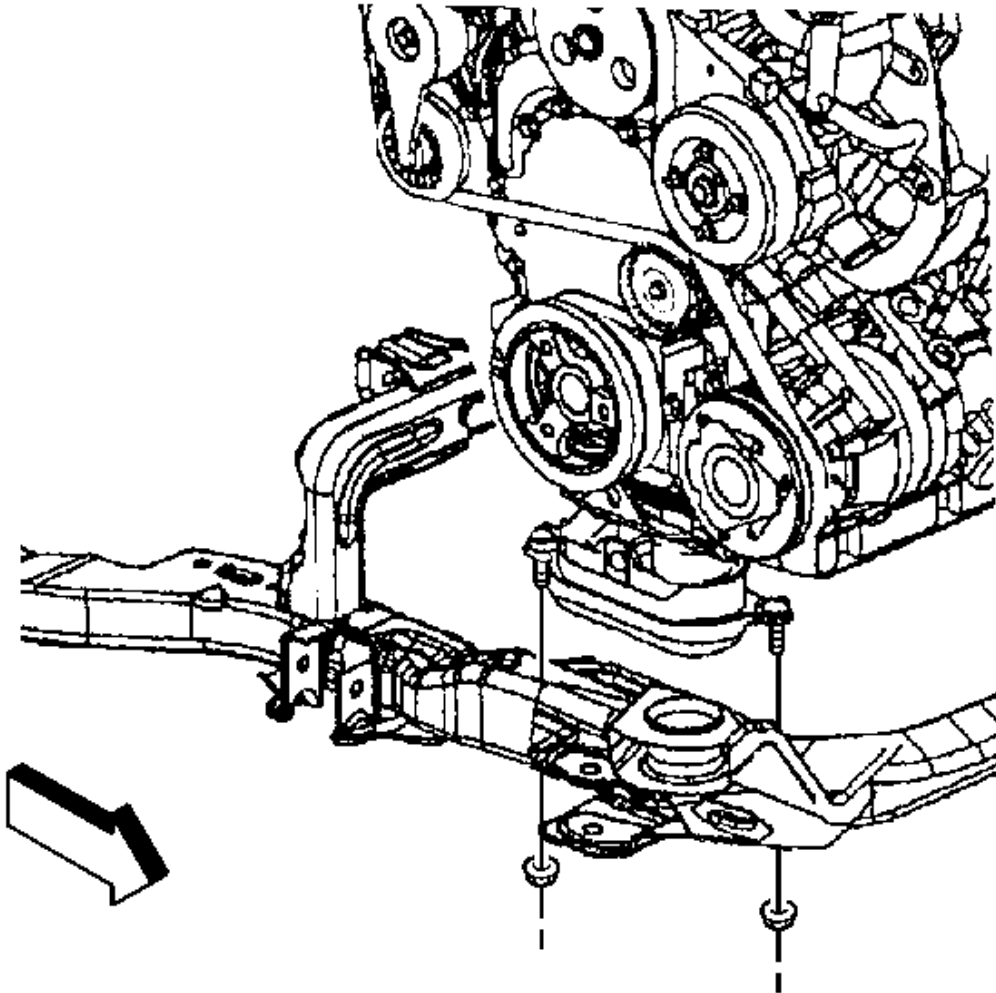

Fig. 25: Right Engine Mount
Courtesy of GENERAL MOTORS CORP.

1. Remove the air cleaner outlet duct. Refer to [Air Cleaner Outlet Duct Replacement](#) .
2. Remove the engine mount struts. Refer to [Engine Mount Strut Replacement - Left Side](#) and [Engine Mount Strut Replacement - Right Side](#).
3. Remove the catalytic converter. Refer to [Catalytic Converter Replacement](#) .
4. Remove the right front wheel and tire. Refer to [Tire and Wheel Removal and Installation](#) .
5. Remove the right engine splash shield. Refer to [Splash Shield Replacement - Engine](#) .
6. Remove the engine mount lower nuts.

NOTE: In order to avoid oil pan damage and possible engine failure, insert a block of wood that spans the width of the oil pan bottom between the oil pan and the jack support.

7. Place an adjustable jack stand and a block of wood under the engine.

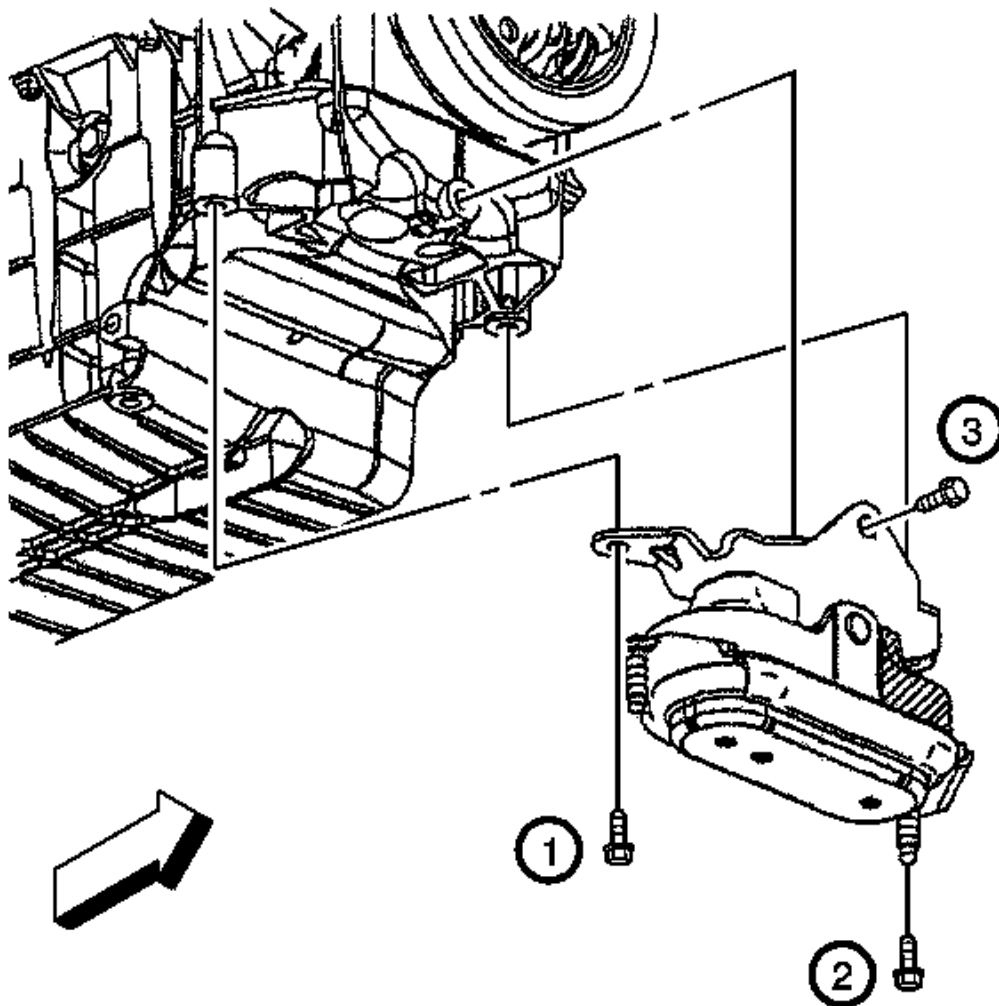

Fig. 26: Engine Mount Bracket Bolts (FWD)
Courtesy of GENERAL MOTORS CORP.

8. Remove the engine mount bracket bolts, if equipped with front wheel drive (FWD).

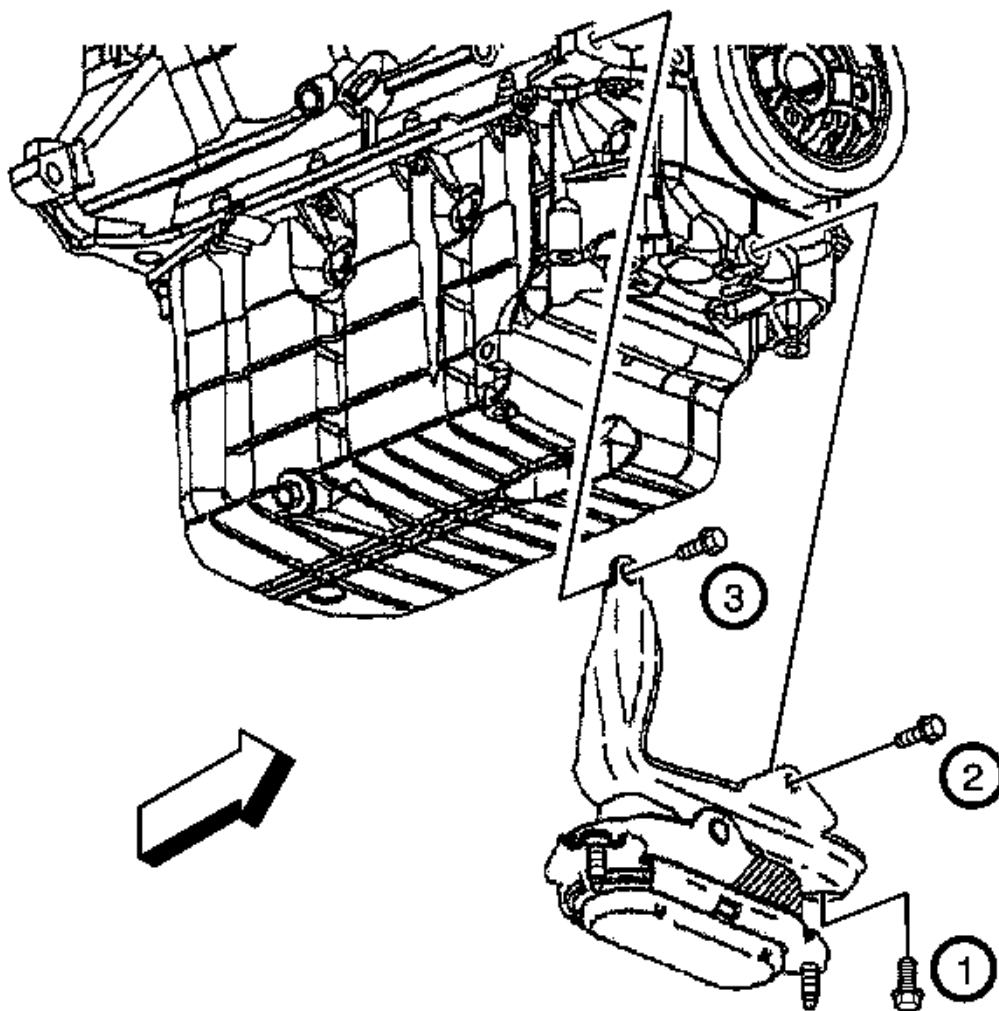

Fig. 27: Engine Mount Bracket Bolts (AWD)
Courtesy of GENERAL MOTORS CORP.

9. Remove the engine mount bracket bolts, if equipped with all wheel drive (AWD).
10. Using the adjustable jack and block of wood, raise the engine until the engine mount/bracket can be removed.
11. Remove the engine mount/bracket.

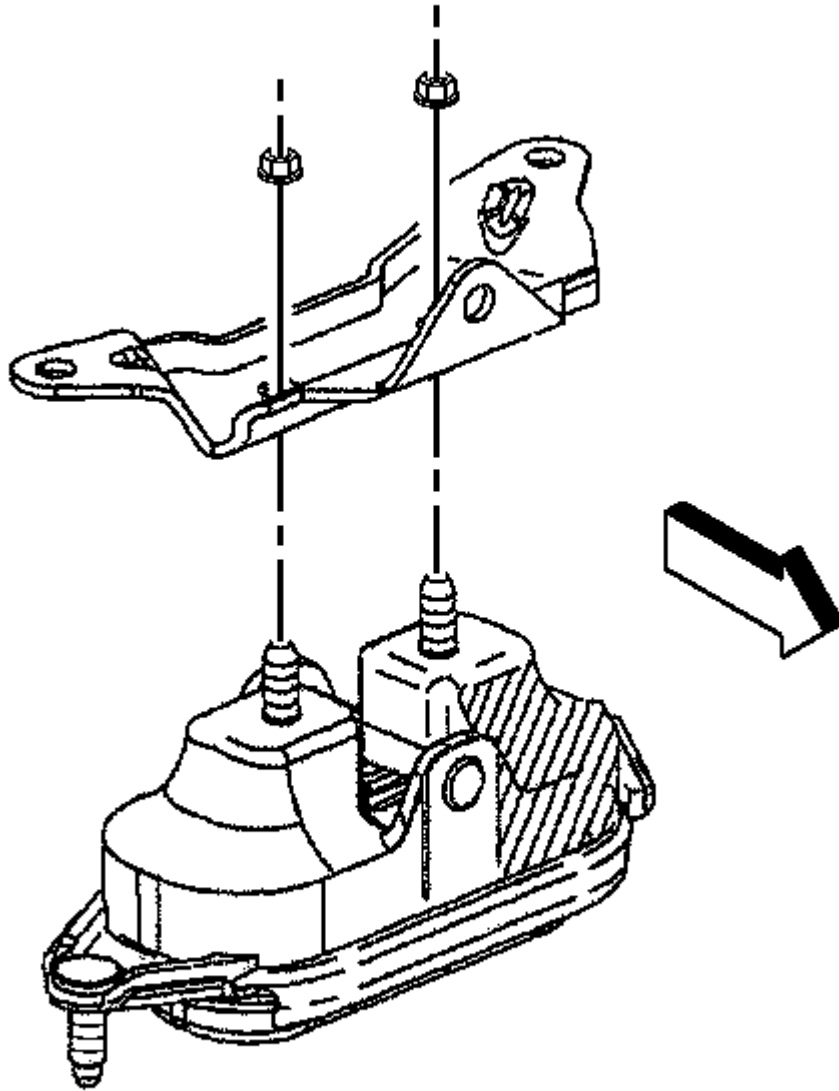

Fig. 28: Engine Mount Bracket (FWD)
Courtesy of GENERAL MOTORS CORP.

12. Remove the engine mount bracket nuts, if equipped with FWD.
13. Remove the engine mount bracket.