

Fig. 21: View Of Left Side Lift Hook Assembly
Courtesy of GENERAL MOTORS CORP.

11. Install the left side lift hook assembly to the left side hole in the **J-41803-9** (2).
12. Gently tighten the **J 28467-34** lift hook wing nuts.
13. Raise and support the vehicle. Refer to **Lifting and Jacking the Vehicle** .
14. Remove the lower air baffle. Refer to **Radiator Air Baffle Assemblies and Deflectors** .
15. Install one end of a suitable utility strap to the transaxle.
 - If the vehicle is equipped with all wheel drive (AWD), carefully wrap the utility strap around the transfer case.
 - If the vehicle is equipped with front wheel drive (FWD), carefully wrap the utility strap around the transaxle case extension housing.
16. Install the opposite end of the utility strap to a suitable underbody structure.
17. Tighten the utility strap in order to prevent movement of the powertrain.

ENGINE MOUNT INSPECTION

IMPORTANT: Before replacing any engine mount due to suspected fluid loss, verify that the source of the fluid is the engine mount, and not the engine or accessories.

1. Install the engine support fixture. Refer to **Engine Support Fixture**.
2. Observe the engine mount while raising the engine. Raising the engine removes the weight from the engine mount and creates slight tension on the rubber.
3. Replace the engine mount if the mount exhibits any of the following conditions:
 - The hard rubber is covered with heat check cracks.
 - The rubber is separated from the metal plate of the engine mount.
 - The rubber is split through the center of the engine mount.
 - The engine mount itself is leaking fluid.
4. For engine mount replacement, refer to **Engine Mount Replacement**.

ENGINE MOUNT REPLACEMENT

Removal Procedure

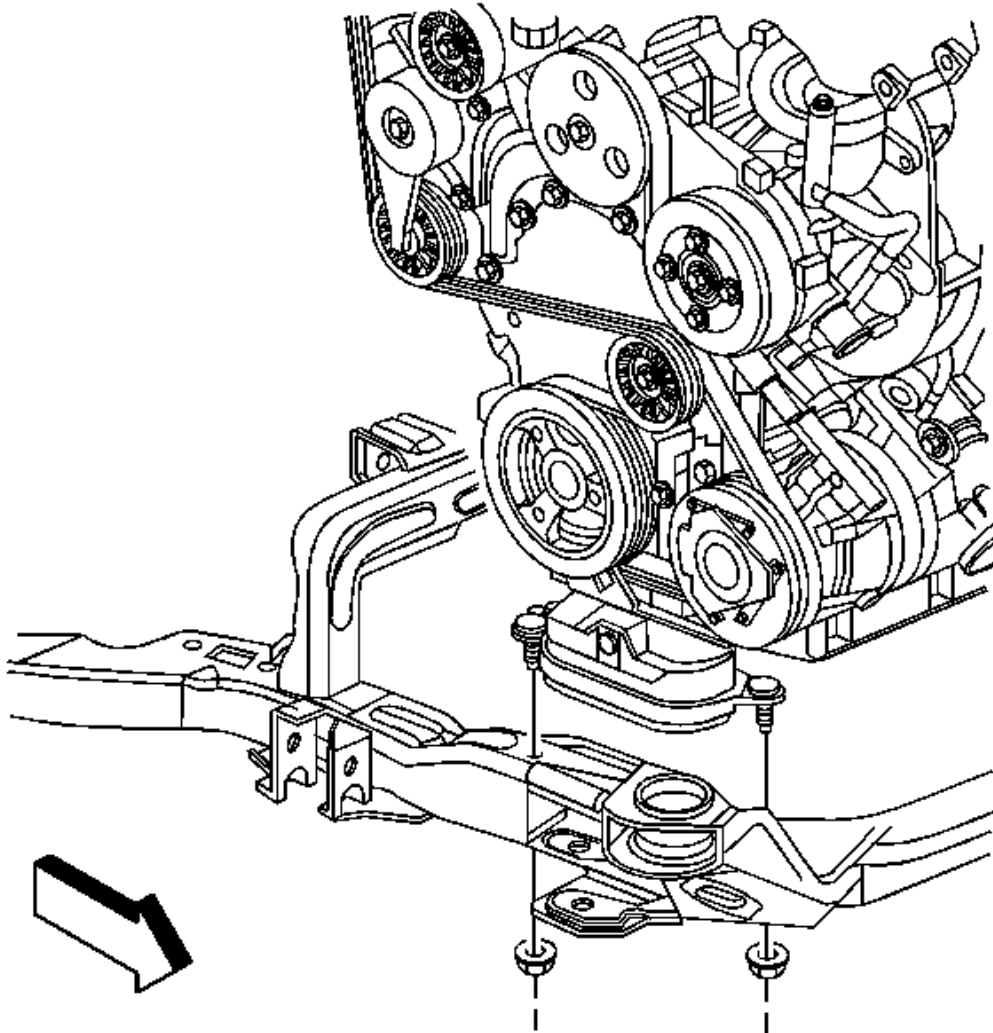

Fig. 22: Identifying Engine Mount-To-Support Frame Bolts
Courtesy of GENERAL MOTORS CORP.

1. Remove the air cleaner outlet duct. Refer to **Air Cleaner Outlet Duct Replacement** .
2. Remove the engine mount struts. Refer to **Engine Mount Strut Replacement - Left Side** and **Engine Mount Strut Replacement - Right Side**.
3. Raise and support the vehicle. Refer to **Lifting and Jacking the Vehicle** .
4. Remove the catalytic converter. Refer to **Catalytic Converter Replacement** .
5. Remove the right front wheel and tire. Refer to **Tire and Wheel Removal and Installation** .

6. Remove the right engine splash shield. Refer to Engine Splash Shield Replacement .
7. Remove the engine mount to frame nuts.

CAUTION: In order to avoid oil pan damage and possible engine failure, insert a block of wood that spans the width of the oil pan bottom between the oil pan and the jack support.

8. Place a utility stand and a block of wood under the oil pan in order to raise the engine.

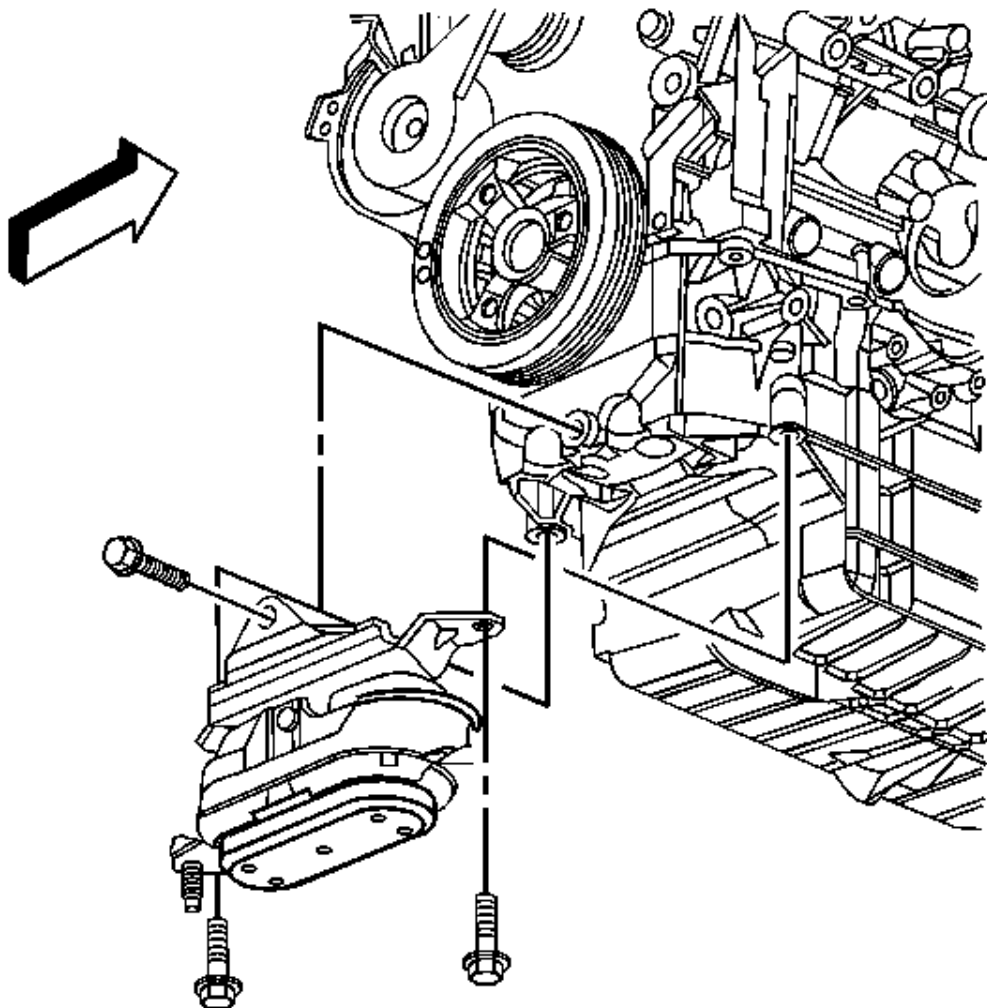

Fig. 23: Identifying Engine Mount And Bracket To-Oil-Pan Bolts

Courtesy of GENERAL MOTORS CORP.

9. Remove the engine mount bracket to oil pan bolts.
10. Remove the engine mount and bracket.

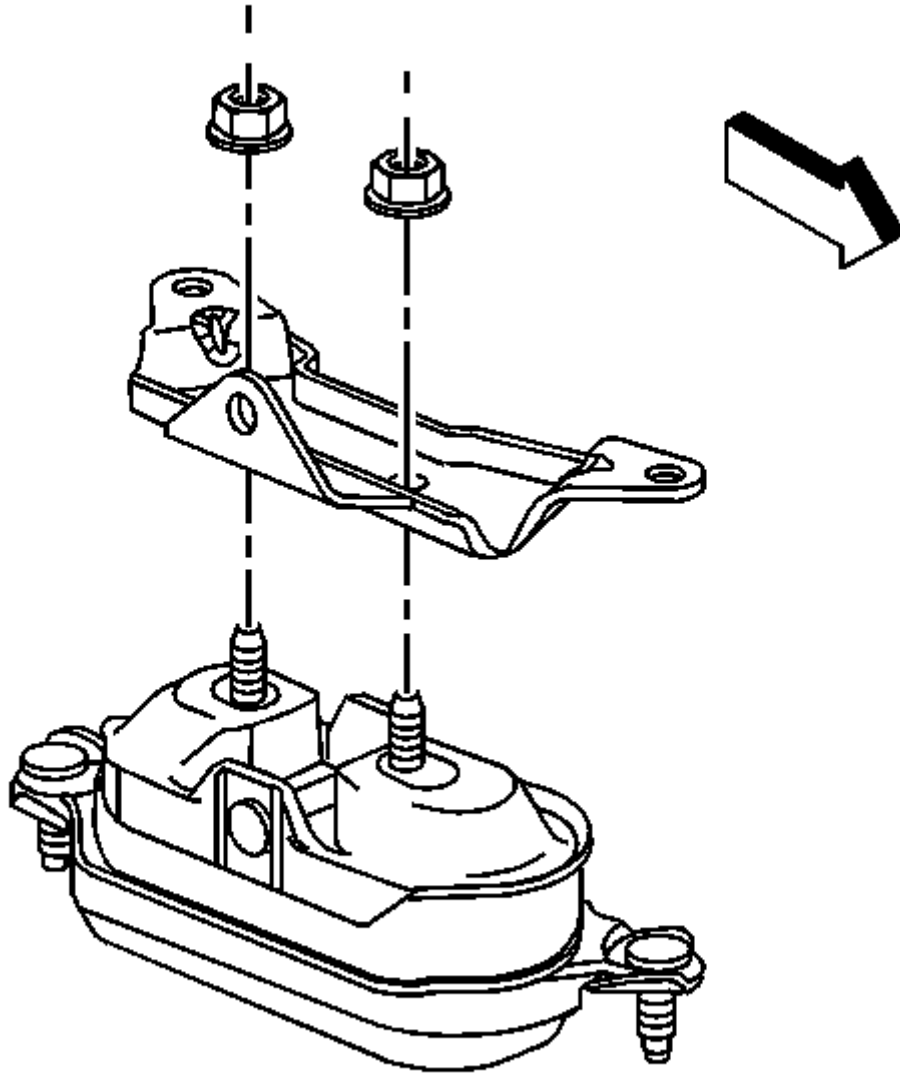

Fig. 24: Identifying Engine Mount Bracket Nuts
Courtesy of GENERAL MOTORS CORP.

11. Remove the engine mount bracket to engine mount nuts.
12. Remove the engine mount from the bracket.

Installation Procedure

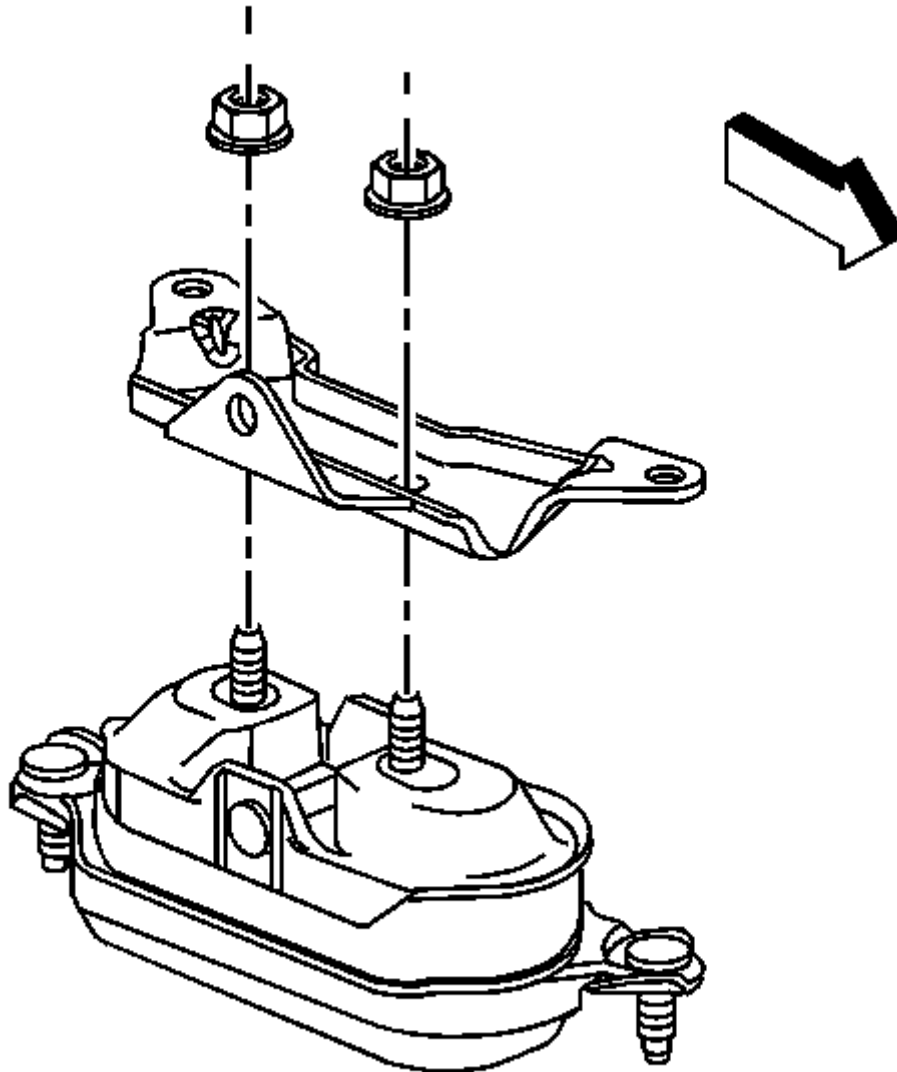

Fig. 25: Identifying Engine Mount Bracket Nuts
Courtesy of GENERAL MOTORS CORP.

1. Install the engine mount to the bracket.

CAUTION: Refer to Fastener Caution .

2. Install the engine mount bracket to engine mount nuts and tighten to **50 N.m (37 lb ft)** .

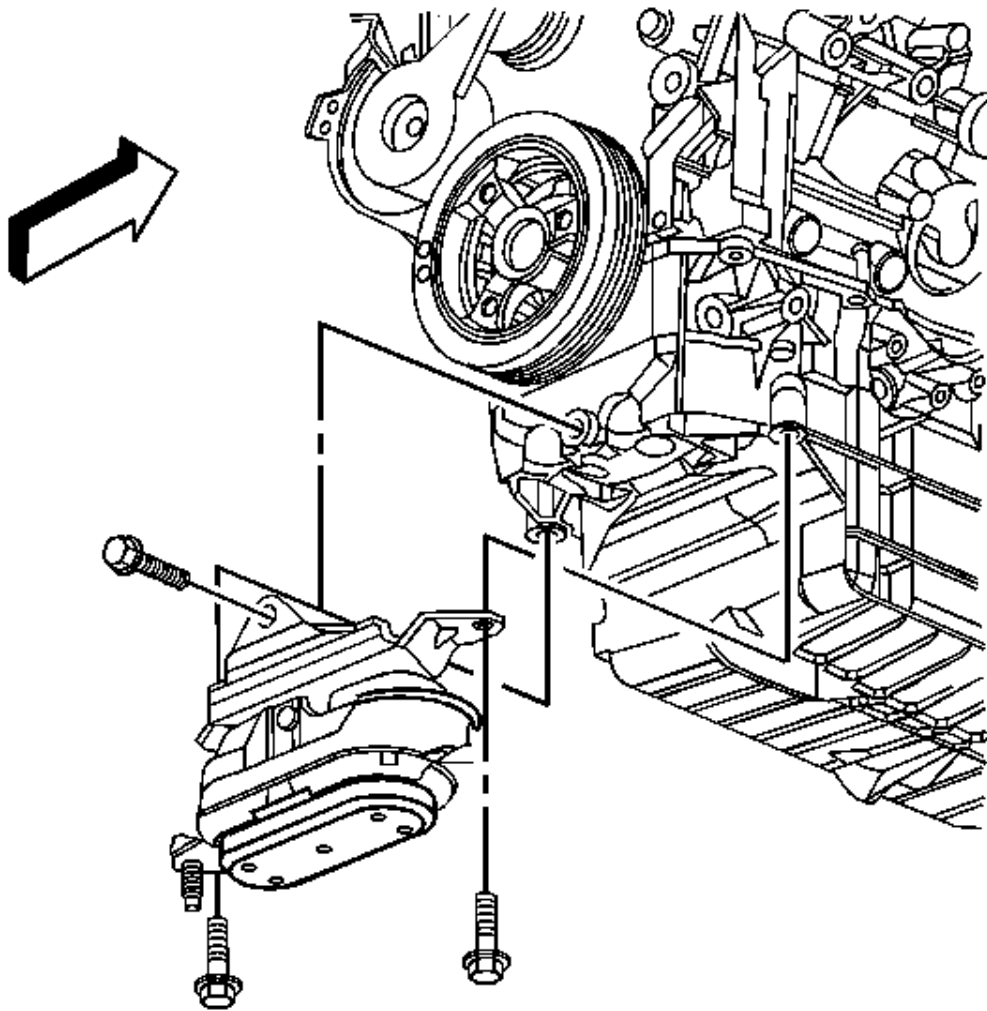

Fig. 26: Identifying Engine Mount And Bracket To-Oil-Pan Bolts
Courtesy of GENERAL MOTORS CORP.