

## **Disassembly and Assembly**

### **3044C Industrial Engine and Engines for Caterpillar Built Machines**

Media Number -REN7582-07

Publication Date -01/01/2010

Date Updated -26/02/2010

i02707279

## **Crankshaft Main Bearings - Remove**

SMCS - 1203-011

### **Removal Procedure**

#### **Start By:**

- A. Remove the engine oil pan. Refer to Disassembly and Assembly, "Engine Oil Pan - Remove and Install".
- B. Remove the flywheel housing in order to remove the rear main bearing. Refer to Disassembly and Assembly, "Flywheel Housing - Remove and Install".

---

#### **NOTICE**

**Keep all parts clean from contaminants.**

**Contaminants may cause rapid wear and shortened component life.**

---

1. Make sure that the main bearing caps are marked for the location and direction for installation. The main bearings and the main bearing caps must be installed in the same location.
-

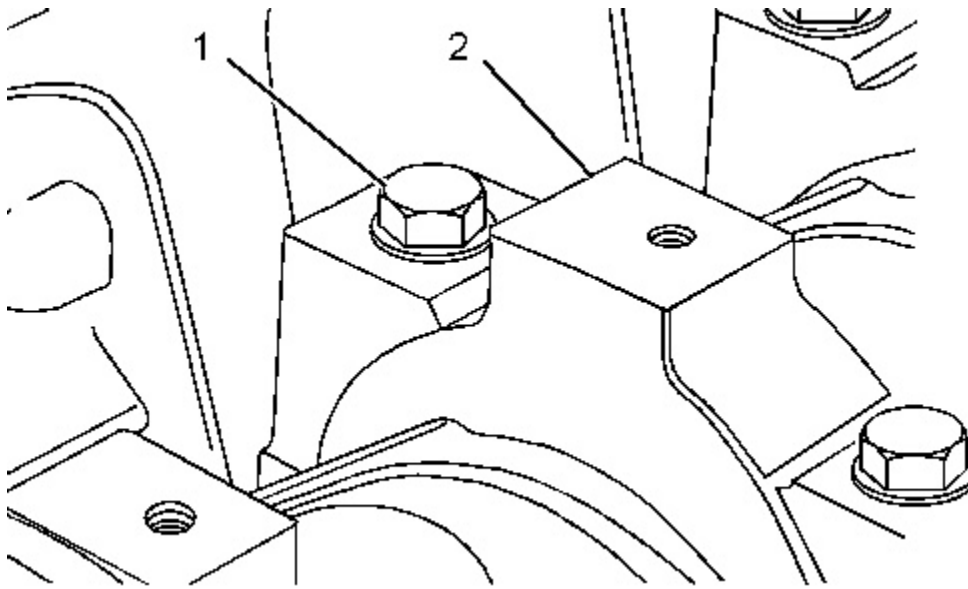

Illustration 1

g01358190

2. Remove bolts (1) and main bearing cap (2) .

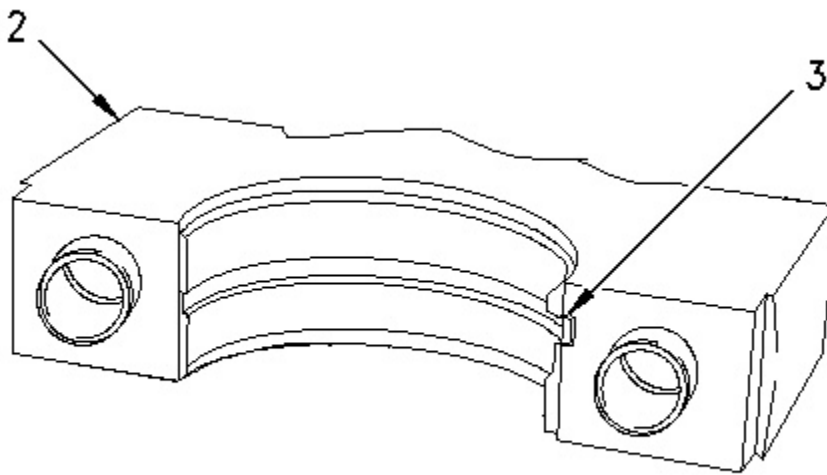

Illustration 2

g00934803

3. Remove lower main bearing (3) from main bearing cap (2). Keep the respective main bearing and the main bearing cap together for proper installation.

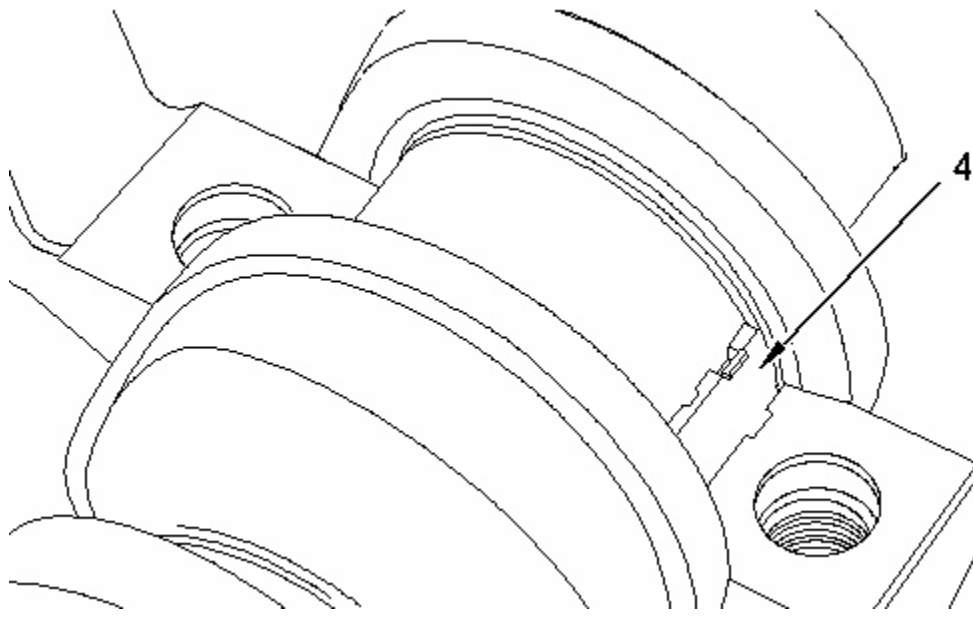

Illustration 3

g00934767

4. Push upper main bearing (4) from the opposite side of the bearing tab with a suitable tool. Carefully rotate the crankshaft while you push on the bearing. Remove upper main bearing (4) from the cylinder block. Keep the upper bearing halves together in order to ensure proper installation.
5. Repeat Step 2 through Step 4 for the remaining main bearings.

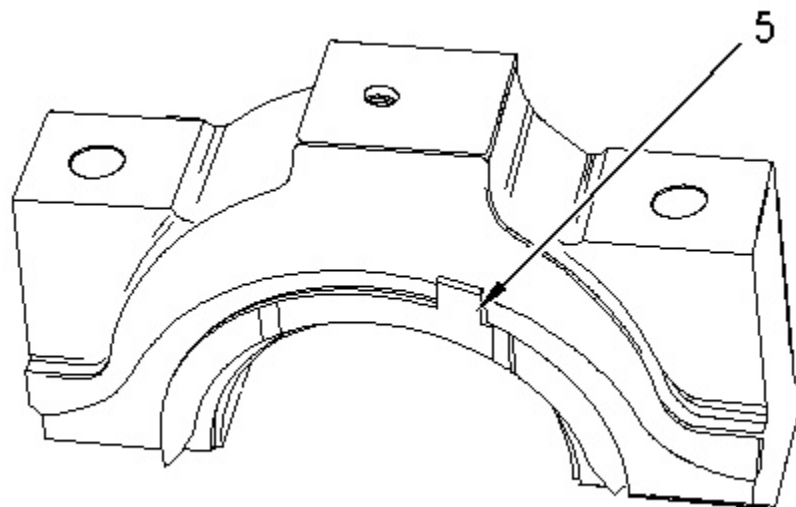

Illustration 4

g00934744

6. Remove the lower half of thrust washers (5) from both sides of the rear main bearing cap. Remove

the seals from the rear main bearing cap.

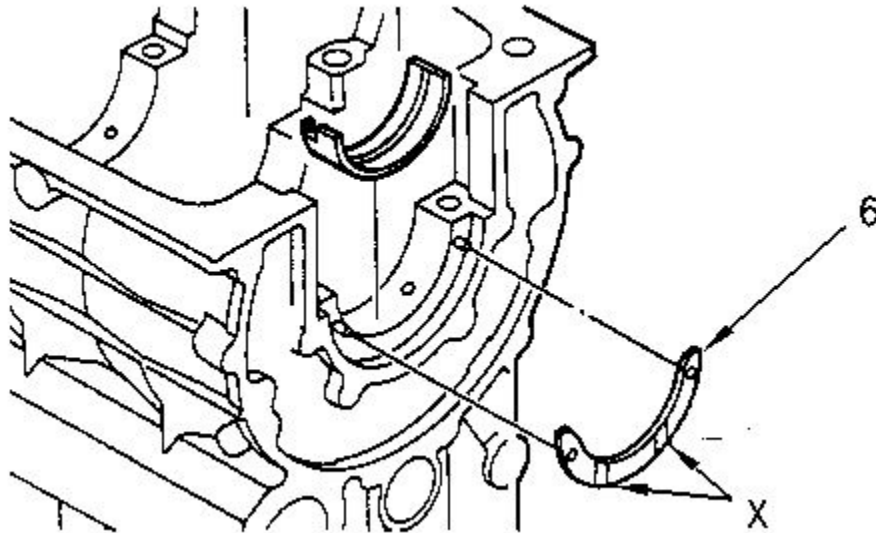

Illustration 5

g01001838

7. Remove the upper half of thrust washer (6) from the rear of the cylinder block. Carefully rotate the crankshaft while you push on thrust washer (6). If necessary, move the crankshaft to the front or to the rear in order to loosen a tight thrust washer.

---

Mon Nov 26 14:20:44 UTC+0700 2018