

FG000993

Figure 31

6. Install retaining ring (13). Make sure that it is properly seated.

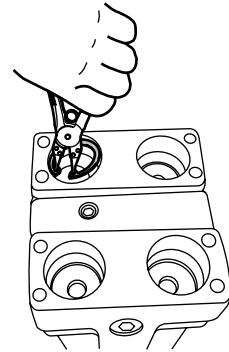

FG000991

Figure 32

7. Assemble rod seal (23), dust seal (24), and O-ring (22) into plug (21).

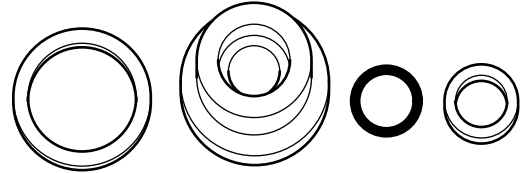

FG001001

Figure 33

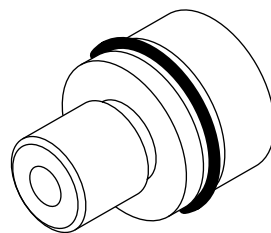

FG001002

Figure 34

8. Assemble seal (16), piston (38), steel ball (17), plate (19), spring (18), and retaining ring (20) into push rod (14).

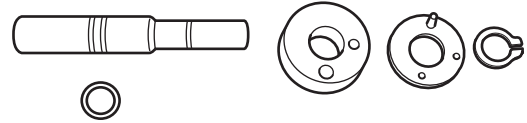

FG001003

Figure 35

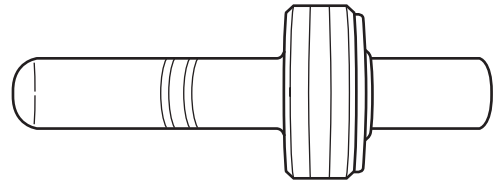

FG001004

Figure 36

9. Assemble push rod and plug.

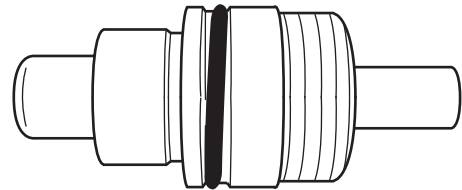

FG001005

Figure 37

10. Install push rod assembly into each body (1 and 2).

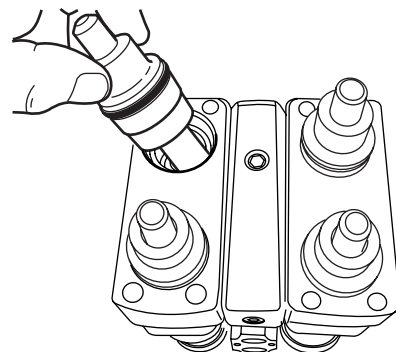

FG000990

Figure 38

11. Install bushing (28) in cover (25) using jig.

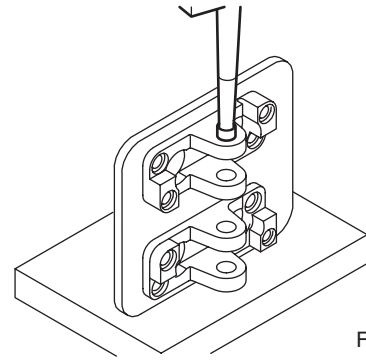

Figure 39

FG001006

12. Assemble cover (28) onto each body (1 and 2) and install hex socket head bolt (26) using torque wrench.

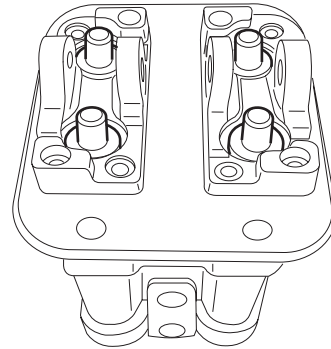

Figure 40

FG001007

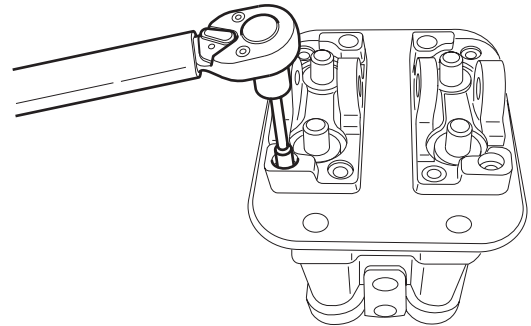

Figure 41

FG000989

13. Install set screws (31) and hex nut (32) into cam (27) and tighten it.

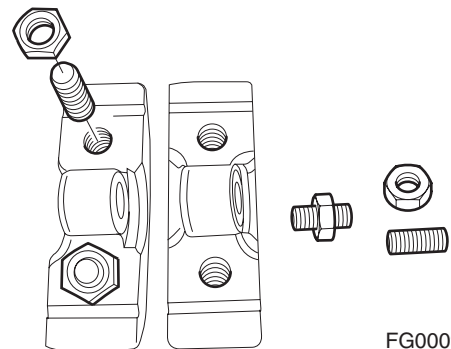

Figure 42

FG000987