

Fig. 12: Moving Manual Control Lever
Courtesy of FORD MOTOR CO.

6. **NOTE:** To prevent selector lever cable damage, do not apply force to the selector lever cable between the manual control lever and the selector lever cable bracket.

NOTE: When installing the selector lever cable end, make sure that the selector lever cable end is correctly installed onto the manual control lever ball stud. Pull back on the selector lever cable to make sure that the selector cable end is correctly installed onto the manual control lever ball stud.

Install the selector lever cable end onto the manual control lever ball stud.

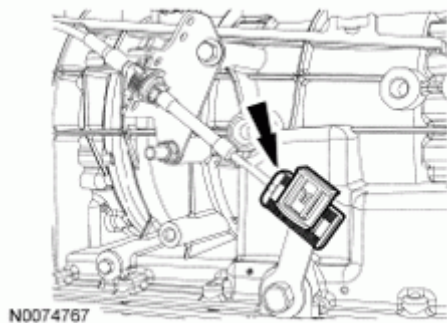

Fig. 13: Locating Selector Lever Cable
Courtesy of FORD MOTOR CO.

7. Lock the transmission selector lever cable lock tab.

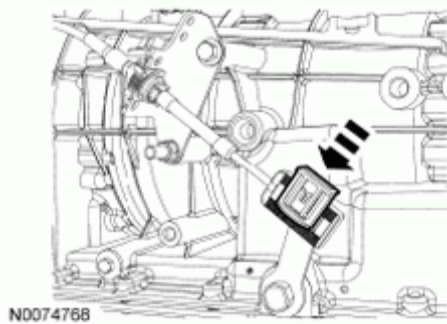

Fig. 14: Locking Transmission Selector Lever Cable Lock Tab
Courtesy of FORD MOTOR CO.

8. Remove the weight.
9. Carefully move the selector lever from detent to detent and compare with transmission settings. Verify that the vehicle will start in PARK or NEUTRAL and reverse lamps illuminate in REVERSE. If not, Steps 1 through 5 must be repeated and for the 4R75E transmission, include Transmission Range (TR) sensor adjustment in NEUTRAL. Readjust if necessary.

REMOVAL AND INSTALLATION

BRAKE SHIFT INTERLOCK ACTUATOR

NOTE: On vehicles equipped with an auxiliary battery, both the negative and positive battery cables must be disconnected.

1. Disconnect the battery. For additional information, refer to **BATTERY, MOUNTING AND CABLES**.
2. Remove the 2 screws and Data Link Connector (DLC).

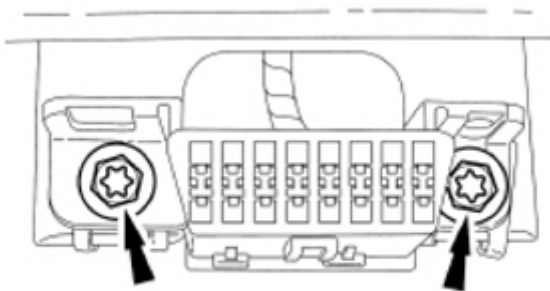

Fig. 15: Locating Data Link Connector Screws
Courtesy of FORD MOTOR CO.

3. Pull to release the retaining clips and remove the steering column opening lower finish panel.

4. Disconnect the Brake Shift Interlock Actuator (BSIA) solenoid connector.
5. Remove the 4 steering column-to-cross car beam nuts and lower the steering column.
 - To install, tighten to 15 Nm (133 lb-in).

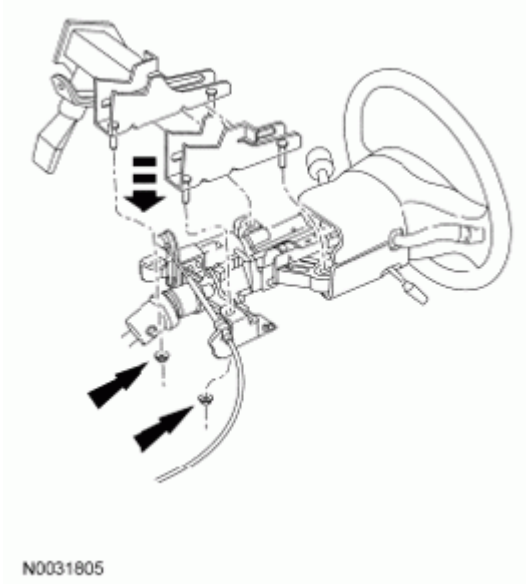

Fig. 16: Locating Steering Column-To-Cross Car Beam Nuts
Courtesy of FORD MOTOR CO.

6. Remove the bolts and the BSIA solenoid.
 - To install, tighten to 9 Nm (80 lb-in).

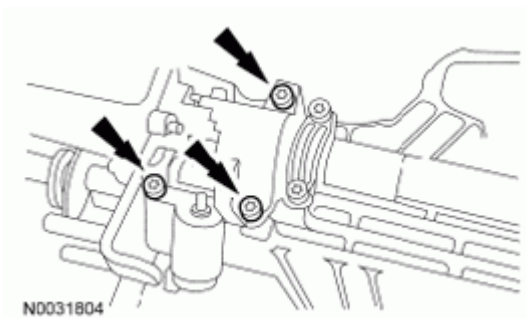

Fig. 17: Locating BSIA Solenoid Bolts
Courtesy of FORD MOTOR CO.

7. To install, reverse the removal procedure.
8. Make sure the selector lever cable is correctly adjusted. For additional information, refer to **SELECTOR LEVER CABLE ADJUSTMENT**. Test the BSIA for normal operation.

SELECTOR LEVER CABLE AND BRACKET - 4R70E, 4R75E

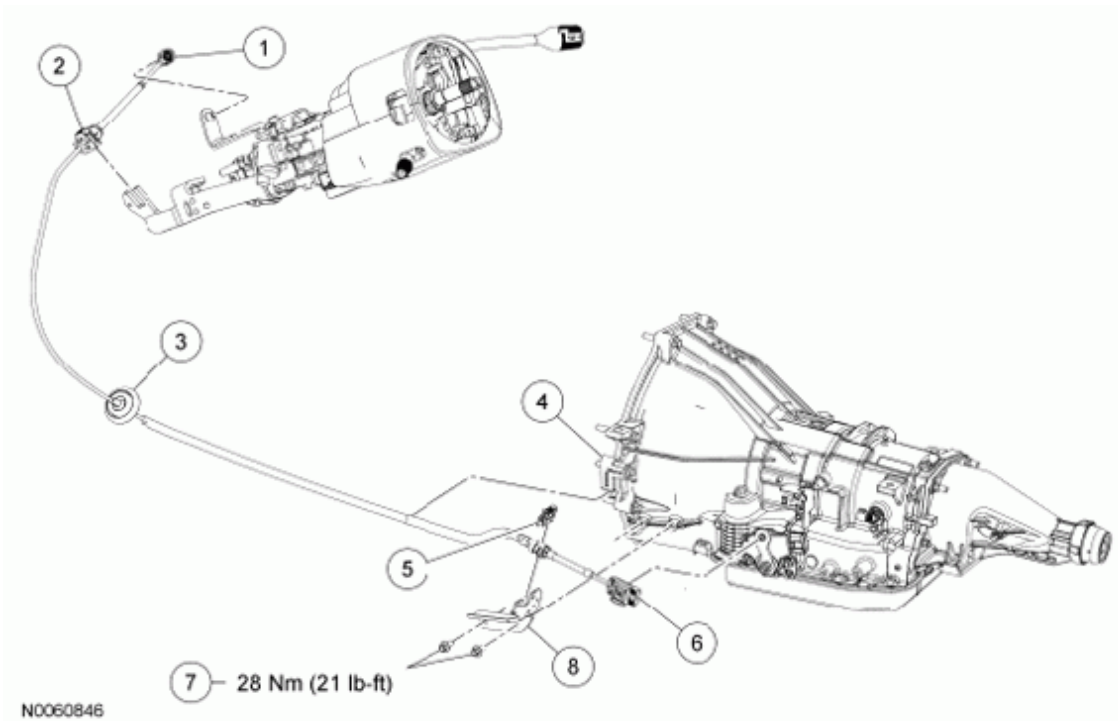

Fig. 18: Exploded View Of Selector Lever Cable And Bracket With Torque Specifications -- 4R70E, 4R75E
 Courtesy of FORD MOTOR CO.

Item	Part Number	Description
1	-	Selector lever cable eyelet (part of 7E395)
2	-	Selector lever cable retainer (part of 7E395)
3	-	Selector lever cable grommet (part of 7E395)
4	N811286	Selector lever cable retainer
5	7H181	Selector lever cable retaining clip
6	7E395	Selector lever cable
7	N605785	Selector lever cable bracket bolts
8	7B229	Selector lever cable bracket

Removal and Installation

NOTE: To prevent selector lever cable damage, do not apply force to the selector lever cable assembly between the steering column shift tube bracket and the steering column bracket.

1. Remove the 2 screws and Data Link Connector (DLC).

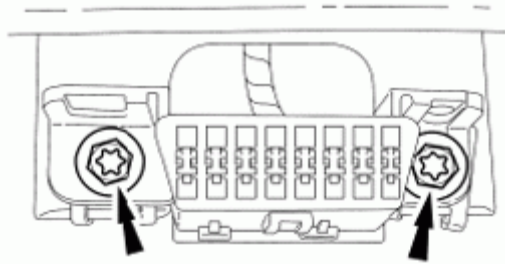

N0089300

Fig. 19: Locating Data Link Connector Screws
Courtesy of FORD MOTOR CO.

2. Pull to release the retaining clips and remove the steering column opening lower finish panel.
3. Remove the 4 steering column-to-cross car beam nuts and lower the steering column.
 - To install, tighten to 15 Nm (133 lb-in).

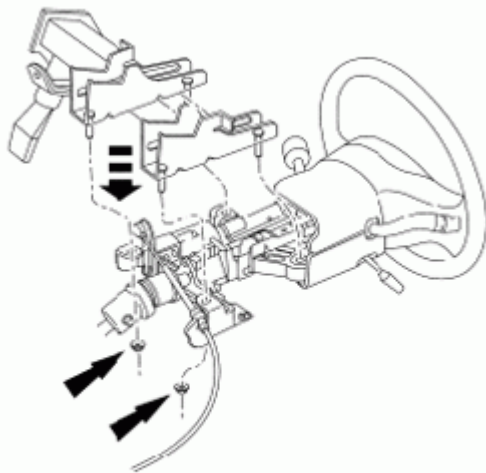

N0031805

Fig. 20: Locating Steering Column-To-Cross Car Beam Nuts
Courtesy of FORD MOTOR CO.

4. Disconnect the selector lever cable.
 1. Disconnect the selector lever cable from the steering column shift tube lever.
 2. Carefully lift the locking tab and disconnect the selector lever cable from the steering column bracket.

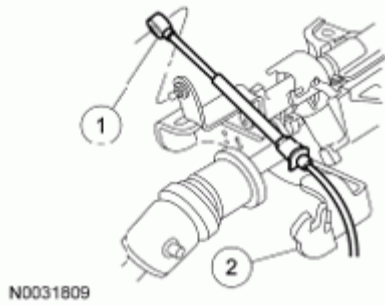

Fig. 21: Identifying Selector Lever Cable And Locking Tab
Courtesy of FORD MOTOR CO.

5. Push the rubber grommet and the selector lever cable through the bulkhead.
6. With the vehicle in NEUTRAL, position it on a hoist. For additional information, refer to **JACKING & LIFTING** .

NOTE: To prevent selector lever cable damage, do not apply force to the selector lever cable between the transmission manual control lever and the selector lever cable bracket.

7.

Disconnect the selector lever cable at the manual control lever.



Fig. 22: Locating Selector Lever Cable
Courtesy of FORD MOTOR CO.

8. Remove the selector lever cable retaining clip and selector lever cable from the bracket.
 - Discard the selector lever cable retaining clip.



Fig. 23: Locating Selector Lever Cable Retaining Clip
Courtesy of FORD MOTOR CO.

9. Remove the selector lever cable bracket.
 - Remove the selector lever cable bracket bolts.
 - To install, tighten to 28 Nm (21 lb-ft).
 - Remove the selector lever cable bracket.

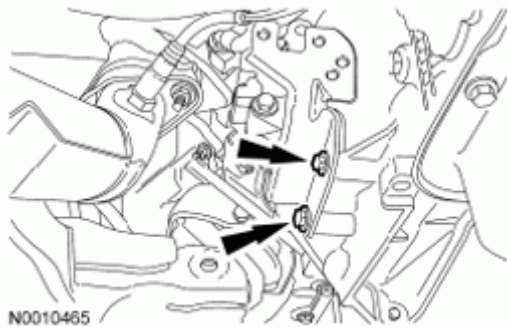

Fig. 24: Locating Selector Lever Cable Bracket Bolts
Courtesy of FORD MOTOR CO.

10. **NOTE:** When installing the selector lever cable, make sure that the selector lever cable locking tabs are locked in place.

NOTE: Press the selector lever cable into the selector lever cable bracket and listen for the selector lever cable to click into place. Pull back on the selector lever cable to make sure that it is locked into the selector lever cable bracket.

To install, reverse the removal procedure.

- Adjust the selector lever cable. For additional information, refer to **SELECTOR LEVER CABLE ADJUSTMENT**.

SHIFT LEVER CABLE AND BRACKET - TORQSHIFT

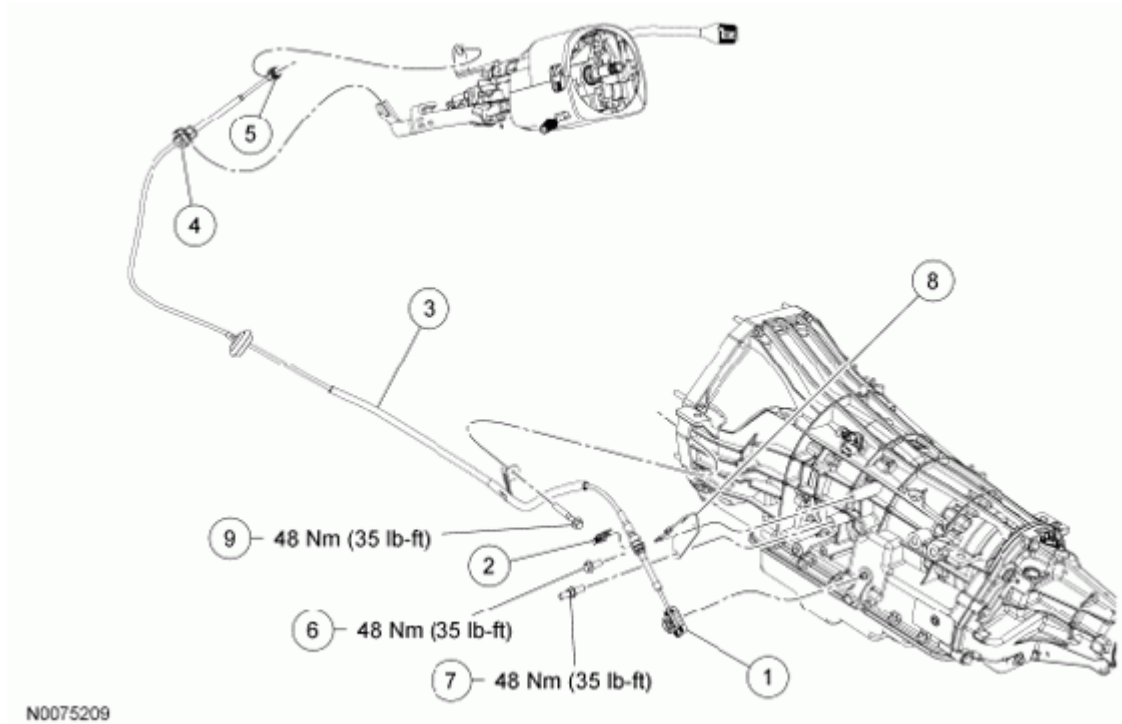

Fig. 25: Identifying Shift Lever Cable And Bracket Components With Torque Specifications (TorqShift)
 Courtesy of FORD MOTOR CO.

Item	Part Number	Description
1	-	Selector lever cable eyelet (part of 7E395)
2	7H181	Selector lever cable retaining clip
3	7E395	Selector lever cable
4	-	Selector lever cable retainer (part of 7E395)
5	-	Selector lever cable eyelet (part of 7E395)
6	56539-S	Selector lever cable bracket bolt
7	391510-S	Selector lever cable bracket bolt
8	7B229	Selector lever cable bracket
9	W707410-S	Selector lever cable retaining clip bolt

Removal and Installation

1. With the vehicle in NEUTRAL, position it on a hoist. For additional information, refer to **JACKING & LIFTING**.
2. Remove the 2 screws and Data Link Connector (DLC).