

## 2014 Ford Edge SE

2014 ENGINE Fuel Tank & Lines - Edge, MKX

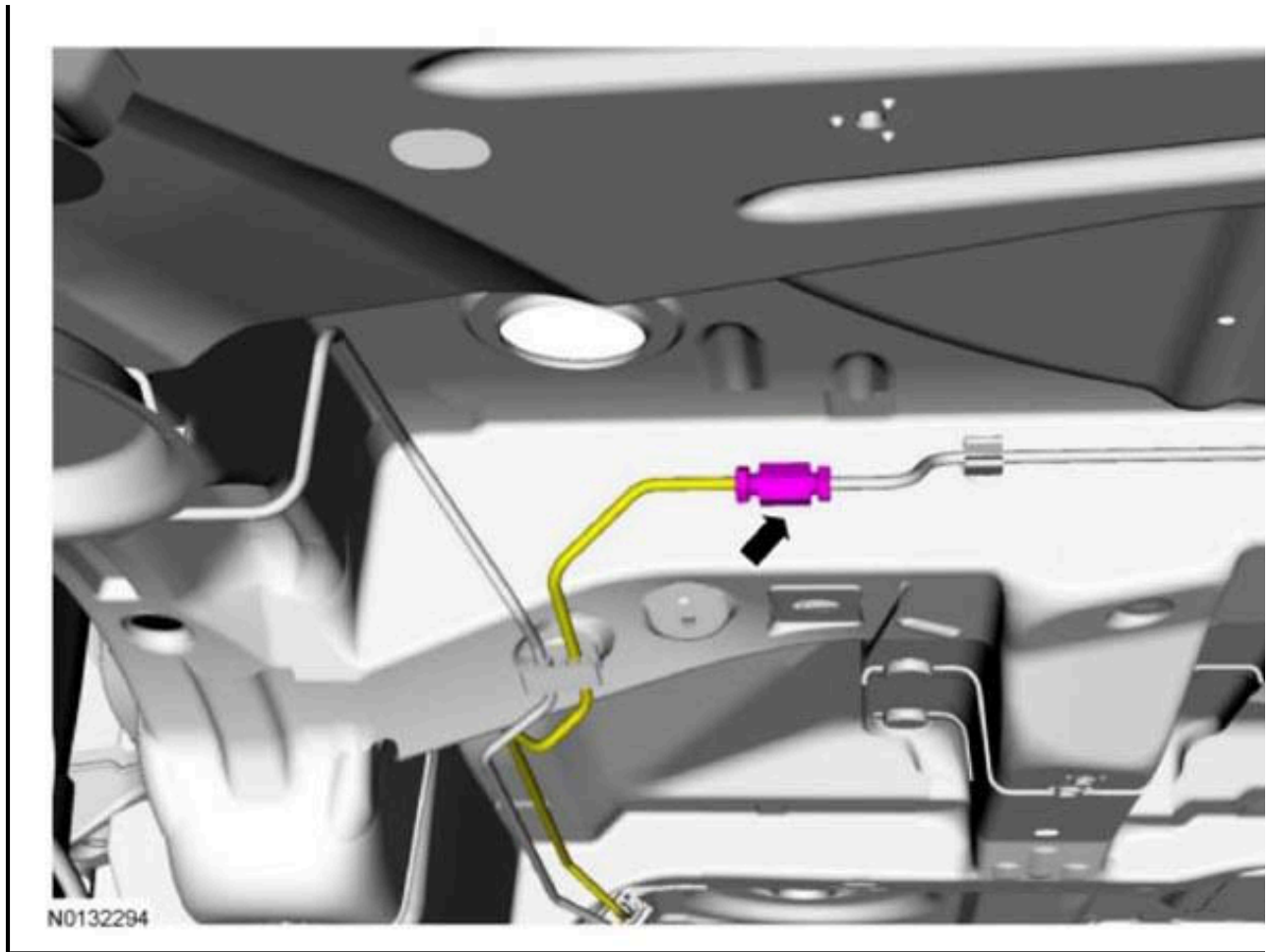

17. Remove the 2 nuts, 7 bundle retainer clips and remove the fuel supply and **EVAP** vapor tube assembly.
  - To install, tighten to 9 Nm (80 lb-in).

## 2014 Ford Edge SE

2014 ENGINE Fuel Tank & Lines - Edge, MKX

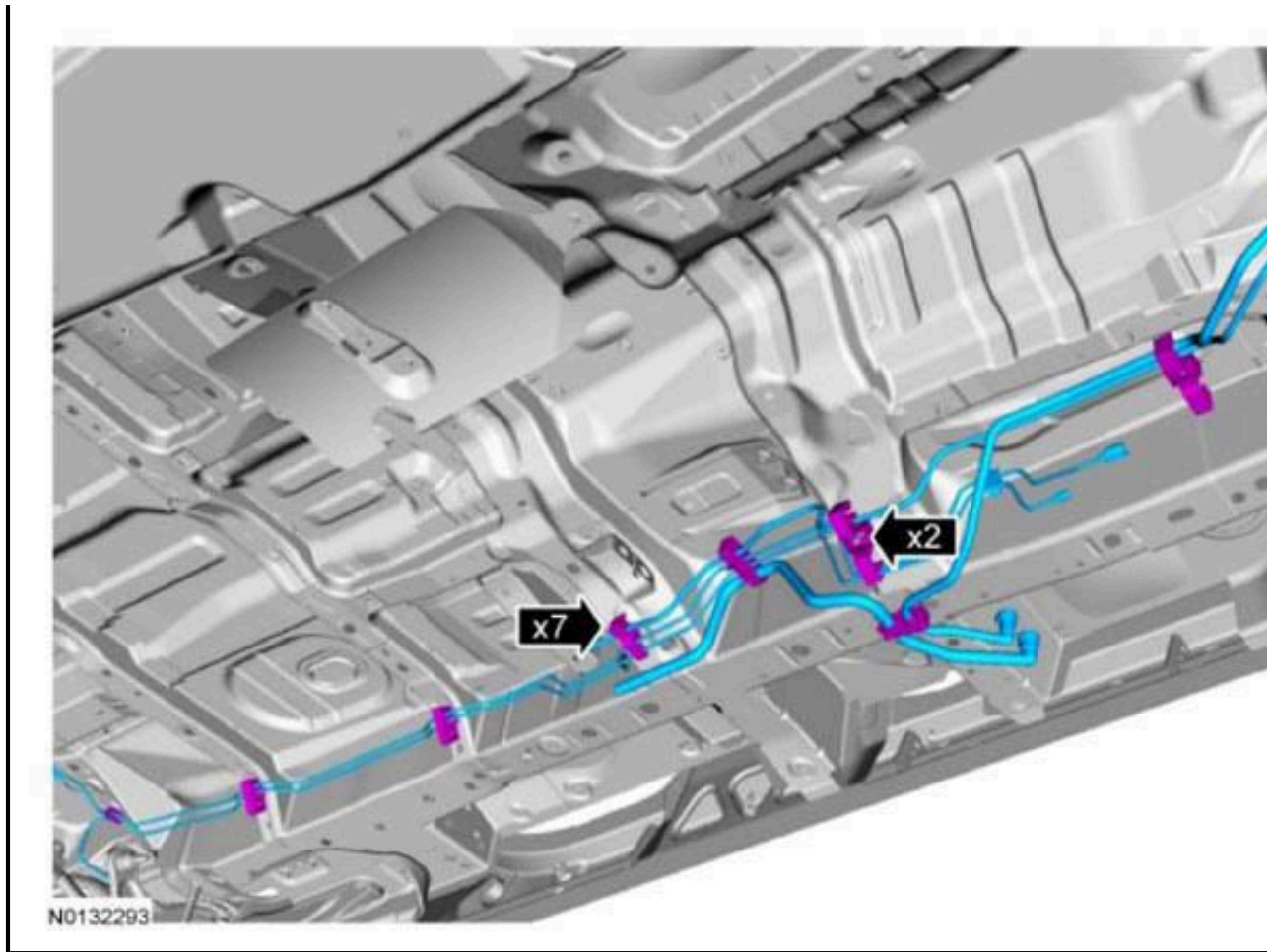

18. To install, reverse the removal procedure.

### FUEL LINES - 3.5L, 3.7L

Front Fuel Supply and Evaporative Emission (EVAP) Vapor Tubes

## 2014 Ford Edge SE

2014 ENGINE Fuel Tank & Lines - Edge, MKX

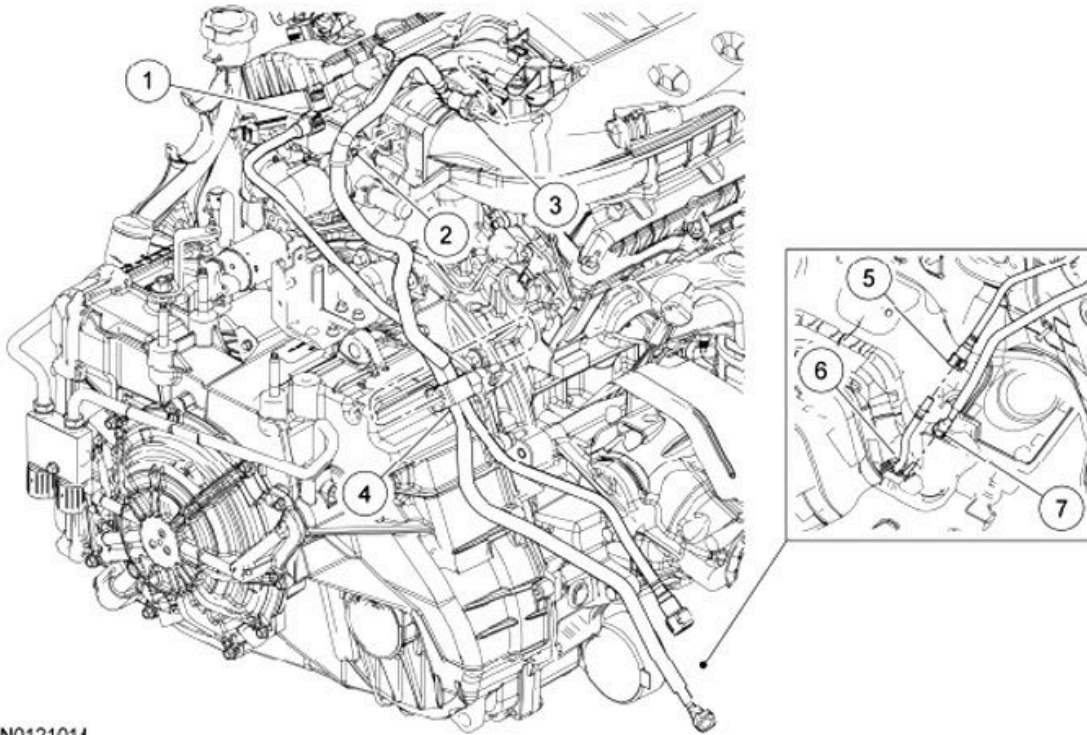

N0121014

**Fig. 5: Identifying Front Fuel Supply And Evaporative Emission (EVAP) Vapor Tubes Components**  
 Courtesy of FORD MOTOR CO.

Item	Part Number	Description
1	-	Front fuel supply tube quick connect coupling-to-fuel rail (part of 9J280)
2	-	Front fuel supply and <b>EVAP</b> vapor tube assembly pin-type retainer (part of 9J280)
3	-	Front Evaporative Emission (EVAP) vapor tube quick connect coupling-to- <b>EVAP</b> canister purge valve (part of 9J280)
4	9J280	Front fuel supply and <b>EVAP</b> vapor tube assembly
5	-	Front <b>EVAP</b> vapor tube quick connect coupling-to-middle <b>EVAP</b> vapor tube (part of 9J280)
6	-	Middle <b>EVAP</b> vapor tube-to-front <b>EVAP</b> vapor tube quick connect coupling (part of 9S284)
7	-	Front fuel supply tube quick connect coupling-to-middle fuel supply tube (part of 9J280)

### Middle Fuel Supply and Evaporative Emission (EVAP) Vapor Tubes

## 2014 Ford Edge SE

2014 ENGINE Fuel Tank & Lines - Edge, MKX

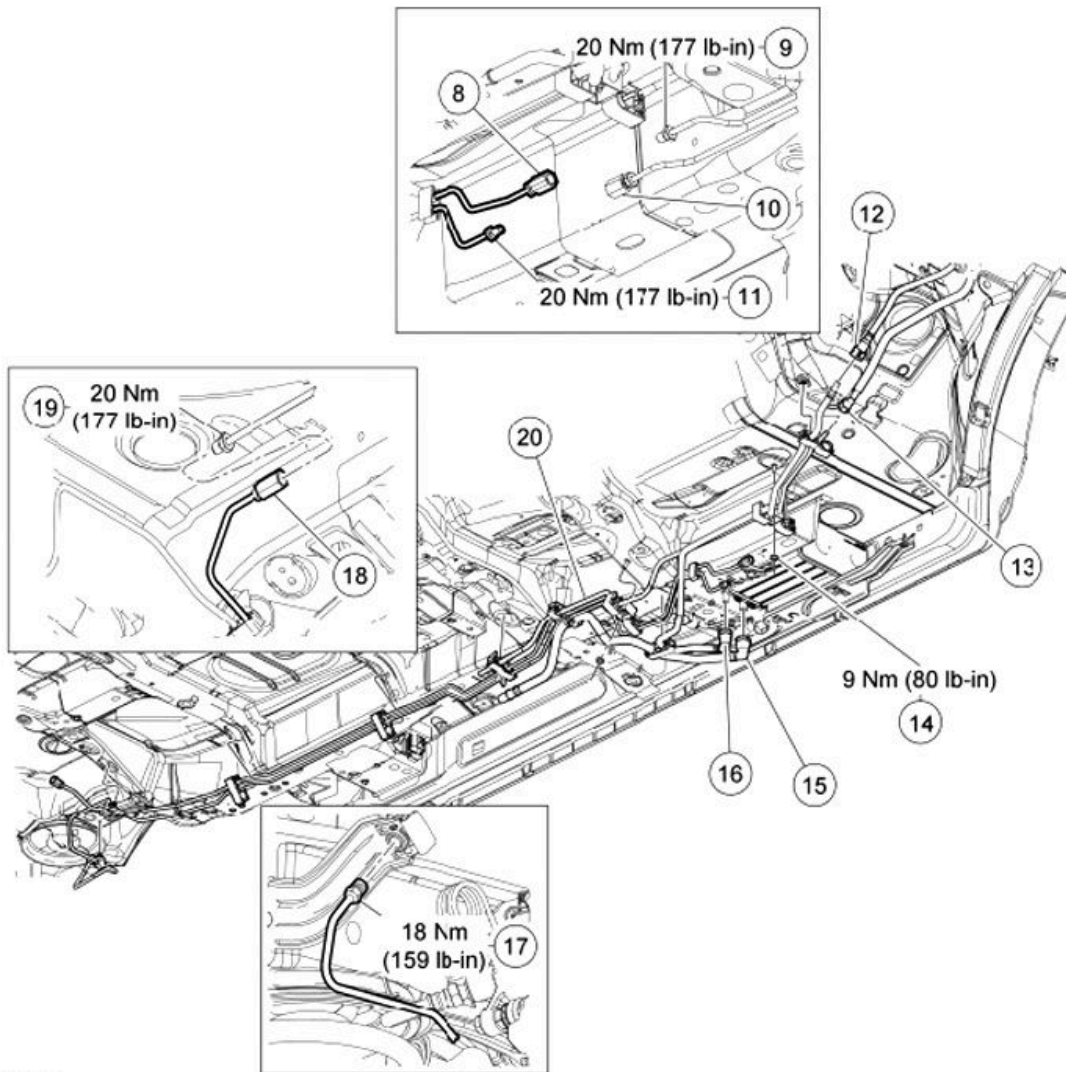

N0126200

**Fig. 6: Identifying Middle Fuel Supply And Evaporative Emission (EVAP) Vapor Tubes Components With Torque Specifications**  
 Courtesy of FORD MOTOR CO.

Item	Part Number	Description
8	-	Middle brake tube-to-front brake tube fitting (part of 9S284)
9	-	Front brake tube-to-middle brake tube fitting (part of 9C296)
10	-	Front brake tube-to-middle brake tube fitting (part of 9C296)
11	-	Middle brake tube-to-front brake tube fitting (part of 9S284)
12	-	Front <b>EVAP</b> vapor tube quick connect coupling-to-middle <b>EVAP</b> vapor tube (part of 9J280)
13	-	Front fuel supply tube quick connect coupling-to-middle fuel supply tube (part of 9J280)

## 2014 Ford Edge SE

2014 ENGINE Fuel Tank & Lines - Edge, MKX

14	W707137	Bundle retainer clip nut (2 required)
15	-	Middle <b>EVAP</b> vapor tube quick connect coupling-to- <b>EVAP</b> canister (part of 9S284)
16	-	Middle <b>EVAP</b> vapor tube quick connect coupling-to- <b>EVAP</b> canister (part of 9S284)
17	-	Middle brake tube fitting-to-rear brake hose (part of 9S284)
18	-	Middle brake tube fitting-to-rear brake tube fitting (part of 9S284)
19	-	Rear brake tube fitting-to-middle brake tube fitting (part of 2265)
20	9S284	Middle fuel supply and <b>EVAP</b> vapor tube assembly

### Removal and Installation

**WARNING:** Do not smoke, carry lighted tobacco or have an open flame of any type when working on or near any fuel-related component. Highly flammable mixtures are always present and may be ignited. Failure to follow these instructions may result in serious personal injury.

**WARNING:** Do not carry personal electronic devices such as cell phones, pagers or audio equipment of any type when working on or near any fuel-related component. Highly flammable mixtures are always present and may be ignited. Failure to follow these instructions may result in serious personal injury.

**WARNING:** Before working on or disconnecting any of the fuel tubes or fuel system components, relieve the fuel system pressure to prevent accidental spraying of fuel. Fuel in the fuel system remains under high pressure, even when the engine is not running. Failure to follow this instruction may result in serious personal injury.

**WARNING:** When handling fuel, always observe fuel handling precautions and be prepared in the event of fuel spillage. Spilled fuel may be ignited by hot vehicle components or other ignition sources. Failure to follow these instructions may result in serious personal injury.

**WARNING:** Always disconnect the battery ground cable at the battery when working on an evaporative emission (EVAP) system or fuel-related component. Highly flammable mixtures are always present and may be ignited. Failure to follow these instructions may result in serious personal injury.

### Front Fuel Supply and Evaporative Emission (EVAP) Vapor Tubes

1. With the vehicle in NEUTRAL, position it on a hoist. For additional information, refer to **JACKING & LIFTING**.
2. Release the fuel system pressure. For additional information, refer to **FUEL SYSTEM - GENERAL INFORMATION**.

## 2014 Ford Edge SE

### 2014 ENGINE Fuel Tank & Lines - Edge, MKX

3. Disconnect the battery ground cable. For additional information, refer to **BATTERY, MOUNTING AND CABLES** .
4. Remove the Air Cleaner (ACL) outlet pipe. For additional information, refer to **INTAKE AIR DISTRIBUTION AND FILTERING** .
5. Disconnect the vapor tube-to-**EVAP** canister purge valve quick connect coupling. For additional information, refer to **FUEL SYSTEM - GENERAL INFORMATION** .
6. Disconnect the fuel vapor tube retainer.
7. Disconnect the fuel tube-to-fuel rail quick connect coupling. For additional information, refer to **FUEL SYSTEM - GENERAL INFORMATION** .

- NOTE:**        **The front fuel supply and EVAP vapor tube assembly must be replaced anytime the routing clip is removed from the transaxle stud.**
- 8.

Disconnect the front fuel supply and **EVAP** vapor tube assembly routing clip from the transaxle stud and position aside.

- NOTE:**        **Some residual fuel may remain in the fuel tubes. Carefully drain into a suitable container.**
- 9.

Disconnect the front fuel supply tube-to-middle fuel supply tube quick connect coupling. For additional information, refer to **FUEL SYSTEM - GENERAL INFORMATION** .

10. Disconnect the front **EVAP** vapor tube-to-middle **EVAP** vapor tube quick connect coupling. For additional information, refer to **FUEL SYSTEM - GENERAL INFORMATION** .
11. Remove front fuel supply and **EVAP** vapor tube assembly.

#### **Middle Fuel Supply and Evaporative Emission (EVAP) Vapor Tubes**

12. Remove the fuel tank. For additional information, refer to **FUEL TANK** .
13. Remove the 3 bolts, pin-type retainer and the Evaporative Emission (EVAP) shield.
  - To install, tighten to 9 Nm (80 lb-in).
14. Disconnect the fresh air tube from the dust separator.
15. Release the retainer clip and remove the fresh air tube.
16. Disconnect the 2 middle-to-rear brake tube fittings.
  - To install, tighten to 20 Nm (177 lb-in).
17. Remove the 4 nuts and the 4 bundle retainer clips.
  - To install, tighten to 9 Nm (80 lb-in).
18. Remove middle fuel supply and **EVAP** vapor tube assembly.
19. To install, reverse the removal procedure.

#### **FUEL PUMP MODULE**