

REPAIR INSTRUCTIONS

EXHAUST MANIFOLD REPLACEMENT (LEA)

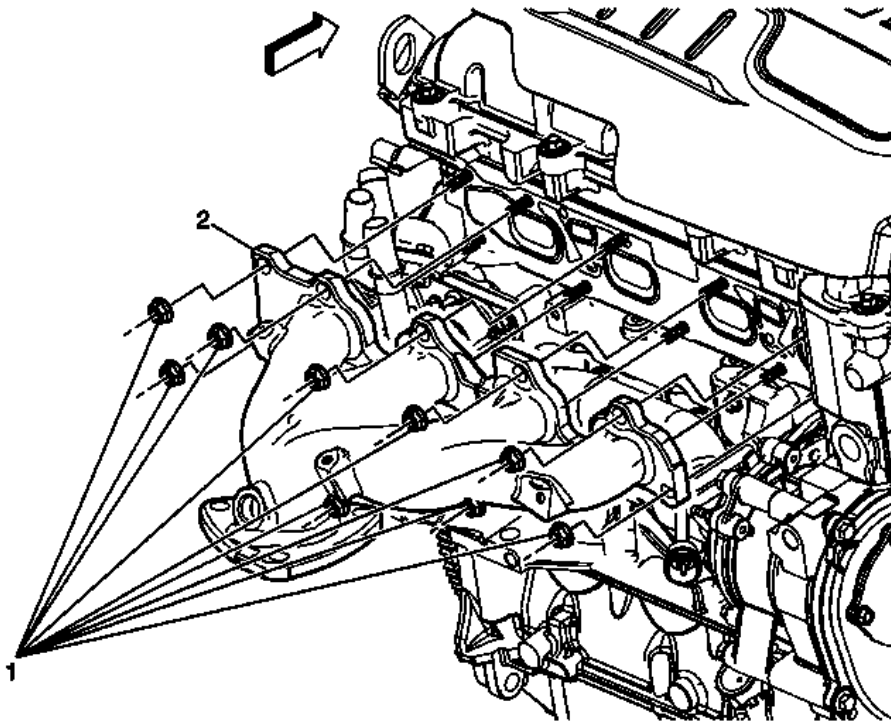

Fig. 1: View Of Exhaust Manifold & Nuts

Courtesy of GENERAL MOTORS COMPANY

Exhaust Manifold Replacement (LEA)

Callout	Component Name
Preliminary Procedures <ol style="list-style-type: none"> 1. Remove the exhaust manifold heat shield. Refer to <u>Exhaust Manifold Heat Shield Replacement (LEA)</u>. 2. Remove the exhaust manifold heated oxygen sensor. Refer to <u>Heated Oxygen Sensor Replacement - Sensor 1</u>. 3. Remove the intake manifold bracket. 4. Remove the 3 exhaust manifold fasteners. Refer to <u>Catalytic Converter Replacement (LEA)</u>. 	
1	Exhaust Manifold Nut (Qty: 10) WARNING: Refer to <u>Hot Exhaust System Warning</u> . CAUTION:

2014 GMC Terrain SLE

2014 ENGINE Engine Exhaust - Equinox & Terrain

Refer to **Fastener Caution** .

Tighten
14 (10 lb ft)

Exhaust Manifold

Procedure

- 2
1. Remove and discard the exhaust manifold gasket.
2. Clean any exhaust manifold gasket debris from the cylinder head and exhaust manifold.
3. Install new exhaust manifold gasket.
4. Tighten the exhaust manifold nuts working from the center out.

CATALYTIC CONVERTER REPLACEMENT (LEA)

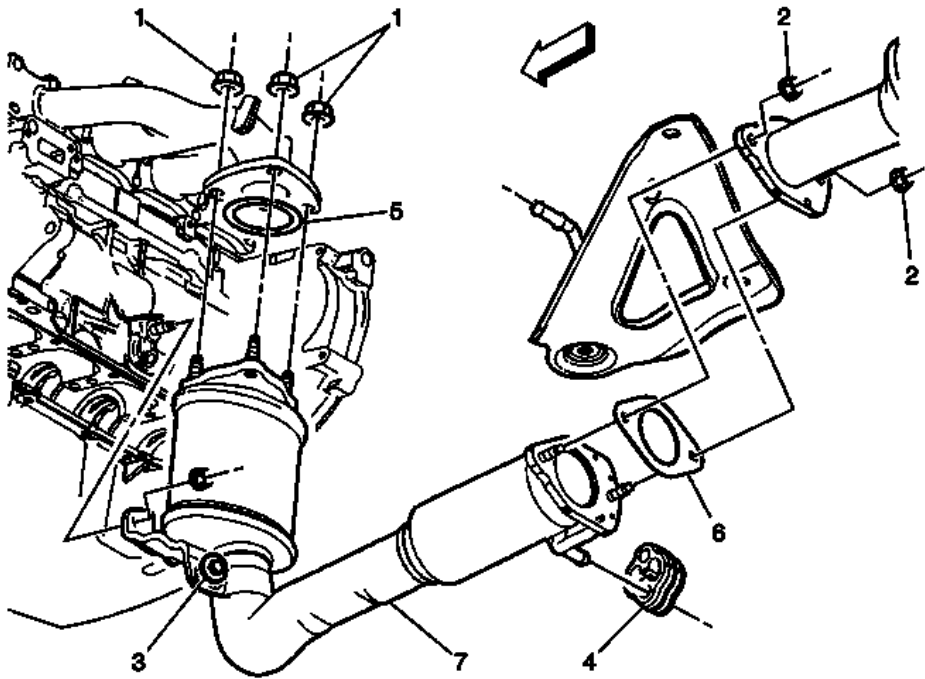

Fig. 2: Catalytic Converter

Courtesy of GENERAL MOTORS COMPANY

Catalytic Converter Replacement (LEA)

Callout	Component Name
WARNING:	

Refer to **Hot Exhaust System Warning** .

Preliminary Procedure

1. Raise and support the vehicle. Refer to **Lifting and Jacking the Vehicle** .
2. Remove the exhaust manifold. Refer to **Exhaust Manifold Replacement (LEA)**.
3. Remove the oxygen sensor after the catalytic converter. Refer to **Heated Oxygen Sensor Replacement - Sensor 2** .
4. Remove the catalytic converter brace. Refer to **Catalytic Converter Brace Replacement (LEA)**.
5. Remove the steering gear heat shield. Refer to **Steering Gear Heat Shield Replacement (2.4L)** .

1	Exhaust Manifold Fastener (Qty: 3) CAUTION: Refer to Fastener Caution . Tighten 50 N.m (37 lb ft).
2	Exhaust Muffler Fastener (Qty: 2) Tighten 40 N.m (30 lb ft).
3	Catalytic Converter Bracket Clamp Fastener Tighten 50 N.m (37 lb ft).
4	Exhaust Insulator Hanger
5	Seal
6	Gasket
7	Catalytic Converter NOTE: Replace with NEW gasket and seal.

CATALYTIC CONVERTER REPLACEMENT - LEFT SIDE (LFX)

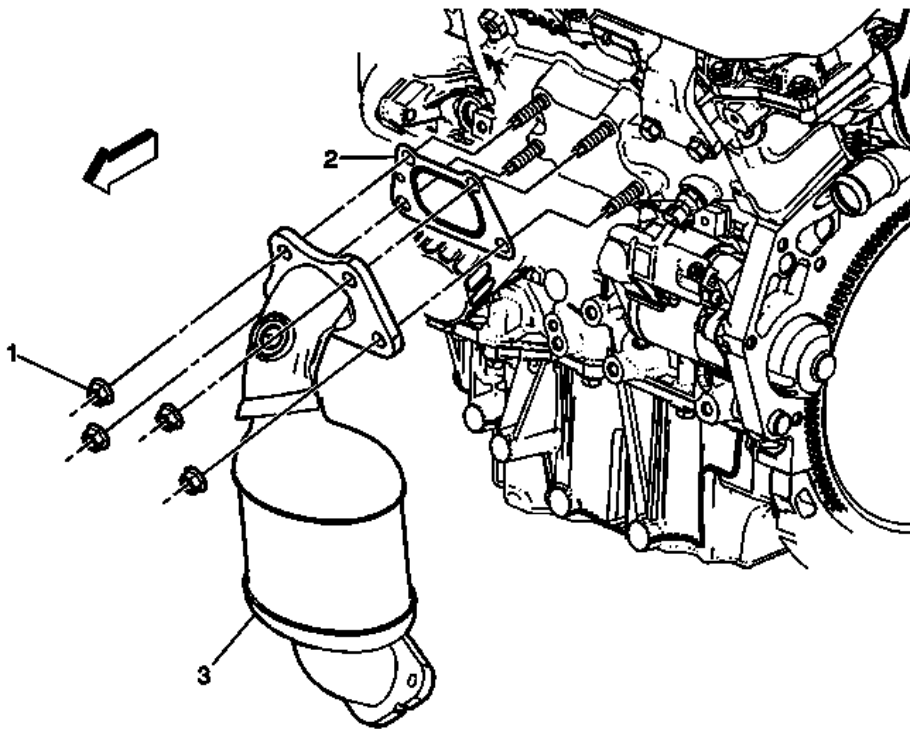

Fig. 3: Catalytic Converter - Left Side Front
 Courtesy of GENERAL MOTORS COMPANY

Catalytic Converter Replacement - Left Side (LFX)

Callout	Component Name
WARNING: Refer to Hot Exhaust System Warning .	
Preliminary Procedure	
1. Remove the catalytic converter heat shield. Refer to Catalytic Converter Heat Shield Replacement (LFX)	
2. Remove the exhaust flexible pipe. Refer to Exhaust Flexible Pipe Replacement (LFX) .	
	Catalytic Converter Nuts (Qty: 4)
	CAUTION: Refer to Fastener Caution .
	CAUTION: To prevent damage to the exhaust manifold flange or stud, make sure the flange is fully seated before tightening.
	Procedure