

## SECTION 5 FRONT ATTACHMENT

### Group 2 Cylinder

**CAUTION:** Arm cylinder (1) weight: 460 kg (1020 lb)

**IMPORTANT:** Add hydraulic oil. Start the engine and check for any oil leaks.

6. Remove the wires from the arm cylinder (1) rod side. Hoist arm cylinder (1). Start the engine. Operate the arm control lever and fit the hole at cylinder rod side to the pin (7) mounting hole on arm.

**CAUTION:** Metal fragments may fly off when a hammer is used. Wear necessary protection, such as goggles, helmets, etc in order to prevent personal injury.

7. Install pin (7).
8. Install stopper (6), bolt (5), and nuts (4) (2 used) to pin (7).

 : 30 mm

 : 400 N·m (40 kgf·m, 300 lbf·ft)

9. Connect hose (8) to arm cylinder (1).

 : 19 mm

 : 30 N·m (3 kgf·m 22 lbf·ft)

**IMPORTANT:** After completing the work, operate arm cylinder (1) several times to the stroke end and bleed air from the circuit.

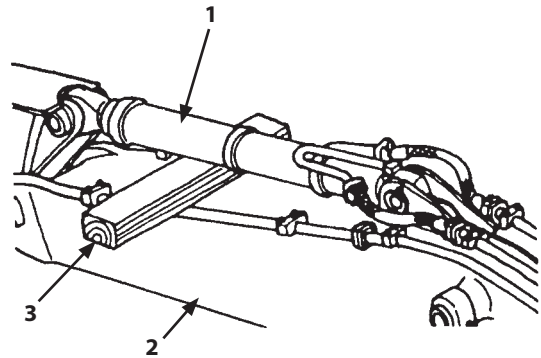

W162-04-01-008

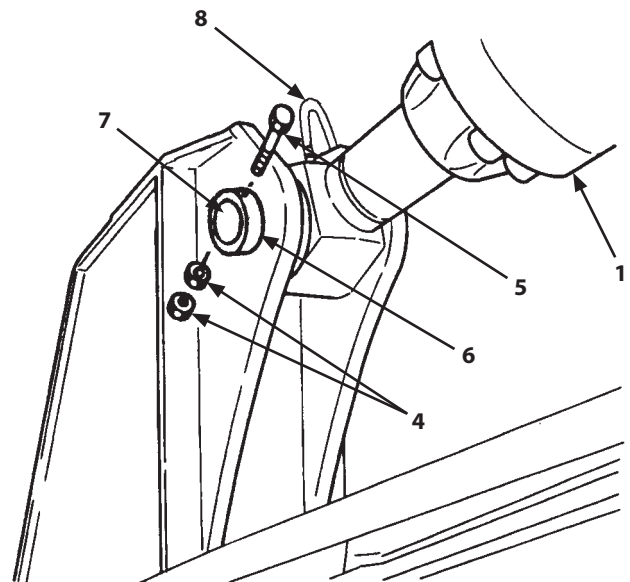

W166-04-01-004

## SECTION 5 FRONT ATTACHMENT

### Group 2 Cylinder

#### Removal and Installation of Bucket Cylinder

**IMPORTANT:** Cap the open ends in case the hoses and pipes have been disconnected. In addition, attach an identification tag onto the connectors, hoses, and pipes for assembling. Connect the hoses and install the clips in case the clips which secure the hoses have been removed.

##### Removal

1. Insert wooden blocks (3) (2 used) under the arm (2) top and between arm (2) and bucket cylinder (1).

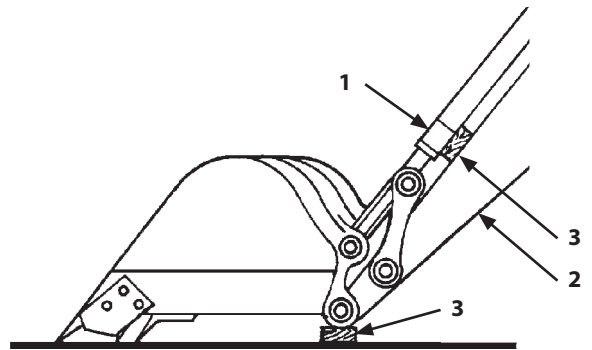

W178-02-11-287

**CAUTION:** Before removing pin (7), secure the link by using a wire in order not to fall off.

**CAUTION:** Metal fragments may fly off when a hammer is used. Wear necessary protection, such as goggles, helmets, etc in order to prevent personal injury.

2. Remove nuts (6) (2 used) and bolt (4). Remove pin (7). Remove shims (5) (several).

 : 30 mm

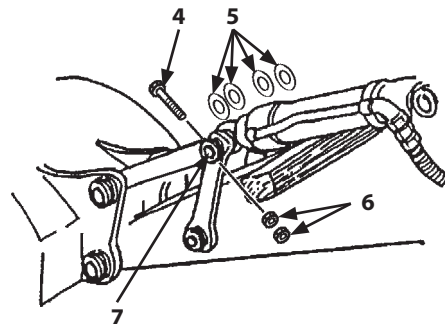

W158-04-02-006

3. Starts the engine. Operate the bucket control lever and retract bucket cylinder (1). In order not to extend the rod, pass a wire through the rod hole and secure the rod to the cylinder tube.

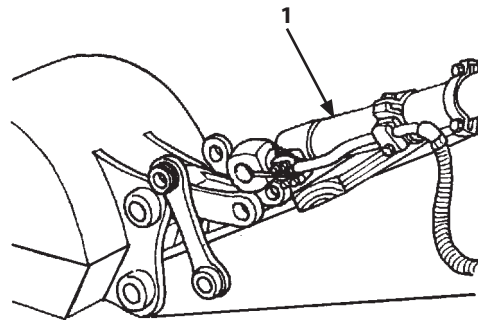

W102-04-02-005