

DAMPER REPLACEMENT

EXPLODED VIEW

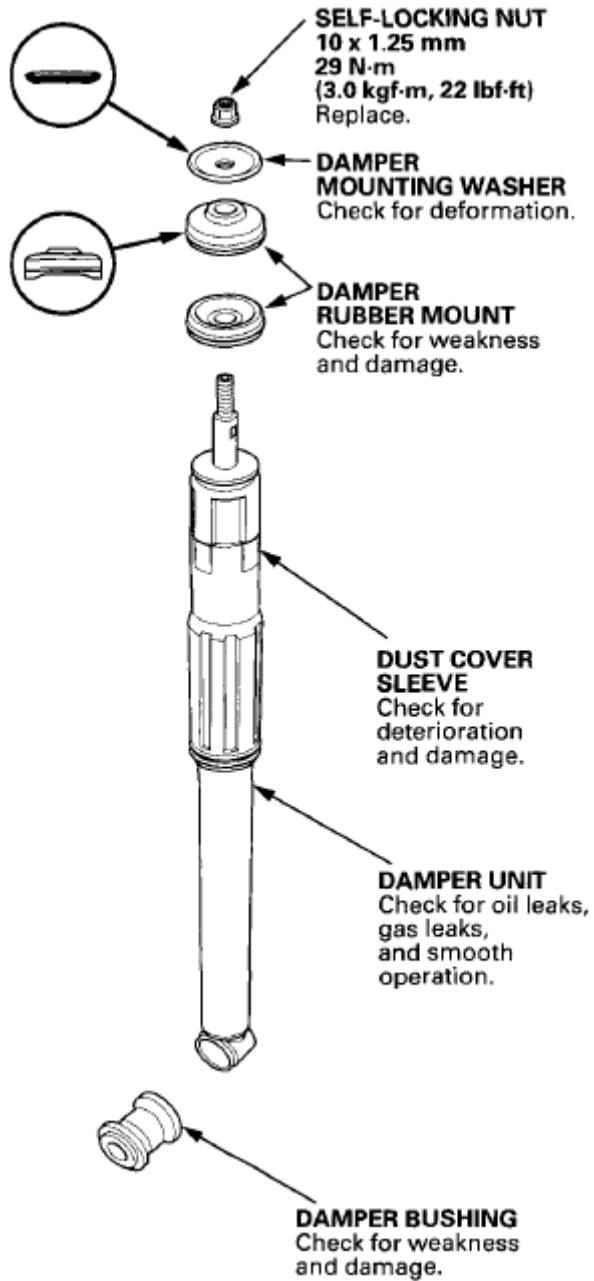

Fig. 10: Exploded View Of Damper With Torque Specifications
Courtesy of AMERICAN HONDA MOTOR CO., INC.

REMOVAL

1. Raise and support the vehicle (see **LIFT AND SUPPORT POINTS**).
2. Remove the rear wheels.
3. Remove the wheel speed sensor clip (A) and the wire guide rubber (B) from both sides of the axle beam.

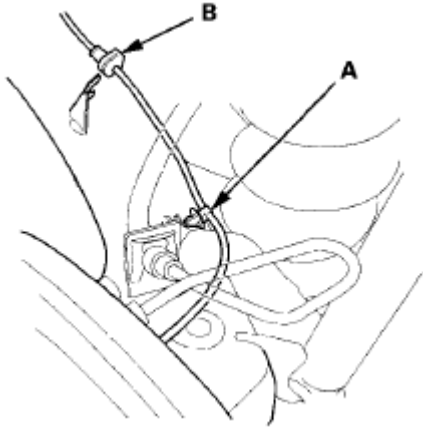

Fig. 11: Identifying Wheel Speed Sensor Clip And Wire Guide Rubber
 Courtesy of AMERICAN HONDA MOTOR CO., INC.

4. Position a floor jack under lower spring seat (A) on both sides of the axle beam (B). Raise the floor jack until the suspension begins to compress.

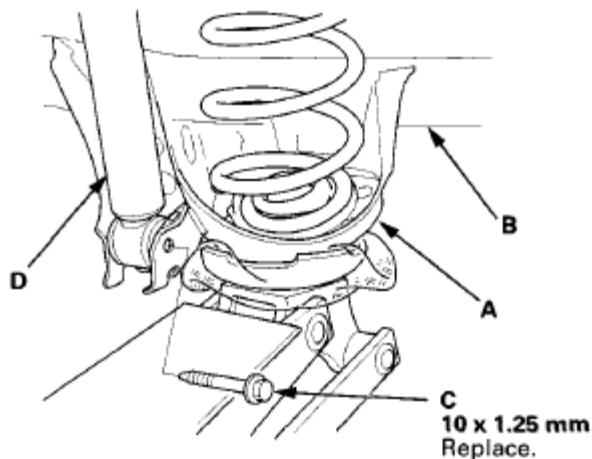

Fig. 12: Identifying Floor Jack Under Lower Spring Seat, Axle Beam, Damper Mounting Bolt And Damper
 Courtesy of AMERICAN HONDA MOTOR CO., INC.

5. Remove the damper mounting bolt (C) that connects the axle beam and the damper (D) from both sides.
6. Remove the access panel (A) on the cargo area side trim.

Left side:

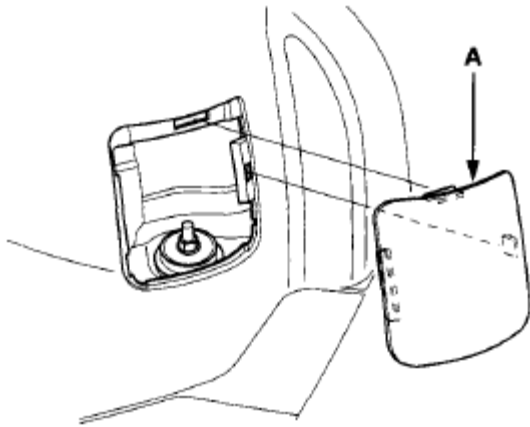

Fig. 13: Identifying Access Panel On Cargo Area Side Trim - Left Side
Courtesy of AMERICAN HONDA MOTOR CO., INC.

Right side:

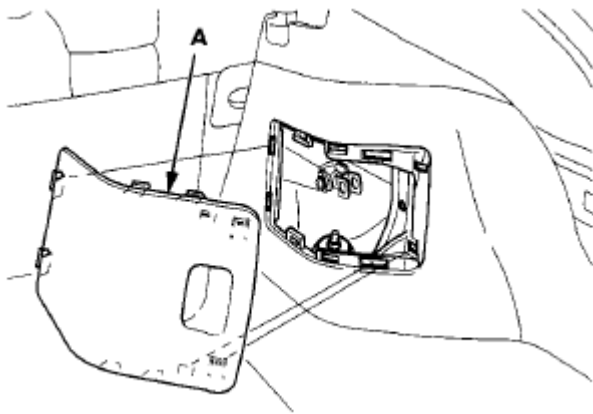

Fig. 14: Identifying Access Panel On Cargo Area Side Trim - Right Side
Courtesy of AMERICAN HONDA MOTOR CO., INC.

7. Remove the self-locking nut (A) while holding the damper shaft (B) with a hex wrench (C).

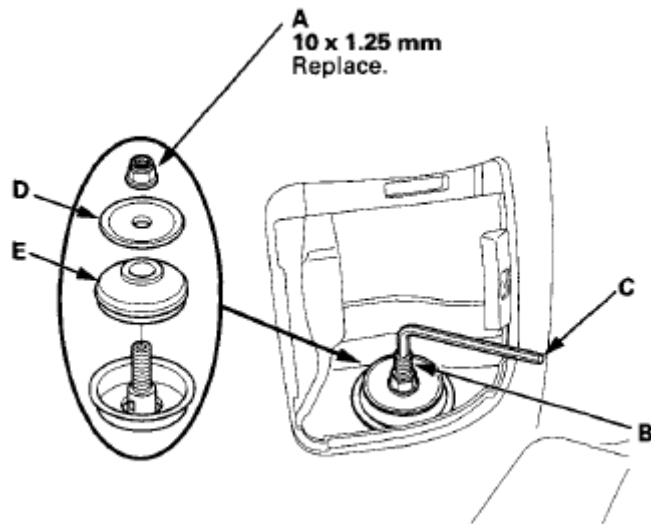

Fig. 15: Removing Self-Locking Nut While Holding Damper Shaft With Hex Wrench
Courtesy of AMERICAN HONDA MOTOR CO., INC.

8. Remove the damper mounting washer (D) and the damper rubber mount (E) from the top of the damper.
9. Compress the damper assembly (A) by hand, and remove it from the vehicle.

NOTE: Be careful not to damage the body.

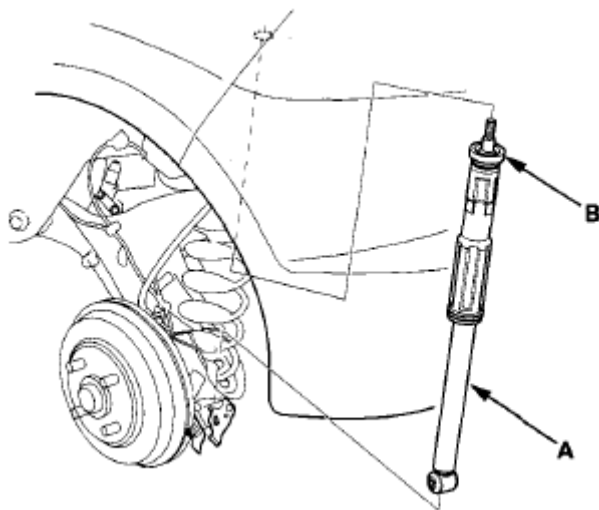

Fig. 16: Identifying Damper Assembly And Damper Rubber Mount
Courtesy of AMERICAN HONDA MOTOR CO., INC.

10. Remove the damper rubber mount (B).

INSPECTION