

2009-12 ENGINE

Intake Manifold and Exhaust System - Ridgeline

INTAKE MANIFOLD REMOVAL AND INSTALLATION

EXPLODED VIEW

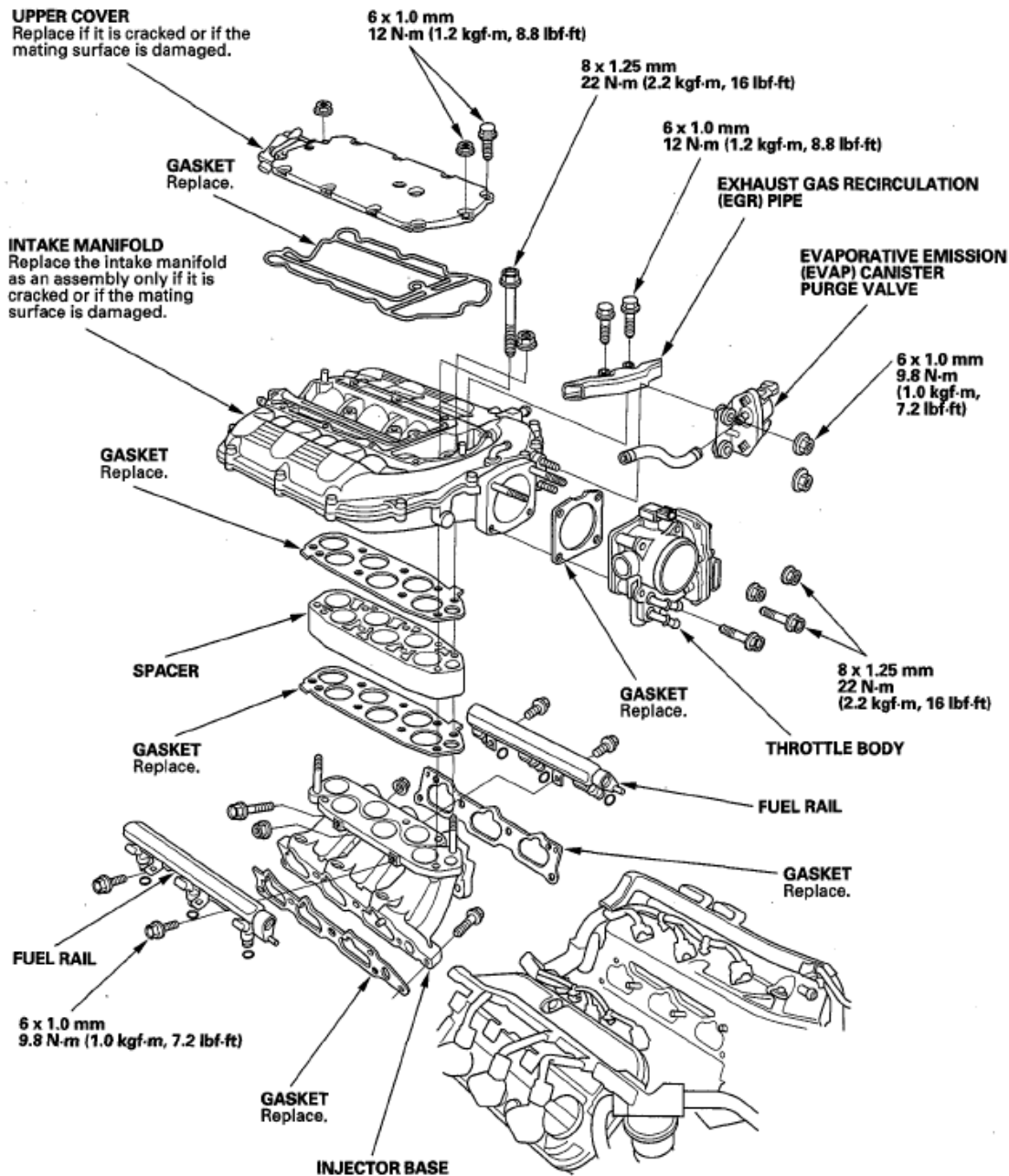

Fig. 1: Exploded View Of Intake Manifold With Torque Specifications
Courtesy of AMERICAN HONDA MOTOR CO., INC.

REMOVAL

1. Remove the engine cover.

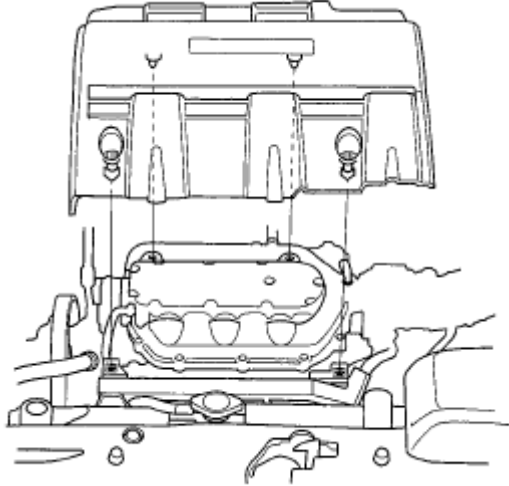

Fig. 2: Identifying Engine Cover

Courtesy of AMERICAN HONDA MOTOR CO., INC.

2. Remove the breather pipe (A), then remove the air intake duct (B).

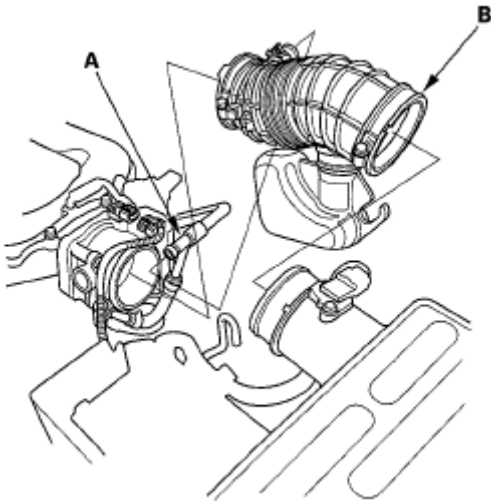

Fig. 3: Identifying Breather Pipe And Air Intake Duct

Courtesy of AMERICAN HONDA MOTOR CO., INC.

3. Disconnect the engine wire harness connectors from the intake manifold.
 - Throttle actuator connector
 - MAP sensor connector
 - EVAP canister purge valve connector

- IMT valve actuator connector

4. Disconnect the PCV hose (A), the brake booster vacuum hose (B), and the EVAP canister purge hose (C).

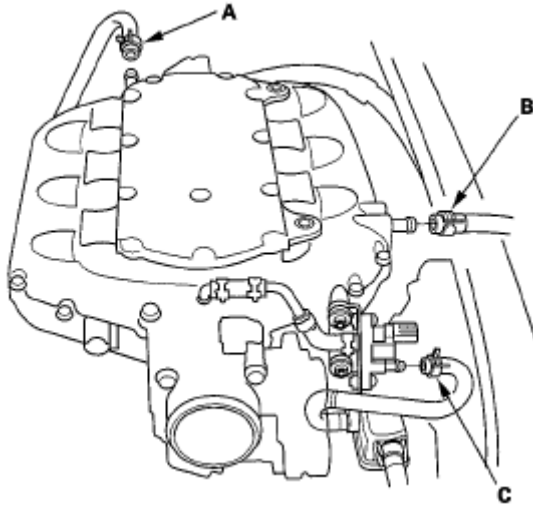

Fig. 4: Identifying Positive Crankcase Ventilation Hose, Brake Booster Vacuum Hose And Evaporative Emission Canister Purge Hose
Courtesy of AMERICAN HONDA MOTOR CO., INC.

5. Disconnect the water bypass hoses (A), then plug the water bypass hoses.

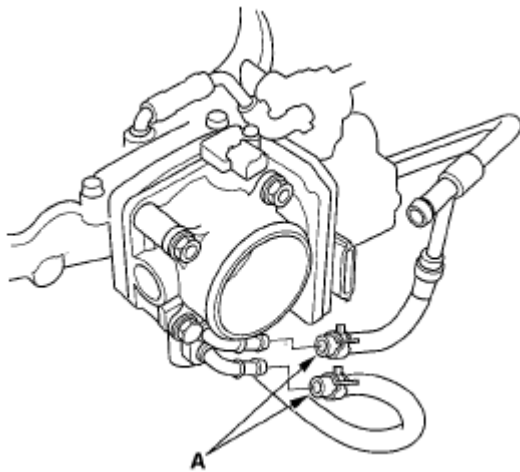

Fig. 5: Identifying Water Bypass Hoses
Courtesy of AMERICAN HONDA MOTOR CO., INC.

6. Remove the upper cover mounting bolts and nuts sequentially, in three steps, then remove the upper cover.

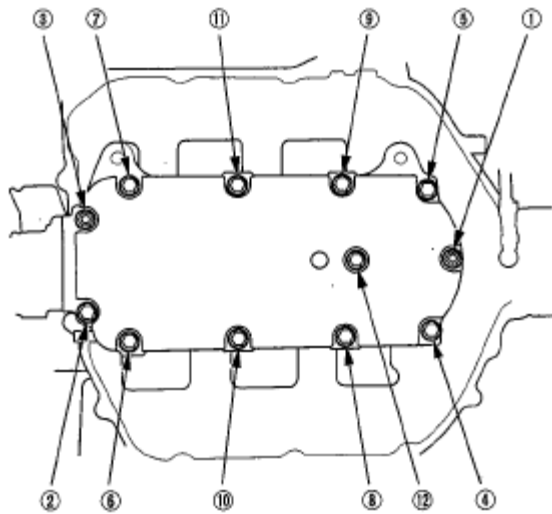

Fig. 6: Identifying Upper Cover Mounting Bolts And Nuts
Courtesy of AMERICAN HONDA MOTOR CO., INC.

7. Remove the intake manifold mounting bolts and nuts sequentially in three steps, then remove the intake manifold and the spacer.

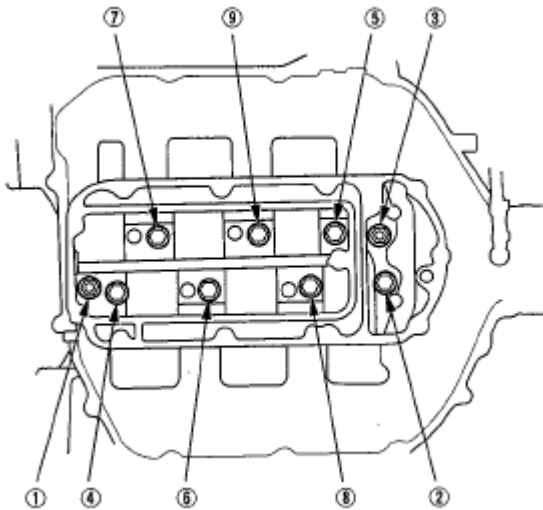

Fig. 7: Identifying Intake Manifold Mounting Bolts And Nuts
Courtesy of AMERICAN HONDA MOTOR CO., INC.

INSTALLATION

1. Put a new gasket and the spacer on the injector base.
2. Install the intake manifold. Tighten the bolts and nuts sequentially in three steps. Always use a new intake manifold gasket.

Specified Torque