

FIGURE 4. ENGINE MAINTENANCE POINTS

Fuel System

WARNING

All fuels are very flammable and can burn or cause an explosion. Do not use an open flame to check the fuel level or to check for leaks in the fuel system. If there is a leak in the fuel system, extra care must be used during the repair. Do not operate the lift truck until a leak is repaired.

Check the fuel system for leaks and the condition of parts. When fuel is added to the lift truck, see the section, **How To Add Fuel To The Lift Truck** procedures in the **OPERATING MANUAL**.

Air Filter (See FIGURE 5.)

Clean or replace the air filter as necessary. Use compressed air to clean the filter element. Air pressure must be less than 210 kPa (30 psi). Apply the air from the inside to the outside of the filter element.

Inspect the filter element. Put a bright light inside the filter element and look for holes or other damage. If the filter element is damaged, replace it with a new filter element. Use a cloth with solvent to clean the inside of the canister when the filter element is replaced.

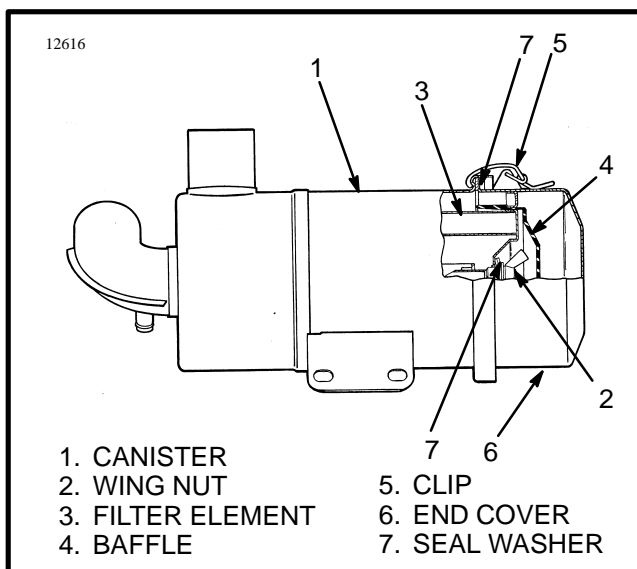

FIGURE 5. AIR FILTER

Hydraulic System Oil (See FIGURE 6.)

WARNING

At operating temperature the hydraulic oil is **HOT**. Do not permit the hot oil to touch the skin and cause a burn.

CAUTION

Do not permit dirt to enter the hydraulic system when the oil level is checked or the filter is changed.

Never operate the hydraulic pump without oil in the hydraulic system. The operation of the hydraulic pump without oil will damage the pump.

Check the hydraulic oil level when the oil is at operating temperature, the carriage is lowered and the engine is stopped. Add hydraulic oil only as needed. If more hydraulic oil is added than the "FULL" level, the hydraulic oil will leak from the breather during operation. The oil level indicated by the dipstick is most accurate when the oil temperature is 53 to 93°C (130 to 200°F).

Check the hydraulic system for leaks and damaged or loose components.

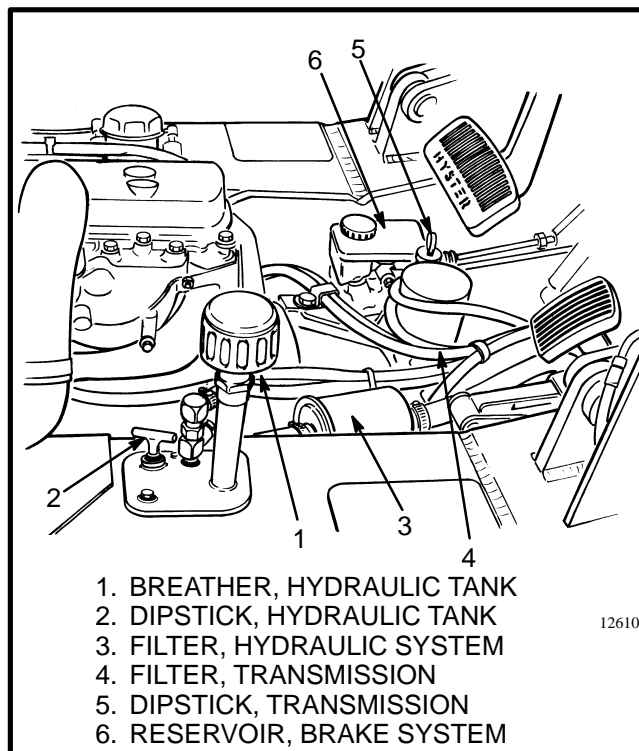

FIGURE 6. FILTERS AND SYSTEM CHECK POINTS