

4. Remove the cover for the solenoids. Remove the wires from the solenoids. Remove the solenoids. Remove the spools and springs.

**WARNING**

Compressed springs can cause injury to the user or to other personnel. Wear eye protection.

5. The cover plate is under spring pressure. Remove two capscrews at opposite corners. Replace these capscrews with longer capscrews and wing nuts. With the other capscrews removed, slowly loosen the wing nuts to remove the cover plate. Remove the springs and spools.
6. Remove the stop plate.
7. Remove the plugs and check balls.

CLEAN AND INSPECT**WARNING**

Cleaning solvents can be flammable and toxic and can cause skin irritation. When using cleaning solvents, always follow the solvent manufacturer's recommended safety precautions.

Clean all of the parts in solvent. Inspect the spools, bores, and springs for damage. Make sure the spools move freely in the bores.

ASSEMBLE

Lubricate all parts with transmission oil. Use new O-rings on the plugs. Assemble the control valve as shown in Figure 6. During assembly, make sure that all spools move freely in their bores. Connect the wires to the solenoids as shown in Figure 7.

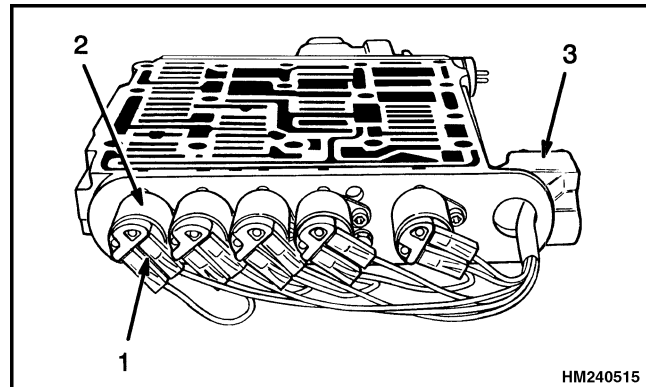

1. WIRE HARNESS
2. SOLENOID
3. HARNESS CONNECTOR

Figure 7. Solenoid Wire Harness

INSTALL

1. Install two alignment pins in the housing. Install the gaskets, cover plate and port plate. Install the capscrews and tighten them to 16 N•m (12 lbf ft). See Figure 1 and Figure 9.
2. Install the gaskets and cover plate. Install the control valve assembly. Tighten the capscrews for the control valve to 20 N•m (15 lbf ft).
3. Connect the oil lines between the port plate and the clutch shafts as shown in Figure 8. Install the oil lines at the control valve.
4. Connect the wire harness.

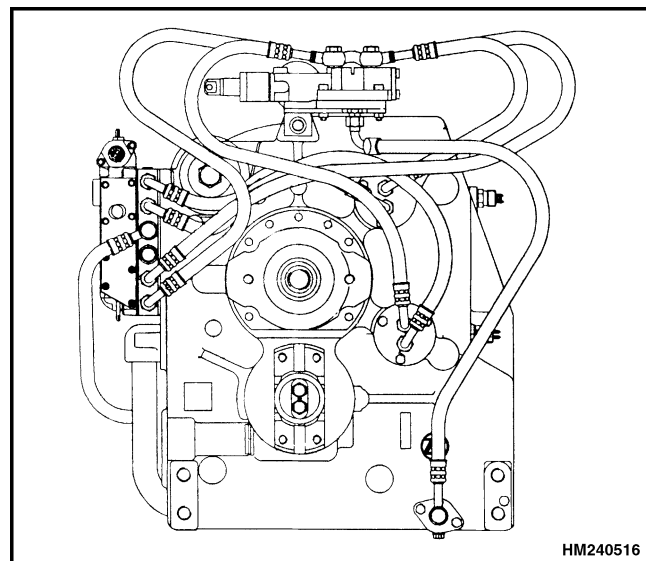
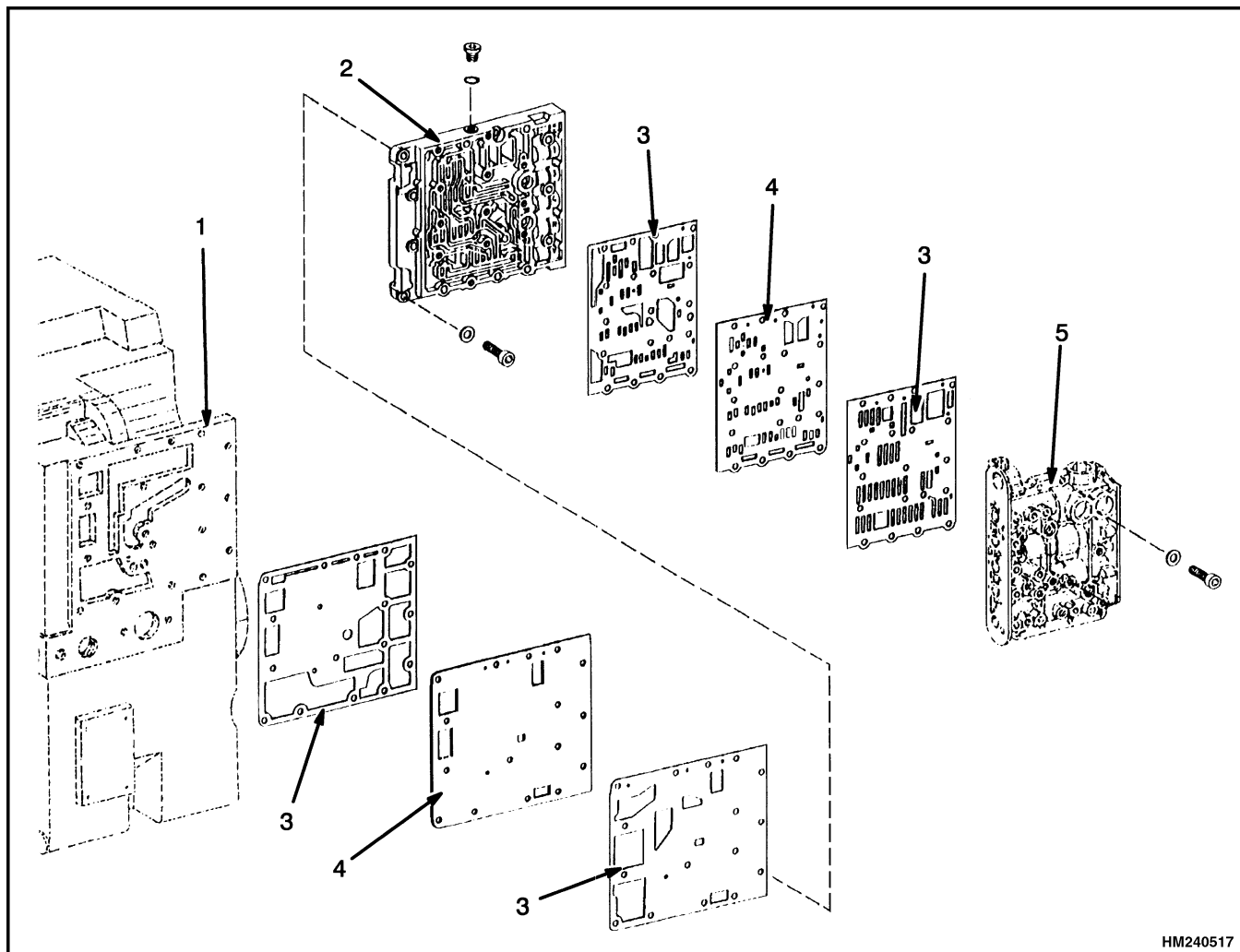

Figure 8. Oil Line Arrangement



HM240517

1. TRANSMISSION HOUSING
2. PORT PLATE
3. GASKET
4. COVER PLATE
5. CONTROL VALVE

Figure 9. Control Valve Mounting

Inching Valve Repair

REMOVE

1. Put tags on the oil lines for identification. Disconnect the oil lines at the inching valves. Disconnect the linkage at the inching spool. See Figure 10.
2. Remove the capscrews that hold the inching valve to the bracket.

DISASSEMBLE

1. Remove the retainer for the inching spool. See Figure 10.
2. Remove the housing for the inching plunger. Remove the plunger, guide, gasket and the seal. Remove the pilot spool, spring and washer.
3. Remove the cover for the inching spool. Remove the spring and the inching spool.