

7. Remove the CMP retaining screws. Remove the CMP. See Figure 33.

INSTALL



CAUTION

Do not use the old cap, CMP sensor, and rotor screws. Use the replacement screws that have been coated with a thread locking compound.

1. Insert the CMP sensor through the reluctor wheel slot. See Figure 33.
2. Install new CMP mounting screws and tighten to 2.2 N•m (19 lbf in). See Figure 33.
3. Install the rotor onto the reluctor wheel. See Figure 31.
4. Install new rotor retaining screws and tighten to 2 N•m (18 lbf in). See Figure 30.
5. Install the distributor cap and new distributor capscrews. See Figure 29.
6. Connect the CMP sensor harness connector. See Figure 28.

7. Connect the spark plug wires and ignition coil wire. Refer to Spark Plug Wire Replacement and Figure 27.

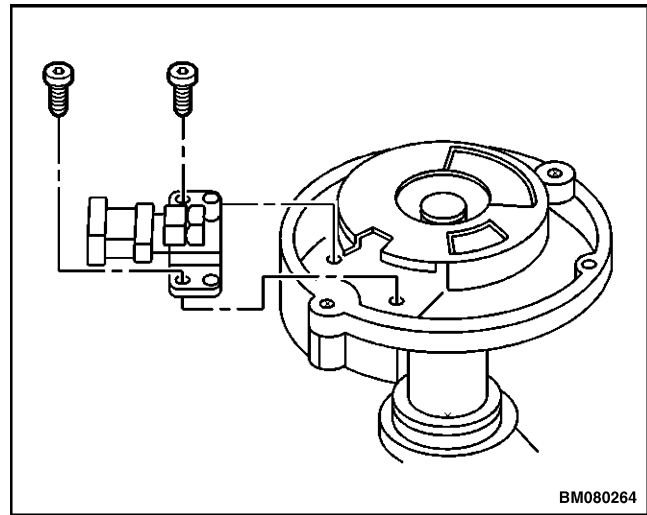

Figure 33. Camshaft Position Sensor Remove/Install

Crankshaft Position (CKP) Sensor Replacement

REMOVE

1. Disconnect the crankshaft position (CKP) sensor harness connector. See Figure 34.
2. Remove the CKP sensor mounting bolt. See Figure 35.
3. Remove the CKP sensor. See Figure 36.

INSTALL



CAUTION

When installing the CKP sensor, make sure the sensor is fully seated before tightening the mounting bolt. A poorly seated CKP sensor may perform erratically and may set false DTCs.

NOTE: Do not reuse the original O-ring.

1. Replace the CKP sensor O-ring.

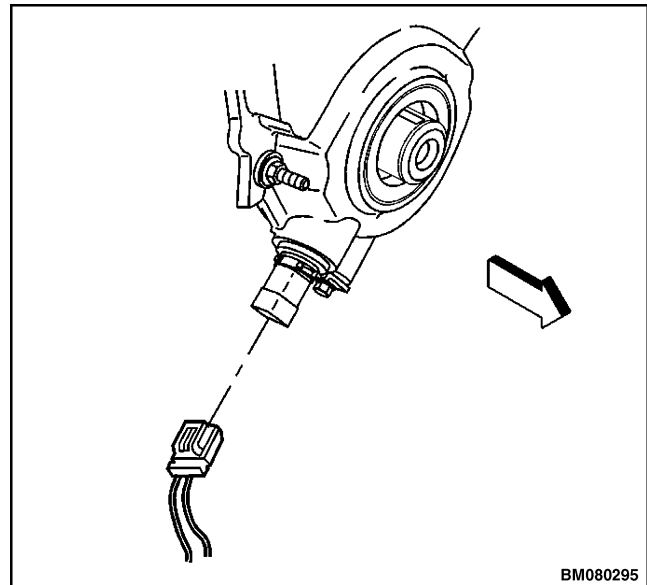

Figure 34. Crankshaft Position (CKP) Sensor Harness

2. Lubricate the O-ring with clean engine oil before installing the CKP sensor.

NOTE: Make sure the CKP sensor mounting surface is clean and free of burrs.

3. Install the CKP sensor. See Figure 36.



CAUTION

Late model engines use a combination of standard and metric fasteners. The components affected are the starter motor, engine mounts, and flywheel housing mounting. Other components may also have a combination of fasteners. Always verify that the proper fasteners are used whenever removing or replacing any components.

4. Install the CKP sensor mounting bolt and tighten the CKP sensor mounting bolt to 9 N•m (80 lbf in). See Figure 35.
5. Connect the CKP sensor harness connector. See Figure 34.

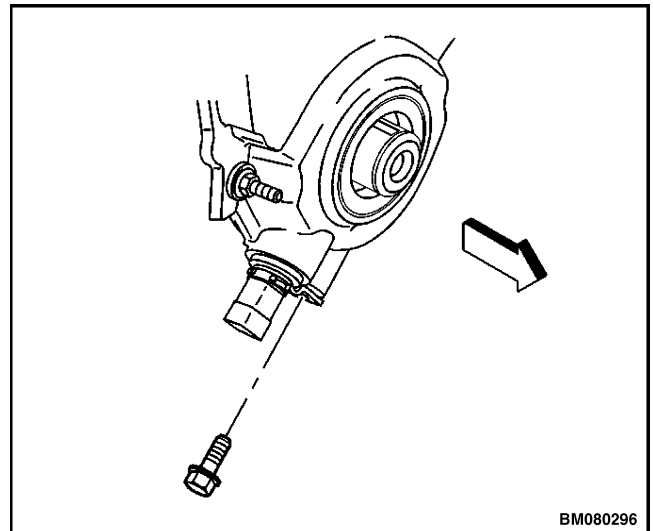

Figure 35. Crankshaft Position (CKP) Sensor Mounting Bolt

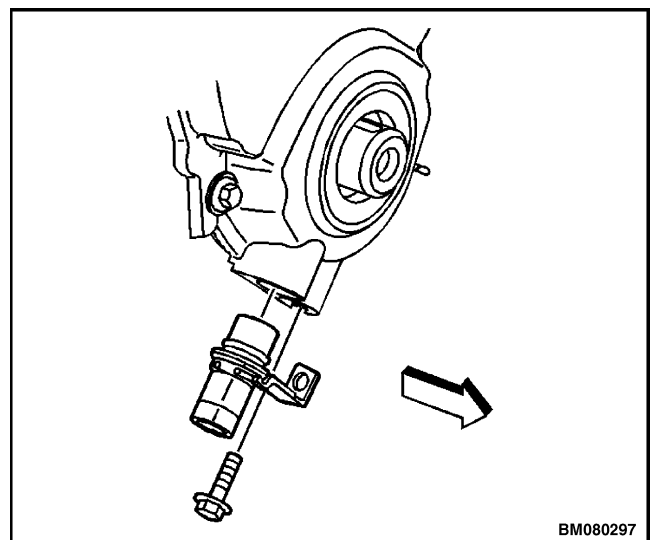

Figure 36. Crankshaft Position (CKP) Sensor Remove/Install