

**Caution:**

Do not touch the glass portion of the new bulb with your fingers.

**Headlight Replacement**

**Removal**

Preparation: Disconnect the battery ground cable.

1. Remove the battery ground cable at the battery.
2. Remove the seal rubber (3).
  - Remove the seal rubber from beneath the headlight.
3. Remove the front combination light (2).
  - Open the cab door. Insert a screwdriver (1) into the space between the cab and the cab door. Use the screwdriver to force out the stud pin at the center of the grommet (the pin securing the front combination light).

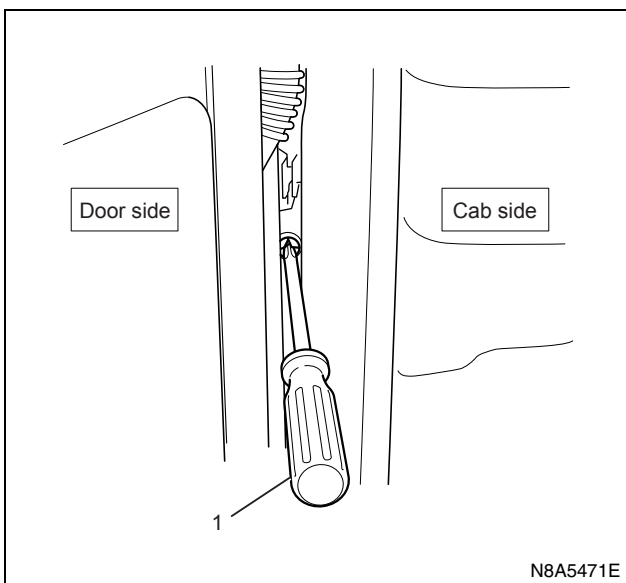

- Remove the fixing screw.
- Remove the two catches.

- Remove the front combination light connector.
4. Remove the front grille (4).
    - Remove the bolt at the center of the front grille.
    - Remove the four clips securing the front grille.
    - The grille is secured by 4 clips (2 clips at the inside of each headlight). Pull the grille toward you to remove it.
  5. Remove the front corner panel.
  6. Remove the headlight (1).
    - Remove the four bolts securing the headlight (loosen the fixing bolts at the bottom of the front side panel to create working space).
    - Remove the headlight clips.
    - Remove the headlight connector.

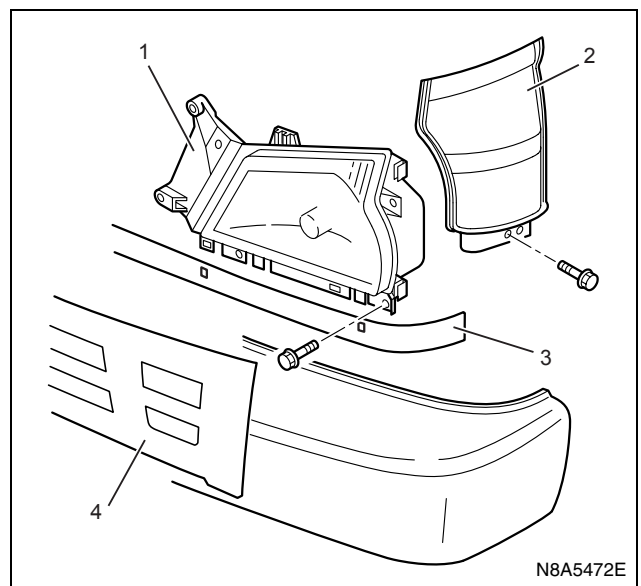

**Installation**

1. Assemble the headlight assembly (1).
  - Connect the connector.
  - Fix it to body panel with four bolts (5).
2. Assemble the front panel side. (Refer to "DOOR" in section 2.)
3. Install the front grille (4).
4. Install the front combination assembly (2).
  - 1) Position it by aligning two pawls with the groove of H/L.
  - 2) Fit the iron PIN in the upper portion by aligning it with the center of corresponding grommet.

**Notice:**

Push it into securely with a force of approx. 250 N (25 kgf) until click is heard.

- 3) Pull the front combination light assembly lightly toward the front of vehicle to make sure that the PIN and grommet are engaged securely.
- 4) Tighten one bolt (6) in the lower portion of front combination light assembly.
- 5) Hook the seal rubber (3) on two projections under H/L.

5. Connect the battery ground cable.
6. Check the operation and lighting of each lamp.

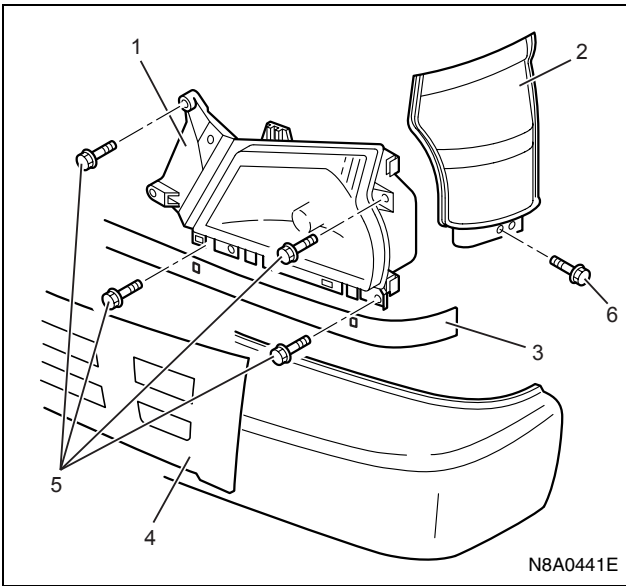

### Aiming of Headlight

Preparation: Place the unloaded vehicle on a level surface and check to see if the inflation pressure of the tires is correct, the lenses are clean, and the battery is sufficiently charged. Adjust the aim with the headlight tester. When adjusting, follow the procedure of the tester manufacturer's.

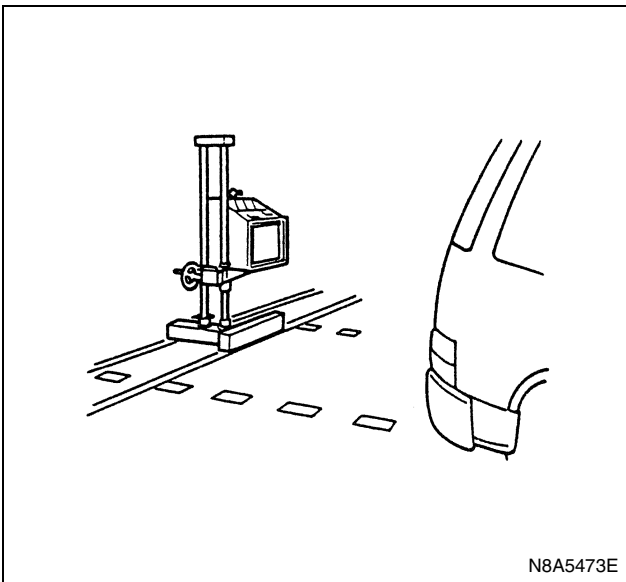

### Vertical Adjustment

Insert the tip of a screwdriver into the hole beneath the headlight (the shaft of the screwdriver must be slanted up) until contact is made with the head of the adjusting screw. Turn the screw to adjust headlight focus up or down.

Two vertical aim screws should be turned in the same direction at the same time to adjust aiming.

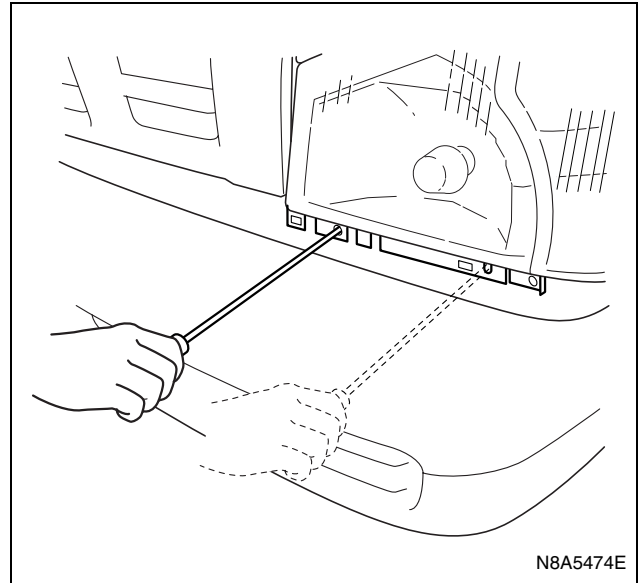

### Horizontal Adjustment

Insert the tip of a screwdriver into the hole beneath the headlight (the shaft of the screwdriver must be slanted up) until contact is made with the head of the adjusting screw. Turn the screw to adjust headlight focus to the left or right.

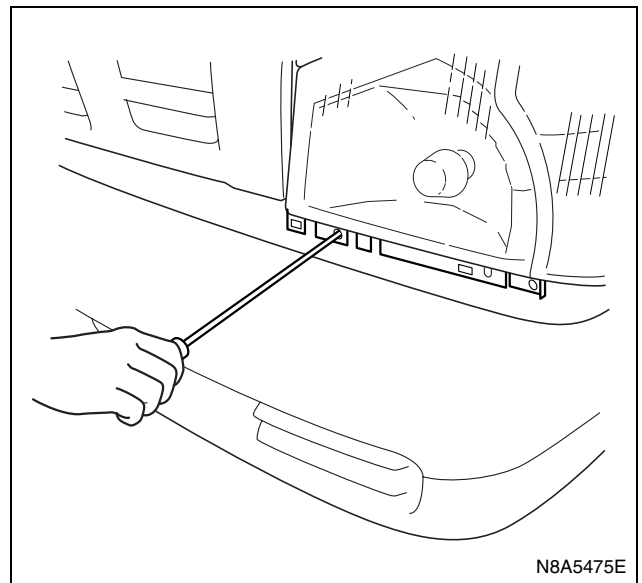

## Cornering Light Bulb Replacement

### Removal

1. Remove the battery ground cable at the battery.
2. Remove the front combination light.
  - Open the cab door. Insert a screwdriver (1) into the space between the cab and the cab door. Use the screwdriver to force out the stud pin at the center of the grommet (the pin securing the front combination light).

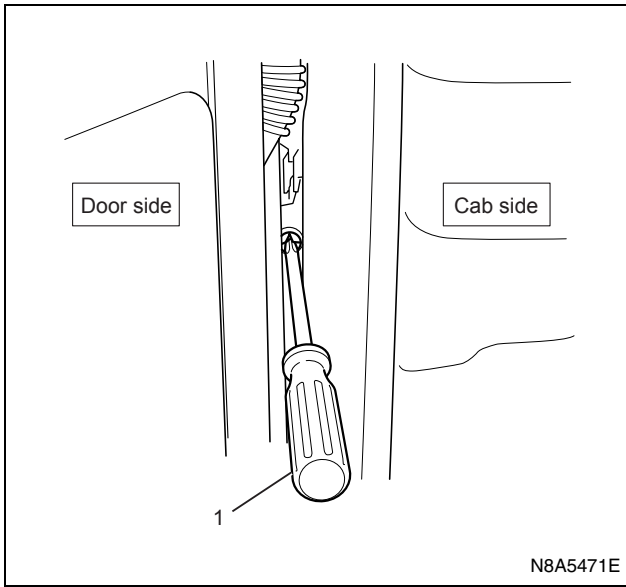

- Remove the fixing screw.
- Remove the two catches.
- Remove the front combination light (1) connector.

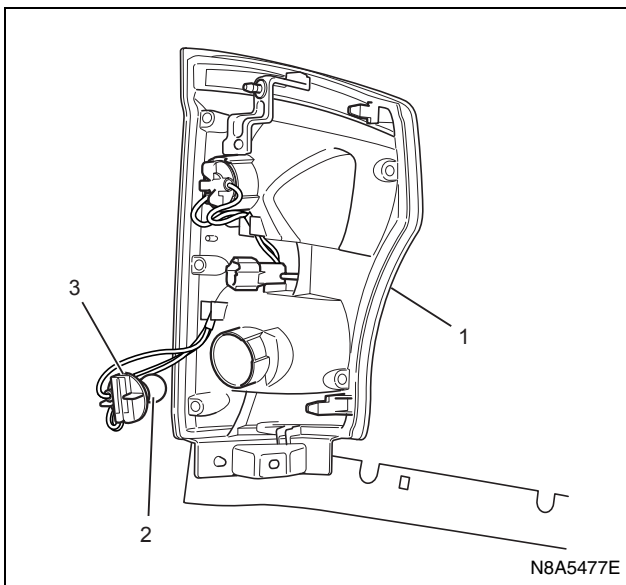

3. Remove the cornering light bulb.
  - Turn the cornering / clearance bulb socket (3) to the left to remove it.
  - Press the bulb (2) in and turn it to the left to remove it from the socket.

### Installation

1. Install the cornering / clearance bulb.
  - While pressing the bulb (2), turn it clockwise to fit.

### Notice:

Do not let the glass portion dirty with sebum etc.

- Turn the bulb socket (3) clockwise to fit.

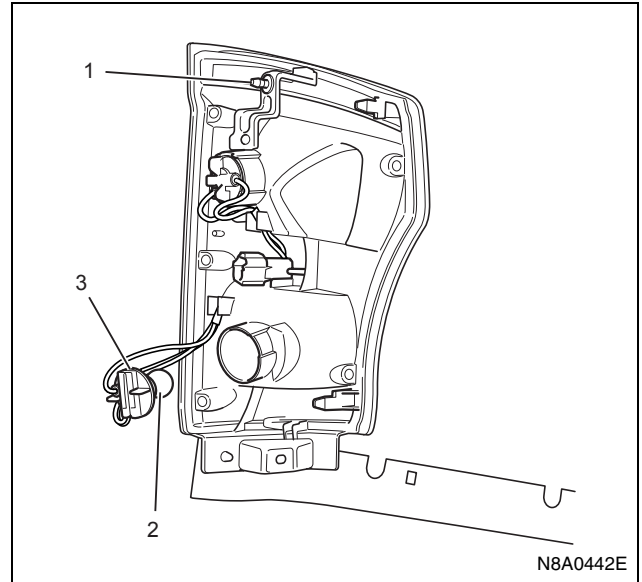

2. Installation procedure of front combination light assembly
  - Connect the connector of the front combination light assembly.
  - Position it by aligning two pawls with the groove of H/L.
  - Fit the iron PIN (1) in the upper portion of the side by aligning it with the center of corresponding grommet.

### Notice:

Push it into securely with a force of approx. 250 N (25 kgf) until click is heard.

- Pull the front combination light assembly lightly toward the front of vehicle to make sure that the PIN and grommet are engaged securely.
  - Tighten one bolt in the lower portion of front combination light assembly.
3. Hook the seal rubber on two projections under H/L.
  4. Connect the battery ground cable.
  5. Check lighting of each light.

## Fog Light Bulb

### Notice:

The configuration of the fog light assembly is different in each manufacturer.

### Removal

1. Remove the battery ground cable at the battery.
2. Remove the screws (1).
3. Remove the cover which holds fog light assembly. (If equipped)
4. Remove the connector (3).
5. Remove the fog light assembly (2).

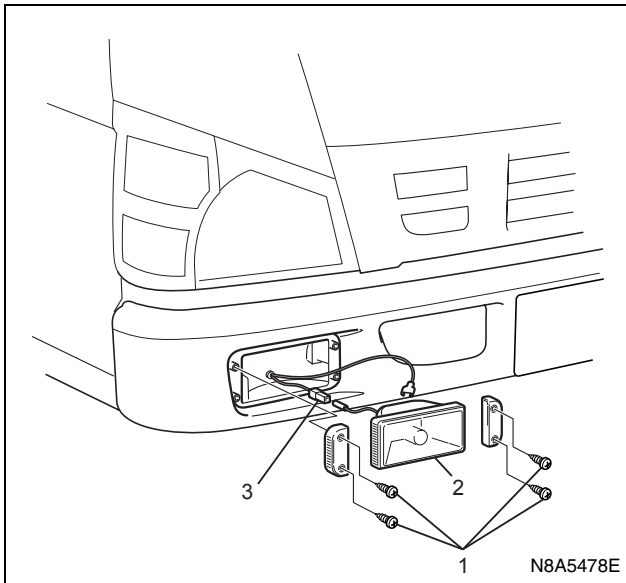

### 6. Bulb

- Remove the back cover. (If equipped)
- Push the clip (1) inward as arrow to remove.
- Remove the bulb (2).

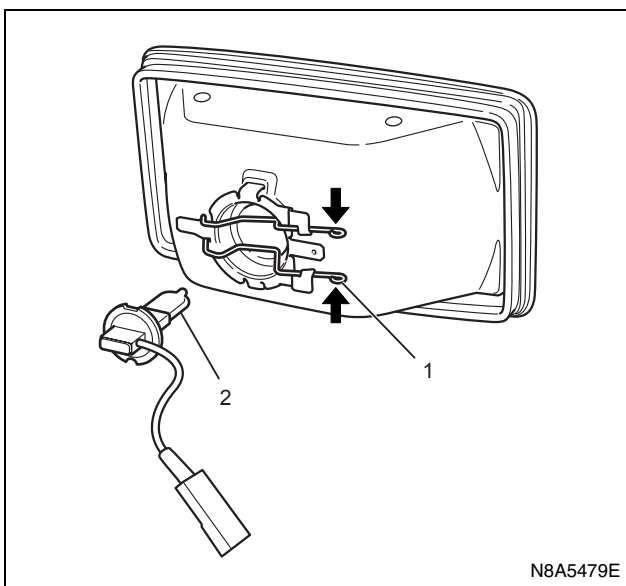

### Installation

1. Install the fog light bulb.
  - Set the fog light bulb (2).

- Hook the clip (1) to secure fog light bulb.
- Install the back cover. (If equipped)

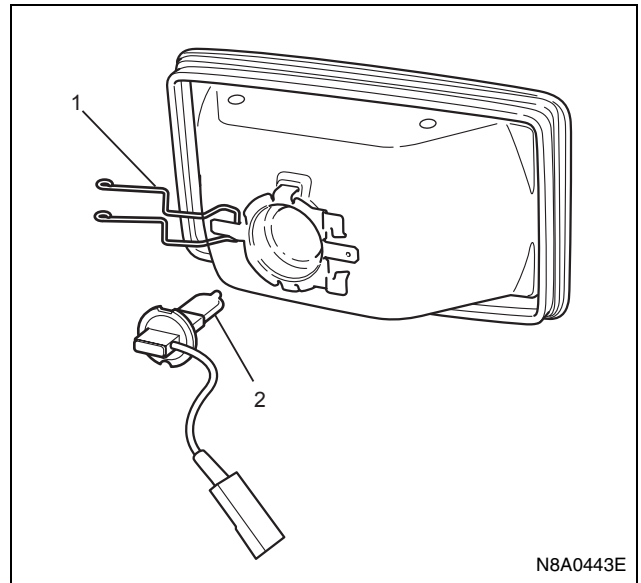

2. Connect the two locations of connector (4).
3. Install the fog light assembly.
  - Hold the fog light (2) with right and left covers (1) and secure it with screws (3). (If equipped)

### Notice:

Make sure that "TOP" mark on the lens comes upside.

4. Connect the battery ground cable.
5. Check lighting.

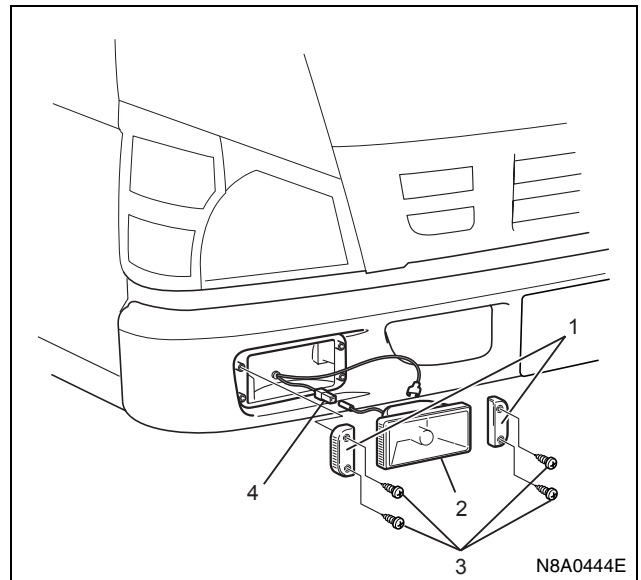

**Fog Light Switch**

**Inspection**

Check the continuity between the connector terminals while operating the switch.  
 Replace the switch when the result of inspection is found abnormal.

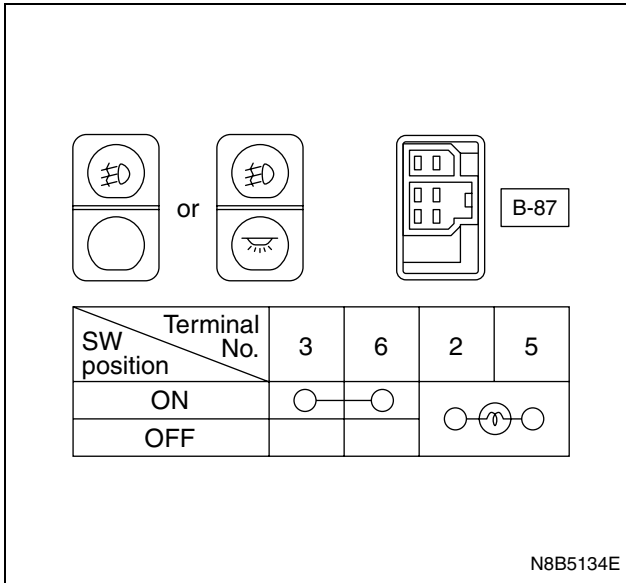

**Removal**

**Preparation:**

Disconnect the battery ground cable.

1. Meter Cluster  
 Refer to "METER AND WARNING/INDICATOR LIGHT" in this section.
2. Fog Light Switch  
 Release the lock pushing the switch from the back side of the meter cluster.

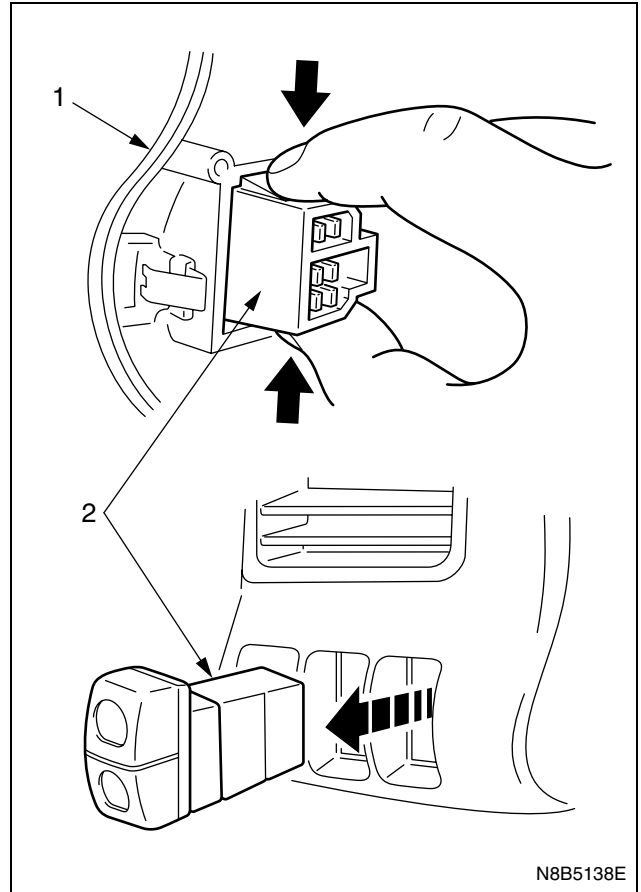

**Installation**

To install, follow the removal steps in the reverse order.

**Combination Switch (Lighting Switch, Dimmer/Passing Switch, Cornering Light Switch and Rear Fog Light Switch)**

**Inspection**

Check the continuity between the connector terminals while operating the switch.  
 Replace the switch when the result of inspection is found abnormal.

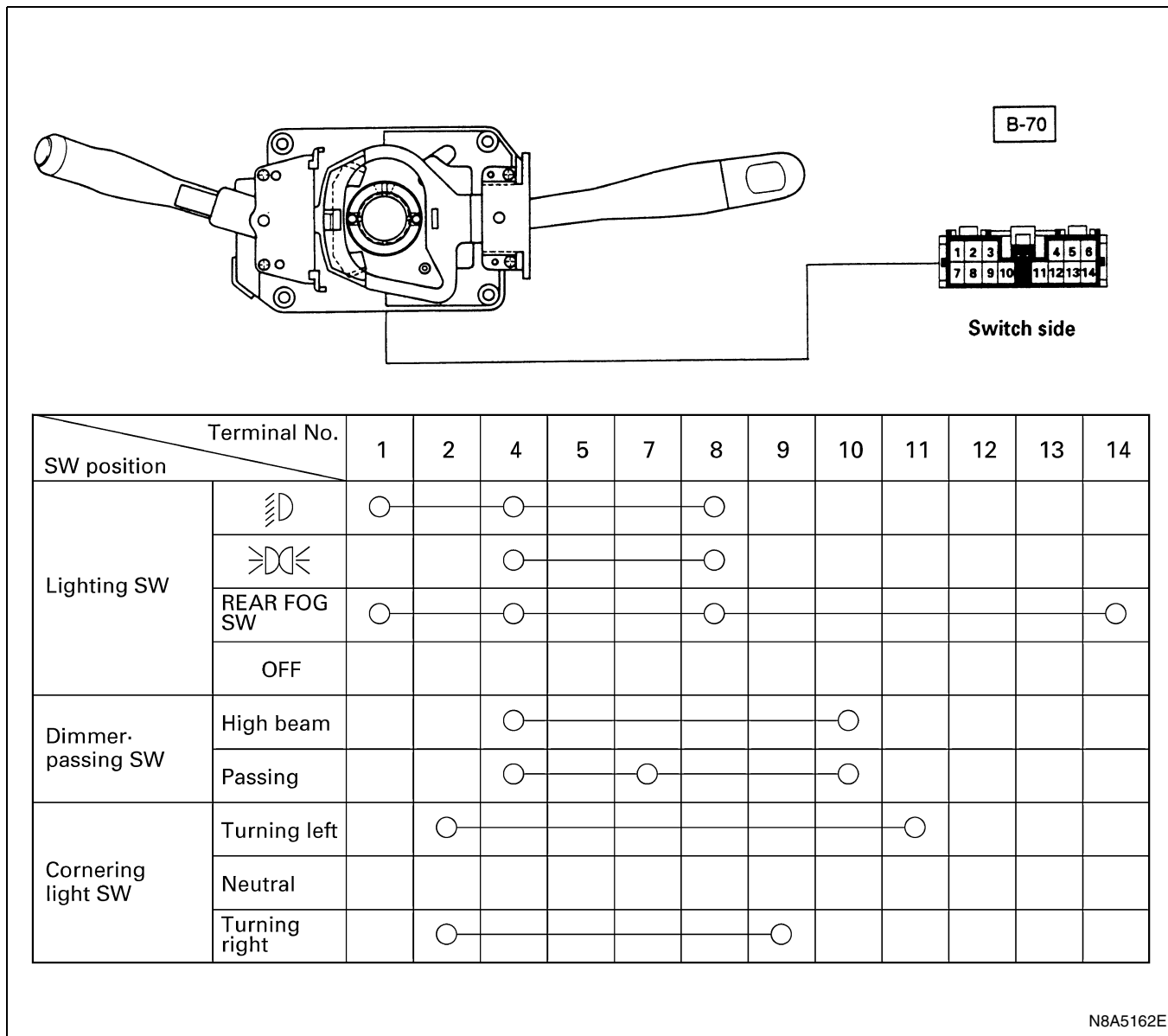

**Removal**

**Preparation:**

Disconnect the battery ground cable.

1. Horn Pad
  - 1) Hold the horn pad and pull it upward.
2. Steering Wheel
  - 1) Remove the steering shaft nut.
  - 2) Remove the steering wheel by using steering wheel remover.  
 (Refer to Section 3B4 "STEERING COLUMN" for steering wheel removal steps.)
3. Steering Cowl
  - Remove the four screws.

4. Combination Switch

- 1) Remove the four screws.
- 2) Disconnect the connector.

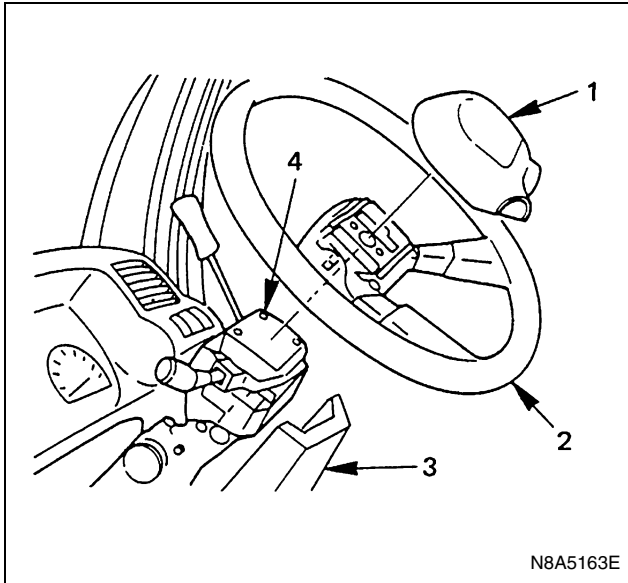

**Installation**

To install, follow the removal steps in the reverse order, noting the following point.

1. Tighten the steering shaft nut to the specified torque.

**Tighten:**

Shaft nut to 49 N·m (5 kgf·m / 36 lbf·ft)

**Headlight Leveling**

**General Description**

The circuit consists of starter SW, headlight leveling SW and headlight leveling actuator.

When the headlight leveling SW is operated with the starter SW at ON position, the actuator is operated to change the angle of the optical axis of the headlight.

**Operation of The Circuit**

**Notice:**

Arrow marks indicate the direction of current.

1. When headlight leveling SW is turned to “1” position

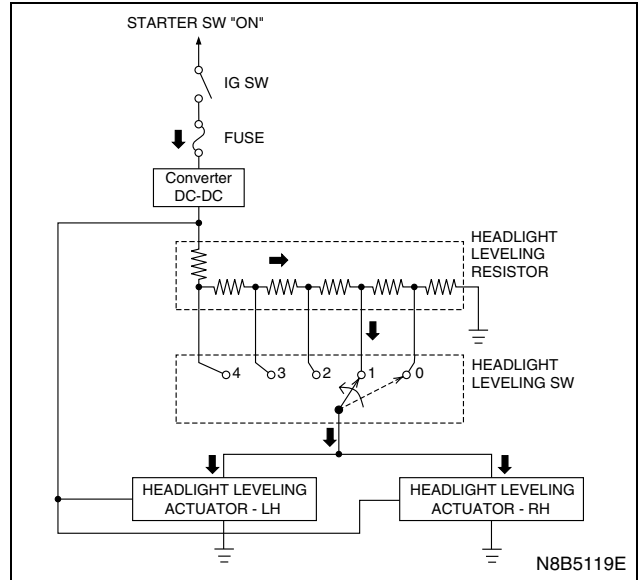

2. When headlight leveling SW is turned to “0” position

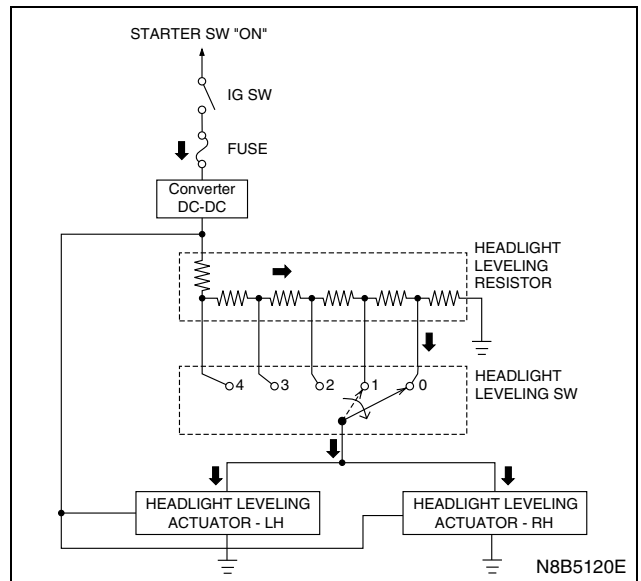

Parts Location

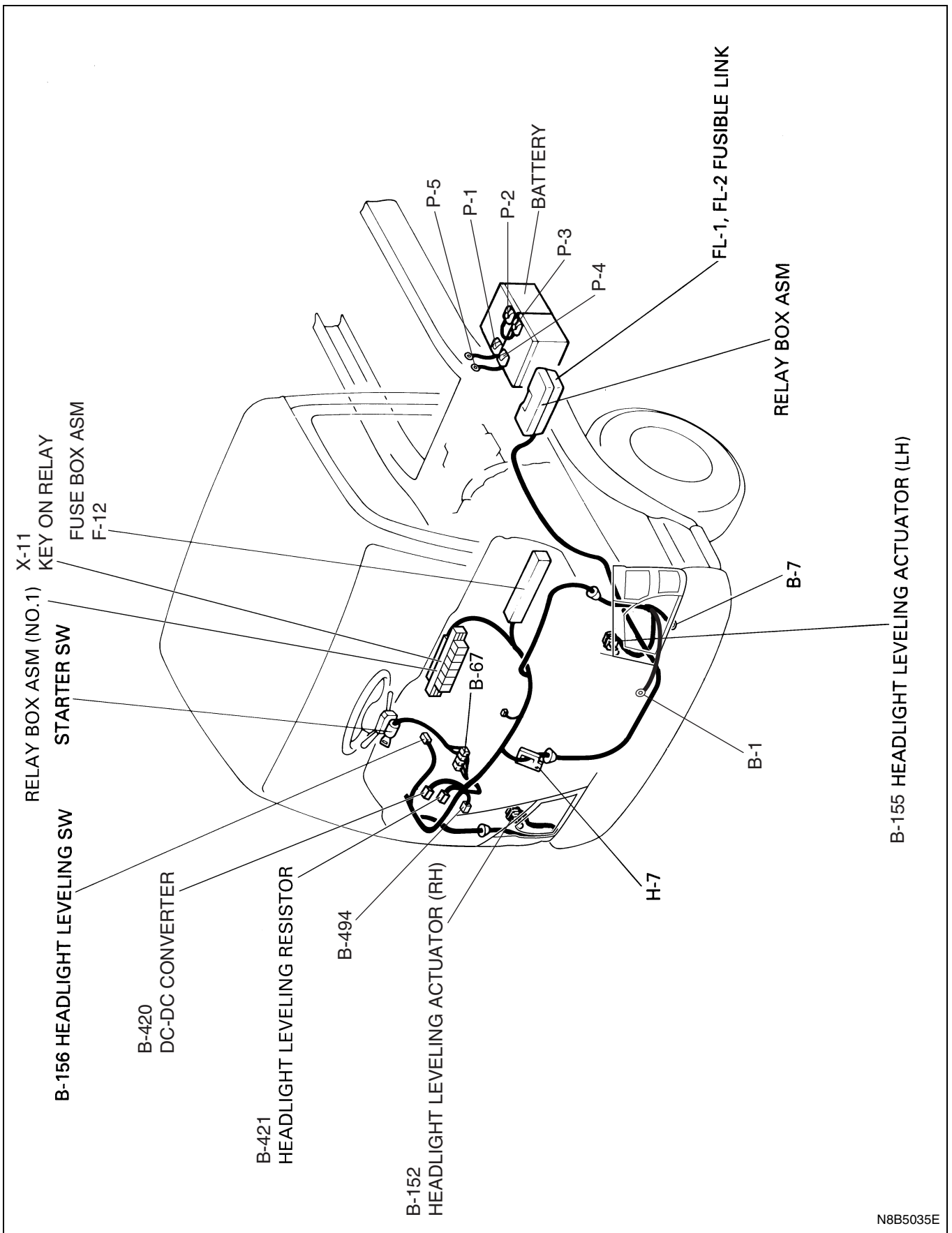





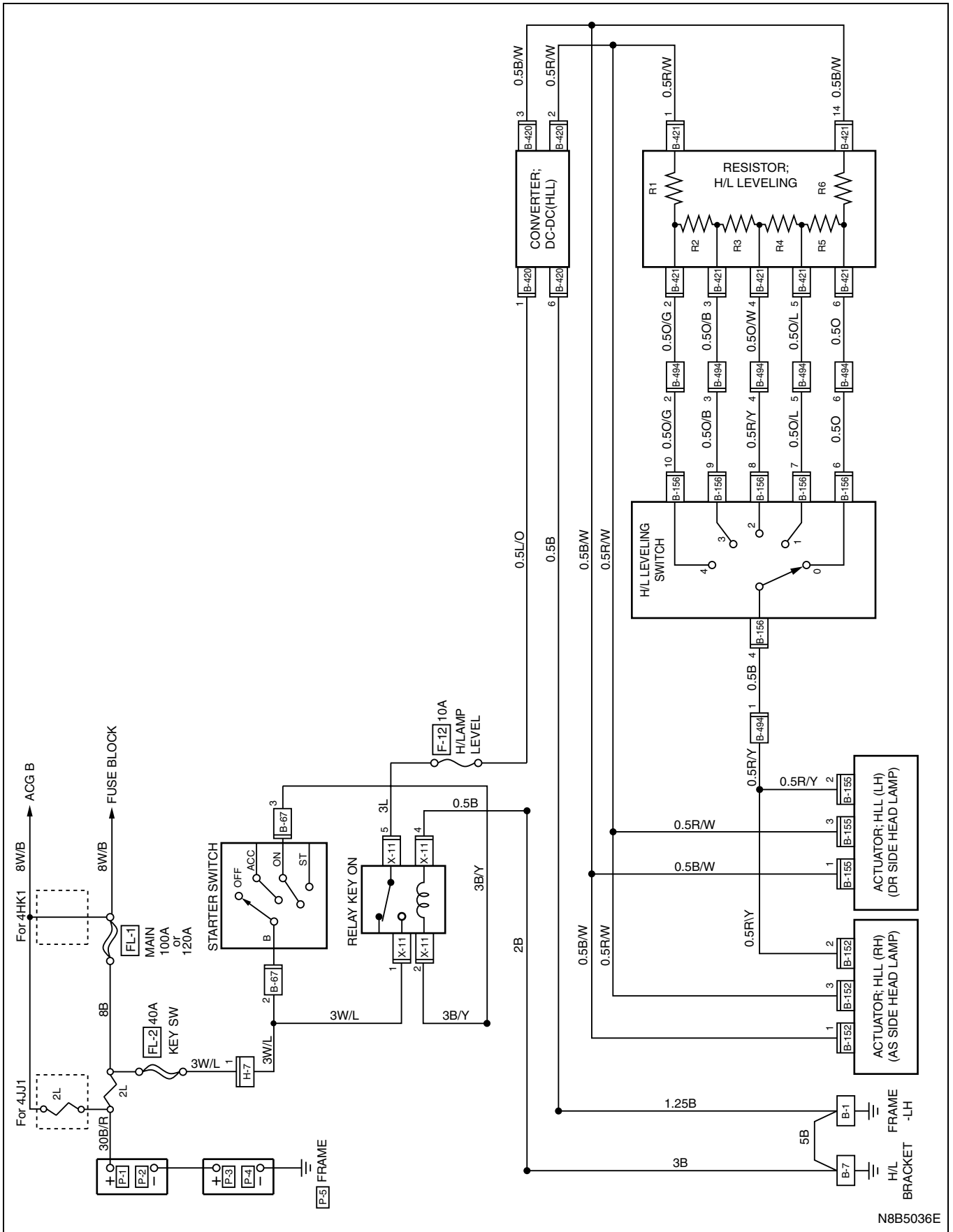

Circuit Diagram



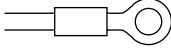
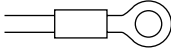

N8B5036E

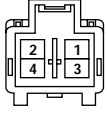
# 8-122 CAB AND CHASSIS ELECTRICAL

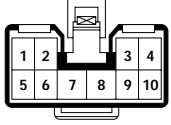
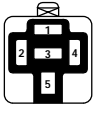
## Connector List

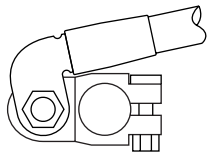
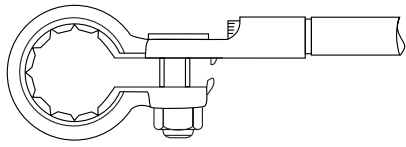
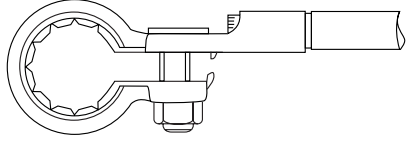
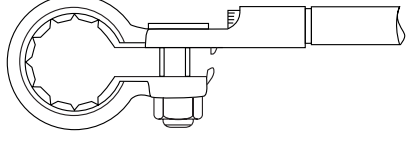
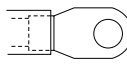
No.	Connector Face
B-1	 <p style="text-align: right;">000-001</p>
B-7	 <p style="text-align: right;">000-001</p>
B-67	 <p style="text-align: right;">004-001</p>
B-67	 <p style="text-align: right;">004-002</p>
B-152	 <p style="text-align: right;">003-016</p>
B-155	 <p style="text-align: right;">003-016</p>
B-156	 <p style="text-align: right;">010-002</p>
X-11	 <p style="text-align: right;">005-001</p>

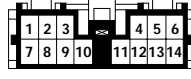
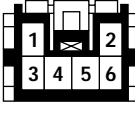
No.	Connector Face
P-1	 <p style="text-align: right;">000-022</p>
P-2	 <p style="text-align: right;">000-014</p>
P-3	 <p style="text-align: right;">000-014</p>
P-4	 <p style="text-align: right;">000-014</p>
P-5	 <p style="text-align: right;">000-002</p>
B-420	 <p style="text-align: right;">006-019</p>
B-421	 <p style="text-align: right;">014-002</p>
B-494	 <p style="text-align: right;">006-002</p>

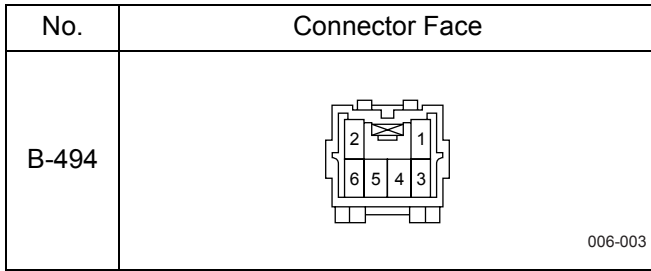

**H-7**

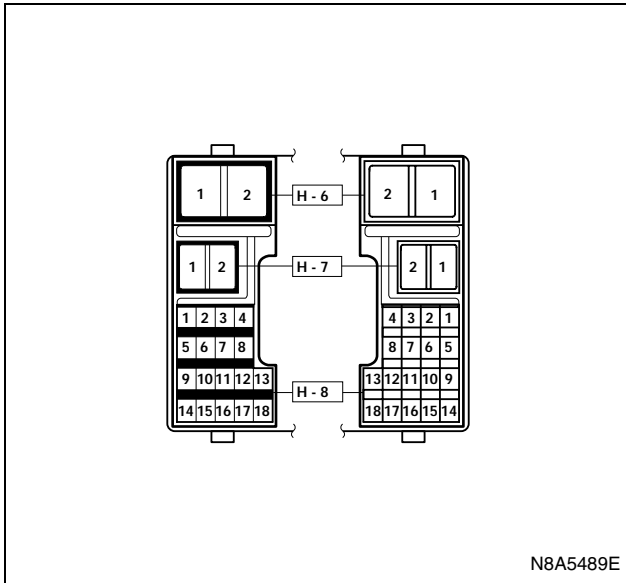

**Diagnosis**

**Quick Chart for Check Points**

		Check point					
		Fuse F-12 (10 A)	DC-DC converter	Headlight leveling resistor	Headlight leveling switch	Headlight leveling actuator	Cable harness
Trouble mode	1. Both actuators inoperative	○ (1)	○ (2)	○ (3)	○ (4)		○ (5)
	2. Actuator on the left (right) side inoperative					○ (1)	○ (2)
	3. When leveling SW is turned to a certain position, actuator inoperative			○ (1)	○ (2)	○ (3)	○ (4)

**Notice:**

Figure in parenthesis “( )” indicates the order of inspection.