

12-2 SUSPENSION

Exploded View

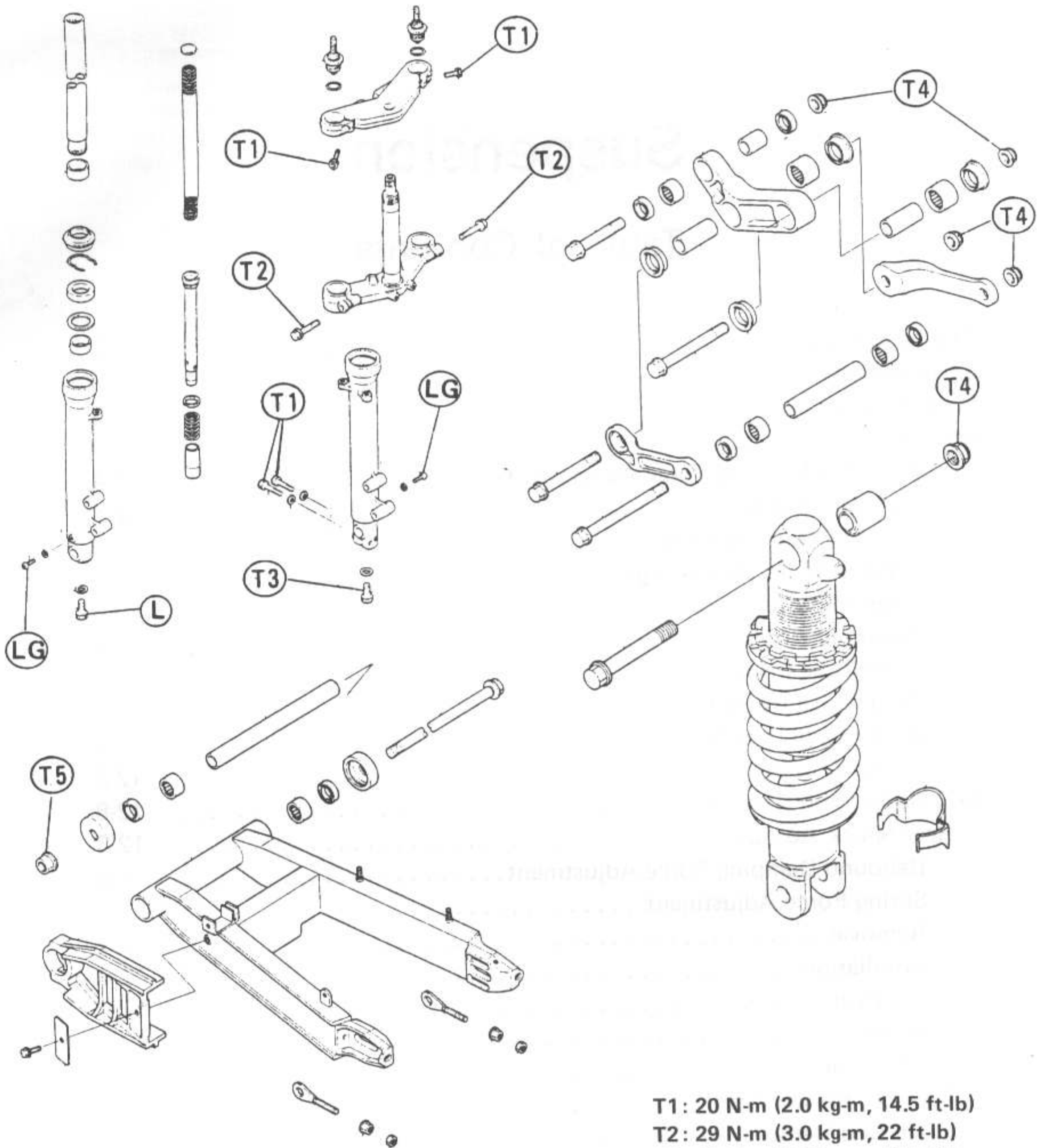

- T1: 20 N-m (2.0 kg-m, 14.5 ft-lb)
- T2: 29 N-m (3.0 kg-m, 22 ft-lb)
- T3: 61 N-m (6.2 kg-m, 45 ft-lb)
- T4: 49 N-m (5.0 kg-m, 36 ft-lb)
- T5: 93 N-m (9.5 kg-m, 69 ft-lb)

Specifications

Item	Standard	Service Limit
Front Fork:		
Oil type	SAE10W20	---
Oil capacity	421 ±4 mL (when assembling) approx. 355 mL (when oil changing)	---
Oil level (full compressed, without main spring)	125 ±2 mm	---
Fork spring free length	450.7 mm	442 mm
Fork spring force	6th mark from the top	---
Rear Shock Absorber:		
Rebound damping force adjuster setting position	No. 2	---
Spring force	Spring free length minus 10 mm	Spring free length minus 0 to 25 mm

Special Tools

Front Fork Cylinder Handle: 57001-183

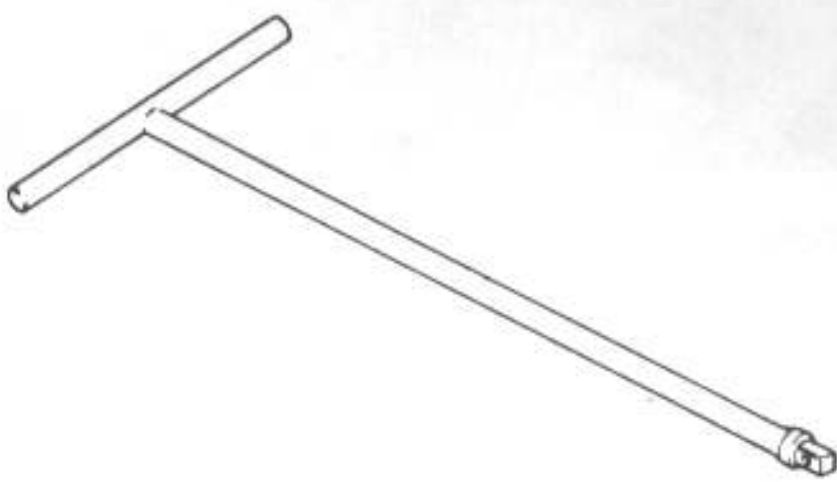

Fork Oil Seal Driver: 57001-1219

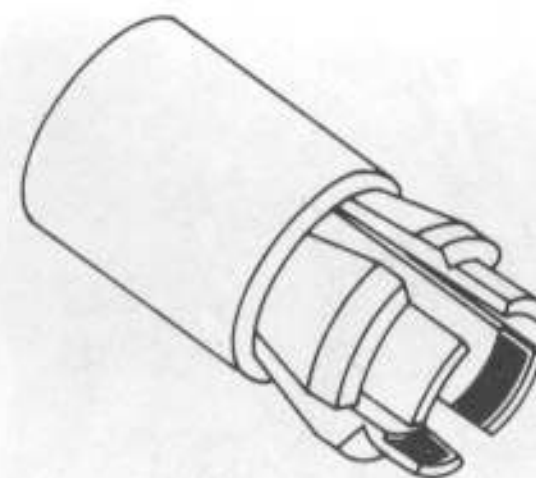

Adapter: 57001-1057



Hook Wrench: 57001-1101

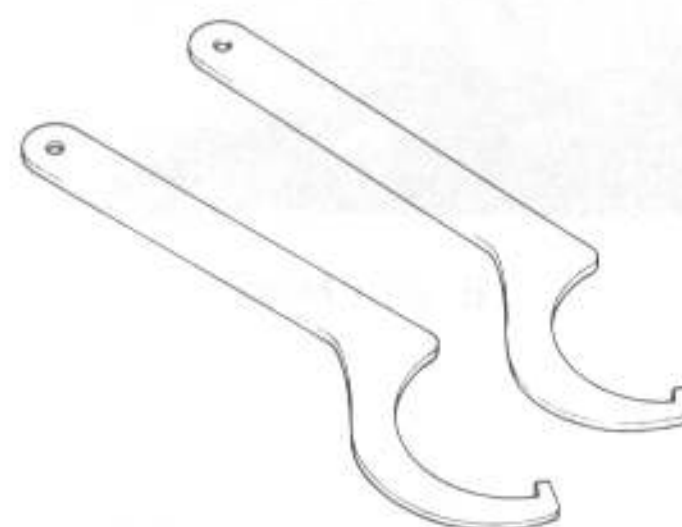

Fork Outer Tube Weight: 57001-1218

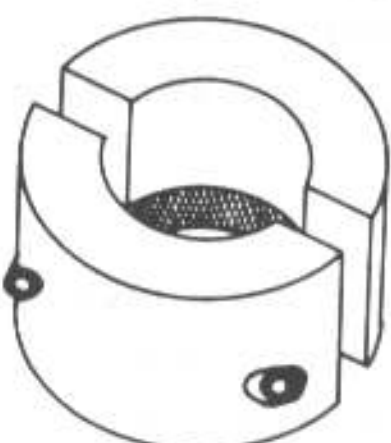

12-4 SUSPENSION

Front Fork

Front Fork Spring Force Adjustment

- Turn the adjuster in to increase spring force and out to decrease spring force.

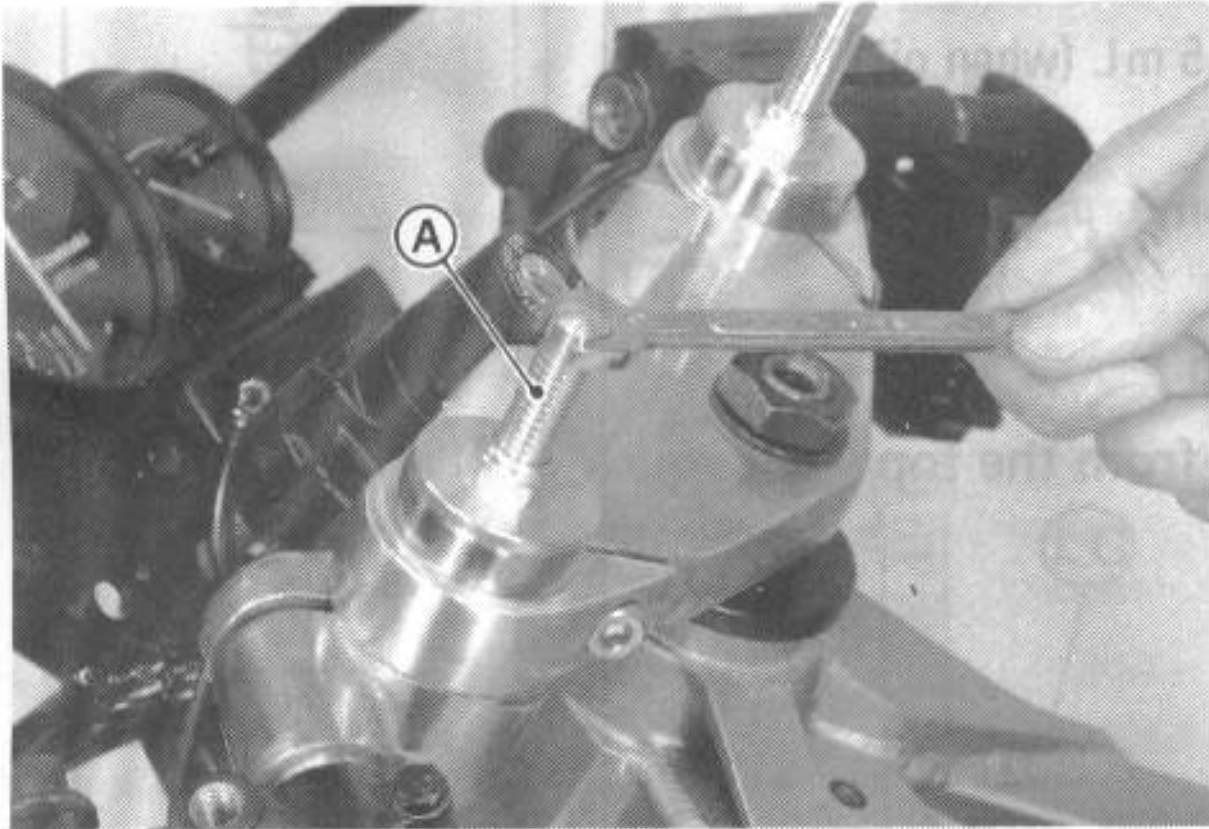

A. Adjuster

- The standard setting position of the adjuster for the average-build rider with no passenger and no accessories is the 6th mark from the top.

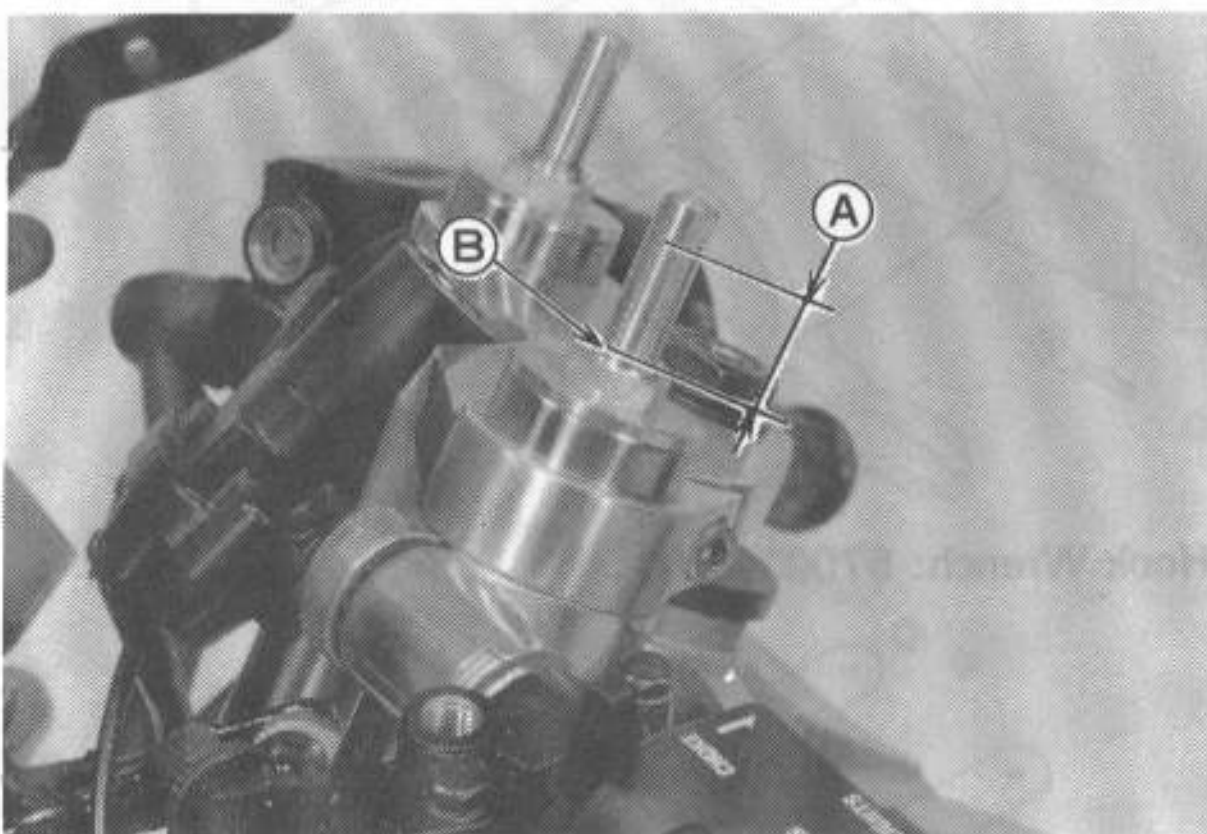

A. Marks

B. 6th Mark

Fork Oil Change

- Set the motorcycle on its side stand.
- Remove the following.

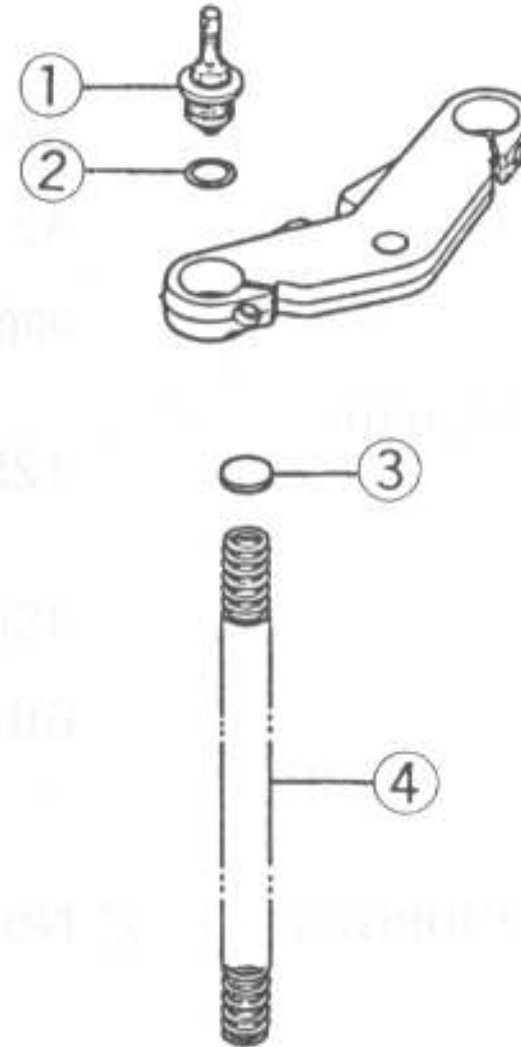

1. Fork Top Plug
2. O-ring
3. Spring Seat
4. Spring

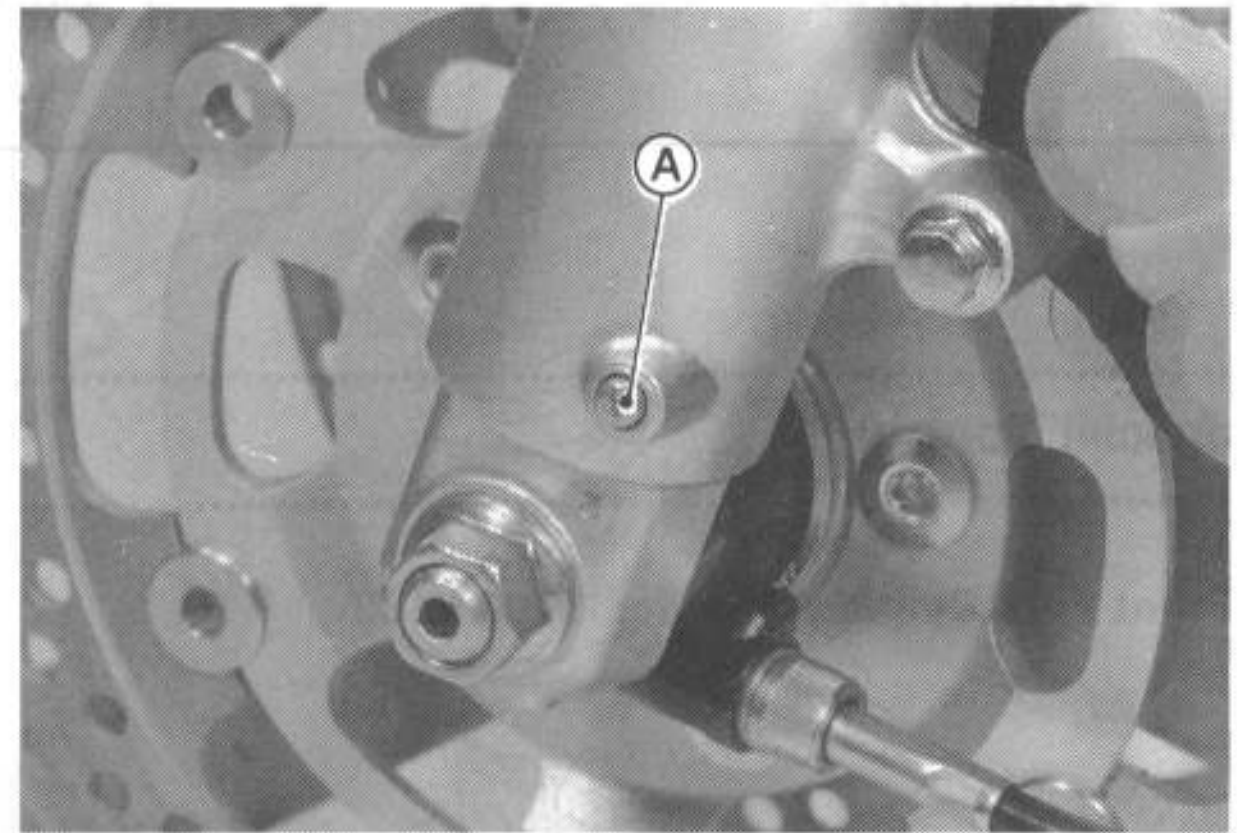

A. Drain Screw

- Pump the fork legs to force out the oil.
- Apply liquid gasket—silver (Kawasaki Bond: 92104-002) to the threads of the drain screw and gasket.
- Pour in the specified type and amount of oil.

Front Fork Oil

Viscosity	SAE 10W20
Amount per side	
When changing oil:	About 355 mL
After disassembly and completely dry:	421 ±4 mL

- With the fork fully compressed insert a tape measure or rod in the inner tube, and measure the distance from the top of the inner tube to the oil.

WARNING

- If both adjusters are not adjusted equally, handling may be impaired and a hazardous condition may result.

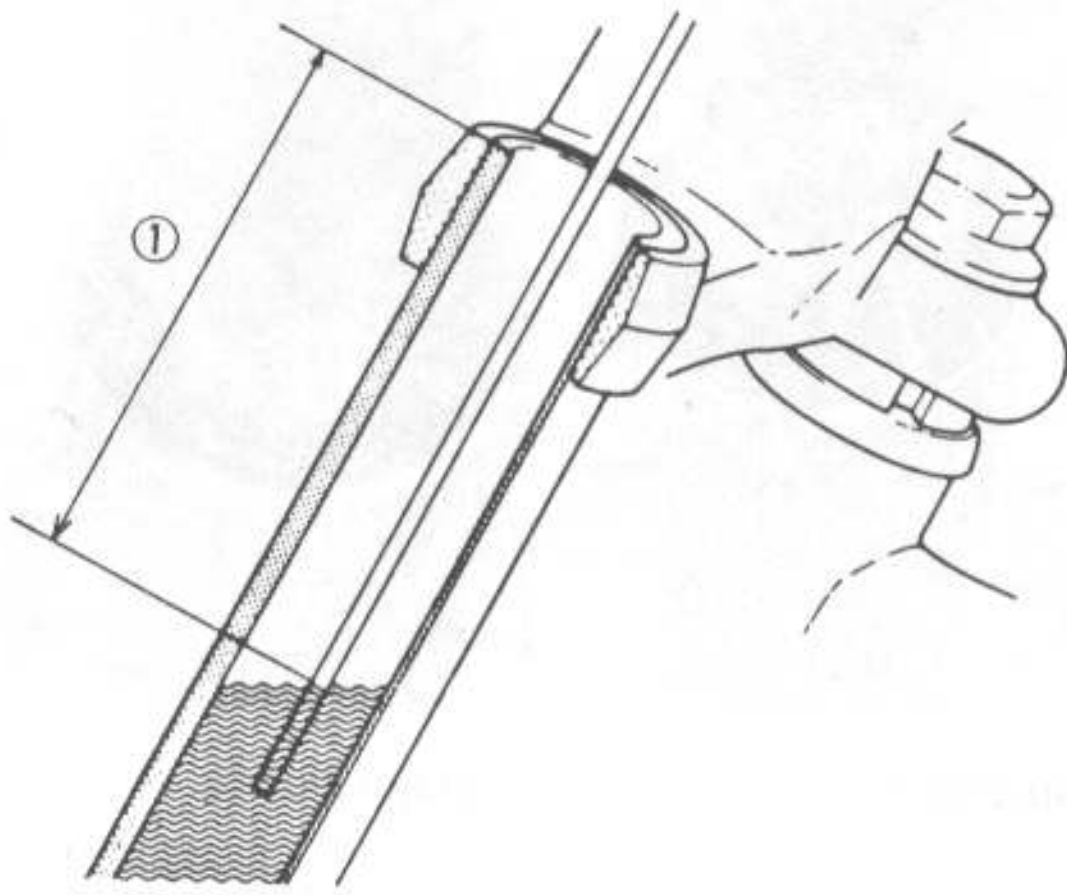

1. Oil Level

Fork Oil Level

(Fully Compressed, without main spring)

125 ±2 mm

- ★If the oil is above or below the specified level, remove or add oil and recheck the oil level.
- When installing the parts removed, tighten the fork top plug to the specified torque (see General Information chapter).
- Change the oil of the other fork leg in the same manner.

Removal (each fork leg)

- Remove the front wheel (see Wheels/Tires chapter).
- ★If the front fork legs are to be disassembled, loosen the fork top plugs beforehand.
- Remove the following.
 - Caliper (from the fork leg to be removed.)
 - Fairings
 - Front Fender

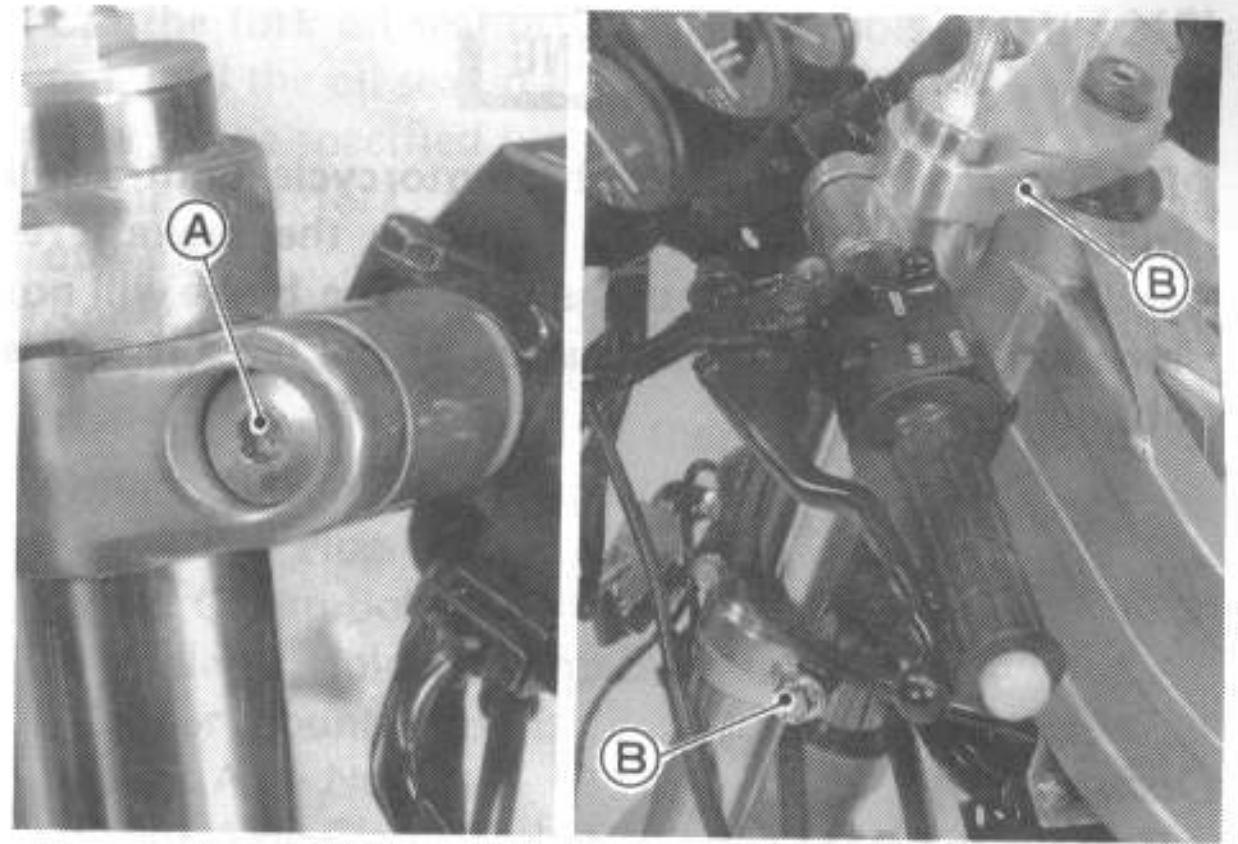

A. Handlebar Holder Clamp Bolt B. Fork Clamp Bolts

- With a twisting motion, work the fork leg down and out.

Installation (each fork leg)

- Install the fork leg as shown.

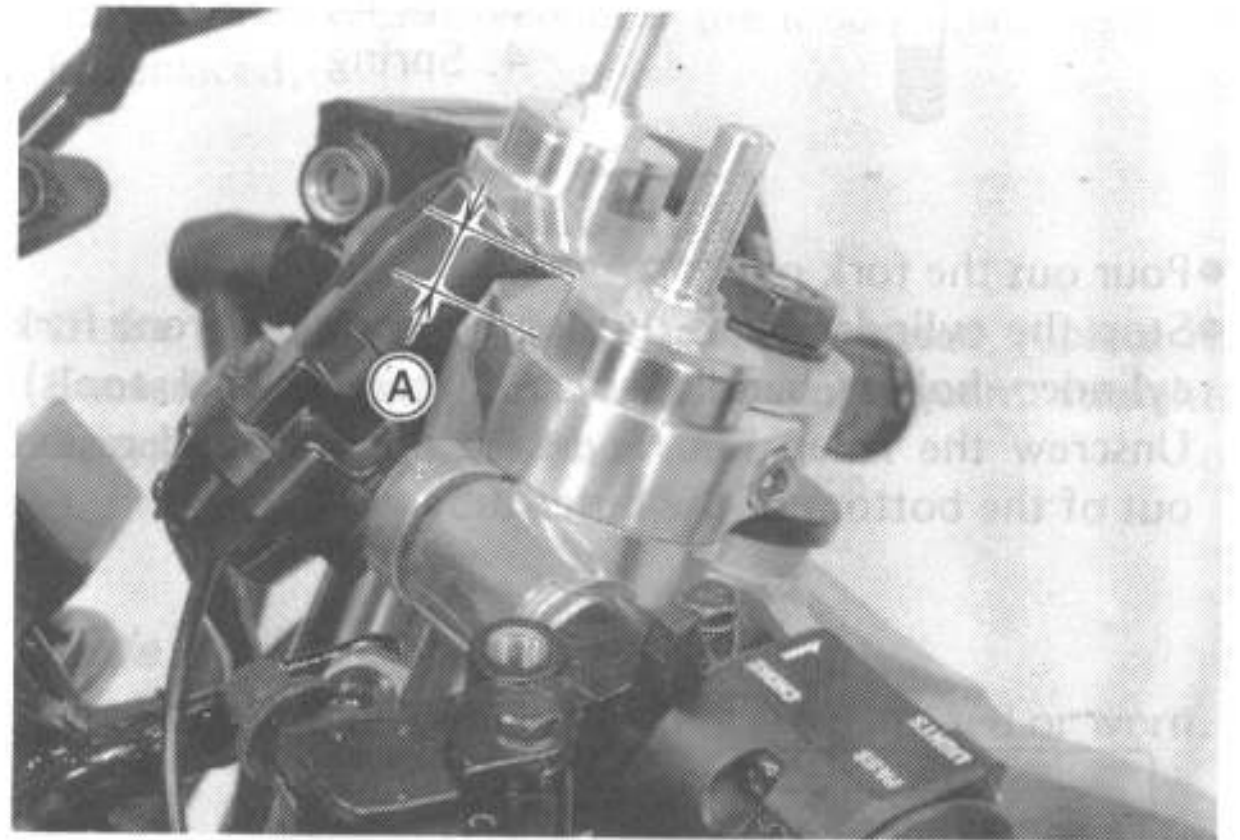

A. 10 mm

- Apply a non-permanent locking agent to the threads of side stand bracket mounting bolt.
- Tighten the following to the specified torques (see General Information chapter).
 - Fork Clamp Bolts
 - Handlebar Holder Clamp Bolt
 - Caliper Mounting Bolts
 - Front Axle Nut
 - Side Stand Bracket Mounting Bolts
 - Front Axle Clamp Bolts