

## Removal and installation of HST controller assembly

### Removal

**⚠ Disconnect the cable from the negative (-) terminal of the battery.**

1. Pull out starting switch (1), remove 4 plastic panel mounting bolts (2), and fold plastic panel (3) toward the operator seat.
2. Disconnect following connectors of panel switch (4) and remove plastic panel (3).
  - (4a):CN-FWL
  - (4b):CN-FAN
  - (4c):CN-BUZ
  - (4d):CN-CUR
  - (4e):CN-REV
  - (4f):CN-MTS
  - (4g):CN-HET

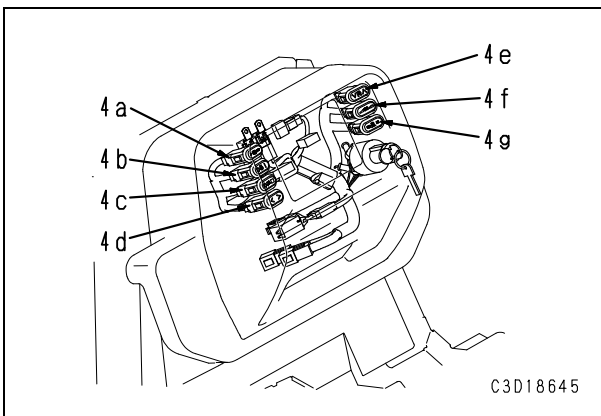
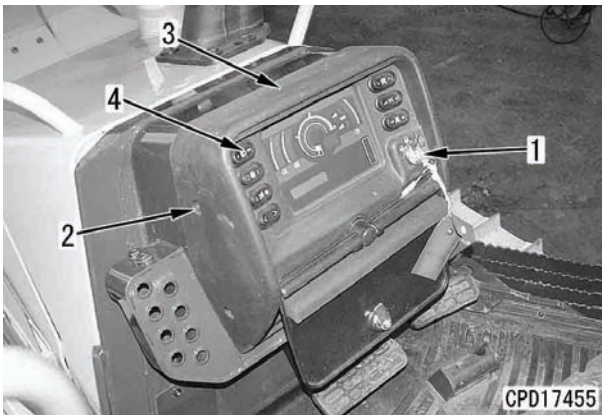

3. Remove 6 mounting bolts (6) of monitor panel mounting bracket (5) and fold the bracket toward the operator seat.
4. Disconnect connectors CN-P1 (6a), CN-P2 (6b) and CN-P3 (6c).

5. Remove monitor panel mounting bracket (5).

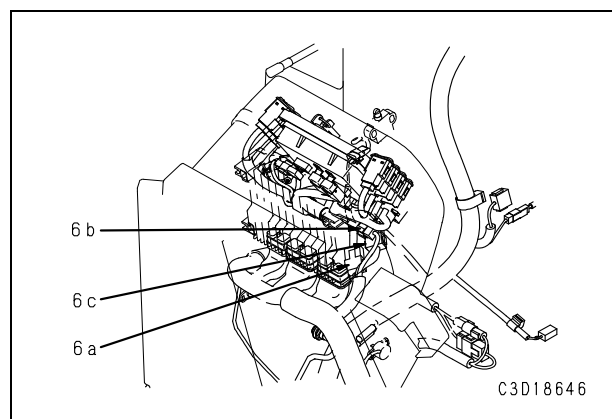
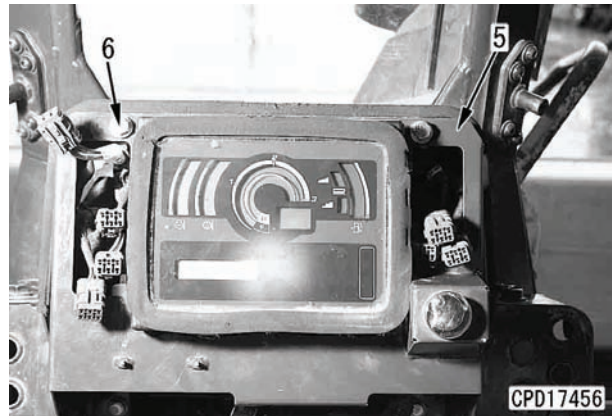

6. Disconnect connectors CN-ST1 (8), CN-ST2 (9) and CN-ST3 (10) of HST controller (7).
7. Remove 4 mounting bolts (11) and HST controller (7).

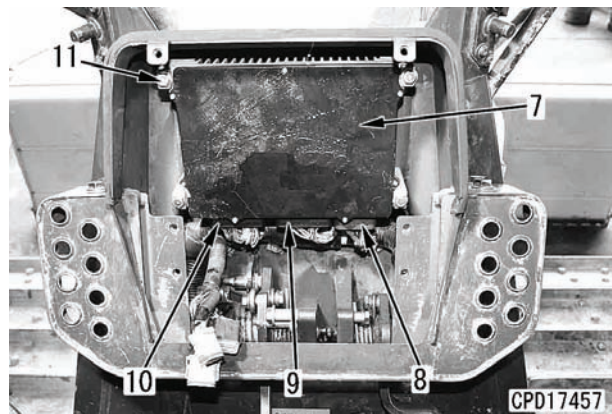

### Installation

- Carry out installation in the reverse order to removal.
- ★ If the HST controller assembly was replaced, adjust the new assembly. For details, see Testing and adjusting, "Special functions of monitor panel (EMMS), 11. Tuning mode (TUNING)".

## Removal and installation of KOMTRAX terminal assembly

### Removal

- ⚠ **Disconnect the cable from the negative (-) terminal of the battery.**

1. Remove the operator seat.

 Operator seat: **50 kg**

2. Remove cover (1).

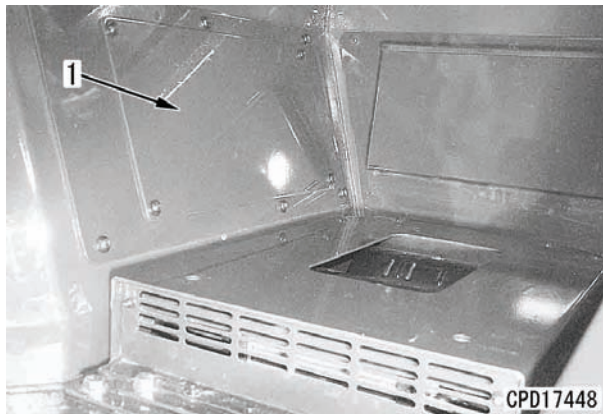

3. Disconnect the 3 wiring connectors.
  - (2): CN-G01
  - (3): CN-KOM2
  - (4): CN-KOM3
4. Remove KOMTRAX terminal (5).

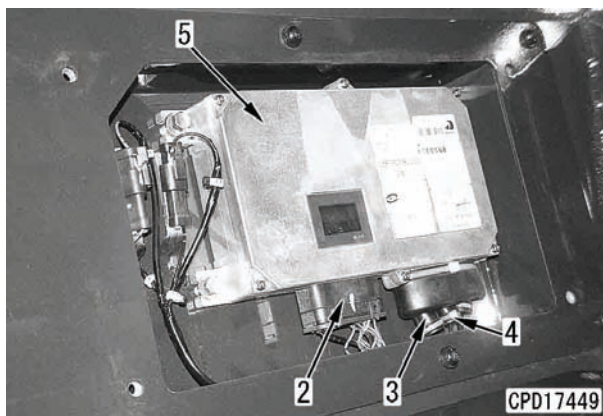

### Installation

- Carry out installation in the reverse order to removal.
- ★ If the HST controller assembly was replaced, adjust the new assembly. For details, see Testing and adjusting, "Special functions of monitor panel (EMMS), 11. Tuning mode (TUNING)".