

Hydraulic circuit for powering the Duplex lift cylinders

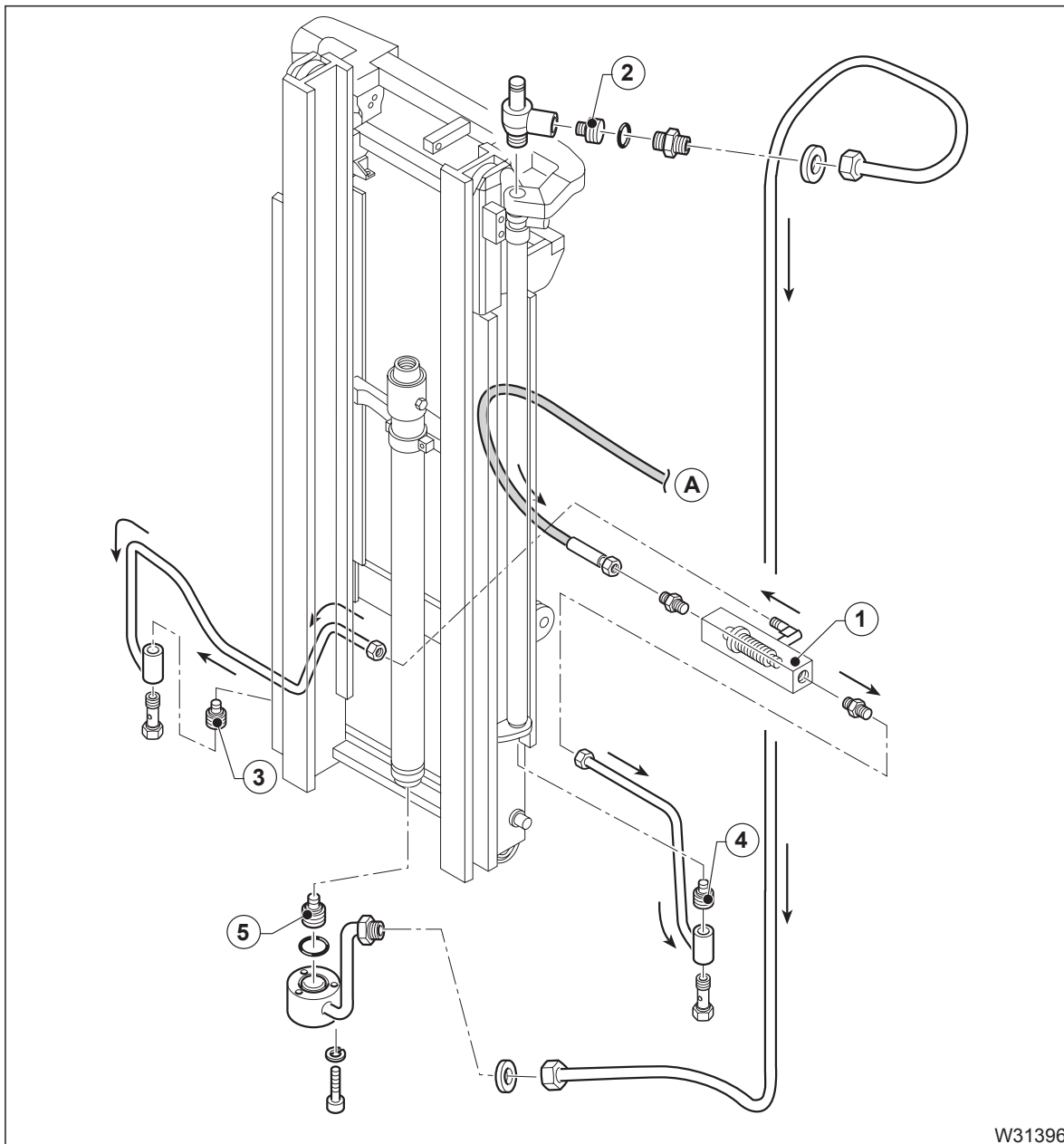

- 1 Metering valve.
- 2 Safety valve
- 3 Safety valve

- 4 Safety valve
- 5 Safety valve
- A From the distributor

The oil enters at the metering valve(1). From this point it passes through the side piping to the outer cylinders. On the Duplex lift the oil powers the central cylinder through the left outer cylinder and the vertical piping. Due to the difference in the surface area of the two pistons, the first piston to be extended is that of the central cylinder.

Stroke 1= operates the fork carriage only.

Stroke 2= extends the inner (moving) mast.
(refer to the respective diagrams).

The safety valves are fitted in the cylinders and prevent the rapid and uncontrolled lowering of the load in case the piping breaks.



NOTE

Adjustments or repairs are not permitted on these valves. In case of malfunctioning or anomalies, replace the valves. For the type of valve, refer to the Spare Parts Catalogue only.

Adjusting the load chains of the Duplex lift

- The load chains must be adjusted uniformly using the tensioning attachments (1).

The centre of the upper rollers of the four-roller fork carriage or, depending on the case, the centre of the middle rollers of the six-roller carriage, must remain inside the section of the inner mast for a dimension at least greater than "X" (see respective diagram) when the piston of the lift cylinder is completely extended (up to the limit stop inside the cylinder).

Never compensate tyre wear by adjusting the load chain tension.

When adjusting the load chains, a minimum distance of 2 mm must be kept from the fork carriage retaining device (see adjustment in the respective paragraph).

- For the load chain locking device according to the sketch shown on the side, see the respective paragraph.

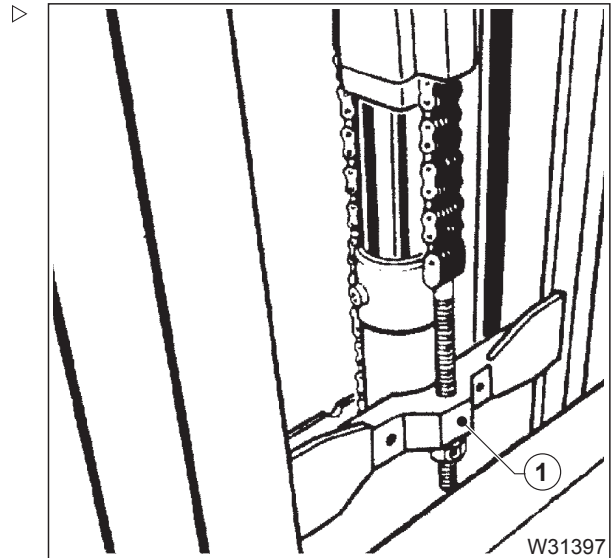

NOTE

The wear, possible damage and elongation of the load chains should be checked according to the accident prevention rules and as described in the User and Maintenance Manual.

