

OIL FLOW PATH (PC220-RA18-044-K-00-A)

The direction of operation of the pedal and the path of the oil flow is as shown in the figure below.

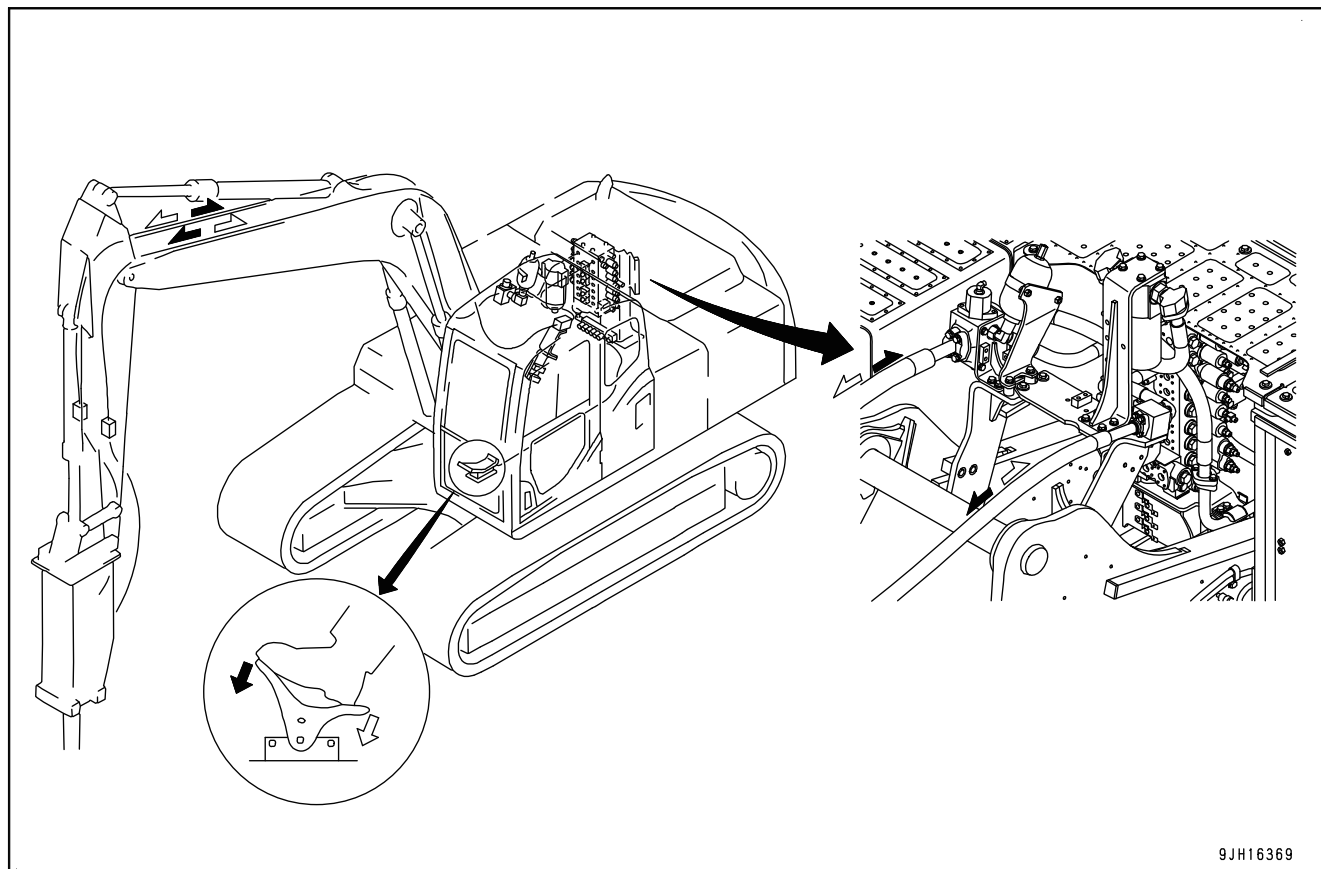

When the front of the pedal is depressed, oil flows to the piping on the left side of the work equipment; when the rear of the pedal is depressed, oil flows to the piping on the right side of the work equipment. (When a breaker is installed, only the front of the pedal can be used.)

REPLACE ELEMENT FOR ADDITIONAL FILTER FOR BREAKER (PC220-LGC5-923-K-00-A)

⚠ WARNING

- Immediately after the engine is stopped, the parts or oil are at high temperature and may cause burns. Wait for the temperature to go down before starting the work.
- If compressed air is used, there is a danger of dirt scattering and causing personal injury.
Always wear protective eyeglasses, dust mask, and other protective equipment.

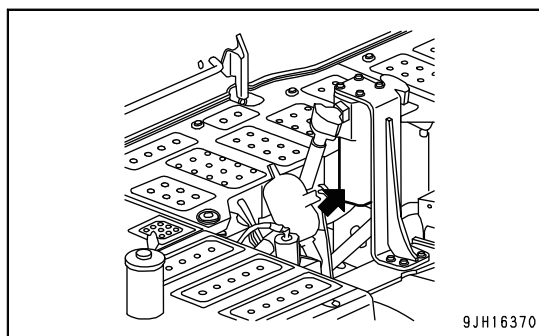

NOTICE

For the details of the element replacement interval, see “MAINTENANCE INTERVAL FOR HYDRAULIC BREAKER (PAGE 4-13) ”.

- Prepare a container to catch the oil.

1. Lower the work equipment to the ground and stop the engine.

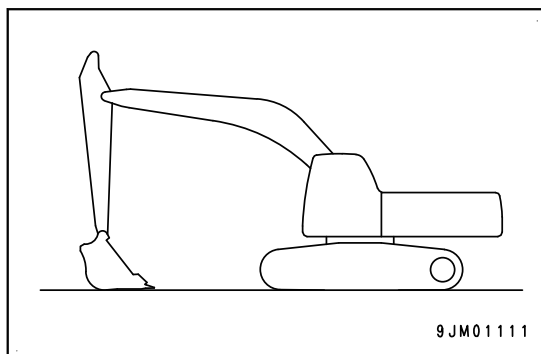

2. Turn the starting switch to ON position (B), then set the lock lever to FREE position (F).
3. After carrying out Step 2, operate each work equipment control lever and attachment control pedal fully to the front, rear, right, and left 2 to 3 times within 15 seconds to release the internal pressure in the hydraulic circuit.

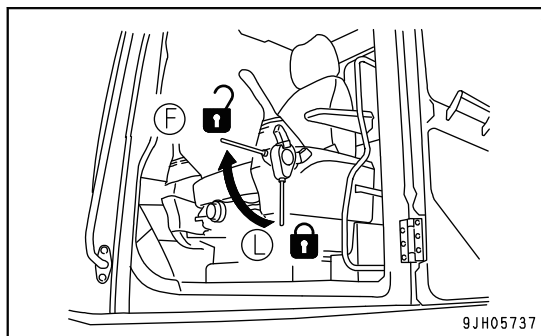
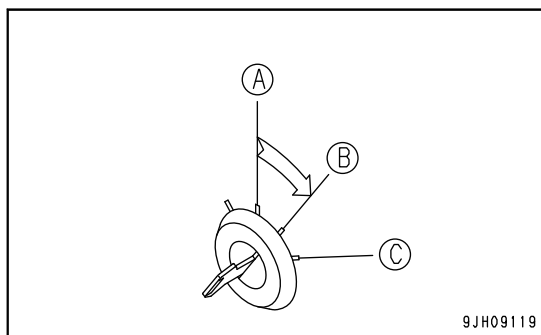

4. Set the lock lever to LOCK position (L).

