

DISPLAY METHOD AND SPECIAL FUNCTIONS OF 7-SEGMENT MONITOR PANEL

1. Troubleshooting function of lamps, gauges, buzzer

When the starting switch is turned on, all the lamps and gauges light up for approx. 3 seconds, and the buzzer sounds for approx. 1 second. During this time, the monitor itself carries out self-diagnosis, and after it has finished, it gives the normal display (if any lamp does not light up during the visual check, the lamp bulb is blown).

2. User code display function

All the abnormality data for the engine controller and pump controller are transmitted to the monitor panel. Of the abnormality data, items with a high emergency level are displayed as a user code automatically on digital meter display (1) of the monitor panel to advise the operator of the action to take.

★ On digital meter display (1) and service meter display (2), only the places marked [x] in the illustration below light up. All the other places are OFF.

1) User code display

- (1) Digital meter display
- (2) Service meter display
- (3) Working mode selector (UP) switch
- (4) Working mode selector (DOWN) switch
- (5) Setting switch
- (6) Travel speed switch
- (7) Auto-deceleration switch
- (8) Buzzer cancel switch

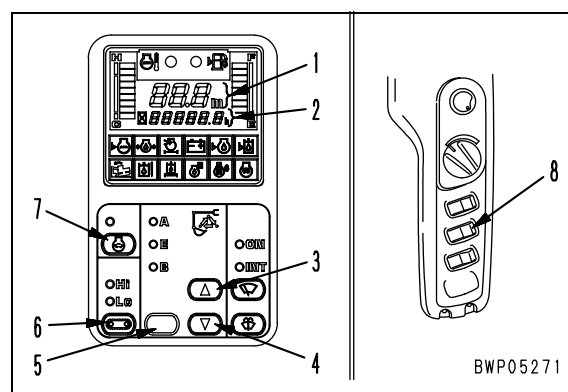

Example: When user code [E02] is displayed

2) Table of user codes

User code	Abnormal system
E02	PC-EPC system
E03	Swing holding brake system
E05	Governor motor system
E06	Boom RAISE stroke end throttle EPC system

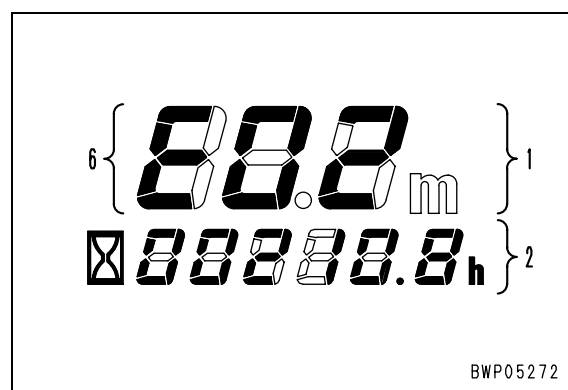

3. User code display function

All the abnormality data for the engine controller and pump controller are transmitted to the monitor panel. These abnormality data, regardless of whether they are necessary to display as a user code or not, are all stored inside the monitor panel as service codes.

When the following operations are carried out, the service codes are displayed on the monitor panel digital display; the existing problems are marked with "E" and are displayed together with the elapsed time data (time on the service meter) on the service meter display panel.

1) Method of displaying and deleting service codes

i) To switch to the service code display mode, do as follows:

- ① Keep [Buzzer cancel switch (8)] + [Auto-deceleration switch (7)] pressed for at least 2.5 seconds.
- ② Press [Buzzer cancel switch (8)] + [Working mode selector (UP) switch (3)] (or [Working mode selector (DOWN) switch (4)] and set so that [01] is displayed in the 2nd and 3rd digits from the left on service meter display (2).
- ③ Press [setting switch (5)].

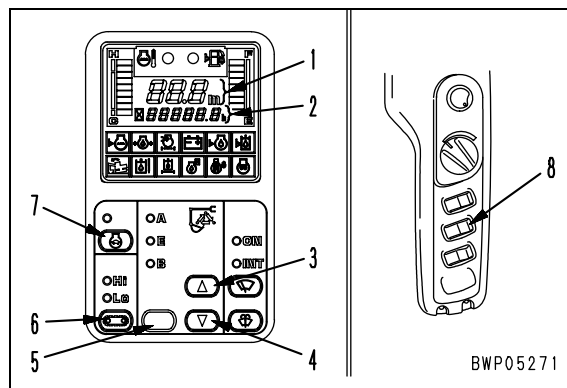

- (1) Digital meter display (5) Setting switch
 (2) Service meter display (6) Travel speed switch
 (3) Working mode selector (UP) switch (7) Auto-deceleration switch
 (4) Working mode selector (DOWN) switch (8) Buzzer cancel switch

Example 1: When [01] is displayed on service meter display (2)

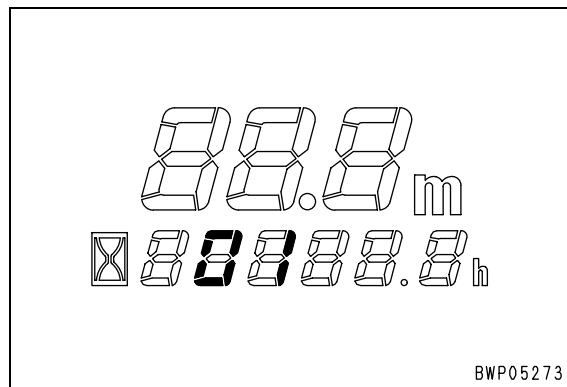

Example 2: When [E213] occurred 6 hours before

- ★ If the problem still exists, "E" is displayed at the 2nd digit from the left on service meter display (2); if the situation has returned to normal, "E" is not displayed.
- ★ The 3 digits on the right from service meter display (2) show the elapsed time.

