

CLEAN, INSPECT RADIATOR FINS, OIL COOLER FINS, AFTERCOOLER FINS, CONDENSER FINS



WARNING

If compressed air, steam, or water hit your body directly, there is danger of injury. Always wear personal protective items, such as protective eyeglasses, dust mask.

When using compressed air for cleaning, make sure the maximum pressure of it is less than 0.2 MPa (2.1 kg/cm², 30.0 PSI).

NOTICE

To prevent damage to the fins, apply compressed air from an appropriate distance. Damaged fins may cause water leakage or overheating. In a dusty site, check the fins daily, irrespective of the maintenance interval.

1. Remove bolts (1) at the top surface of the hood, then remove panel (2).
2. Remove bolts (3) at the top of the radiator shroud, then remove panel (4).
3. Check that there is no mud or dirt clogging the radiator fins, oil cooler fins, aftercooler fins, or condenser fins.

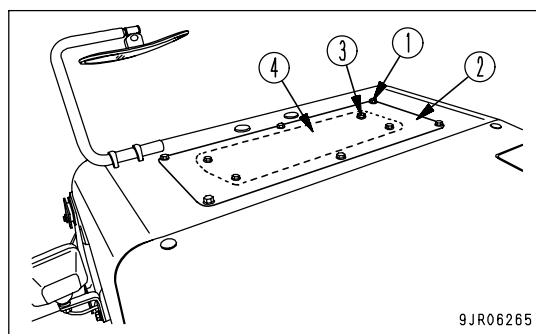

If there is any mud or dirt clogging the radiator fins, oil cooler fins, aftercooler fins, or condenser fins, clean the fins as follows.

4. Remove cap (5) and bolt (6), then remove grill mask (7).

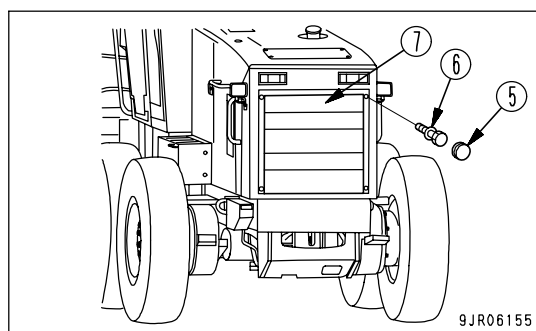

5. Remove bolts (8) at the bottom of the radiator shroud, then remove panel (9).

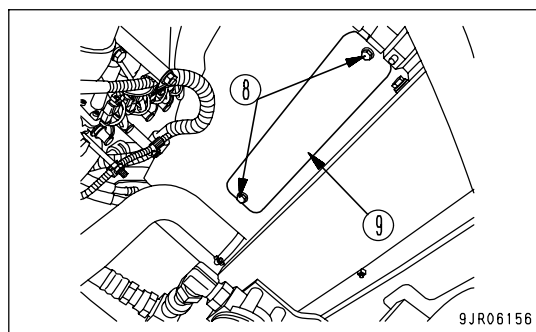

6. Insert cleaning nozzle (12) through the gap between radiator core (10) and aftercooler core (11) and the rear of the radiator, then use compressed air to blow out the mud or dirt clogging the fins.

Steam or water can be used instead of compressed air. But, make sure to keep a reasonable distance when performing washing with powerful steam (high-pressure washing) to heat exchange devices (radiator, oil cooler, after cooler, and air conditioner condenser). If steam washing (high pressure washing) is performed from point-blank distance, fins inside the heat exchange device may deform which will cause clogging or damage on early stage.

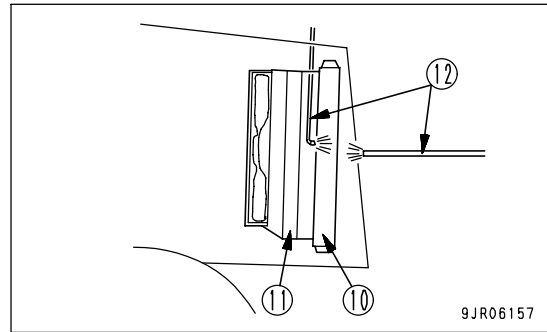

7. Check the rubber hose. Replace with a new one if the hose is found to have cracks or to be hardened by ageing.
Further, check hose clamps for looseness.
8. Install panels (9), (4), and (2), and grill mask (7), then tighten the bolts to the specified tightening torque.
9. Install cap (5).