

## Disassembly and assembly of differential assembly

### Special tools

Symbol	Part No.	Part Name	Necessity	Q'ty	New/Remodel	Sketch
H	13	799-301-1500	Oil leak tester	■	1	
	14	797-101-1211	Wrench	■	1	
	15	793-615-1100	Wrench	■	1	
	16	793T-422-1220	Push tool	■	1	○
	17	797T-423-1320	Push tool	■	1	○
	18	792T-413-1130	Push tool	■	1	○
	19	793-520-2202	Installer	●	3	
	20	790-190-1500	Pump assembly	■	1	
	21	799-101-5210	Nipple	■	1	
	22	793T-422-1611	Plate	■	1	○
	23	791T-465-1210	Push tool	■	1	○
	24	790-201-3260	Bolt (12 x 1.75 mm)	●	2	
	25	791-615-2130	Sleeve	■	1	
	26	Commercially available	Puller	●	1	
	27	79G-05V-1400	Bar	■	1	
	28	792T-413-1120	Push tool	■	1	○
	29	Commercially available	Depth gauge	●	1	
	30	Commercially available	Torque wrench	●	1	
	31	Commercially available	Dial gauge	●	1	
	32	790-201-2830	Spacer	■	1	
	33	791-126-0211	Adapter	■	1	
	34	Commercially available	Depth micrometer	●	1	

### Disassembly

#### 1. Draining oil

 Axle (Each of front and rear axles): **18 ℓ**

#### 2. Brake piping

- 1) Remove brake tube and hose assembly (2).

#### 3. Rear axle support (Only rear axle)

- 1) Remove grease tube (3).
- 2) Remove cover (4).
  - ★ Check the thickness and quantity of the shims.

#### 4. Axle housing

- 1) Remove both axle housings (1). For details, see "Disassembly and assembly of axle housing".

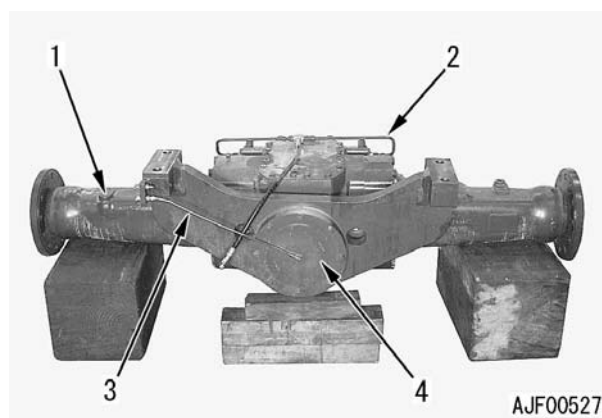

- 2) Remove 2 thrust washers (5) and thrust plate (6).

- 3) Lift off rear axle support (7).

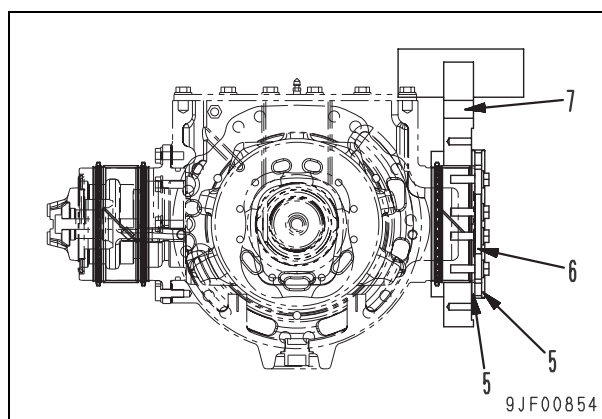

- 4) Remove packing (8) and bushing (9) from rear axle support (7).

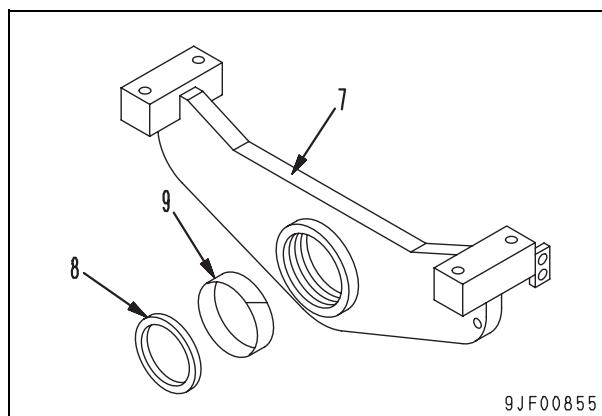

## 5. Axle oil temperature sensor (Only front axle)

- 1) Remove cover (10).
- 2) Remove axle oil temperature sensor (11).  
(The shape of the cover in the figure is different more or less from the shape of the actual cover.)

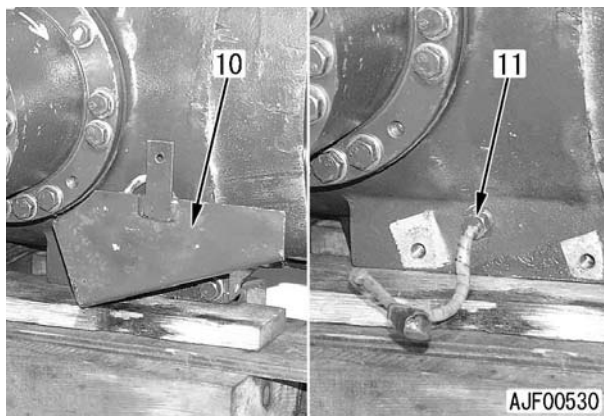

## 6. Differential assemblies

- 1) Place and stabilize differential assemblies (12) and (13) on blocks.
- ★ (12): Front differential
  - (13): Rear differential

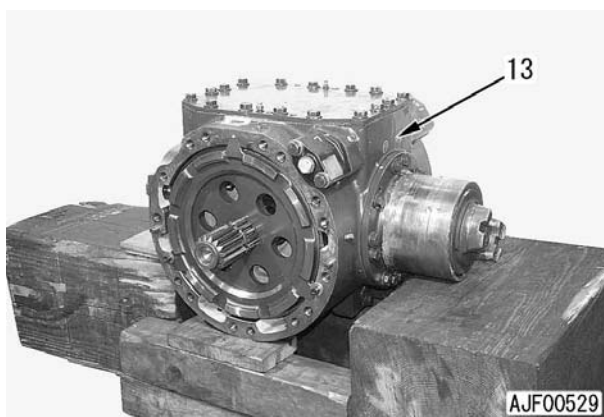
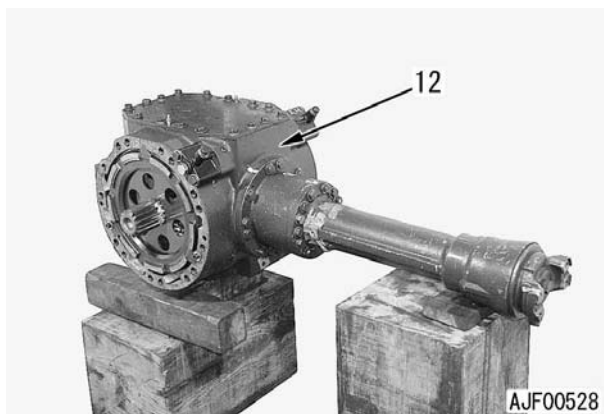

## 7. Brakes

- ★ Remove both brakes according to the following procedure.
- 1) Remove sun gear shafts (14).

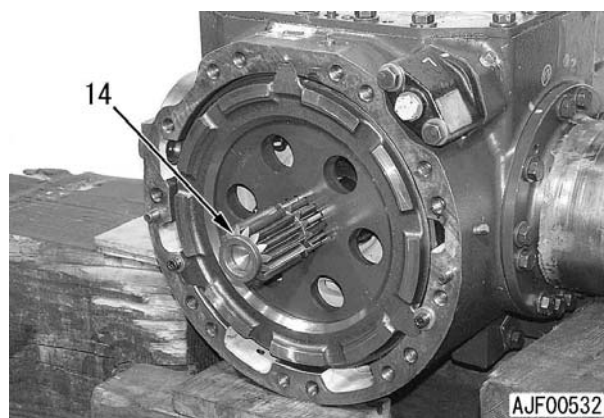

- 2) Remove 2 inside hexagon bolts (15) and outer plate (16).

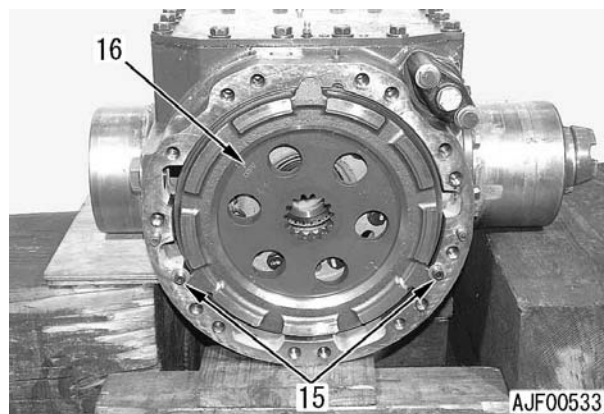

- 3) Remove 2 discs (17), 1 plate (18), and 4 wave springs (19).

