

STRUCTURAL VIEW

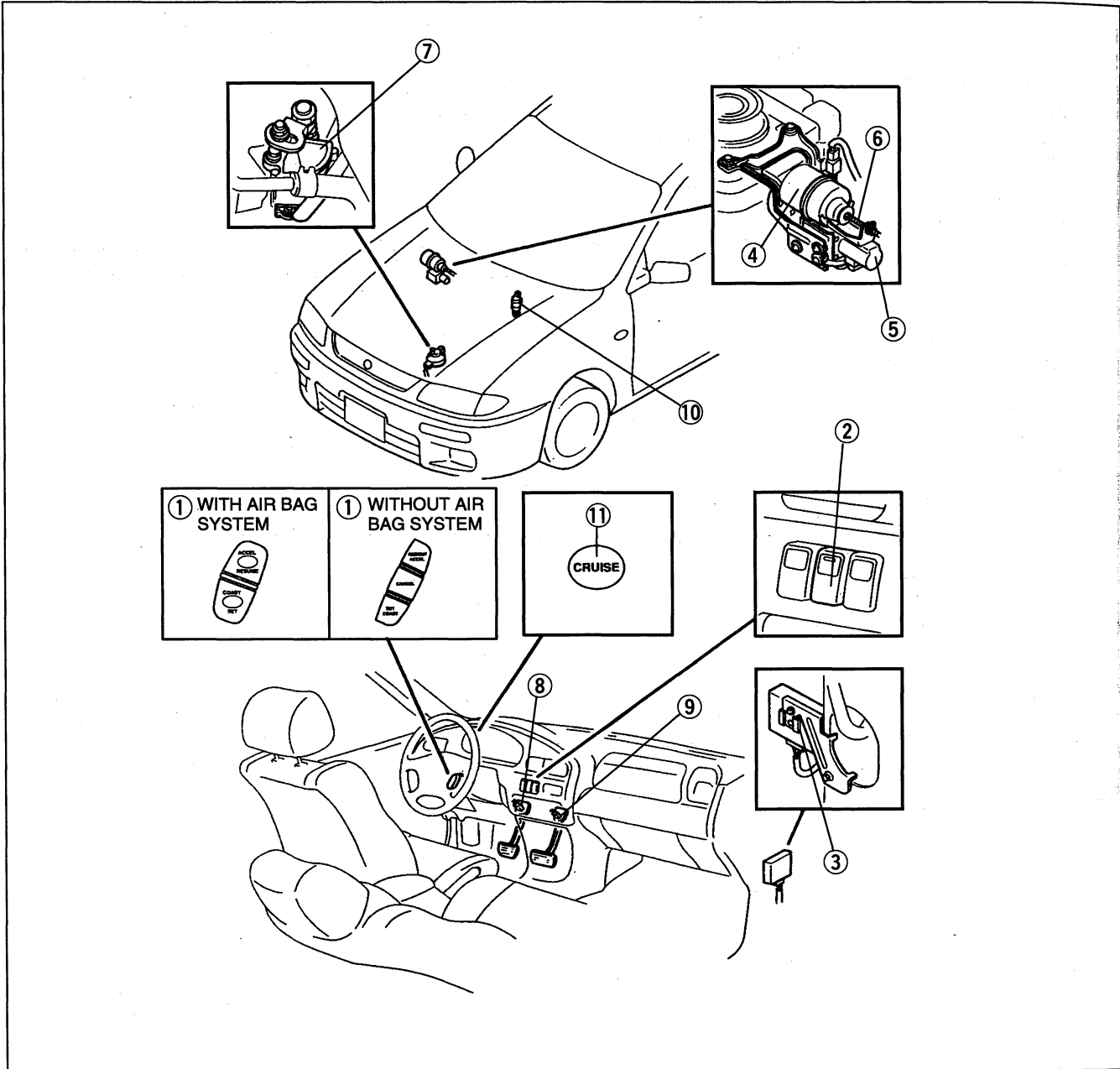

- | | |
|--|----------------------|
| 1. Cruise control switch | |
| Removal / Installation | page T1-94 |
| Inspection | page T1-95 |
| 2. Cruise control main switch | |
| Removal / Installation | page T1-96 |
| Inspection | page T1-96 |
| 3. Cruise control module | |
| Removal / Installation | page T1-89 |
| Inspection | page T1-90 |
| 4. Cruise actuator | |
| Removal / Installation | page T1-91 |
| Inspection | page T1-92 |
| 5. Vacuum pump | |
| Removal / Installation | page T1-92 |
| Inspection | page T1-93 |
| 6. Actuator cable | |
| Removal / Installation | page T1-93 |
| Adjustment | page T1-93 |
| 7. Transaxle range switch | |
| Removal / Installation | section K |
| Inspection | section K |
| 8. Clutch switch | |
| Removal / Installation | section F1, F2 |
| Inspection | section F1, F2 |
| 9. Brake switch | |
| Removal / Installation | section P |
| Inspection | section P |
| 10. Vehicle speedometer sensor | |
| Removal / Installation | section K |
| Inspection | section K |
| 11. Cruise set indicator light (in instrument cluster) | |