

P35.10-2303-09

03	<input checked="" type="checkbox"/>	Spindle 221 589 01 43 03	021	<input checked="" type="checkbox"/>	Hand pump 652 589 00 33 21
04	<input checked="" type="checkbox"/>	Thrust piece 221 589 01 43 04	023	<input checked="" type="checkbox"/>	Hydraulic hose 652 589 00 33 23
05	<input checked="" type="checkbox"/>	Thrust piece 221 589 01 43 05	5		Rear axle carrier
06	<input checked="" type="checkbox"/>	Stop 221 589 01 43 06	10		Rubber bushing
07	<input checked="" type="checkbox"/>	Hollow piston cylinder 001 589 51 33 00			
5	<input checked="" type="checkbox"/>	Insert stop (06) from rear into bore on rear axle carrier			

Fig. 34: Installing Rear Rubber Mount Of Rear Axle Center Assembly Suspension
Courtesy of MERCEDES-BENZ USA

i The hole (arrow) in the stop (06) must face downward.

5. Apply extraction and insertion tool using cylinder (07) to rubber mount (10).
6. Press rubber mount (10) into rear axle carrier (5)

i When turning the spindle (03) into the stop (06), make sure that the spare tire well is not damaged.

i If the hollow piston cylinder (07) has reached its max. stroke, release pressure at the hand pump (021), turn the spindle (03) further into the stop (06) and repeat the pressing procedure.

i The shape of the stop (06) determines the end position of the rubber mount (10) in the rear axle carrier (5).

REMOVE/INSTALL REAR RUBBER BUSHINGS FOR DIFFERENTIAL MOUNT IN REAR AXLE CARRIER - AR35.10-P-0050SZ

MODEL 221.054/056/070/071/077/084/086/087/095/176/177/179, 216.374/376/377/379

MODEL 221.128 with CODE (Z07) Top protection

2012 Mercedes-Benz CL65

DRIVELINE/AXLES Rear Axle - 216.379 CL65 AMG

AP	Remove/install		
i	Notes on self-locking nuts and bolts		<u>AH00.00-N-0001-01A</u>
1.1	Remove rear axle center assembly	Vehicles with screwed-on rear axle shafts.	<u>AR35.31-P-0520SZ</u>
1.2	Lower rear axle center assembly	Vehicles with inserted rear axle shafts. See "Install front differential mount on rear axle carrier".	<u>AR35.10-P-0051SZ</u>
2	Remove rear rubber mount of rear axle center assembly suspension		<u>AR35.10-P-0050-02SX</u> *221589014300 *001589513300 *652589003321 *652589003323
3	Install in the reverse order		

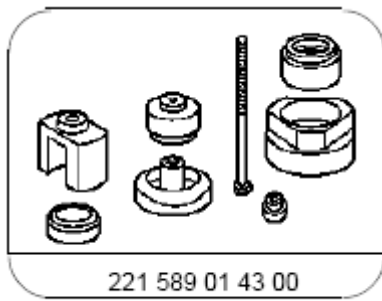

221 589 01 43 00

Extraction and insertion tool

Fig. 35: Identifying Extraction And Insertion Tool (221 589 01 43 00)
 Courtesy of MERCEDES-BENZ USA

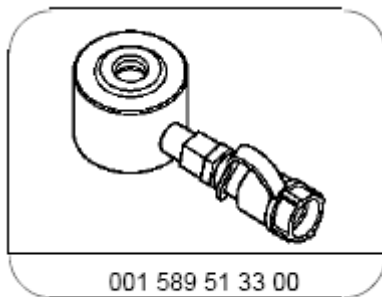

001 589 51 33 00

Hollow piston cylinder

Fig. 36: Identifying Hollow Piston Cylinder (001 589 51 33 00)

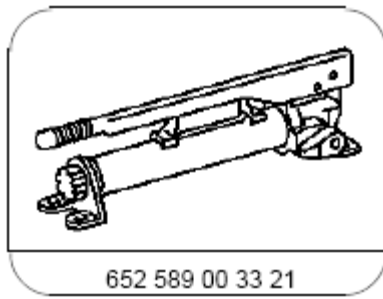

652 589 00 33 21

Hand pump

Fig. 37: Identifying Hand Pump (652 589 00 33 21)
Courtesy of MERCEDES-BENZ USA

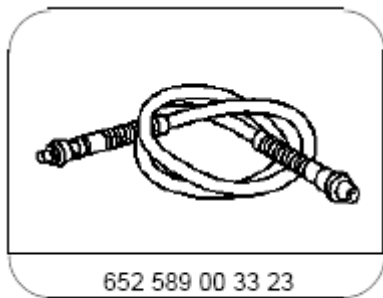

652 589 00 33 23

Hydraulic hose (complete)

Fig. 38: Identifying Hydraulic Hose (652 589 00 33 23)
Courtesy of MERCEDES-BENZ USA

REMOVE/INSTALL RUBBER MOUNT OF FRONT CENTER ASSEMBLY MOUNTING - AR35.10-P-0051-01SX

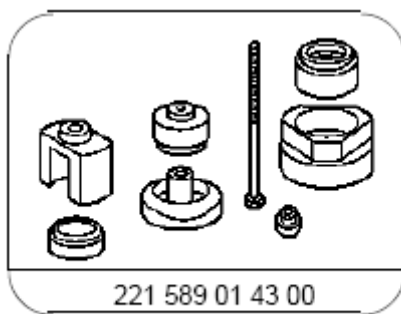

221 589 01 43 00

Extraction and insertion tool

Fig. 39: Identifying Extraction And Insertion Tool (221 589 01 43 00)
Courtesy of MERCEDES-BENZ USA

i The following parts are required from the  extraction and insertion tool

221 589 01 43 00:

Ⓜ 221 589 01 43 06 (thrust piece (06))

Ⓜ 221 589 01 43 07 (support (07))

Ⓜ 221 589 01 43 08 (measuring insert (08))

Removal

1. Ⓜ Place support (07) on workshop press.
2. Place front differential mount (8) on the Ⓜ support (07) and position.

i See next picture:

The shoulder which is arched inwards (arrow) of the Ⓜ support (07) must abut the cutout (a) of the front differential mount (8).

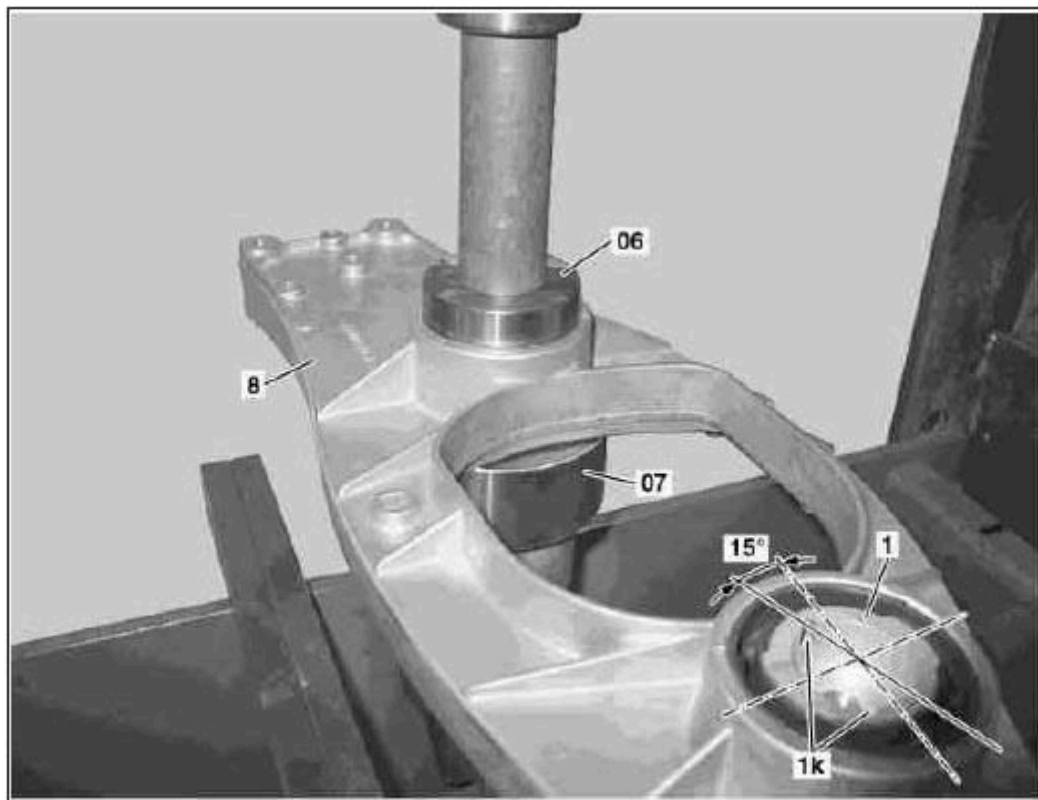

P35.31-2204-06

Fig. 40: Removing Rubber Mount Of Front Center Assembly Mounting
Courtesy of MERCEDES-BENZ USA

3. Press rubber mounts (1) Ⓜ out of the front differential mount (8) using the thrust piece (06).

Install

i Pay attention to the projection dimension when pressing in the rubber mounts (1). It is adjusted by using the **!** measuring insert (08) when pressing in:

- Right-hand projection dimension: 6.2 mm
- Left-hand projection dimension: 8.7 mm

The measuring insert **!** (08) has two different depth milled sections (see laser inscription). For the right rubber mount (1) the lettering 6.2 must face upwards, for the left rubber mount (1) the lettering 8.7.

4. **!** Place support (07) on workshop press.
5. **!** Insert measuring insert (08) in **!** support (07).

i Insert inscription on **!** measuring insert (08).

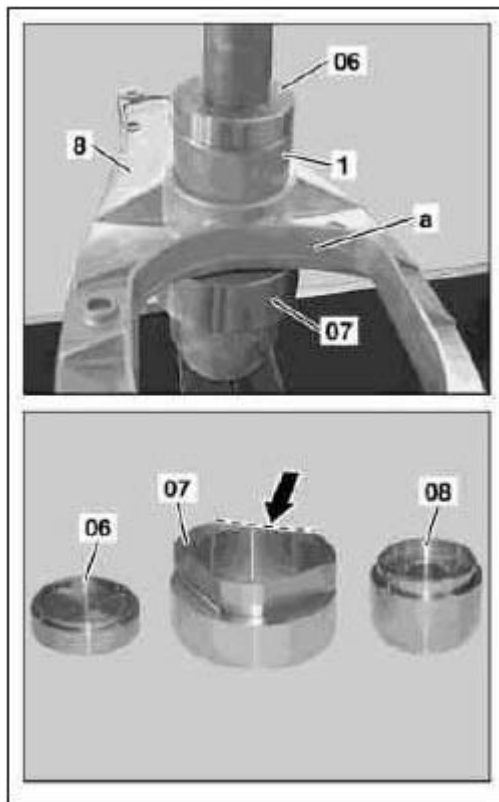

P35.31-2203-03

Fig. 41: Installing Rubber Mount Of Front Center Assembly Mounting
Courtesy of MERCEDES-BENZ USA

6. Place front differential mount (8) on support **!** and position.

2012 Mercedes-Benz CL65

DRIVELINE/AXLES Rear Axle - 216.379 CL65 AMG

i The shoulder which is arched inwards (arrow) of the **!** support (07) must abut the cutout (a) of the front differential mount (8).

7. Place rubber mounts (1) on the front differential mount (8) and move into the specified position.

i The notches (1k) must be twisted upwards by 15°.

8. Press rubber mounts (1) **!** out of the front differential mount (8) using the thrust piece (06).

REMOVE/INSTALL FRONT DIFFERENTIAL MOUNT ON REAR AXLE CARRIER - AR35.10-P-0051SZ

MODEL 221.054/056/070/071/077/084/086/087/095/176/177/179, 216.374/376/377/379

MODEL 221.128 with CODE (Z07) Top protection

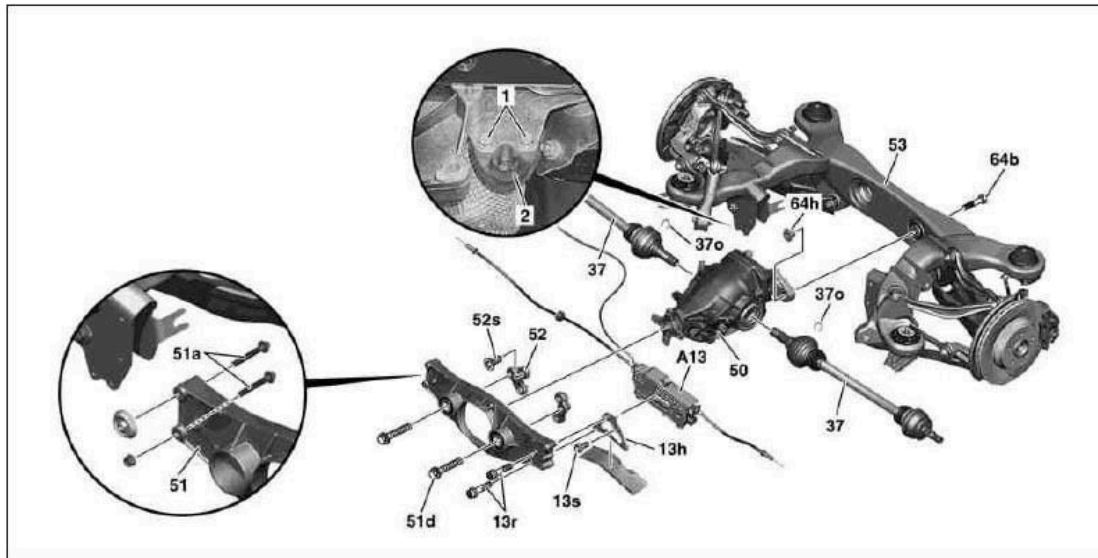

P35.10-2325-09

- | | | |
|------------------------|-----------------------------|-----------------------------------------|
| 1 Bolts | 50 Differential | 64b Screw |
| 2 Exhaust rubber mount | 51 Front differential mount | 64h Adjusting bush |
| 13h Bracket | 51a Screw | A13 Electric parking brake control unit |
| 13r Screw | 51d Screw | |
| 13s Screw | 53 Rear axle carrier | |

Fig. 42: Identifying Components Of Front Differential Mount On Rear Axle Carrier
 Courtesy of MERCEDES-BENZ USA

AP	Remove/install		
i	Notes on self-locking nuts and bolts		AH00.00-N-0001-01A
1	Lower rear axle.		AR35.10-P-0015SX
2	Remove bolts (1) and remove exhaust rubber	! Gasoline engine	-