

Track rollers - Remove - TerraGlide™

CR10.90	WE
CR7.90	WE ---
CR8.80	WE ---
CR8.90	WE ---
CR9.80	WE ---
CR9.90	WE ---

1. Remove the rubber track (1), see **Rubber track - Remove (48.100)**.

NOTE: It is not required to remove the rubber tracks, in order to remove an individual track roller.

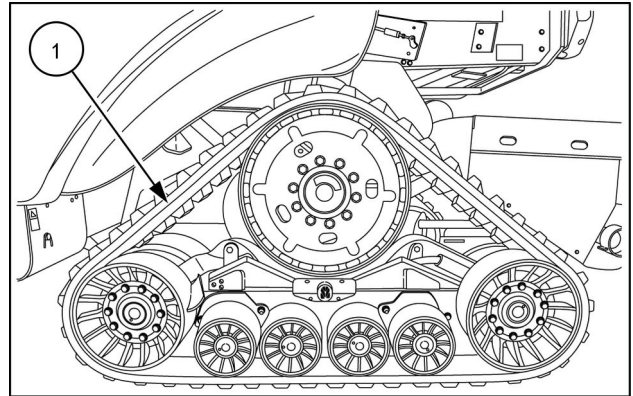

ZEIL14CR0005AA 1

2. Remove the drain plug (2) and drain the oil from the track roller (3) in a suitable container.

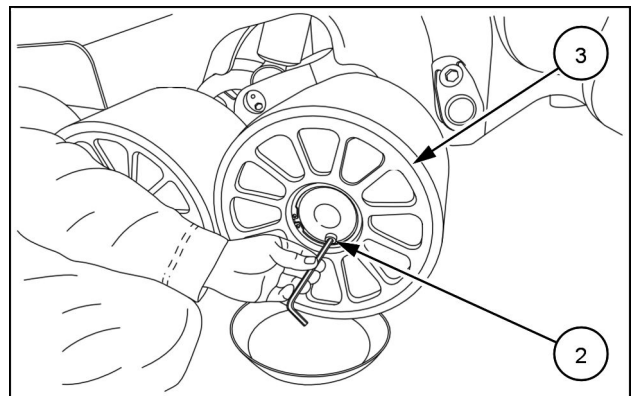

ZEIL14CR00011AA 2

3. Remove the retaining ring (4), the cover (5) and the O-ring (6).

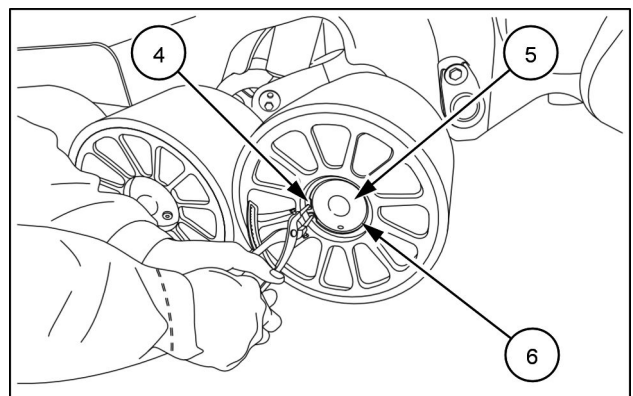

ZEIL14CR00012AA 3

4. Remove the bolt (7) and the retainer (8).
5. Remove the track roller (3) along with the bearings from the hub.

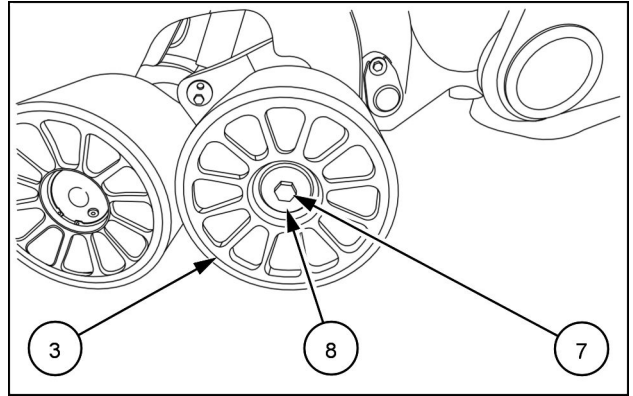

ZEIL14CR00013AA 4

6. Cover the wheel hub (9) to avoid dirt and damage.
7. Remove the bolt (10) and the pin (11). Secure the spacers of the hydraulic cylinder.
8. Remove the bolt (12) and the pin (13).

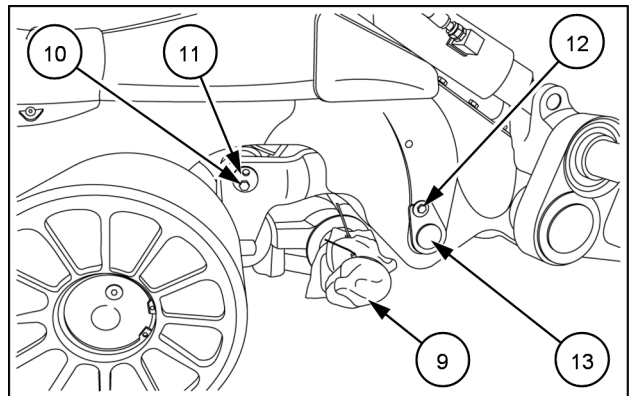

ZEIL14CR00014AA 5

9. Raise the track frame (15) and pull out the track rollers assembly (16).

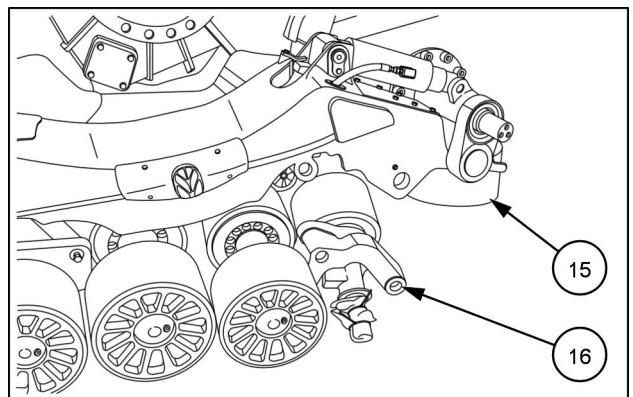

ZEIL14CR00020AA 6

Track rollers - Install - TerraGlide™

CR10.90	WE
CR7.90	WE ---
CR8.80	WE ---
CR8.90	WE ---
CR9.80	WE ---
CR9.90	WE ---

1. Place the track roller assembly (1) below the track frame (2) as shown.

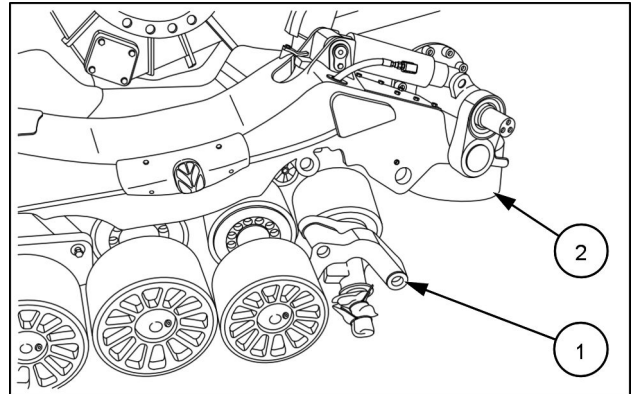

ZEIL14CR00020AA 1

2. Align the hydraulic cylinder (3) to the hinge arm of the track roller assembly with the two spacers (4) on both sides. Secure in place with the pin (5).
3. Install the bolt (6) and tighten to a torque between **133 - 153 N·m (98.1 - 112.8 lb ft)**.

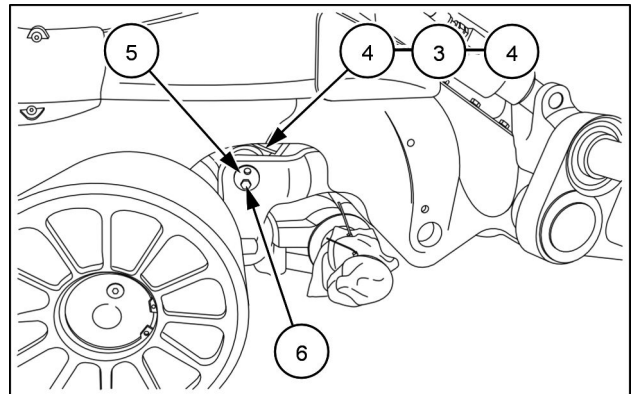

ZEIL14CR00031AZ 2

4. Align the hole on the other side of the hinge arm to the hole on the track frame and install the pin (7).
5. Apply **LOCTITE® 242®** to the bolt (8) and tighten to a torque between **70 - 80 N·m (51.63 - 59 lb ft)**.
6. Clean the shaft (9).

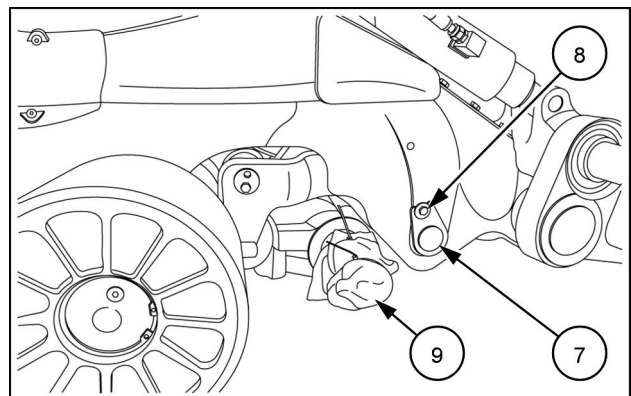

ZEIL14CR00014AA 3

7. Install the track roller (10) along with the bearings. Install the retainer (11) and the bolt (12).

NOTE: Make sure that the bearings, O-ring and track roller is clean from any dust or dirt.

8. Tighten the bolt (12) to a torque between **455 - 510 N·m (335.6 - 376.2 lb ft)**.

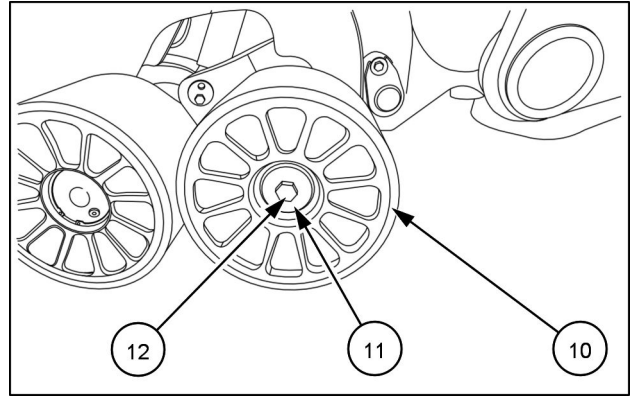

ZEIL14CR00013AA 4

9. Install the O-ring (13), the cover (14) and the circlip (15).

NOTE: Apply a small amount of **NEW HOLLAND AMBRA GR 75 MD** to the O-ring before installation.

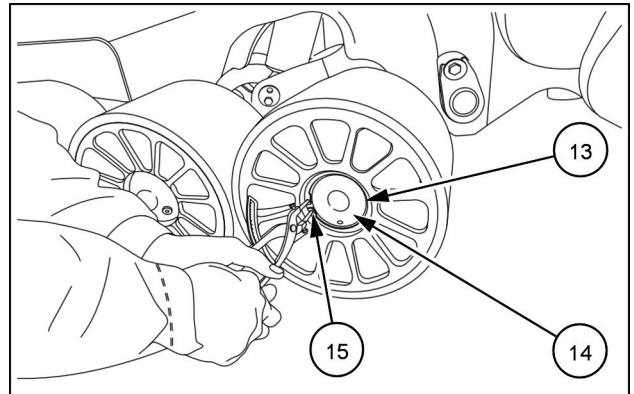

ZEIL14CR00012AA 5

10. Install the drain plug (16) and tighten to a torque between **4 - 4.5 N·m (2.95 - 3.32 lb ft)**.
11. Fill the track roller hub with the recommended oil, refer to the operator's manual of the machine.

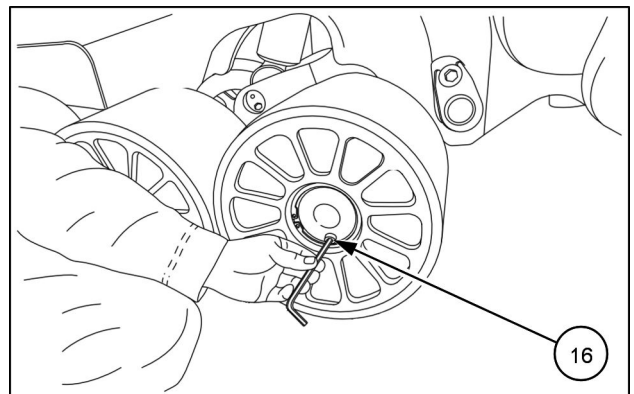

ZEIL14CR00011AA 6

12. Install the rubber track, refer to **Rubber track - Install - TerraGlide™ (48.100)**.
13. Calibrate the tracks, refer to the operator's manual of the machine.