

4. Reconnect the electrical connectors (1) and (2).

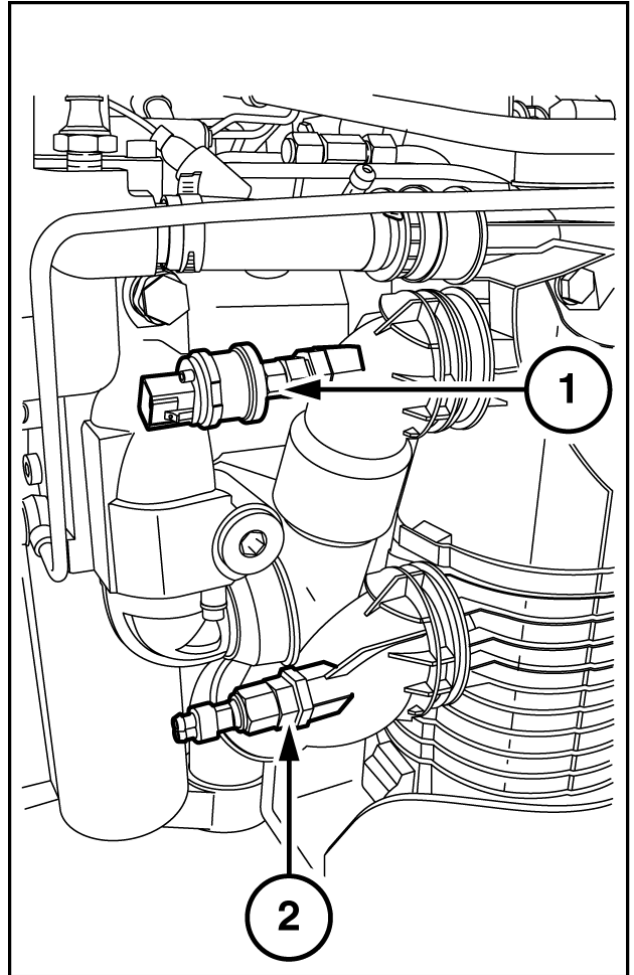

BAIL12APH187AAB 4

5. Install the filter guard and torque bolts (1) to **85 N·m (62.7 lb ft)**.

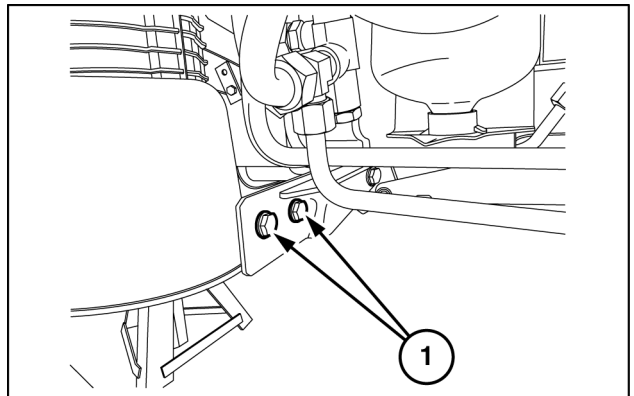

BAIL12APH185AAB 5

## Oil filters - Install

T6.140 AutoCommand	WE
T6.150 AutoCommand	WE
T6.160 AutoCommand	WE

1. Lubricate all O-rings before installation

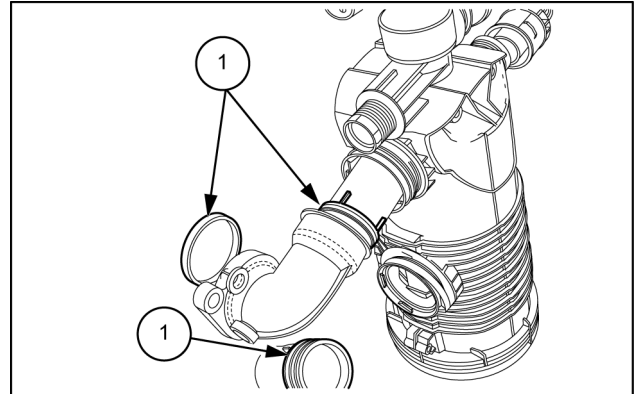

BAIL13TR00172AB 1

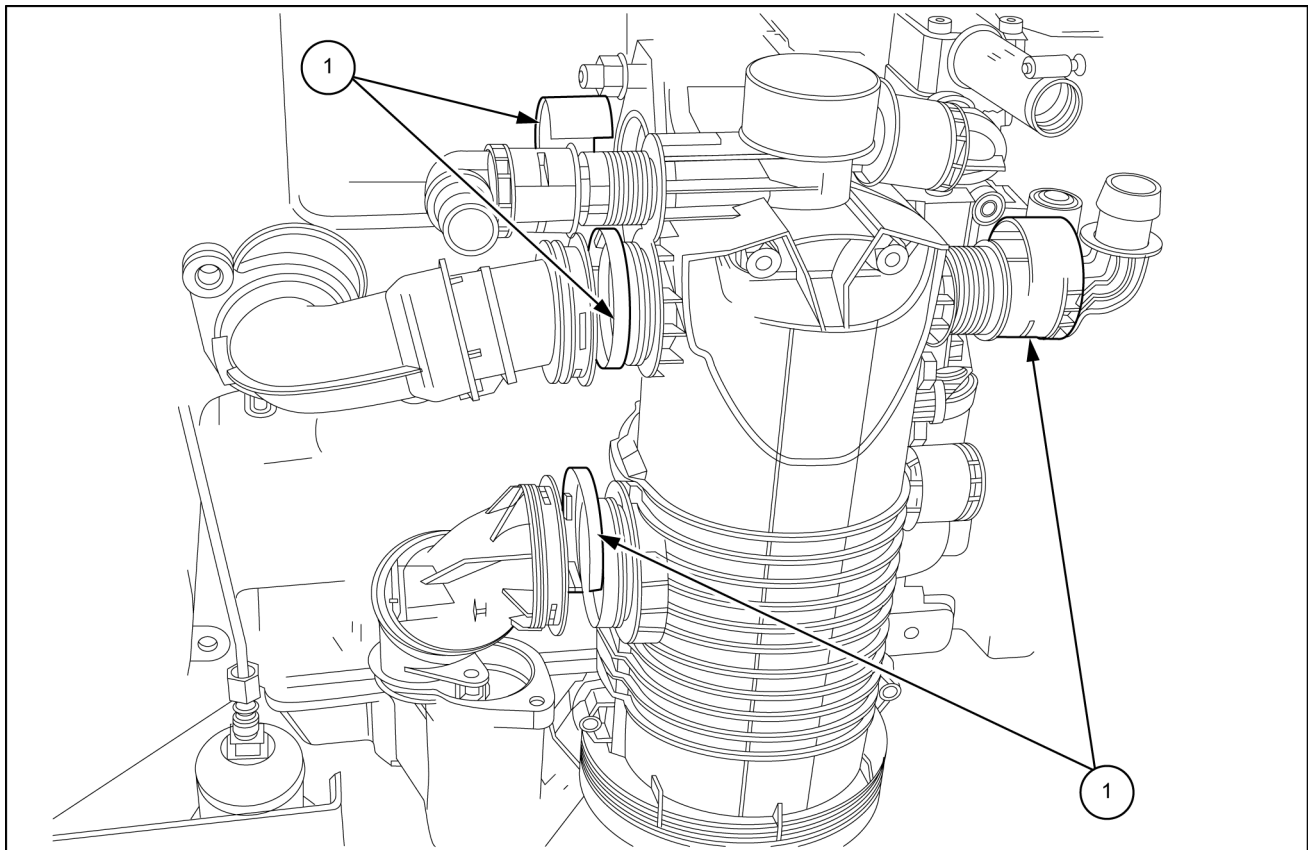

BAIL13TR00173FB 2

**Location of clip connectors (1)**

2. Insert the clips **(1)** into the grooves **(2)** to complete filter pipe assembly.

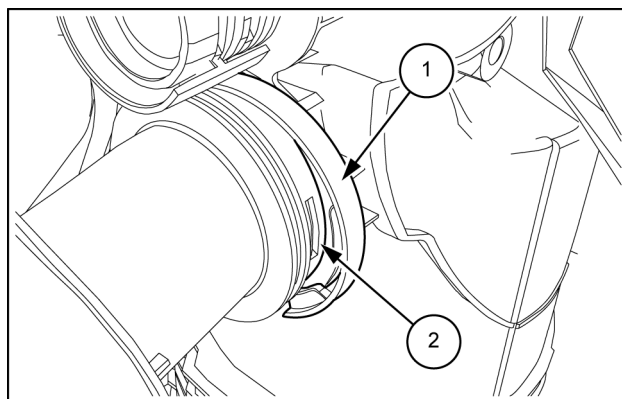

BAIL13TR00174AB 3

3. Position the filter assembly for mounting to the centre housing. Ensure the suction pipe **(1)** is correctly located in the oil sump orifice.
4. Rotate the filter so that the mounting face is flush with the pump gear housing.

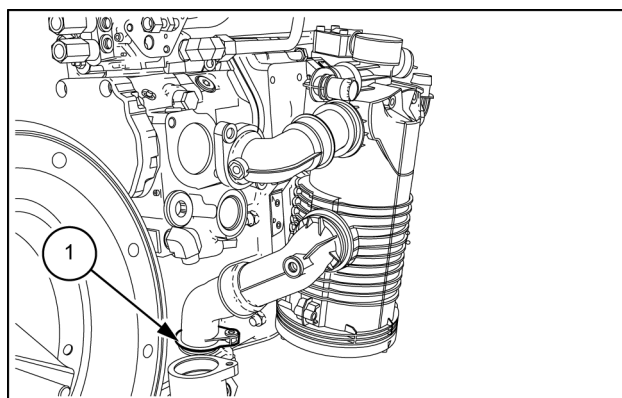

BAIL13TR00175AB 4

5. Ensure the suction pipe is correctly fitted. Incorrect fitting Figure 5.

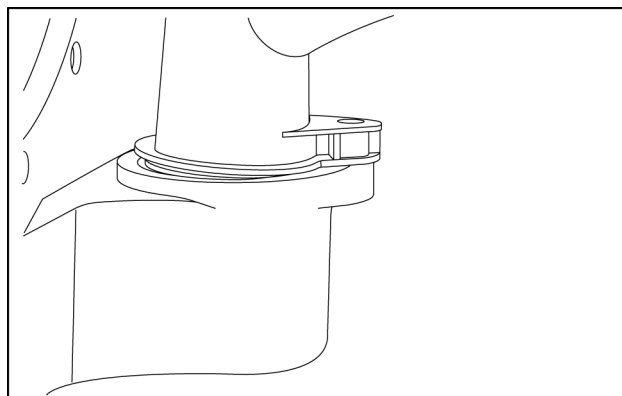

BAIL13TR00053AB 5

6. Correct fitting Figure 6.

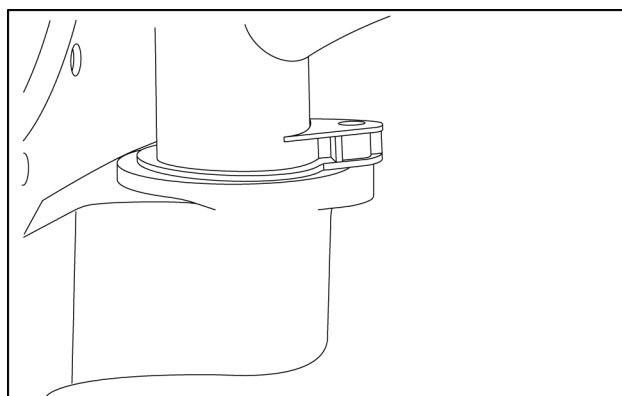

BAIL13TR00054AB 6