

Main Roller Bearing Replacement

The main rollers can be removed from the plunger through the side of the baler. Remove only one roller at a time, except when removing the plunger.

Removal

See the safety warnings at the beginning of this section and follow the procedures.

1. Apply the flywheel brake.
2. Disconnect the implement drive line from the tractor.
3. Loosen the cap screws for the shaft retainer.

If you are removing the rear roller assembly, loosen the bolt in the pusher plate. Move the shaft retainer out of the groove in the roller shaft and tighten the cap screws.

If you are removing the front roller assembly, loosen the jam nut on the pusher bolt and then loosen the bolt. Move the shaft retainer out of the groove in the roller shaft and tighten the cap screws.

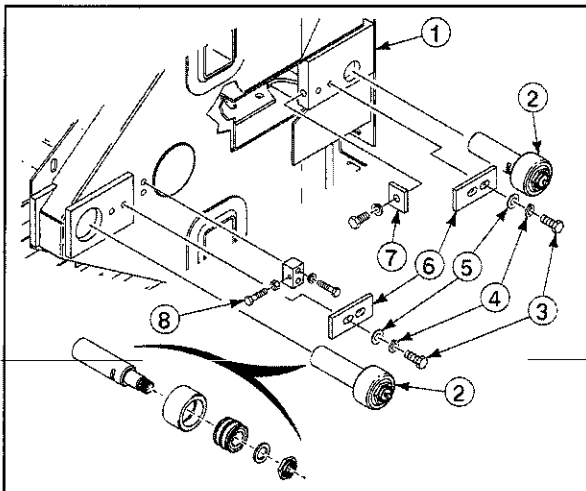

L93A-0225

1. Plunger
2. Main Roller Assembly
3. Cap Screws
4. Lock Washers
5. Hardened Plain Washers
6. Shaft Retainers
7. Pusher Plate
8. Pusher Bolt and Jam Nut

4. Remove the roller assembly. Use a prybar to apply force between the plunger and the inside edge of the roller assembly. On the front main roller, it can be necessary to use a jack to remove the roller shaft from the roller adjustment eccentric.

Installation

See the safety warnings at the beginning of this section and follow the procedures.

1. Align the groove in the roller shaft with the shaft retainer, and install the roller assembly in the plunger.

2. Loosen the cap screws in the shaft retainer.

If you are installing the rear roller assembly, tighten the bolt in the pusher plate. The pusher plate must push the shaft retainer tight into the groove on the roller shaft.

If you are installing the front roller assembly, adjust the pusher bolt against the shaft retainer. The pusher bolt must push the shaft retainer tight into the groove on the roller shaft. Tighten the jam nut on the pusher bolt.

Make sure the shaft retainer is seated in the slot in the roller shaft. Tighten the cap screws in the shaft retainer.

NOTE: Periodically inspect the main rollers to make sure the roller shafts are held tight by the shaft retainer. Damage to the plunger can result if the roller shaft is loose.

3. Lubricate the splines of the tractor PTO shaft with oil or grease. Connect the IDL to the tractor PTO shaft.

If the IDL has a quick disconnect yoke, make sure the locking mechanism is seated in the groove on the shaft.

If the IDL has a clamp yoke, tighten the bolts to 76 LB·FT (105 N·m).

WARNING

A yoke that is not installed correctly can slip off a shaft and result in injury to persons or damage to the machine.

When installing a quick disconnect yoke, the locking mechanism must be seated in the groove on the shaft.

When installing a clamp yoke, tighten the bolt(s) to the correct torque.

After installing a yoke, pull on the yoke to make sure the IDL cannot be pulled off the shaft.

Disassembly

1. Use a 3/16 IN (4.5 mm) wide chisel to straighten the stake nut flange.
2. Remove and discard the stake nut. Use a new stake nut at assembly.

3. Remove the tongued washer. Remove the roller from the roller shaft.

4. Remove and discard the two bearing cups and retaining ring from the inside of the roller.

5. Remove and discard the two bearing cones and the ID spacer from the roller shaft.

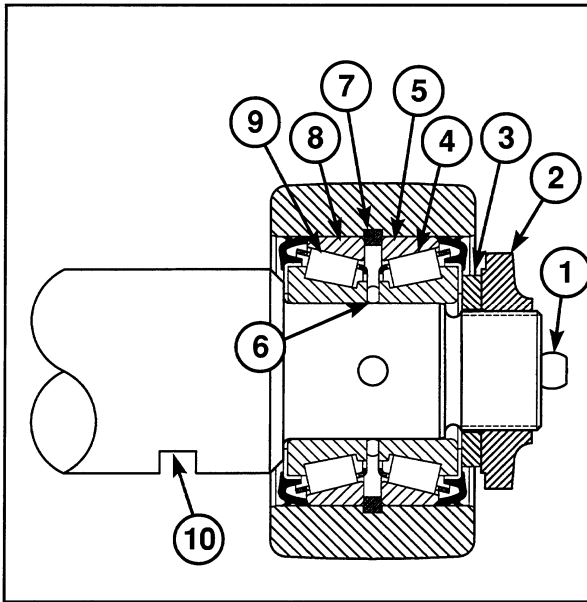

L92A-0014

1. Grease Fitting
2. Stake Nut
3. Tongued Washer
4. Outer Bearing Cone
5. Outer Bearing Cup
6. ID Spacer
7. Retaining Ring
8. Inner Bearing Cup
9. Inner Bearing Cone
10. Notch for Shaft Retainer