

Wheel Bearing and Wheel Hub

Each front wheel and tire assembly is bolted to its respective front hub and brake drum assembly. Two opposed tapered roller bearings are installed in each hub. A wheel seal is installed at the inner end of the hub to prevent lubricant from leaking into the drum. The entire assembly is retained to its spindle by an adjusting nut and cotter pin.

⚠ CAUTION: Wheel seals on front axles should be replaced any time the axle lubricants on that axle are changed from the factory-installed mineral lube to synthetic lube or vice versa.

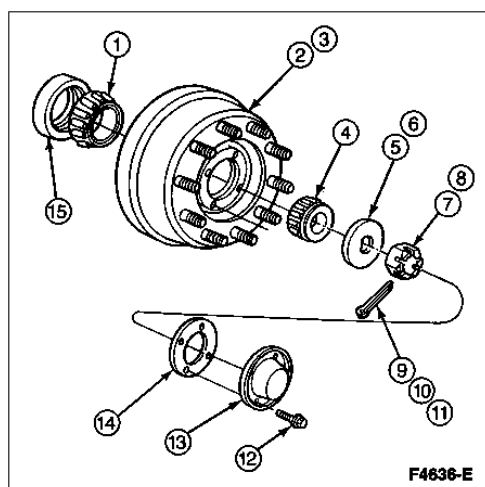

Item	Part Number	Description
1	1201	Inner Bearing
2	1125	Drum Assembly
3	1126	Drum Assembly
4	1216	Outer Bearing
5	385603	Washer
6	3293	Washer
7	385602	Nut
8	3276	Nut
9	72145	Cotter Pin
10	72171	Cotter Pin
11	72147	Cotter Pin
12	56520	Bolt
13	1131	Hub Cap
14	1153	Gasket
15	1190	Wheel Seal

Section 04-01: Suspension and Wheel Hubs, Front 1996 CF-7000-8000, CFT-8000 Workshop Manual
DIAGNOSIS AND TESTING

Suspension and Wheel Hubs, Front

Refer to Section 04-00 .

Spring**Removal**

1. Raise vehicle until weight is off front springs, with wheels still touching floor. Remove shock absorber. Refer to Shock Absorber in the Removal and Installation portion of this section.
2. Remove lock bolts that secure pin in front bracket.
3. Remove spring pin from front bracket.

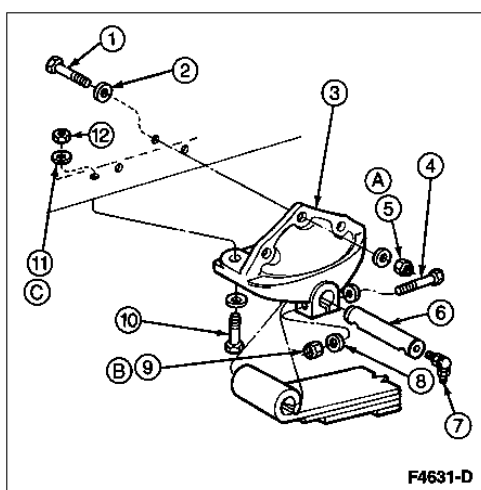

Item	Part Number	Description
1	58742	Bolt
2	44882-S2	Washer
3	5340	Front Spring Front Bracket
4	58684	Lock Bolt
5	34992	Nut
6	5A314	Pin
7	87916	Lube Fitting, 90-Degree
8	44879	Washer
9	34989	Nut
10	58721	Bolt
11	44881	Washer
12	44882-S2	Nut
A	Â	Tighten to 299-406 Nm (220-300 Lb-Ft)
B	Â	Tighten to 102-142 Nm (75-105 Lb-Ft)
C	Â	Tighten to 204-277 Nm (150-205 Lb-Ft)