

Universal Joints

NOTE: Other type universal joints (4635) should not be used in place of this type. Driveshaft imbalance and vibration may result.

The universal joints are:

- lubed-for-life design.
- equipped with nylon thrust washers, located at each base of the bearing cup, which control end play, position the needle bearing and improve grease movement.

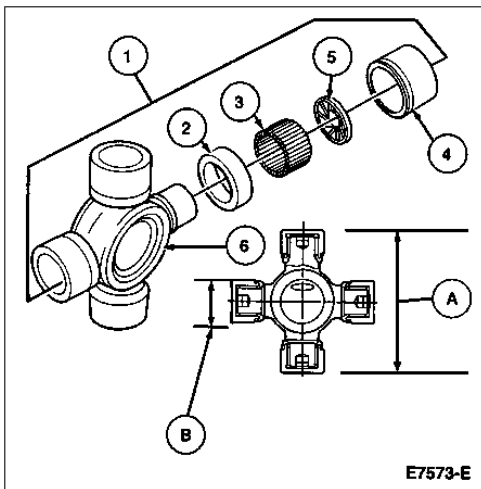

Item	Part Number	Description
1	4635	Universal Joint
2	Â	Grease Seal (Part of 4635)
3	Â	32 Needle Rollers (Part of 4635)
4	Â	Bearing Cup (Part of 4635)
5	Â	Thrust Washer (Part of 4635)
6	Â	Spider (Part of 4635)
A	Â	Series 1310 82.55 mm (3.250 inch) Series 1330 92.07 mm (3.625)
B	Â	26.98 mm (1.0625 inch)

NOTE: Span measurements are with bearing cups fully seated on spider.

Vehicles are equipped with two different size universal joints. The most common size is 1310, 82.55 mm (3.25 inch) span. Heavy duty applications use 1330, 92.07 mm (3.625 inch) span. Both sizes use 26.98 mm (1.0625 inch) diameter bearing cups.