

Driveshaft Front  [Printable View \(189 KB\)](#)

Material

Item	Specification
Threadlock and Sealer TA-25	WSK-M2G351-A5

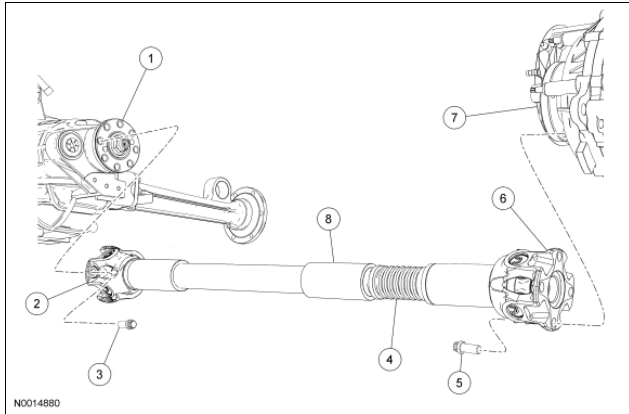

Item	Part Number	Description
1	4858	Pinion Flange
2	4866	Driveshaft flange
3	N800594-S100	Driveshaft flange-to-pinion flange bolt
4	4421	Driveshaft slip-yoke boot
5	N800594-S100	Driveshaft flange-to-transfer case output flange bolt
6	4866	Driveshaft flange
7	7061	Transfer case output flange
8	4817	Driveshaft

Removal and Installation

1. With the vehicle in NEUTRAL, position it on a hoist. For additional information, refer to [Section 100-02](#) .
2. Remove the front driveshaft shield nuts and the front driveshaft shield.
 - To install, tighten to 25 Nm (18 lb-ft).

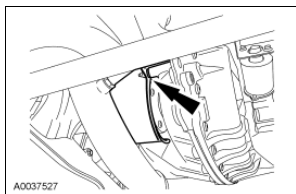

3. Index-mark the front driveshaft flange to the pinion flange to maintain alignment during installation.

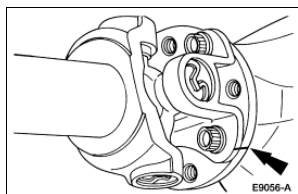

4. Index-mark the rear driveshaft flange to the transfer case flange to maintain alignment during installation.
5. Remove the 4 driveshaft flange bolts from the transfer case
 - To install, tighten to 103 Nm (76 lb-ft).

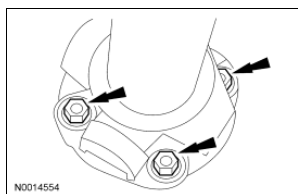

6. Remove the 4 driveshaft flange bolts from the pinion flange.
 - To install, tighten to 103 Nm (76 lb-ft).

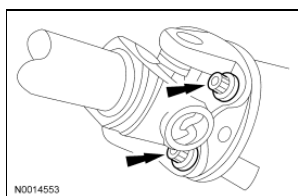

7. Remove the front driveshaft.

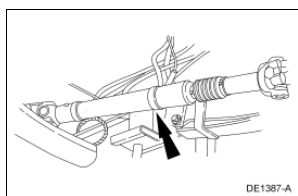

8. **⚠ CAUTION: If new bolts are not available, coat the threads of the original bolts with Threadlock and Sealer.**

NOTE: Align the index marks made during removal.

To install, reverse the removal procedure.

- Install new driveshaft flange bolts.

Driveshaft Rear, One-Piece  [Printable View \(159 KB\)](#)

Material

Item	Specification
Threadlock and Sealer TA-25	WSK-M2G351-A5

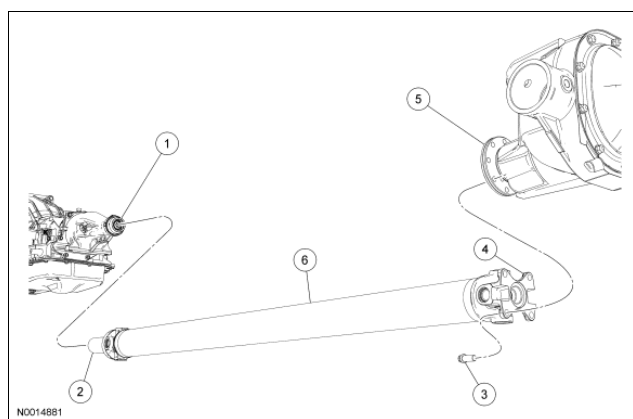

Item	Part Number	Description
1	7A309	Transmission extension housing
2	4841	Driveshaft slip yoke
3	N800594-S100	Driveshaft flange-to-pinion flange bolt
4	4866	Driveshaft flange
5	4858	Pinion flange
6	4602	Driveshaft

Removal and Installation

NOTE: For automatic transmissions, when installing a new driveshaft, match the yellow dots on the driveshaft to the yellow dots on the pinion flange and the output shaft to maintain balance during installation.

1. With the vehicle in NEUTRAL, position it on a hoist. For additional information, refer to [Section 100-02](#).
2. Index-mark the driveshaft flange to the pinion flange to maintain alignment during installation.

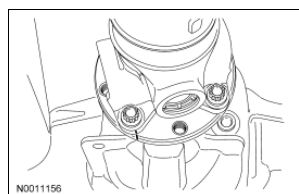

3. Index mark the driveshaft to the extension housing to maintain alignment during installation.

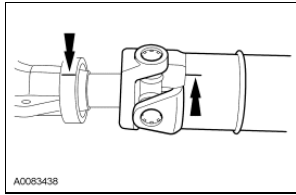

4. Remove and discard the 4 driveshaft flange bolts.
 - To install, tighten to 103 Nm (76 lb-ft).

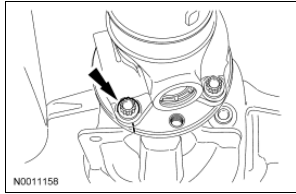

5. **⚠ CAUTION: The driveshaft flange fits tightly on the flange pilot. Never hammer on the driveshaft or any of its components to disconnect the driveshaft flange from the flange pilot. Pry only in the area shown with a suitable tool to disconnect the driveshaft flange from the flange pilot.**

Using a suitable tool as shown, disconnect the driveshaft flange from the flange pilot and remove the driveshaft.

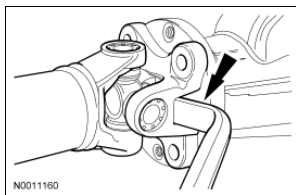

6. Plug the extension housing to prevent fluid loss.
7. **⚠ CAUTION: The driveshaft flanges fits tightly on the pinion flange pilots. To make sure that the driveshaft flanges seat squarely on the pinion flange pilots, tighten the driveshaft flange bolts evenly in a cross pattern.**

⚠ CAUTION: If new bolts are not available, coat the threads of the original driveshaft flange bolts with Threadlock and Sealer.

NOTE: Align the index marks made during removal.

To install, reverse the removal procedure.

- Install new driveshaft flange bolts.

Driveshaft Rear, Two-Piece  [Printable View \(180 KB\)](#)

Material

Item	Specification
Threadlock and Sealer TA-25	WSK-M2G351-A5

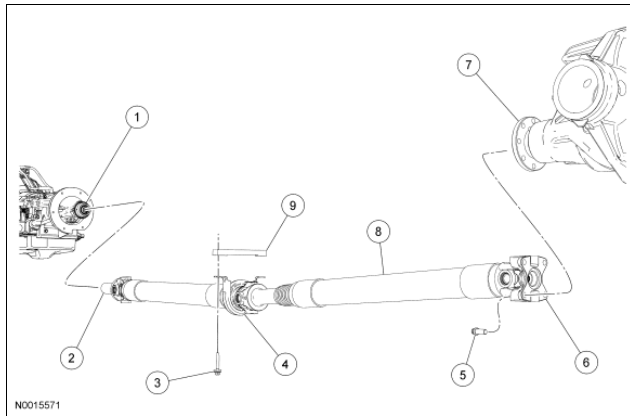

Item	Part Number	Description
1	7A309	Transmission extension housing
2	4841	Driveshaft slip yoke
3	W707472	Driveshaft center bearing bolt
4	4K145	Driveshaft center bearing
5	N800594-S100	Driveshaft flange-to-pinion flange bolt
6	4866	Driveshaft flange
7	4858	Pinion flange
8	4K145	Driveshaft
9	4230	Center bearing shim (if equipped)

Removal and Installation

NOTE: For automatic transmissions, when installing a new driveshaft, match the yellow dots on the driveshaft to the yellow dots on the pinion flange and the output shaft to maintain balance during installation.

1. With the vehicle in NEUTRAL, position it on a hoist. For additional information, refer to [Section 100-02](#).
2. Index-mark the driveshaft flange to the pinion flange to maintain alignment during installation.

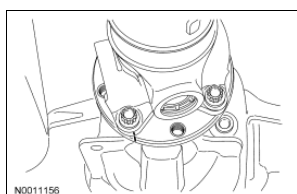

3. Index-mark the driveshaft to the extension housing to maintain alignment during installation.

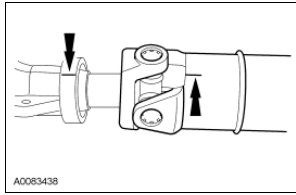

4. Remove and discard the 4 driveshaft flange bolts.
 • To install, tighten to 103 Nm (76 lb-ft).

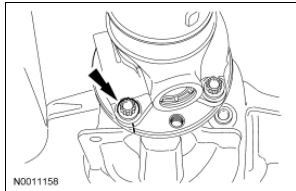

5. **⚠ CAUTION:** The driveshaft flange fits tightly on the flange pilot. Never hammer on the driveshaft or any of its components to disconnect the driveshaft flange from the flange pilot. Pry only in the area shown with a suitable tool, to disconnect the driveshaft flange from the flange pilot.

Using a suitable tool as shown, disconnect the driveshaft flange from the flange pilot.

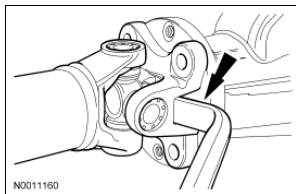

6. Remove the driveshaft center bearing bolts and remove the driveshaft.
 1. Remove the driveshaft center bearing bolts.
 2. Lower the driveshaft and slide the driveshaft slip yoke rearward off of the output shaft.
 ♦ To install, tighten to 48 Nm (35 lb-ft).

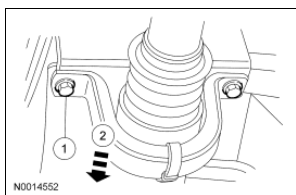

7. Plug the extension housing to prevent fluid loss.

8. **⚠ CAUTION:** The driveshaft flanges fits tightly on the pinion flange pilots. To make sure that the driveshaft flanges seat squarely on the pinion flange pilots, tighten the driveshaft flange bolts evenly in a cross pattern.

⚠ CAUTION: If new bolts are not available, coat the threads of the original driveshaft flange bolts with Threadlock and Sealer.

NOTE: Align the index marks made during removal.

To install, reverse the removal procedure.

- Install new driveshaft flange bolts.
-

Driveshaft Slip Yoke Boot  [Printable View \(134 KB\)](#)

Special Tool(s)

	Installer, Keystone Clamp 211-002 (T63P-9171-A)
---	--

Material

Item	Specification
Premium Long-Life Grease XG-1-C	ESA-M1C75-B

Removal

1. Remove the driveshaft. For additional information, refer to [Driveshaft Front](#) or [Driveshaft Rear, Two-Piece](#) in this section.
2. **⚠ CAUTION: Do not, under any circumstance, clamp the driveshaft in the jaws of a vise or similar holding fixture. Denting or localizing fracture can result, causing driveshaft failure during vehicle operation.**

Place the driveshaft on a suitable workbench. Do not damage the tubes.

3. Remove the driveshaft slip yoke from the driveshaft.
 1. Cut and discard the driveshaft slip-yoke boot clamps.
 2. Remove the driveshaft slip yoke from the driveshaft.

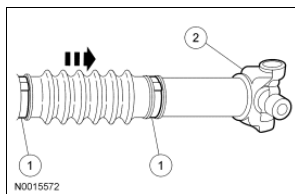

4. Remove the slip-yoke boot from the driveshaft.
 - Inspect the boot for damage. Discard the boot as necessary.

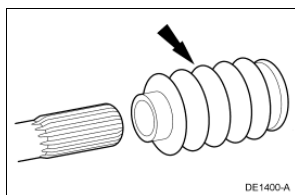

5. Inspect the lubricant on the driveshaft splines and in the driveshaft slip yoke for contamination. If contaminated, inspect the driveshaft splines and the driveshaft slip yoke for wear. Install new components as necessary.

Installation

1. Position the new small driveshaft slip-yoke boot clamp on the driveshaft stub shaft.
2. Slide the small opening end of the slip-yoke boot on the driveshaft stub shaft, as far as it will travel.

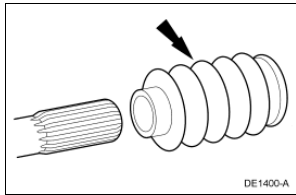

3. Using the special tool, crimp the driveshaft slip-yoke boot clamp.

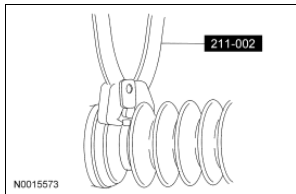

4. Install the driveshaft slip-yoke on the driveshaft.
 1. Pull the slip-yoke boot toward the driveshaft. Lubricate the driveshaft splines with approximately 10 grams (0.24 oz) of grease.
 2. Position the new large slip-yoke boot clamp.
 3. Align the blind splines, and install the driveshaft slip yoke on the driveshaft.

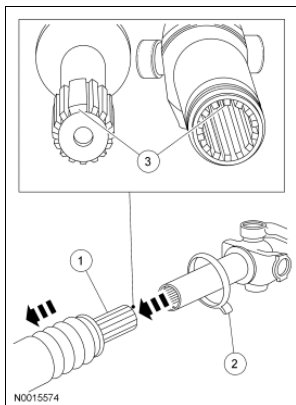

5. Set the driveshaft assembled length to specification.
 1. Remove any excess grease from the slip-yoke boot and driveshaft slip-yoke surfaces.
 2. Position the slip-yoke boot in the slip-yoke boot groove.
 3. Set the driveshaft assembled length to specification.
 - ◆ Measure from the stub shaft weld to the U-joint centerline.
 4. Bleed the air from the slip-yoke boot.

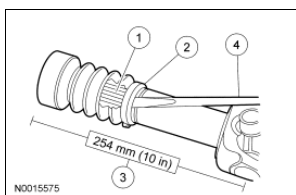

6. Using the special tool, crimp the large driveshaft slip-yoke boot clamp.