

FUEL SYSTEM (CONT'D)

Injection Pump Governor Housing Disassembly And Assembly (Cont'd)

Governor Fork

Figure 70-70-16

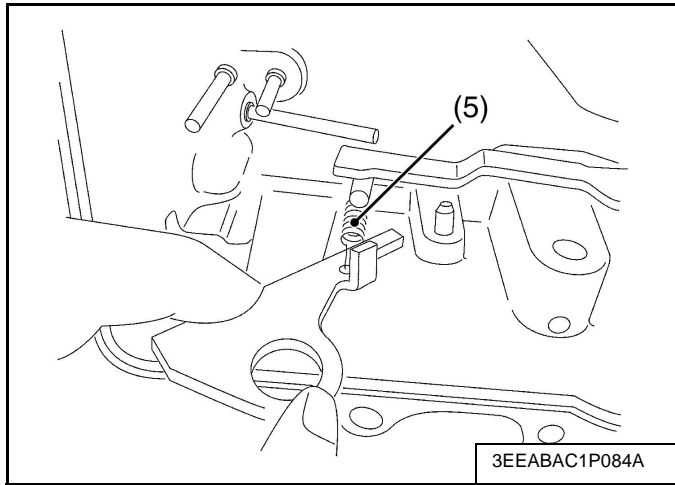

Remove the governor lever assembly (Item 3) **[Figure 70-70-16]** from the governor housing.

Figure 70-70-17

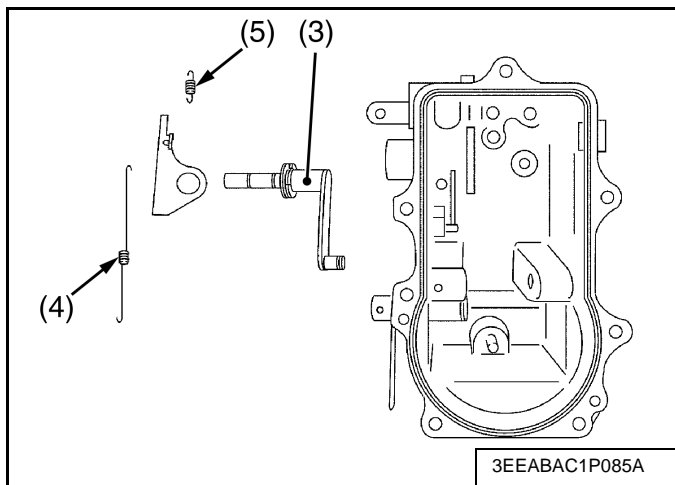

Remove the start spring (Item 4) and the stop spring (Item 5) **[Figure 70-70-17]**

Stop Lever

Figure 70-70-18

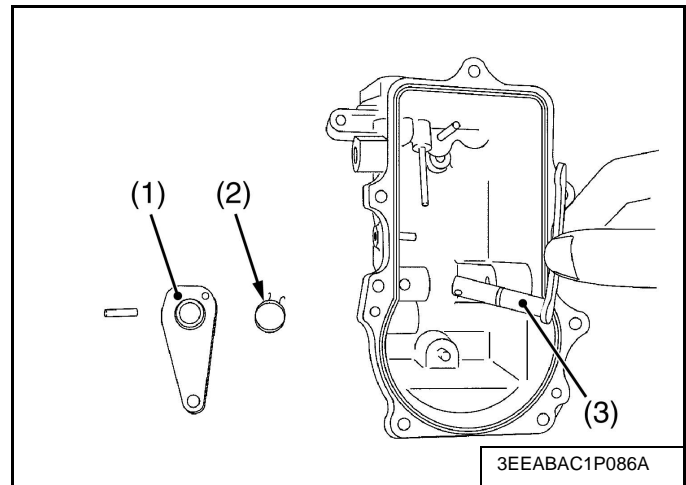

Remove the stop lever (Item 1) and the return spring (Item 2) **[Figure 70-70-18]**.

Remove the stop lever shaft (Item 3) **[Figure 70-70-18]**.

FUEL SYSTEM (CONT'D)

Fuel Shutoff Solenoid - Checking

Figure 70-70-19

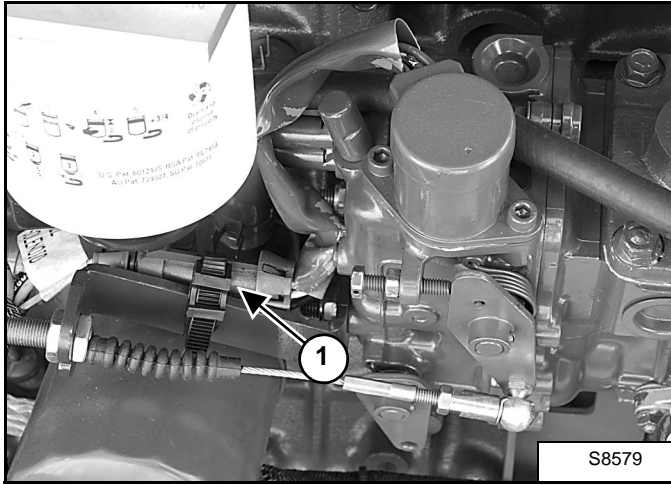

Stop the engine. The fuel shutoff solenoid connector is located between the fuel filter and the oil filter.

Remove the tie strap and disconnect the fuel shutoff solenoid connector (Item 1) [Figure 70-70-19].

Use an ohmmeter to check the fuel shutoff solenoid.

Figure 70-70-20

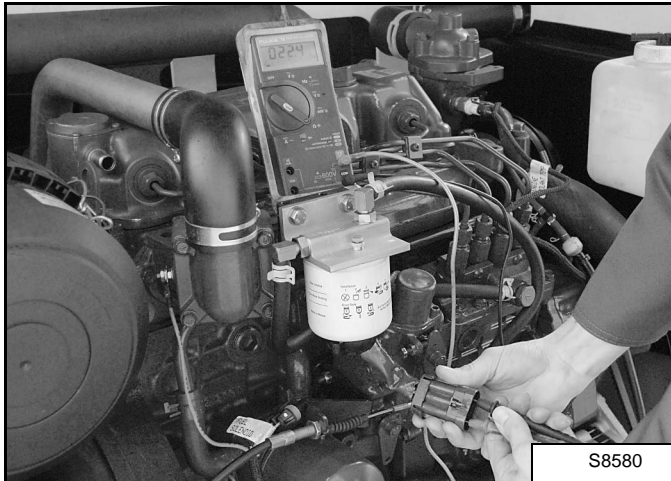

The reading between electrical connector terminal C and terminal A must be approximately 15.6 ohms [Figure 70-70-20].

The reading between electrical connector terminal C and terminal B must be approximately .35 to .40 ohms.

Fuel Shutoff Solenoid - Removal And Installation

Figure 70-70-21

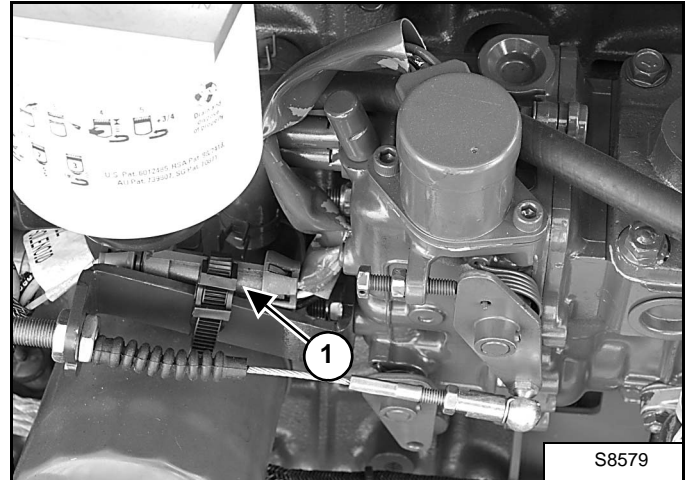

Stop the engine. The fuel shutoff solenoid connector is located between the fuel filter and the oil filter.

Remove the tie strap and disconnect the fuel shutoff solenoid connector (Item 1) [Figure 70-70-21].

Figure 70-70-22

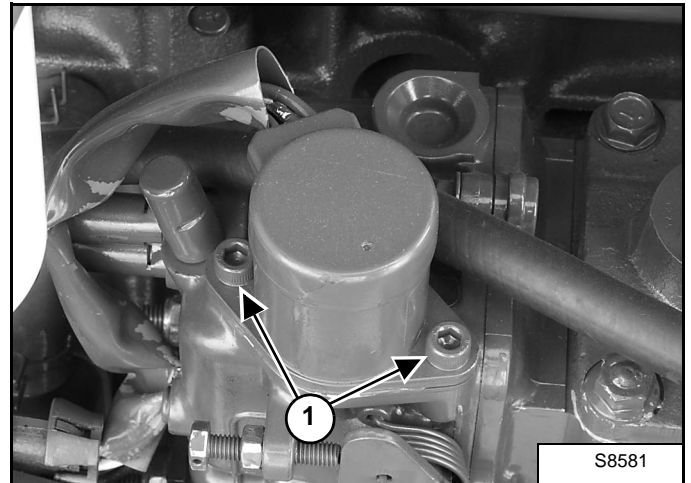

Remove the two mounting bolts (Item 1) [Figure 70-70-22] from the fuel stop solenoid. Remove the solenoid from the injection pump.