

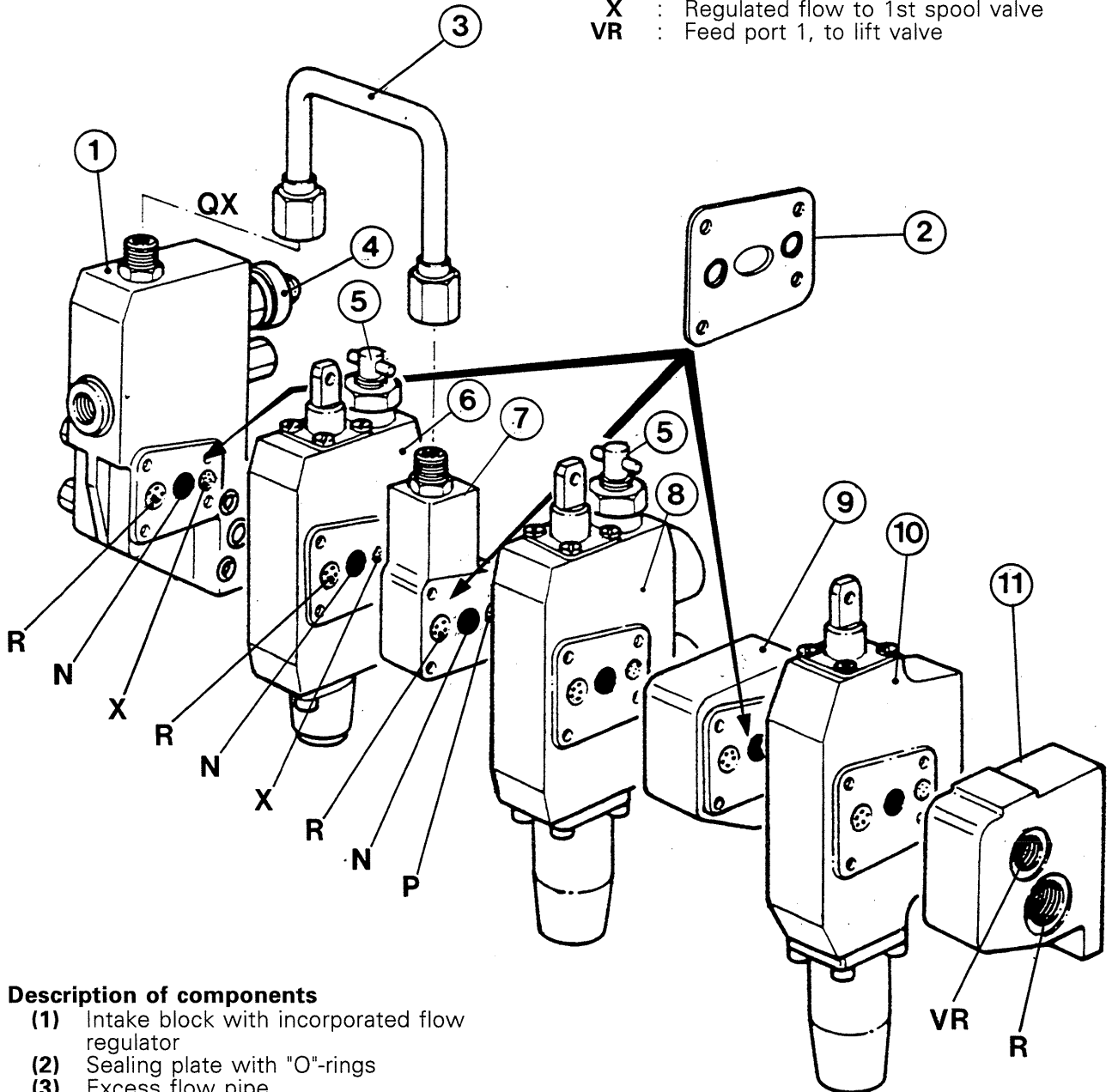

Hydraulics - Open centre

Designation of ports

- N** : Continuity (to lift valve)
- P** : Pressure
- QX** : Excess flow
- R** : Return
- X** : Regulated flow to 1st spool valve
- VR** : Feed port 1, to lift valve



Description of components

- (1) Intake block with incorporated flow regulator
- (2) Sealing plate with "O"-rings
- (3) Excess flow pipe
- (4) Flow divider regulating knob
- (5) Single/double change-over screw
- (6) 3-position spool valve, convertible single/double acting, return to neutral by spring
- (7) Intermediate block receiving excess flow
- (8) 3-position spool valve, convertible single/double acting with kickout return to neutral
- (9) Intermediate block
- (10) 4-position spool valve with kickout return to neutral
- (11) End-plate enabling continuity to lift and return to sump

Fig. 3