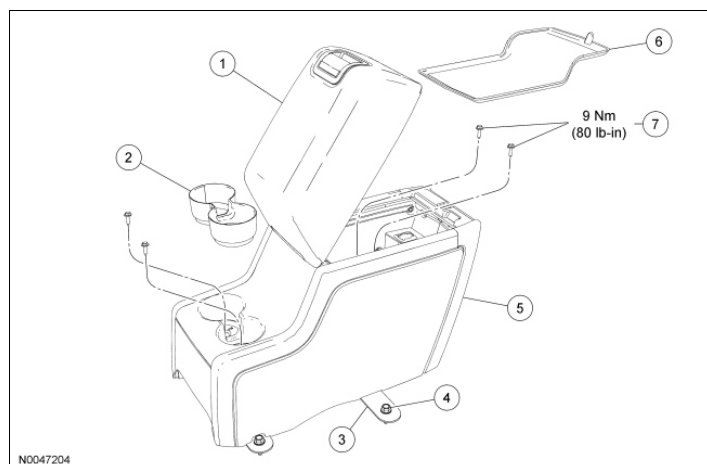

Console - Rear, Floor

Item	Part Number	Description
1	78045C80	Rear console arm rest (part of 78045)
2	78046B94	Cup holder insert
3	78672A44	Rear floor console bracket
4	W706636	Rear floor console bracket bolt (4 required)
5	7867442	Rear console assembly
6	78047A03	Storage compartment insert
7	W705549	Rear floor console bolts (4 required)

Removal and Installation

NOTE: The rear floor console bracket does not need to be removed to remove the console.

1. Open the armrest and remove the storage compartment insert.
2. Remove the 4 rear floor console bolts.
 - To install, tighten to 9 Nm (80 lb-in).
3. **NOTICE:** To prevent damage to the 2 plastic guide pegs located on the bottom of the console, pull the console straight up when removing.

Disconnect the electrical connector and remove the rear floor console.

4. **NOTICE:** To prevent damage to the 2 plastic guide pegs located on the bottom of the console, install the console straight down until the pegs are correctly seated in the holes.

To install, reverse the removal procedure.

Console - Overhead

Overhead Console With Roof Opening Panel

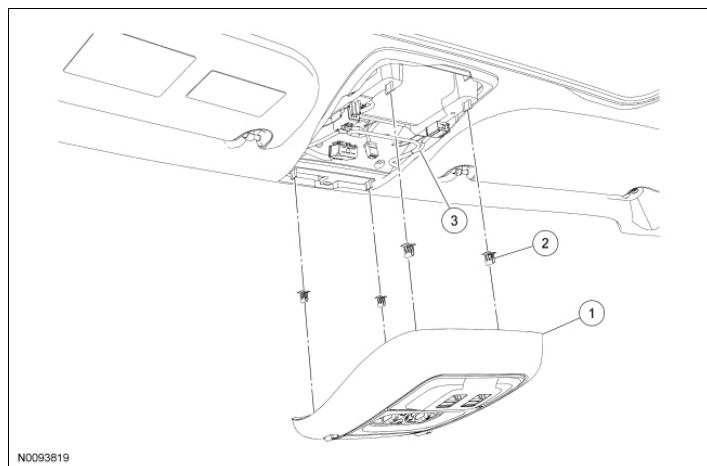

Item	Part Number	Description
1	519A70	Overhead console
2	-	Overhead console retaining clip (4 required) (part of 519A70)
3	14334	Overhead console wiring harness

Overhead Console Without Roof Opening Panel

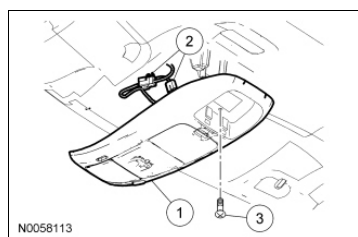

Item	Part Number	Description
1	519A70	Overhead console
2	-	Overhead console electrical connector (part of 14334)
3	-	Overhead console screw

Removal and Installation

Vehicles with roof opening panel

1. Pull the overhead console downward to release the retaining clips.

Vehicles without roof opening panel

2. Open the overhead console garage door opener storage compartment.
3. Remove the overhead console screw.

All vehicles

4. Remove the overhead console.
 5. Disconnect the electrical connectors.
 6. To install, reverse the removal procedure.
 - On vehicles with a roof opening panel, make sure to align the overhead console retaining clips to the adjacent retaining clip holes.
-

Power Point

Special Tool(s)

 <p>ST3024-A</p>	<p>Remover, Power Point Socket 501-039 or equivalent</p>
---	--

Removal

NOTE: Power point cover may differ depending on location.

1. Open the power point cover.
2. Install the Power Point Socket Remover in one of the power point socket slots.

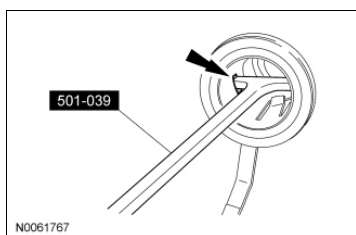

3. Position the Power Point Socket Remover so that it engages in the adjacent slot.

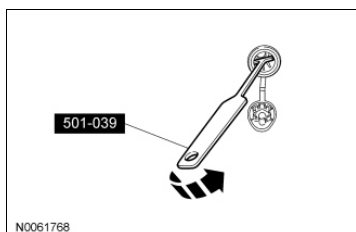

4. Using the Power Point Socket Remover, pull the power point socket out of the retainer.

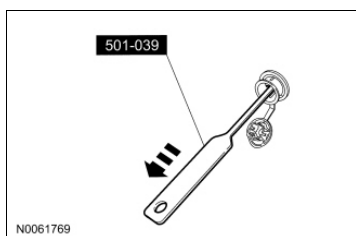

5. Disconnect the electrical connector.

Installation

1. Connect the electrical connector.

2. Slide the power point socket into the retainer.
-

General Specifications

Item	Specification
Lock Repair/Replacement Specifications	
Ignition Cylinder Lock Kit	4L3Z-11582-BB
Door Lock Kit	4L2Z-7821991-BB
Lubricants	
Multi-Purpose Grease XG-4 and/or XL-5	ESB-M1C93-B
Penetrating and Lock Lubricant (US) XL-1; Penetrating Fluid (Canada) CXC-51-A	-

Torque Specifications

Description	Nm	lb-ft	lb-in
Door latch screws	12	-	106
Exterior door handle nuts	9	-	80
Hood latch bolts	12	-	106
Liftgate latch screws	12	-	106
Liftgate striker bolts	30	22	-
Liftgate window latch screws	12	-	106
Pickup bed storage compartment latch bolts	12	-	106
Pickup bed storage compartment release handle bolts	12	-	106
Tailgate access panel bolts	5	-	44
Tailgate latch bolts	25	18	-
Tailgate latch remote control nuts	9	-	80
Tailgate release handle nuts	9	-	80

Handles, Locks, Latches and Entry Systems

NOTE: The Smart Junction Box (SJB) is also known as the generic electronic module GEM.

Hood Latch

The hood latch system contains a latch fastened to the body and a hood latch striker attached to the hood. The latch is controlled by the hood latch release handle and cable.

Front Door

The front door entry system contains a latch that is fastened to the inside of the door frame and is controlled by the exterior and interior door handles. The latch contains the door ajar switch and door lock actuator. The front doors are locked/unlocked by the Remote Keyless Entry (RKE) transmitter, the keyless entry keypad, the door lock control switches or the driver door lock cylinder.

Rear Door

The rear door entry system contains a latch that is fastened to the inside of the door frame and is controlled by the exterior and interior door handles. The latch contains the door ajar switch and door lock actuator. The rear doors can be locked/unlocked by the RKE transmitter, the keyless entry keypad, or the door lock control switches. The rear doors have a child safety lock feature, which is a manual lock on the inside of the rear door frame. When the child safety feature is on, the rear doors cannot be opened from the interior door handle.

Liftgate

The liftgate system contains a latch located on the bottom of the inside frame of the liftgate, which is controlled by the exterior liftgate release handle. The liftgate window latch is mounted on the upper center portion of the liftgate frame and includes the ajar switch and the latch actuator. The liftgate window latch is actuated by the release switch mounted on the license plate housing, the RKE transmitter, or the keyless entry keypad. The liftgate window glass release switch operates only when all the doors are unlocked.

Tailgate

The tailgate release handle is integrated with a lock cylinder. The 2 latches are actuated by 2 actuating rods that are controlled by the release handle and remote control.

Power Lock/Unlock

The Smart Junction Box (SJB) controls the power locking/unlocking feature of all of the vehicle doors, including the liftgate. The determination to lock or unlock the vehicle is based off the input received from the door lock control switch(es), the keyless entry keypad or the Remote Keyless Entry (RKE) transmitter (if the vehicle speed is less than 5 km/h [3 mph]). Power locking and unlocking of the doors function independently of the key position, vehicle speed or transmission position. The SJB activates internal relays to supply power for the door lock actuators.

The liftgate window glass is released, using the keyless entry keypad or the RKE transmitter, and does not operate if the vehicle speed is greater than 5 km/h (3 mph).

Autolock

The autolock feature locks all the doors when all the doors, including the liftgate, are closed, after the brake pedal is pressed, and the vehicle speed exceeds 20 km/h (12 mph). This feature also relocks the doors (if any doors were open) after the brake pedal is pressed, once the SJB receives door closed inputs from all door ajar switches and vehicle speed exceeds 20 km/h (12 mph). The autolock feature can be enabled/disabled, refer to [Autolock and Auto-Unlock Programming](#) in this section for programming information. The autolock feature also uses inputs from the key position, the stoplamp switch and vehicle speed through the Controller Area Network (CAN) from the ABS module.

Auto-Unlock

The auto-unlocking feature unlocks all the doors when all of the following conditions are met:

- All the doors are closed
- The key is in the run position and the vehicle was in motion at a speed greater than 20 km/h (12 mph) for a minimum of 2 seconds since the last key start. The vehicle then comes to a stop and the key is turned to the OFF or ACC position
- The driver door is opened within 10 minutes of the key being turned to the OFF or ACC position

The doors do not auto-unlock if:

- The doors are locked using the door lock control switches
- The doors are locked with the keyless entry keypad or the RKE transmitter within 10 minutes of turning the key to the OFF or ACC position
- 10 minutes elapse and the driver door is not opened

The auto-unlock feature can be enabled/disabled independently of autolock. Refer to [Autolock and Auto-Unlock Programming](#) in this section for programming information.

Smart Unlock

The smart unlock feature prevents all the doors from being locked with the key in the ignition lock cylinder. When the SJB receives a lock command from a front door lock control switch, and the key is in the ignition lock cylinder with one of the front doors open, the SJB commands all the doors to unlock.

Unlock Inhibit Feature

NOTE: The unlock inhibit feature is configured off from the factory.

The unlock inhibit feature prevents the doors from being unlocked from the door lock control switches after certain conditions have been met. This feature is designed to prevent vehicle theft.

The conditions for the unlock inhibit feature are:

- The key is out of the ignition
- All doors are closed
- The vehicle has been locked using the Remote Keyless Entry (RKE) transmitter, keyless entry keypad (if equipped), or the door lock control switch (while the front door was open then subsequently closed)
- 20 seconds have elapsed once all doors are closed and locked

Remote Keyless Entry (RKE) Transmitter

Explorer, Mountaineer

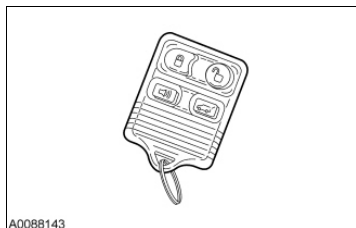

Explorer Sport Trac

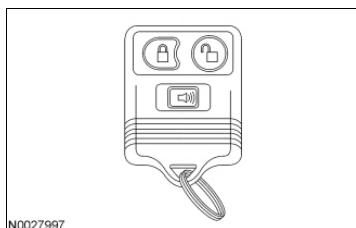

The RKE transmitter initiates the following electronic system functions:

- Unlocks the driver door (with stepped unlock enabled)
- Unlocks all doors
- Locks all doors
- Releases the liftgate window glass (Explorer only)
- Activates/deactivates the panic alarm
- Commands the interior lamps on (when unlocking) and off (when locking)
- Sounds the horn once when LOCK is pressed twice within 3 seconds, and the doors are closed
- Sounds the horn twice when LOCK is pressed twice within 3 seconds, and any door is open

The RKE transmitter has a normal operating range of 10 m (33 ft).

The RKE transmitters can be programmed using a scan tool or by using the remote keyless entry transmitter programming procedure. Refer to [Remote Keyless Entry \(RKE\) Transmitter Programming](#) in this section for programming information.

Remote Keyless Entry (RKE) Transmitter Lock/Unlock Control - Lock

The RKE transmitter feature requests that all the doors be locked when the lock button is pressed. On any press of the lock button with all doors closed, the SJB provides 1 flash of the parking lamps. If any door is ajar, no flash occurs. As soon as the last door is closed, the SJB provides the flash of the parking lamps. If 2 presses of the lock button are received within 3 seconds the horn chirps once, and the parking lamps flash twice to indicate that all the doors are closed and locked. If any door is ajar when the second lock request is received within 3 seconds of the first, the RKE transmitter feature requests the SJB chirp the horn twice without flashing the parking lamps to indicate it locked all the doors, but 1 or more doors are ajar. When the key is in the ON or START position, the parking lamp flashes and horn chirp confirmations do not occur.

Remote Keyless Entry (RKE) Transmitter Lock/Unlock Control - Unlock

The RKE transmitter feature provides lock/unlock functions independently of key position or transmission position. The RKE feature will not unlock the doors if the vehicle speed is greater than 20 km/h (12 mph). The RKE transmitter feature provides a stepped (if enabled) process for unlocking the doors. Upon receipt of the first request for unlocking the doors, the RKE control feature requests the SJB to unlock the driver door only. If another unlock request is received within 3 seconds of the first, the RKE transmitter feature requests the