

5. **NOTE:** For retainer clarity, inside of cushion side shield shown.

Separate the cushion side shield.

1. Remove the scrivet at the rear of the cushion side shield.
2. Remove the screw at the rear of the cushion side shield.
3. Remove the screw at the front of the cushion side shield.
4. Pull out to release the clips and separate the cushion side shield.

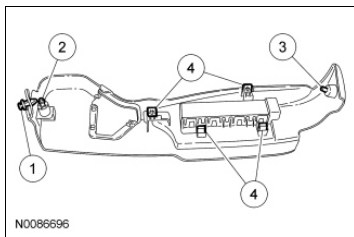

6. Separate the manual lumbar cable.

1. Remove the pin-type retainer, release all the outboard cushion trim cover J-clips and position the cushion trim cover flap up.
2. Separate the manual lumbar cable retainer.
3. Pull the manual lumbar cable cover out of the adjuster.

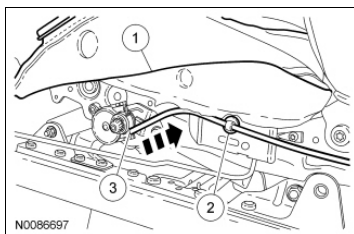

7. Remove the manual lumbar cable from the adjuster.

- Pull the lumbar cable cover out of the adjuster.
- Remove the cable end from the adjuster.
- If necessary, remove the 2 rivets and the manual lumbar adjuster.

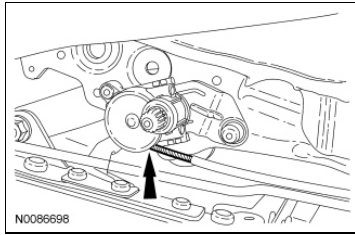

8. Separate the backrest trim cover lower J-clips and invert the backrest trim cover up to the first row of hog rings.

9. Remove the 3 first row hog rings.

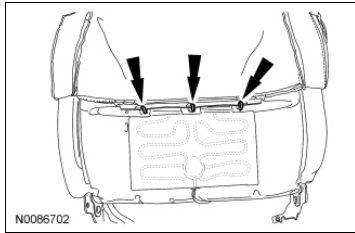

10. Invert the backrest trim cover up to the second row of hog rings.

11. Remove the manual lumbar.

1. Separate the manual lumbar cable pin-type retainer.
2. Squeeze the manual lumbar retaining clips together, on each side and separate them from the backrest frame.
3. Remove the manual lumbar.

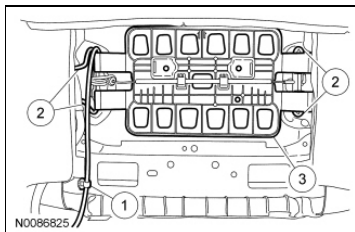

Installation

1. Install the manual lumbar in the following sequence.

1. Position the manual lumbar between the backrest foam pad and the backrest frame.
2. Squeeze the manual lumbar retaining clips together, on each side and engage them to the backrest frame.
3. Route the manual lumbar cable and attach the pin-type retainer.

2. Roll the backrest trim cover down and install the 3 first row hog rings.

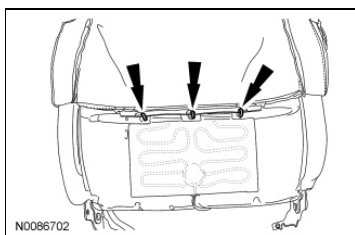

3. Roll the backrest trim cover all the way down and engage the lower J-clips.

2009 Flex Workshop Manual

- Make sure the manual lumbar cable and side air bag module wire harness are routed out from the outboard side of the backrest before engaging the lower J-clips.
 - If equipped, make sure the backrest feed wire harness is routed out from the inboard side of the backrest before engaging the lower J-clips.
4. Install the manual lumbar cable in the following sequence.
 1. Position the manual lumbar cable into the adjuster.
 2. Position the manual lumbar cable cover into the adjuster.
 3. Install the manual lumbar cable retainer.
 4. Position the cushion trim cover flap back around the side of the seat and attach all the outboard cushion trim cover J-clips.
 5. Install the manual lumbar cable in the following sequence.
 1. Position the manual lumbar cable cover into the adjuster.
 2. Install the manual lumbar cable retainer.
 3. Position the cushion trim cover flap back around the side of the seat, attach all the outboard cushion trim cover J-clips and install the pin-type retainer.
 6. Attach the cushion side shield in the following sequence.
 1. Return all retaining clips back to the cushion side shield before attaching to the seat.
 2. Align the 4 cushion side shield clips to the seat and push in seating the clips.
 3. Install the screw at the front of the cushion side shield.
 4. Install the screw at the rear of the cushion side shield.
 5. Install the scrivet at the rear of the cushion side shield.
 7. Install the manual lumbar handle in the following sequence.
 1. Install the clip onto the manual lumbar handle.
 2. Align the splines of the manual lumbar handle to the manual lumbar shaft.
 3. Push the manual lumbar handle onto the manual lumbar shaft, seating the clip.
 8. For driver seat, install the manual recliner handle in the following sequence.
 1. Install the clip onto the manual recliner handle.
 2. Align the splines of the manual recliner handle to those on the manual recliner shaft.
 3. Push the manual recliner handle onto the shaft, seating the clip.
 9. Install the recliner cover in the following sequence.
 1. Return the barrel nut back to the seat before attaching to the seat.
 2. Slide the recliner cover post into the barrel nut on the seat.
 3. Install the screw at the rear of the recliner cover.
 4. Install the scrivet at the rear of the recliner cover.
 10. Install the driver seat. For additional information, refer to [Seat -- Front](#) in this section.
-

Lumbar Assembly -- Manual, With Fold Flat

Special Tool(s)

	Vehicle Communication Module (VCM) and Integrated Diagnostic System (IDS) software with appropriate hardware, or equivalent scan tool
---	---

Removal

NOTE: The air bag warning indicator illuminates when the correct Restraints Control Module (RCM) fuse is removed and the ignition switch is ON.

NOTE: The Supplemental Restraint System (SRS) must be fully operational and free of faults before releasing the vehicle to the customer.

1. Remove the front passenger seat. For additional information, refer to Seat -- Front in this section.
2. Remove the inboard recliner lower cover.
 1. Remove the screw at the back of the inboard recliner lower cover.
 2. Remove the screw at the side of the inboard recliner lower cover.
 3. Pull out at the rear of the inboard recliner lower cover to release the retainers and remove.

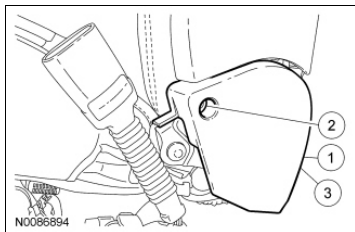

3. Remove the inboard recliner upper cover.
 1. Pull at the front and release the clip.
 2. Rotate the inboard recliner upper cover clockwise and remove.

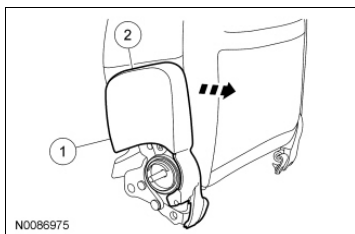

4. Remove the manual lumbar handle.
 1. Push the cushion trim cover and foam pad back and locate the manual lumbar handle clip under the cushion side shield.
 2. Remove the clip and slide the manual lumbar handle off the shaft.

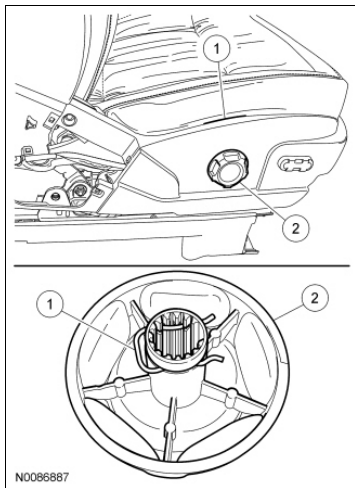

5. **NOTE:** For retainer clarity, inside of cushion side shield shown.

Separate the cushion side shield.

1. Remove the screw at the back of the cushion side shield.
2. Remove the screw at the side of the cushion side shield.
3. Remove the screw at the front of the cushion side shield.
4. Pull out on the cushion side shield to release the clips and separate.

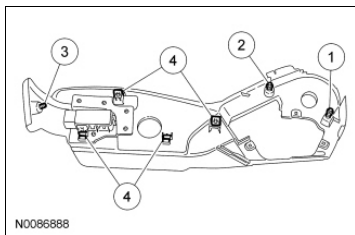

6. Remove the outboard recliner upper cover.
 1. Pull at the front and release the clip.
 2. Pivot the top of the outboard recliner upper cover back and remove.
 - ◆ Pull the fold flat release strap out through the opening.

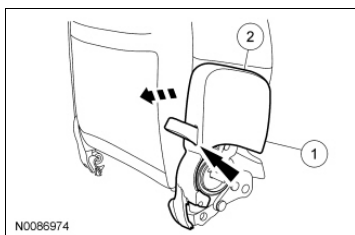

7. Remove the pin-type retainer, release all the outboard cushion trim cover J-clips and position the cushion trim cover flap up.

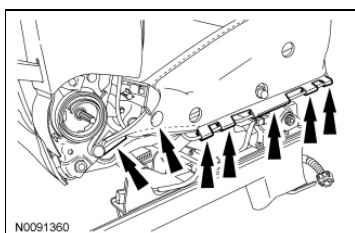

8. Separate the manual lumbar cable.
 1. Separate the manual lumbar cable retainers.
 2. Pull the manual lumbar cable cover out of the adjuster.

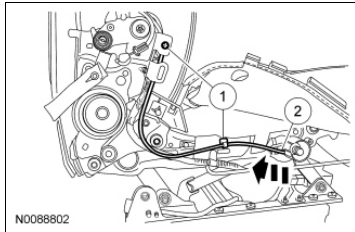

9. Remove the manual lumbar cable from the adjuster.
 - Pull the lumbar cable cover out of the adjuster.
 - Remove the cable end from the adjuster.

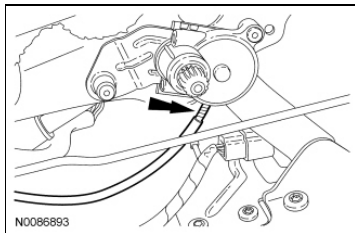

10. Using the strap on the outboard recliner, fold the backrest down to the fold flat position.

11. Separate the backrest trim cover lower J-clips.

12. Release the backrest trim cover clips and open the zippers.

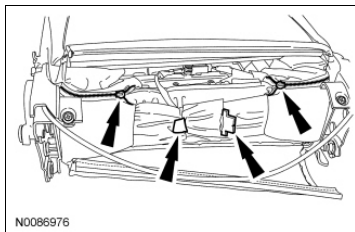

13. Separate the retainer and route the manual lumbar cable out from between the backrest frame and backrest foam pad.

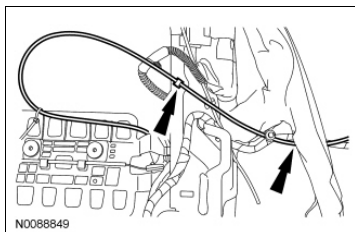

14. Squeeze the manual lumbar retaining clips together on each side and remove the manual lumbar.

Installation

1. Squeeze the manual lumbar retaining clips together on each side and install them to the backrest frame.

2. Route the manual lumbar cable and 1 pin-type retainer between the backrest frame and backrest foam pad and out the other side.
 - Attach the remaining retainer to the backrest frame.

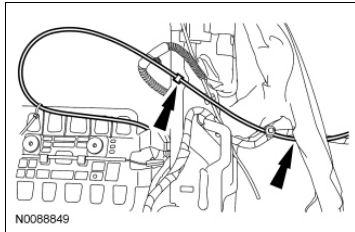

3. Install the manual lumbar cable into the adjuster.
4. Attach the manual lumbar cable in the following sequence.
 1. Install the manual lumbar cable cover into the adjuster.
 2. Install the manual lumbar cable retainers.
5. Attach the cushion trim cover outboard J-clips and install the pin-type retainer.
6. Close the backrest trim cover in the following sequence.
 1. Close the zippers.
 2. Attach the backrest trim cover clips.
 3. Attach the backrest trim cover lower J-clips.
7. Install the outboard recliner upper cover.
 1. Position the fold flat release strap through the opening.
 2. Align the outboard recliner upper cover pocket to the recliner bracket.
 3. Pivot the top of the outboard recliner upper cover forward and attach the pocket to the bracket.
 4. Push in at the front and seat the clip.
8. Attach the cushion side shield in the following sequence.
 1. Return all retaining clips back to the cushion side shield before attaching to the seat.
 2. Align the cushion side shield clips to the seat and push in, seating the clips.
 3. Install the screw at the back of the cushion side shield.
 4. Install the screw at the side of the cushion side shield.
 5. Install the screw at the front of the cushion side shield.
9. Install the manual lumbar handle in the following sequence, if equipped.
 1. Install the clip onto the manual lumbar handle.
 2. Align the splines of the manual lumbar handle to the manual lumbar shaft.
 3. Push the manual lumbar handle onto the manual lumbar shaft, seating the clip.
10. Install the inboard recliner upper cover.
 1. Align the inboard recliner upper cover pocket to the recliner bracket.
 2. Pivot the top of the inboard recliner upper cover forward and attach the pocket to the bracket.
 3. Push in at the front and seat the clip.
11. Install the inboard recliner lower cover.
 1. Align the inboard recliner lower cover to the inner cover and push in, seating the rear clips.
 2. Install the screw at the side of the inboard recliner lower cover.
 3. Install the screw at the back of the inboard recliner lower cover.
12. Install the front passenger seat. For additional information, refer to [Seat -- Front](#) in this section.

Seat Control Switch -- Front

Removal

NOTE: The Supplemental Restraint System (SRS) must be fully operational and free of faults before releasing the vehicle to the customer.

1. **⚠ WARNING:** Turn the ignition OFF and wait one minute to deplete the backup power supply. Failure to follow this instruction may result in serious personal injury or death in the event of an accidental deployment.

For passenger seat, turn the ignition OFF and wait at least one minute.

2. For driver seat, remove the manual recliner handle, if equipped.
 1. Locate the clip between the seat cushion and side shield.
 2. Remove the clip and slide the handle off the shaft.

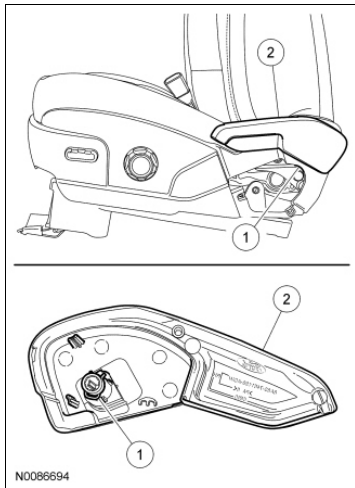

3. For passenger seat, remove the manual recliner handle.
 1. At the rear outboard side of the seat, pull the flap out to access the recliner handle clip.
 2. Locate the clip between the cushion and side shield and pull the clip off.
 3. Slide the recliner handle off the shaft.

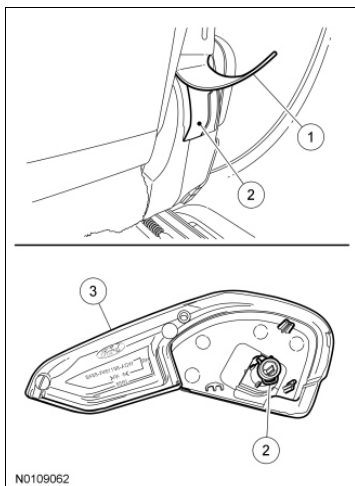

4. If equipped, remove the manual lumbar knob.
 1. Locate the clip between the seat cushion and side shield.
 2. Remove the clip and slide the knob off the shaft.

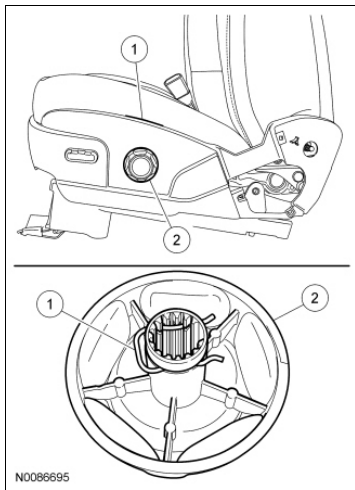

5. For driver seat, carefully pull out to disengage the retainers and remove the cushion side shield cover.
6. For passenger seat, remove the cushion side shield cover.
 1. Pull out to disengage the retainers.
 2. Pull the retainer out and around the cushion side shield to disengage.
 3. Slide the cushion side shield cover rearward and remove.

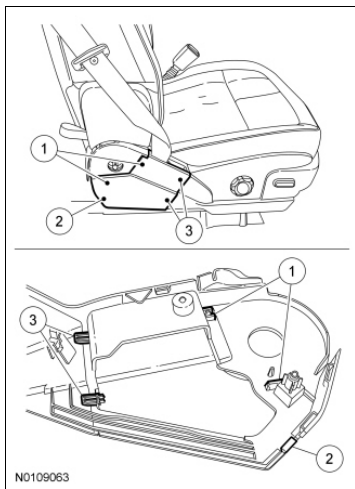

7. Separate the safety belt anchor from the seat.
 - For driver seat, remove the safety belt anchor bolt and separate the safety belt anchor from the seat.
 - For passenger seat, disconnect the Belt Tension Sensor (BTS) electrical connector, remove the safety belt anchor bolt and separate the safety belt anchor from the seat.
8. Separate the cushion side shield.
 1. Remove the scrivet at the rear of the cushion side shield.
 2. Remove the screw at the rear of the cushion side shield.
 3. Remove the screw at the front of the cushion side shield.
 4. Pull out to release the clips and separate the cushion side shield.