

## REPAIR INSTRUCTIONS

### REAR WHEEL BEARING AND HUB REPLACEMENT

#### Removal Procedure

1. Remove the rear wheel speed sensor, if equipped. Refer to **Rear Wheel Speed Sensor Replacement**.
2. Remove the brake drum. Refer to **Brake Drum Replacement**.

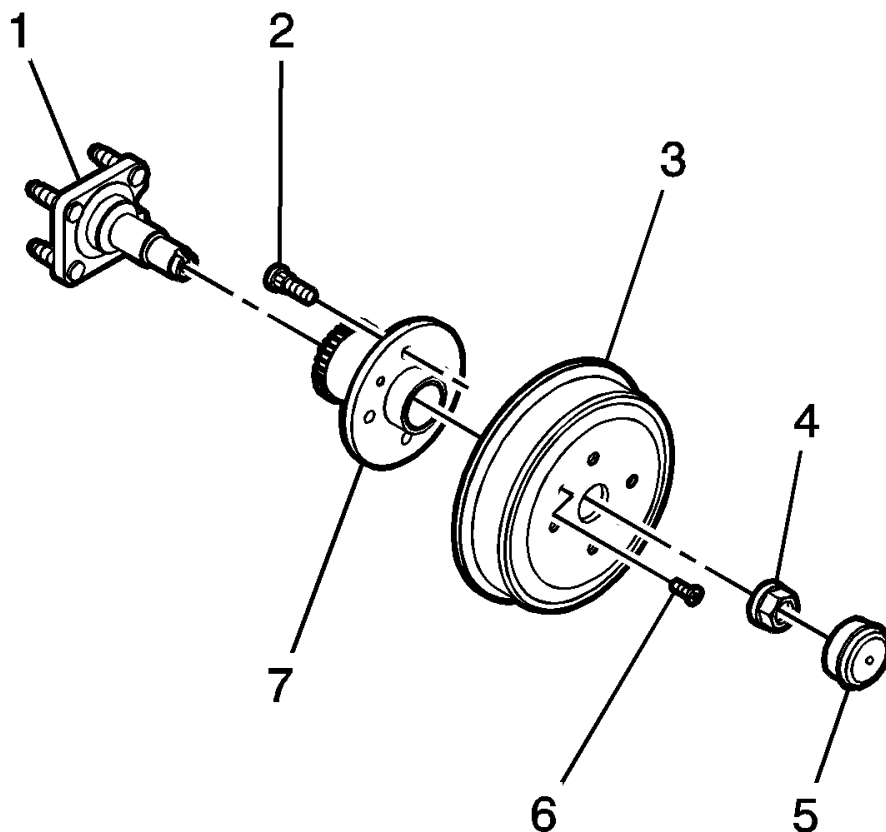

**Fig. 2: Rear Wheel Bearing/Hub Components**  
Courtesy of GENERAL MOTORS CORP.

3. Unstake the caulking nut (4).
4. Remove the caulking nut.

**NOTE:** Pull the wheel bearing and hub assembly straight off the spindle. The 2 inner wheel bearing races may not be secure.

5. Remove the wheel bearing and hub assembly (7) from the spindle (1).

**Installation Procedure**

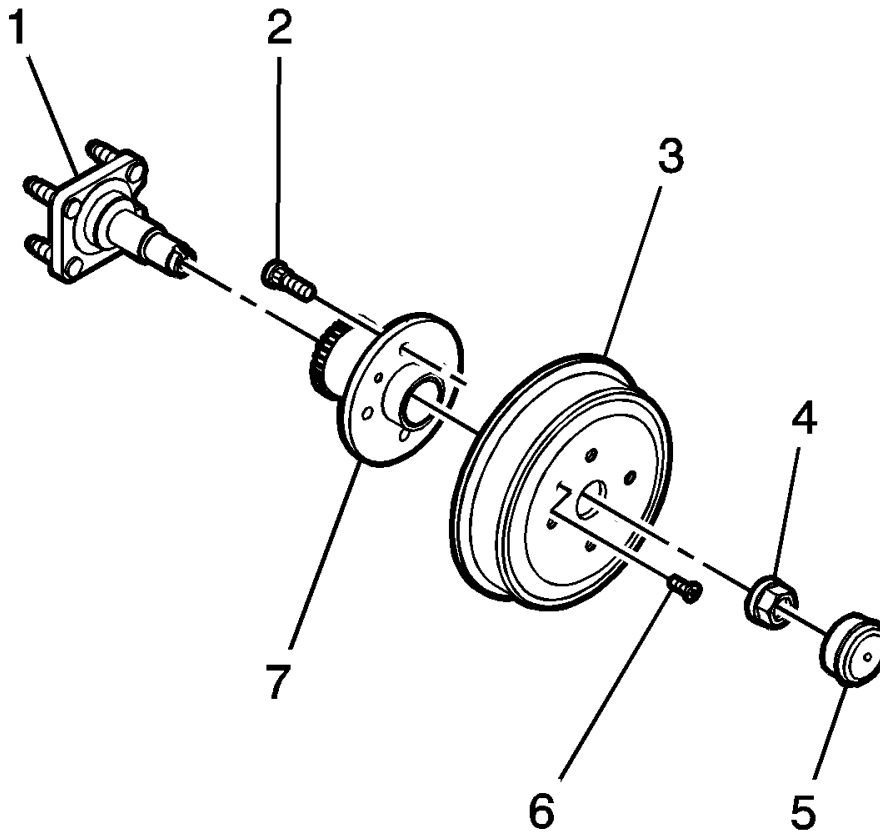

**Fig. 3: Rear Wheel Bearing/Hub Components**  
Courtesy of GENERAL MOTORS CORP.

**NOTE:** Slide the wheel bearing and hub assembly straight onto the spindle. Use care in order to properly position the wheel bearing races on the spindle.

1. Install the wheel bearing and hub assembly (7) to the spindle (1).

**CAUTION: Refer to Fastener Caution .**

2. Install the caulking nut (4) to the spindle and tighten to 190 N.m (140 lb ft).
3. Stake the caulking nut.

4. Install the brake drum. Refer to **Brake Drum Replacement** .
5. Install the rear wheel speed sensor, if equipped. Refer to **Rear Wheel Speed Sensor Replacement** .

## SHOCK ABSORBER REPLACEMENT

### Removal Procedure

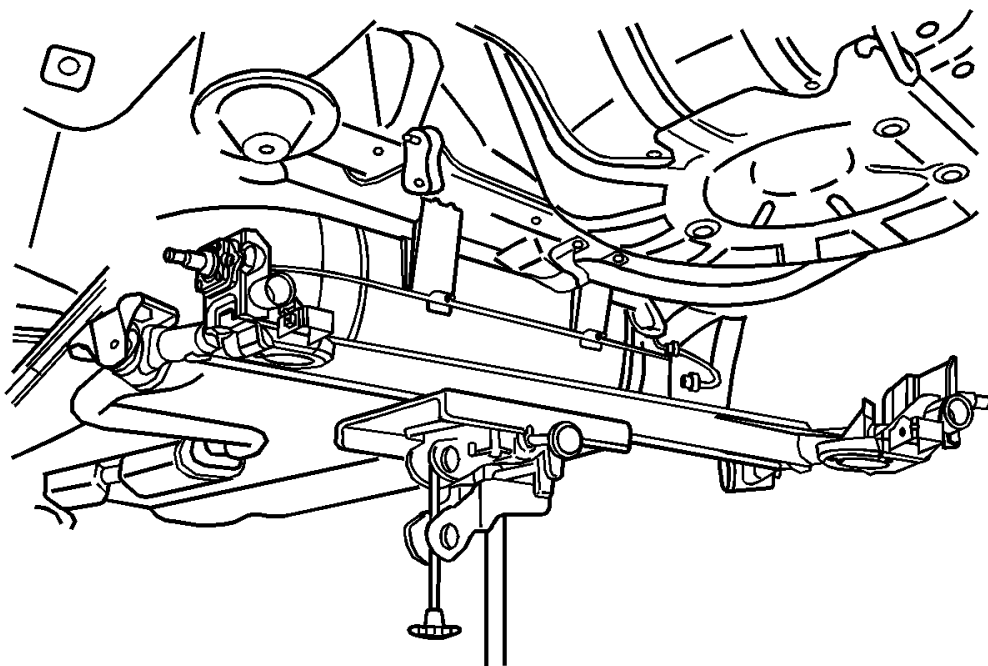

**Fig. 4: Jack Stand Support Rear Axle**  
Courtesy of GENERAL MOTORS CORP.

**CAUTION:** Remove only one shock at a time when both shocks are being replaced. Do not suspend the rear axle by the brake hoses. Damage to the brake hoses may result.

1. Remove the shock absorber-to-body bolts - upper.

**CAUTION:** Refer to **Vehicle Lifting and Jacking Caution** .

**NOTE:** When lifting the vehicle with a body hoist, it will be necessary to support the rear axle with adjustable jack stands.

2. Raise the vehicle and support the rear axle assembly.
3. Remove the lower shock absorber-to-axle bolt.
4. Remove the shock absorber.

**Installation Procedure**

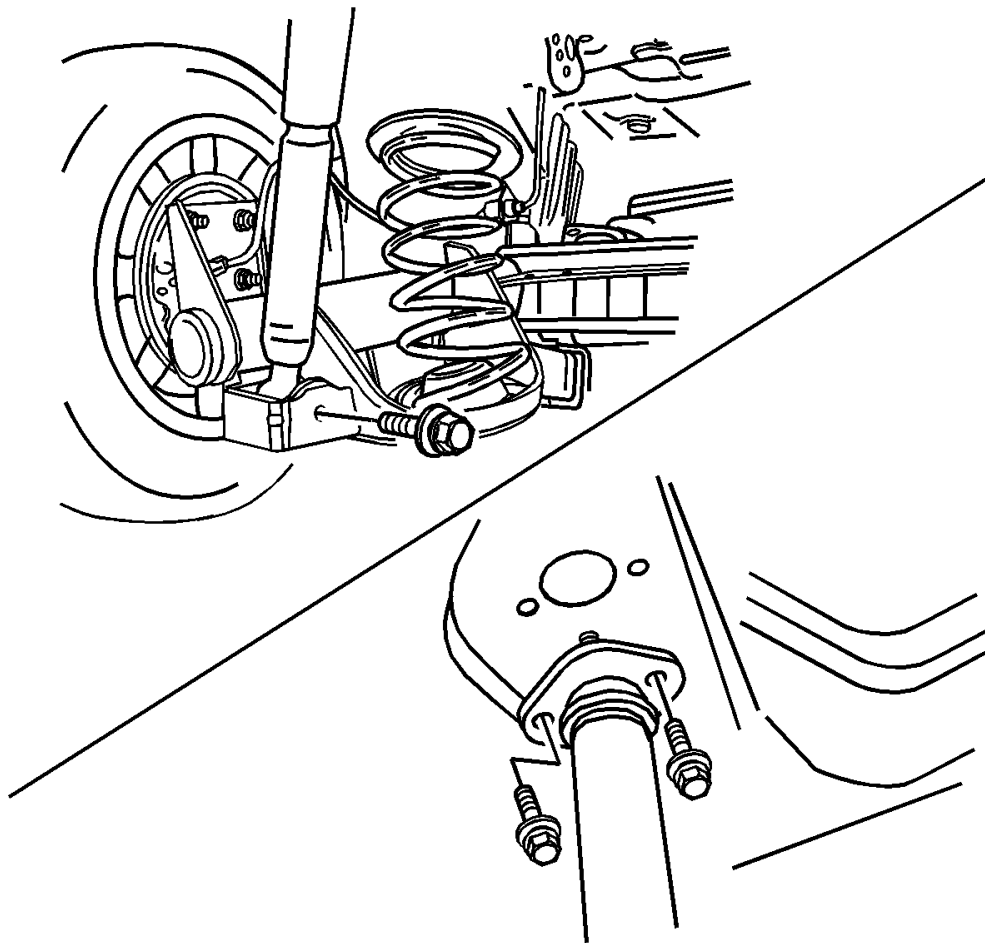

**Fig. 5: Lower Shock Absorber-To-Axle & Bolt**  
Courtesy of GENERAL MOTORS CORP.

**NOTE:** It will be necessary to bring the axle assembly to trim height prior to tightening the shock absorber attachment bolts.

1. Insert the lower shock absorber-to-axle bolt through the shock absorber lower attachment bracket and into the axle.

**CAUTION: Refer to Fastener Caution .**

2. Lower the vehicle enough to guide the upper shock stud on the body opening and loosely install the attaching bolts.
  - Tighten the lower shock absorber-to-axle bolt to 72 N.m (53 lb ft).
  - Tighten the upper shock absorber-to-body bolt to 50 N.m (37 lb ft).

## COIL SPRING REPLACEMENT

### Removal Procedure

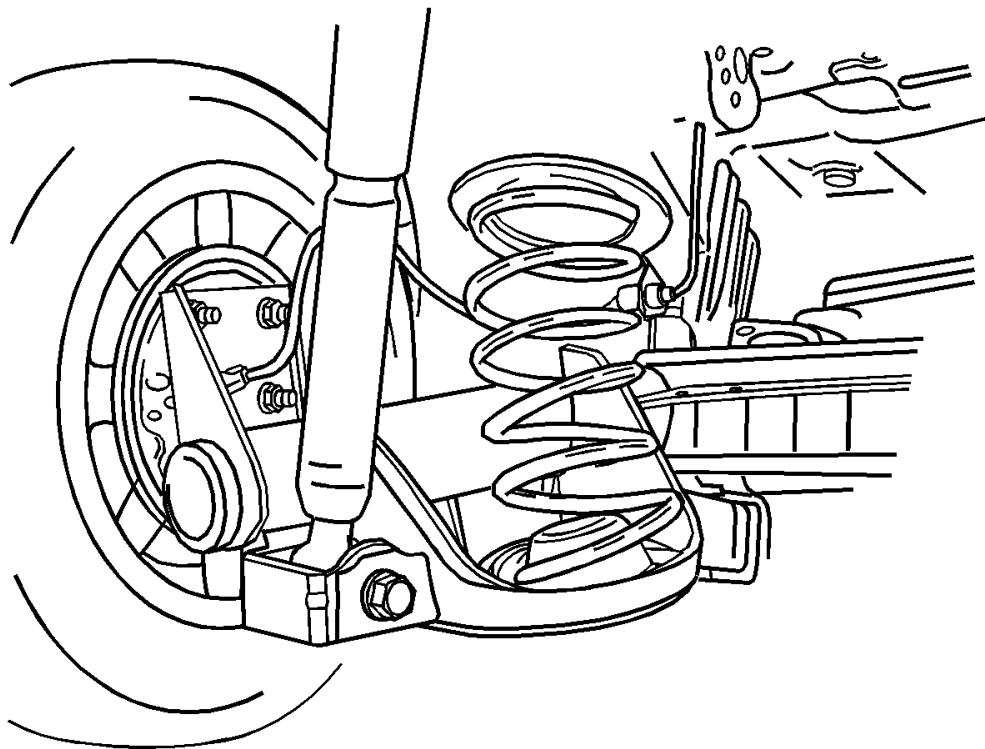

**Fig. 6: Jack Stand Support Rear Control Arms**  
Courtesy of GENERAL MOTORS CORP.