

Fig. 1: Identifying Valve Rocker Arm Inspection Areas
Courtesy of GENERAL MOTORS CORP.

3. Inspect the valve rocker arms for the following conditions:
 - Excessive wear at the valve contact or push rod socket area (1)
 - A loose or damaged pin (2)
 - A worn or damaged roller bearing (3)-The roller should rotate freely with no binding or roughness.
 - The bolt threads for damage

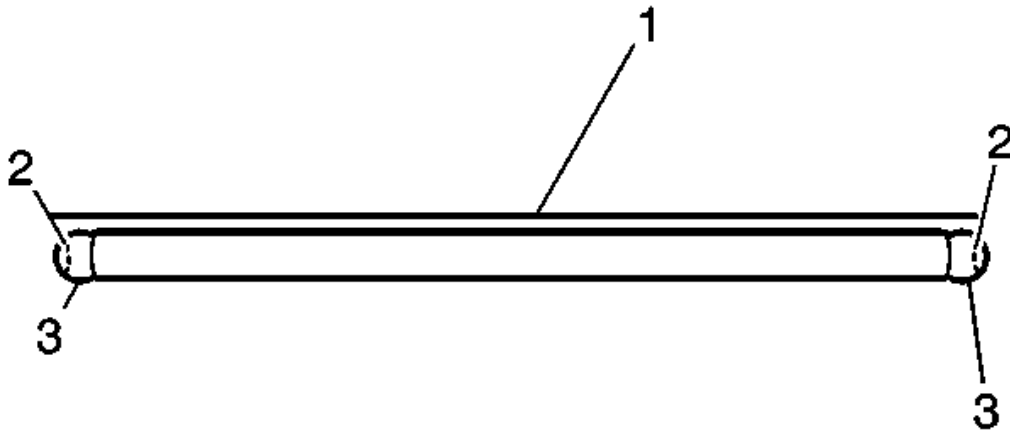

Fig. 2: Identifying Push Rod Inspection Areas
Courtesy of GENERAL MOTORS CORP.

NOTE: Keep the push rods in order. The intake and exhaust are different lengths.

4. Inspect the push rods for the following conditions:
 - Straightness using a straight edge (1)
 - Excessive wear on the push rod ends (3)
 - Clogging of the oil passage (2)

CYLINDER HEAD DISASSEMBLE

SPECIAL TOOLS

- **EN-47823:** Valve Spring Compressor Adapter
- **J 5892-D:** Valve Spring Compressor

For equivalent regional tools, refer to **Special Tools**

DISASSEMBLY PROCEDURE

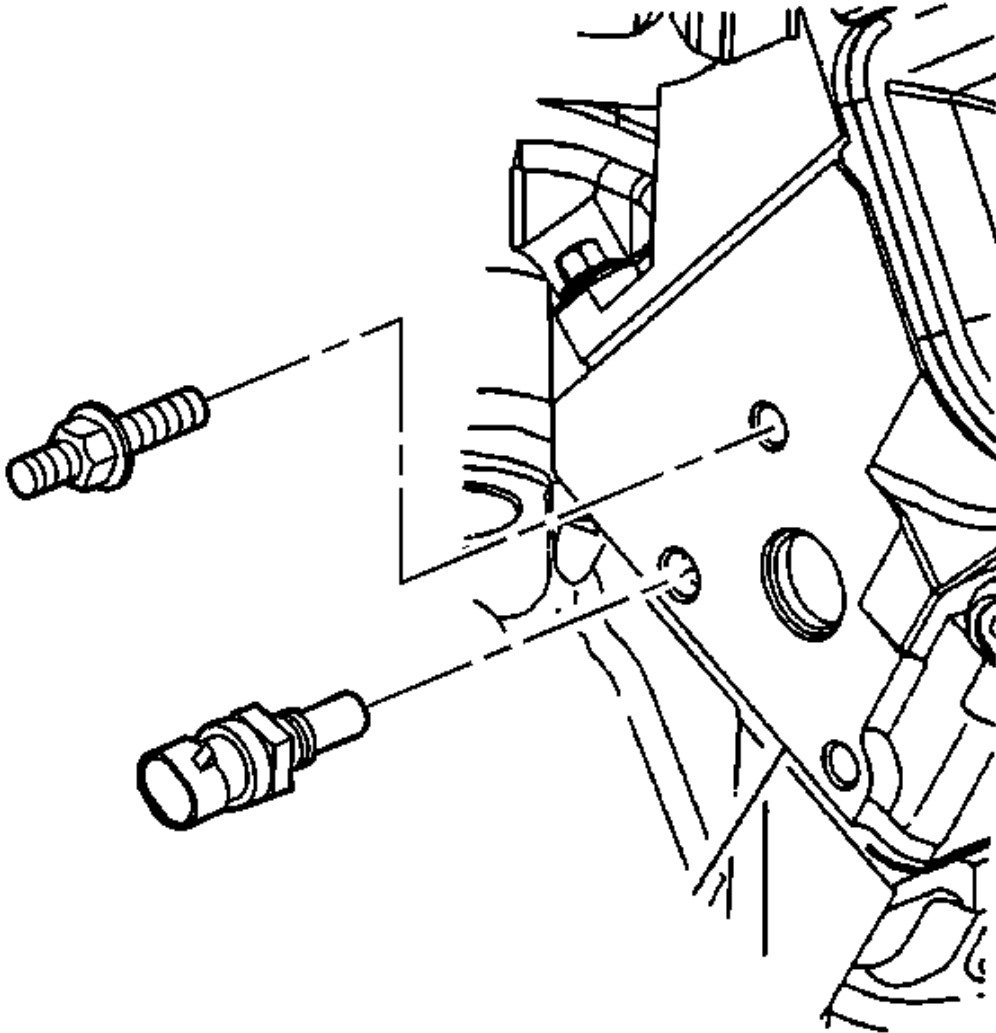

Fig. 3: View Of Heater Inlet Pipe Stud & Coolant Temperature Sensor
Courtesy of GENERAL MOTORS CORP.

1. Remove the heater inlet pipe stud from the right cylinder head, if required.
2. Remove the coolant temperature sensor from the right cylinder head, if required.

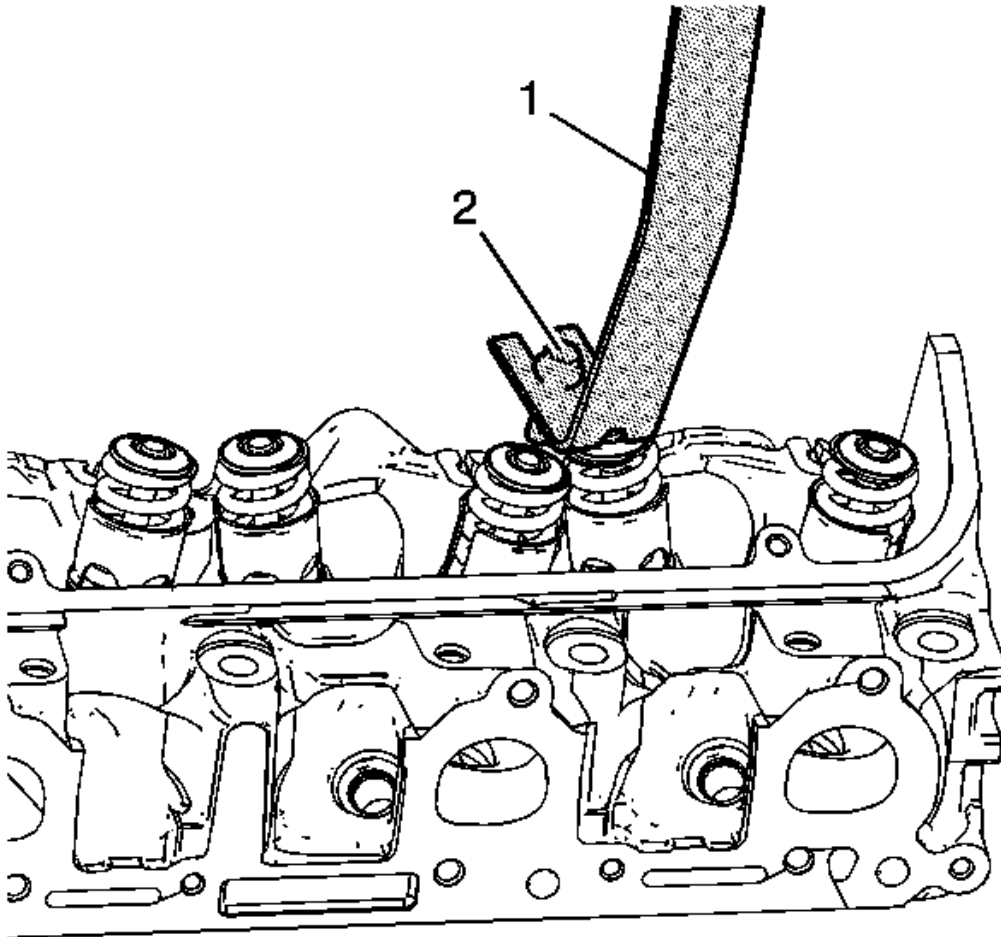

Fig. 4: Identifying Special Tools J 5892-D & EN 47823

Courtesy of GENERAL MOTORS CORP.

3. Using caution so as not to damage the valve spring or valve spring dampener, compress the valve springs using the **J 5892-D**: compressor (1) and the **EN-47823**: adapter (2).

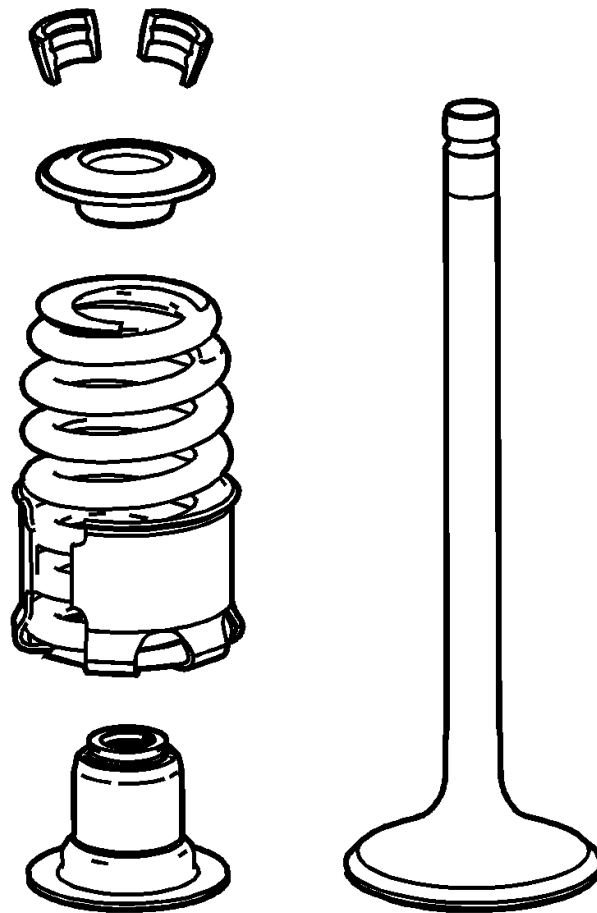

Fig. 5: Identifying Valve Components
Courtesy of GENERAL MOTORS CORP.

CAUTION: Do not damage the valve guide. Remove any burrs that have formed at the key groove by chamfering the valve stem with an oil stone or a file.

NOTE: Ensure that the valve train components are marked, organized or sorted when disassembling the cylinder head. Install the valve train components in the original location from which the component were removed.

4. Remove the valve spring cap keys.
5. Remove the valve spring caps.
6. Remove the valve spring assembly.
7. Remove the valves.
8. Remove the valve stem oil seals and spring seats as an assembly.